

Send to Appropriate  
Office  
This Lease - 4 copies  
If Lease - 3 copies

State of New Mexico  
Energy, Minerals and Natural Resources Department

Form O-102  
Revised 1-1-89

OIL CONSERVATION DIVISION

P.O. Box 2088  
Santa Fe, New Mexico 87504-2088

Exhibit #2

Apache "25" Fed. Com. No. 2  
Eddy County, New Mexico

PROPERTY I  
Box 1980, Hobbs, NM 88240

PROPERTY II  
Box 1980, Artesia, NM 88210

PROPERTY III  
Box 1980, Aztec, NM 87410

WELL LOCATION AND ACREAGE DEDICATION PLAT

All Distances must be from the outer boundaries of the section

Owner MITCHELL ENERGY Corporation			Lease APACHE 25 FEDERAL Com.		Well No. #2
Well Identifier O/P	Section 25	Township 22S.	Range 30E.	County EDDY	NMPM
Well Location of Well: 1320 feet from the EAST line and 660 feet from the SOUTH line					
Well Level Elev. 3336	Producing Formation Morrow		Pool Wildcat		Dedicated Acreage: 320 Acres

- Outline the acreage dedicated to the subject well by colored pencil or hatchure marks on the plat below.
- If more than one lease is dedicated to the well, outline each and identify the ownership thereof (both as to working interest and royalty).
- If more than one lease of different ownership is dedicated to the well, have the interest of all owners been consolidated by communitization, unitization, force-pooling, etc.?  
☐ Yes ☐ No If answer is "yes" type of consolidation \_\_\_\_\_  
If answer is "no" list the owners and tract descriptions which have actually been consolidated. (Use reverse side of this form if necessary.)  
No allowable will be assigned to the well until all interests have been consolidated (by communitization, unitization, forced-pooling, or otherwise) or until a non-standard unit, eliminating such interest, has been approved by the Division.

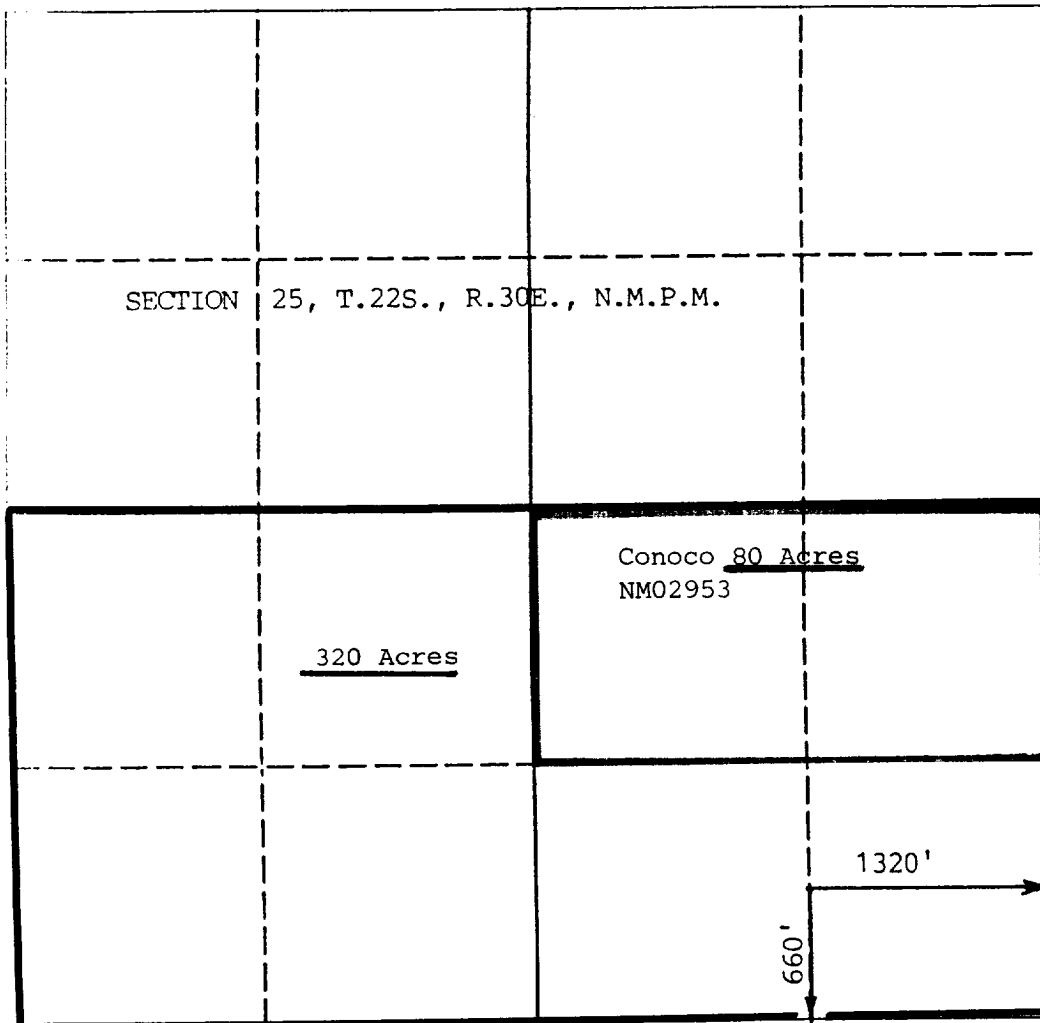

OPERATOR CERTIFICATION

I hereby certify that the information contained herein is true and complete to the best of my knowledge and belief.

Signature: *George Mullen*  
Printed Name: George Mullen  
Position: Reg. Affairs Specialist  
Company: Mitchell Energy Corp.  
Date: December 17, 1992

SURVEYOR CERTIFICATION

I hereby certify that the well location shown on this plat was plotted from field notes of actual surveys made by me or under my supervision, and that the same is true and correct to the best of my knowledge and belief.

Date Surveyed: 11/18/92  
Signature & Seal of Professional Surveyor: *JAQUES*  
Certificate No.: 6290  
6290

RECEIVED

JUN 21 1993

THE J. HBS  
LIBRARY