

Submit to Appropriate  
District Office  
State Lease - 4 copies  
Fee Lease - 3 copies

State of New Mexico  
Energy, Minerals and Natural Resources Department

Form C-102  
Revised 1-1-89

**OIL CONSERVATION DIVISION**

P.O. Box 2088  
Santa Fe, New Mexico 87504-2088

**DISTRICT I**

P.O. Box 1880, Hobbes, NM 88240

**DISTRICT II**

P.O. Drawer DD, Artesia, NM 88210

**DISTRICT III**

1000 Rio Brazos Rd., Aztec, NM 87410

**WELL LOCATION AND ACREAGE DEDICATION PLAT**

All Distances must be from the outer boundaries of the section

Operator <b>CHEVRON USA INC.</b>			Lease <b>LENTINI 1 FEDERAL</b>		Well No. <b>10</b>
Unit Letter <b>K</b>	Section <b>1</b>	Township <b>23 SOUTH</b>	Range <b>28 EAST</b>	NMPM	County <b>EDDY</b>
Actual Footage Location of Well: <b>2310</b> feet from the <b>SOUTH</b> line and <b>1750</b> feet from the <b>WEST</b> line					
Ground Level Elev. <b>3039'</b>	Producing Formation		Pool		Dedicated Acreage:  Acres

- Outline the acreage dedicated to the subject well by colored pencil or hachure marks on the plat below.
- If more than one lease is dedicated to the well, outline each and identify the ownership thereof (both as to working interest and royalty).
- If more than one lease of different ownership is dedicated to the well, have the interest of all owners been consolidated by communitization, unitization, force-pooling, etc.?  
☐ Yes ☐ No If answer is "yes" type of consolidation \_\_\_\_\_  
If answer is "no" list of owners and tract descriptions which have actually been consolidated. (Use reverse side of this form necessary.)  
No allowable will be assigned to the well unit all interests have been consolidated (by communitization, unitization, forced-pooling, otherwise) or until a non-standard unit, eliminating such interest, has been approved by the Division.

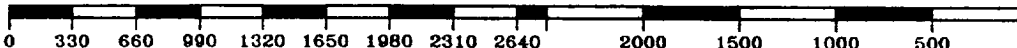
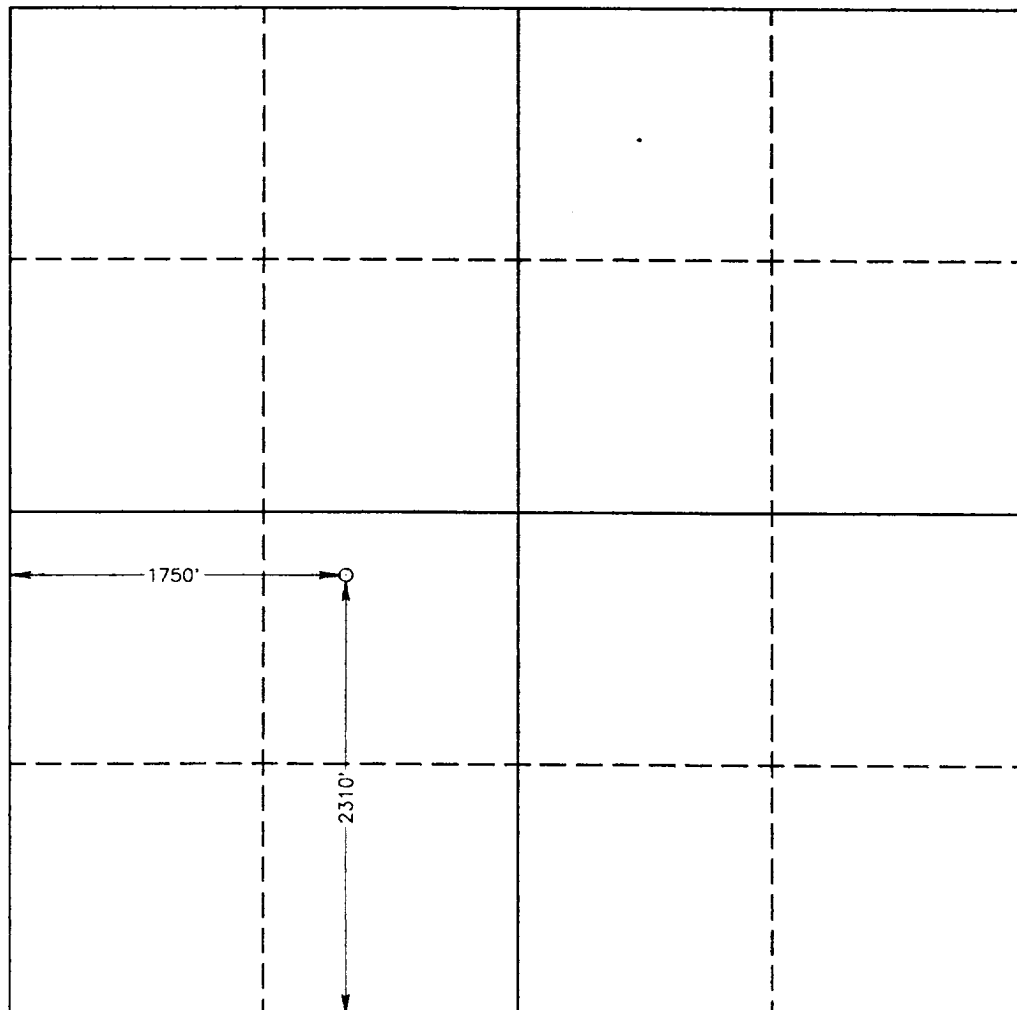

**OPERATOR CERTIFICATION**

I hereby certify the the information contained herein is true and complete to the best of my knowledge and belief.

Signature  
*Wendi Kingston*  
Printed Name  
Wendi Kingston

Position  
Drilling OA  
Company  
Chevron U.S.A. Inc.

Date  
2/2/94

**SURVEYOR CERTIFICATION**

I hereby certify that the well location shown on this plat was plotted from field notes of actual surveys made by me or under my supervision, and that the same is true and correct to the best of my knowledge and belief.

Date Surveyed  
JANUARY 12, 1994

Signature & Seal of  
Professional Surveyor

*Ronald J. Johnson*  
REGISTERED LAND SURVEYOR  
Certificate No. *739* JOHN MCNEST. 676  
RONALD J. JOHNSON 3239  
GARY L. JOHNSON 7977  
94-11170084