

OIL CONSERVATION DIVISION

DISTRICT I
 P.O. Box 1980, Hobbs, NM 88240

P.O. Box 2088
 Santa Fe, New Mexico 87504-2088

DISTRICT II
 P.O. Drawer DD, Artesia, NM 88210

WELL LOCATION AND ACREAGE DEDICATION PLAT

DISTRICT III
 1000 Rio Brazos Rd., Aztec, NM 87410

All Distances must be from the outer boundaries of the section

Operator ENRON OIL AND GAS CO.			Lease JAMES RANCH UNIT		Well No. 37
Unit Letter I	Section 36	Township 22 SOUTH	Range 30 EAST	County EDDY	
Actual Footage Location of Well: 1980 feet from the SOUTH line and 660 feet from the EAST line					
Ground Level Elev. 3310.2	Producing Formation Bone Spring/Delaware	Pool and QUAHOGA RIDGE, SE		Dedicated Acreage: 40 Acres	

- Outline the acreage dedicated to the subject well by colored pencil or hachure marks on the plat below.
- If more than one lease is dedicated to the well, outline each and identify the ownership thereof (both as to working interest and royalty).
- If more than one lease of different ownership is dedicated to the well, have the interest of all owners been consolidated by communitization, unitization, force-pooling, etc.?

Yes No If answer is "yes" type of consolidation _____

If answer is "no" list of owners and tract descriptions which have actually been consolidated. (Use reverse side of this form necessary.) _____

No allowable will be assigned to the well unit all interests have been consolidated (by communitization, unitization, forced-pooling, otherwise) or until a non-standard unit, eliminating such interest, has been approved by the Division.

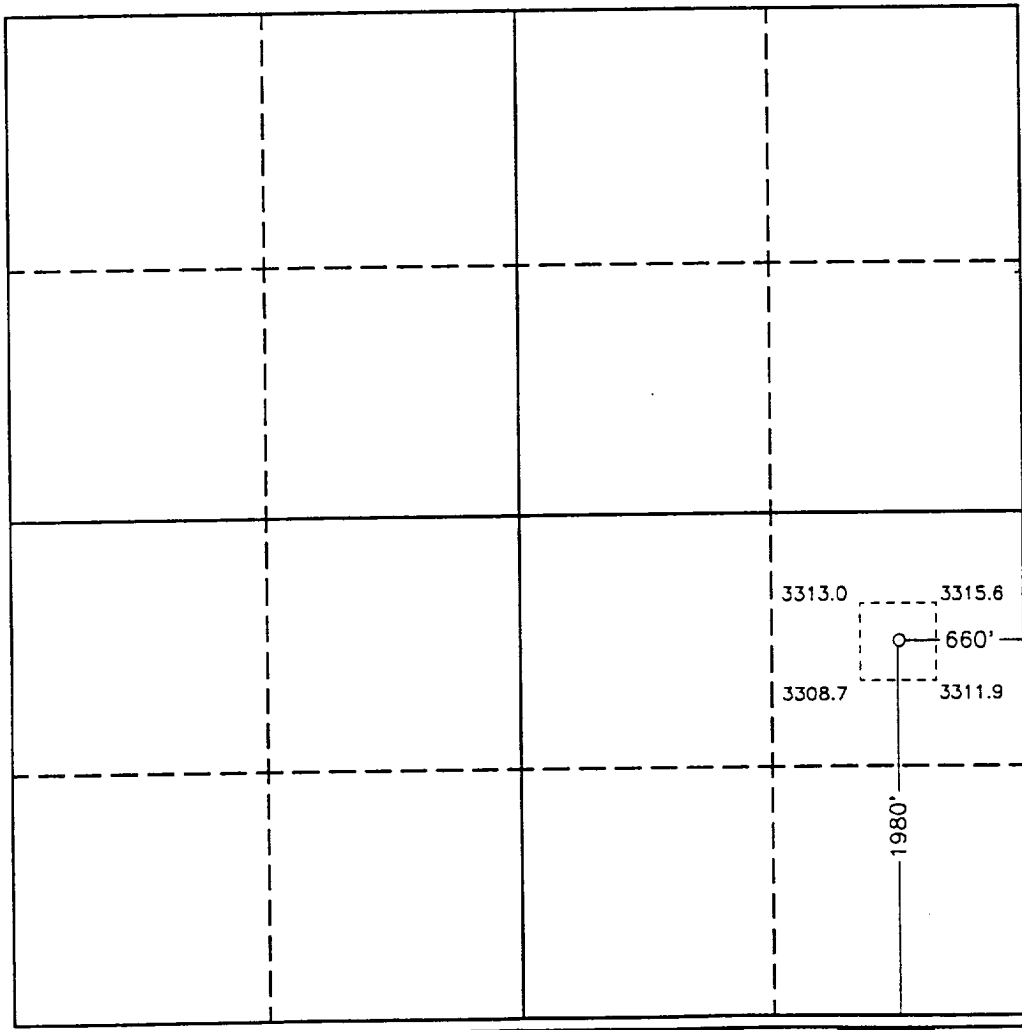

OPERATOR CERTIFICATION

I hereby certify the the information contained herein is true and complete to the best of my knowledge and belief.

Signature
Betty Gildon
 Printed Name
 Betty Gildon
 Position
 Regulatory Analyst
 Company
 Enron Oil & Gas Company
 Date
 5/20/93

SURVEYOR CERTIFICATION

I hereby certify that the well location shown on this plat was plotted from field notes of actual surveys made by me or under my supervision, and that the same is true and correct to the best of my knowledge and belief.

Date Surveyed
 MAY 1, 1993
 Signature & Seal of
 Professional Surveyor

Gary L. Jones
 Certificate No. JOHN W. WEST 878
 RONALD J. EDSON 3239
 GARY L. JONES 7977

