

NM OIL CONS. COMMISSION
UNITED STATES
DEPARTMENT OF THE INTERIOR
BUREAU OF LAND MANAGEMENT

SUBMIT IN TYPE
(Other Instru
reverse s.

FORM APPROVED
OMB NO. 1004-0136
Expires: February 28, 1995

APPLICATION FOR PERMIT TO DRILL OR DEEPEN

1a. TYPE OF WORK

DRILL ☒

DEEPEN ☐

b. TYPE OF WELL

OIL
WELL ☒

GAS
WELL ☐

OTHER ☐

SINGLE
ZONE ☐

MULTIPLE
ZONE ☐

2. NAME OF OPERATOR

Santa Fe Energy Operating Partners, L.P. **20290**

3. ADDRESS AND TELEPHONE NO.

550 W. Texas, Suite 1330, Midland, Texas 79701

4. LOCATION OF WELL (Report location clearly and in accordance with any State requirements.)*

At surface

(N) 330' FSL & 2310' FWL, Sec 34, T-23-S, R-31-E
At proposed prod. zone

14. DISTANCE IN MILES AND DIRECTION FROM NEAREST TOWN OR POST OFFICE*

21 miles east of Loving, New Mexico

16. DISTANCE FROM PROPOSED*

LOCATION TO NEAREST
PROPERTY OR LEASE LINE, FT. 330'
(Also to nearest drig. unit line, if any)

18. NO. OF ACRES IN LEASE

640

17. NO. OF ACRES ASSIGNED
TO THIS WELL

40

18. DISTANCE FROM PROPOSED LOCATION*

TO NEAREST WELL, DRILLING, COMPLETED,
OR APPLIED FOR, ON THIS LEASE, FT. 1650'

19. PROPOSED DEPTH

8200'

20. ROTARY OR CABLE TOOLS

Rotary

21. ELEVATIONS (Show whether DF, RT, GR, etc.)

3451' GR

22. APPROX. DATE WORK WILL START*

October 26, 1994

23.

PROPOSED CASING AND CEMENTING PROGRAM

R-111-P Potash

SIZE OF HOLE	GRADE SIZE OF CASING	WEIGHT PER FOOT	SETTING DEPTH	QUANTITY OF CEMENT
17-1/2"	H-40 13-3/8"	48.0	600'	600sx to circulate
12-1/4"	K-55 8-5/8"	32.0	4200'	2000sx to circulate
7-7/8"	K-55 5-1/2"	15.5 7 17.0	8200'	Tie back to 4000'

We propose to drill to a depth sufficient to test the Delaware formation for oil. If productive 5-1/2" casing will be run to TD. If non-productive the well will be plugged and abandoned in a manner consistent with Federal Regulations. Specific programs as per Onshore Oil and Gas Order No. 1 are outlined in the following attachments:

Drilling Program

Exhibit A - Operations Plan
Exhibit B - BOP and Choke Manifold
Exhibit C - Drilling Fluid Program
Exhibit D - Auxiliary Equipment

Exhibit E - Topo Map of Location
Exhibit F - Map Showing Existing Wells
Exhibit F(A) - Plat of Location
Exhibit G - Well Site Layout
Surface Use and Operations Plan

IN ABOVE SPACE DESCRIBE PROPOSED PROGRAM: If proposal is to deepen, give data on present productive zone and proposed new productive zone. If proposal is to drill or deepen directionally, give pertinent data on subsurface locations and measured and true vertical depths. Give blowout preventer program, if any.

SIGNED

James P. Phil

TITLE Agent for Santa Fe Energy

DATE 9-19-94

(This space for Federal or State office use)

PERMIT NO.

APPROVAL DATE

Application approval does not warrant or certify that the applicant holds legal or equitable title to those rights in the subject lease which would entitle the applicant to conduct operations thereon.

CONDITIONS OF APPROVAL, IF ANY:

APPROVAL SUBJECT TO
GENERAL REQUIREMENTS AND
SPECIAL STIPULATIONS
ATTACHED

APPROVED BY

William C. Calkins

TITLE

State Director

DATE

11/29/94

*See Instructions On Reverse Side

DISTRICT I
P. O. Box 1980
Hobbs, NM 88241-1980

State of New Mexico
Energy, Minerals, and Natural Resources Department

Form C-102
Revised 02-10-94

Instructions on back

DISTRICT II
P. O. Drawer DD
Artesia, NM 88211-0719

OIL CONSERVATION DIVISION
P. O. Box 2088
Santa Fe, New Mexico 87504-2088

Submit to the Appropriate
District Office
State Lease - 4 copies
Fee Lease - 3 copies

☐ AMENDED REPORT

DISTRICT III
1000 Rio Brazos Rd.
Aztec, NM 87410

DISTRICT IV
P. O. Box 2088
Santa Fe, NM 87507-2088

WELL LOCATION AND ACREAGE DEDICATION PLAT

¹ API Number	² Pool Code 53815	³ Pool Name Sand Dunes West (Delaware)
⁴ Property Code N	⁵ Property Name STERLING SILVER '34' FEDERAL	⁶ Well Number 6
⁷ OGRID No.	⁸ Operator Name SANTA FE ENERGY OPER. PART, L.P.	⁹ Elevation 3451'

¹⁰ SURFACE LOCATION

UL or lot no. N	Section 34	Township 23 SOUTH	Range 31 EAST, N.M.P.M.	Lot Ida	Feet from the 330'	North/South line SOUTH	Feet from the 2310'	East/West line WEST	County EDDY
--------------------	---------------	----------------------	----------------------------	---------	-----------------------	---------------------------	------------------------	------------------------	----------------

"BOTTOM HOLE LOCATION IF DIFFERENT FROM SURFACE"

UL or lot no.	Section	Township	Range	Lot Ida	Feet from the	North/South line	Feet from the	East/West line	County
---------------	---------	----------	-------	---------	---------------	------------------	---------------	----------------	--------

¹² Dedicated Acres 40	¹³ Joint or Infill	¹⁴ Consolidation Code	¹⁵ Order No.
-------------------------------------	-------------------------------	----------------------------------	-------------------------

NO ALLOWABLE WELL BE ASSIGNED TO THIS COMPLETION UNTIL ALL INTERESTS HAVE BEEN
CONSOLIDATED OR A NON-STANDARD UNIT HAS BEEN APPROVED BY THE DIVISION

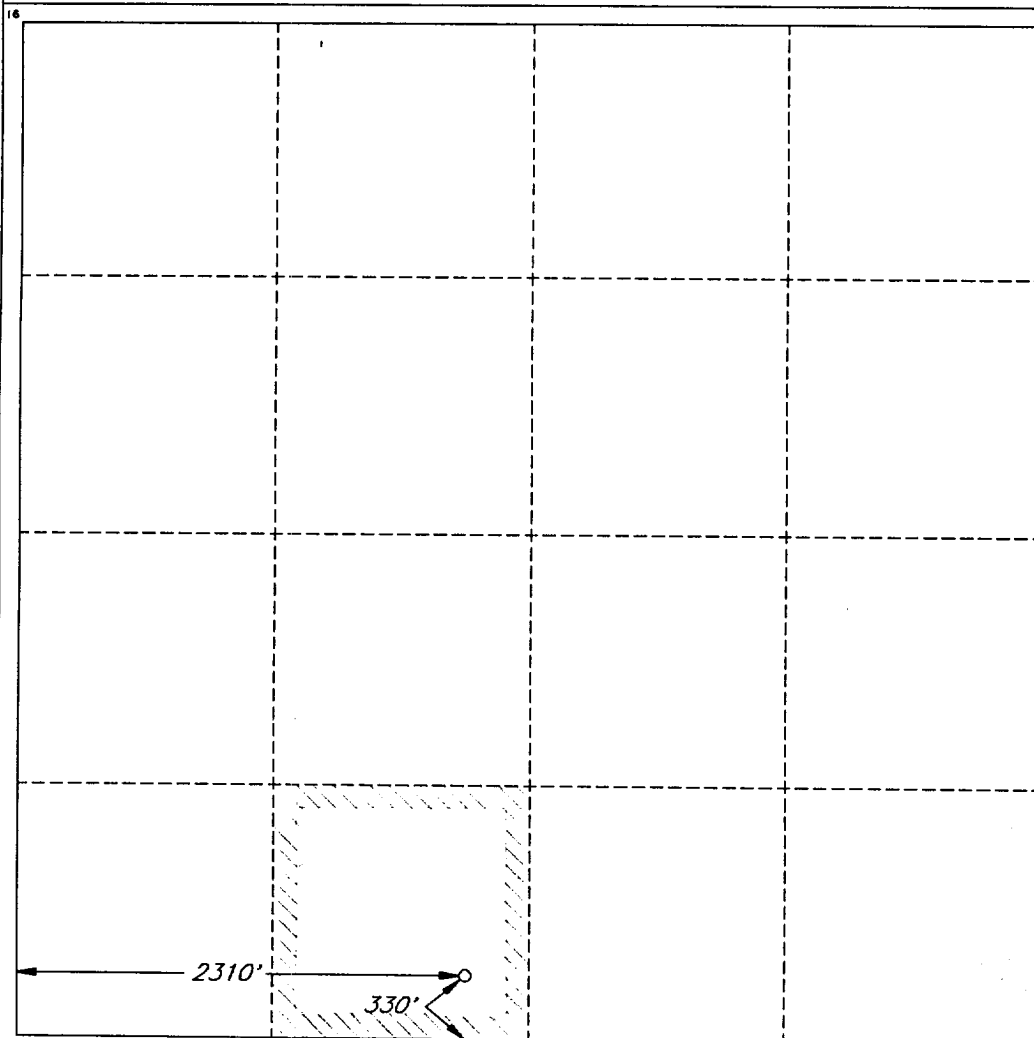

OPERATOR CERTIFICATION

I hereby certify that the information
contained herein is true and complete
to the best of my knowledge and belief.

Signature
James P. Phil Stinson
Printed Name

James P. (Phil) Stinson

Title

Agent

Date

9-19-94

SURVEYOR CERTIFICATION

I hereby certify that the well
location shown on this plat was
plotted from field notes of actual
surveys made by me or under
my supervision, and that the
same is true and correct to the
best of my belief.

Date of Survey
SEPTEMBER 1, 1994

Signature and Seal of
Professional Surveyor

V. Lynn Bezner
V. LYNN
BEZNER
NO. 7920

Certification No.
V. L. BEZNER LAND SURVEYOR #7920

JOB #35240 7 48 SE / V.H.B.

EXHIBIT B

BOP AND CHOKE ARRANGEMENT
SANTA FE ENERGY OPERATING PARTNERS, L.P.
STERLING SILVER "34" FED COM #6
330' FSL & 2310' FWL
SEC 34, T-23-S, R-31-E
EDDY COUNTY, NEW MEXICO

