

DISTRICT I
P.O. Box 1980, Hobbs, NM 88241-1980
DISTRICT II
P.O. Box Drawer DD, Artesia, NM 88211-0719
DISTRICT III
1000 Rio Brazos Rd., Aztec, NM 87410
DISTRICT IV
P.O. Box 2088, Santa Fe, NM 87504-2088

State of New Mexico
Energy, Minerals and Natural Resources Department

OIL CONSERVATION DIVISION

P.O. Box 2088
Santa Fe, New Mexico 87504-2088

Form C-101
Revised February 10, 1994
Instructions on back
Submit to Appropriate District Office
State Lease - 6 Copies
Fee Lease - 5 Copies

APPLICATION FOR PERMIT TO DRILL, RE-ENTER, DEEPEN, PLUGBACK, OR ADD A ZONE

Operator Name and Address TEXACO EXPLORATION & PRODUCTION INC. 205 E. Bender, HOBBS, NM 88240		OGRID Number 022351
Property Code 17551	Property Name REMUDA BASIN STATE	API Number 30-015-28420
		Well No. 4

7 Surface Location									
UI or lot no.	Section	Township	Range	Lot.Idn	Feet From The	North/South Line	Feet From The	East/West Line	County
N	19	23-S	30-E		660	SOUTH	1980	WEST	EDDY

8 Proposed Bottom Hole Location If Different From Surface									
UI or lot no.	Section	Township	Range	Lot.Idn	Feet From The	North/South Line	Feet From The	East/West Line	County
9 Proposed Pool 1 BONE SPRING, WEST					10 Proposed Pool 2				

11 Work Type Code E	12 WellType Code O	13 Rotary or C.T. ROTARY	14 Lease Type Code S	15 Ground Level Elevation 3041' GR
16 Multiple No	17 Proposed Depth 7500'	18 Formation DELAWARE/BONE SPRING	19 Contractor	20 Spud Date 9/18/98

21 Proposed Casing and Cement Program					
SIZE OF HOLE	SIZE OF CASING	WEIGHT PER FOOT	SETTING DEPTH	SACKS OF CEMENT	EST. TOP
14 3/4	11 3/4	24#	405'	400 SACKS	SURFACE
11	8 5/8	24#	3205'	950 SACKS	SURFACE
7 7/8	5 1/2	15.5#, 17#	8494.85'	1650 SACKS	SURFACE

22 Describe the proposed program. If this application is to DEEPEN or PLUG BACK give the data on the present productive zone and proposed new productive zone. Describe the blowout prevention program, if any. Use additional sheets if necessary.

TEXACO INTENDS TO PULL A RBP TO EXPOSE BONE SPRING PAY IN THE REMUDA BASIN STATE #4. THE SUBJECT WELL IS PRODUCING 13 BOPD, 62 BWPD, & 170 MCFPD FROM THE LOWER BRUSHY CANYON. THIS WORKOVER WILL ADD 18 BOPD, 180 BWPD, & 30 MCFPD TO THE WELLS PRODUCTION STREAM. DOWNHOLE COMMINGLING HAS BEEN VERBALLY APPROVED FROM SANTA FE, NM (DHC 2092)

THE INTENDED PROCEDURE IS ATTACHED.

23 I hereby certify that the rules and regulations of the Oil Conservation Division have been complied with and that the information given above is true and complete to the best of my knowledge and belief.		OIL CONSERVATION DIVISION	
Signature <i>J. Denise Leake</i>		Approved By: ORIGINAL SIGNED BY TIM W. GUM DISTRICT II SUPERVISOR	
Printed Name J. Denise Leake		Title:	
Title Engineering Assistant		Approval Date: 9-16-98 Expiration Date: 9-16-99	
Date 9/16/98	Telephone 397-0405	Conditions of Approval: Attached <input type="checkbox"/>	

Remuda Basin State #4
660 FSL & 1980 FWL, N-19-23S-30E
Lea County, New Mexico

Commingling Procedure

Well Data

Tubing:	2-7/8"	Casing:	15.5# & 17# 5-1/2" K-55 @ 8500'
TD:	8500'	PEID:	7100' Elevation: 3041' GL 11.8' KB

Open Perforations:

Lower Brushy Canyon 6976' – 7012' w/ 2 spf (73 holes)

Plugged Back Perforations:

Upper Bone Spring 7160' – 7196' w/ 6 spf (216 holes)

1st Bone Spring 8207' – 8224' & 8318' – 8338' w/ 6 spf

Procedure

1. TOH with pump & rods. Call Unichem, Jerry White, and Axelson, John Dimock, prior to getting pump out of hole. Inspect pump and rods for scale and paraffin, collect samples.
2. Scanalog tubing out of hole.
3. Circulate debris off of 5-1/2" RBP @ 7100'. Unset RBP & tag new PBTD (8450') for fill. Strap out with 5-1/2" RBP.
4. TIH with bit & bailer. Clean out to new PBTD @ 8450'. TOH.
5. Run Check Shot Survey.
6. TIH with 5-1/2" treating packer & RBP on 2-7/8" workstring. Set RBP at +/- 8400'. Set packer at +/- 8150'. Establish a rate into perfs with 2% KCl water. Acidize 1st Bone Spring perfs (8207' – 8338') with 2500 gal 80/20 DAD Acid (2000 gal 15% HCl & 500 gal Xylene) with rock salt as diverter.
7. Unset packer & RBP. Set RBP at +/- 7250'. Set packer at +/- 7100'. Establish a rate into perfs with 2% KCl water. Acidize Upper Bone Spring perfs (7160' – 7196') with 2500 gal 80/20 DAD Acid (2000 gal 15% HCl & 500 gal Xylene) and rock salt as diverter.
8. Unset packer & RBP. Set RBP at +/- 7100'. Set packer at +/- 6900'. Establish a rate into perfs with 2% KCl water. Acidize Lower Brushy Canyon perfs (6976' – 7012') with 2500 gal 80/20 DAD Acid (2000 gal 15% HCl & 500 gal Xylene) and rock salt as diverter.
9. Unset packer & RBP. TIH & set RBP at +/- 8400'. Do not set packer. Swab back all intervals to neutral pH. TOH with packer & RBP.
10. TIH with 3-1/2" MHMA, SN, 1 2-7/8" IPC joint, & 2-7/8" tubing with tubing anchor. Set tubing anchor at +/- 6900'. Set SN below bottom perf @ 8332'. Run 12' gas anchor, 1-3/4" pump, and sucker rods with T grade couplings.

Rod Design:

96	1" rods	2400'	0 1" rods on hand
118	7/8" rods	2950'	103 7/8" rods on hand
110	3/4" rods	2750'	103 3/4" rods on hand
10	1.5" SB	<u>250'</u>	10 SB on hand
		8350'	

11. Return well to production. RD pulling unit. Have Unichem treat for corrosion & paraffin.

Contacts

Foreman: Ray Short (505) 887-5676
Lease Operators: Joe Garcia (505) 369-5463, Earnest Roberts (505) 369-5549,
Larry Rice (505) 369-5536
FMT Support: Mike Parker (505) 369-6162
Engineering: Jason Wacker (505) 397-0484
Lea County Packer: Quinn Capps (505) 390-1160
Unichem: Jerry White (505) 370-9509
Dowell: Kelvin Fisher \ Hank Horton (505) 390-4858
Axelson: John Dimock (505) 392-5583

DISTRICT I

P.O. Box 1980, Hobbs, NM 88241-1980

DISTRICT II

P.O. Box Drawer DD, Artesia, NM 88211-0719

DISTRICT III

1000 Rio Brazos Rd., Aztec, NM 87410

DISTRICT IV

P.O. Box 2088, Santa Fe, NM 87504-2088

State of New Mexico
Energy, Minerals and Natural Resources Department

OIL CONSERVATION DIVISION

P.O. Box 2088
Santa Fe, New Mexico 87504-2088

Form C-102

Revised February 10, 1994

Instructions on back

Submit to Appropriate District Office

State Lease - 4 Copies

Fee Lease - 3 Copies

☐ AMENDED REPORT

WELL LOCATION AND ACREAGE DEDICATION PLAT

¹ API Number 30-015-28420	² Pool Code 47545	³ Pool Name NASH DRAW-BRUSHY CANYON
⁴ Property Code 17551	⁵ Property Name REMUDA BASIN STATE	⁶ Well No. 4
⁷ OGRID Number 022351	⁸ Operator Name TEXACO EXPLORATION & PRODUCTION INC.	⁹ Elevation 3041' GR

¹⁰ Surface Location

UI or lot no.	Section	Township	Range	Lot.Idn	Feet From The	North/South Line	Feet From The	East/West Line	County
N	19	23-S	30-E		660	SOUTH	1980	WEST	EDDY

¹¹ Bottom Hole Location If Different From Surface

UI or lot no.	Section	Township	Range	Lot.Idn	Feet From The	North/South Line	Feet From The	East/West Line	County

¹² Dedicated Acres 40	¹³ Joint or Infill No	¹⁴ Consolidation Code	¹⁵ Orcer No.
-------------------------------------	-------------------------------------	----------------------------------	-------------------------

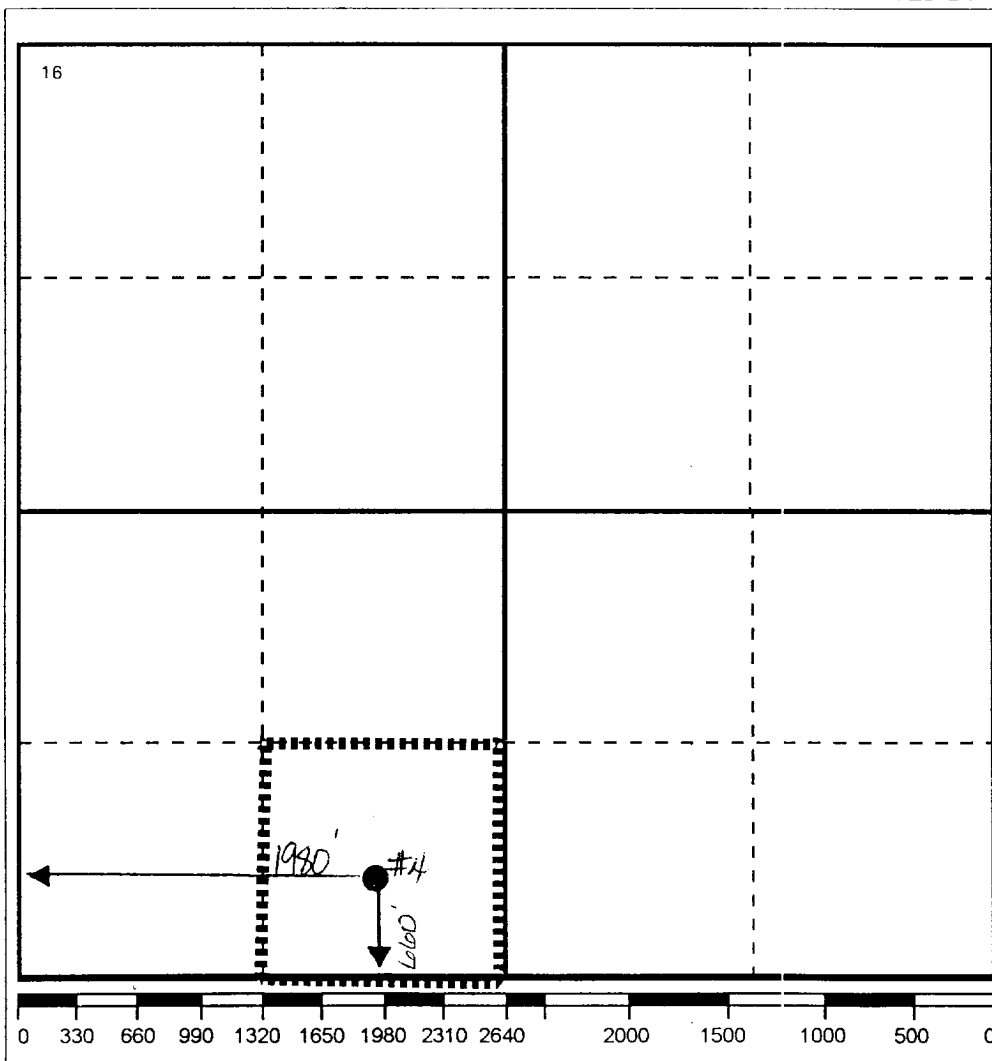
NO ALLOWABLE WILL BE ASSIGNED TO THIS COMPLETION UNTIL ALL INTERESTS HAVE BEEN CONSOLIDATED
OR A NON-STANDARD UNIT HAS BEEN APPROVED BY THE DIVISION

17 OPERATOR CERTIFICATION

I hereby certify that the information
contained herein is true and complete to the
best of my knowledge and belief

Signature

J. Denise Leake

Printed Name

J. Denise Leake

Position

Engineering Assistant

Date

9/16/98

18 SURVEYOR CERTIFICATION

I hereby certify that the well location shown
on this plat was plotted from field notes of
actual surveys made by me or under my
supervision, and that the same is true and
correct to the best of my knowledge and
belief.

Date Surveyed

Signature & Seal of

Professional Surveyor

Certificate No.