

C/SF

Form 3160-3
(December 1990)

UNITED STATES
DEPARTMENT OF THE INTERIOR
BUREAU OF LAND MANAGEMENT

SUBMIT IN TRIPLICATE

FORM APPROVED
Budget Bureau No. 1004-0136
Expires: December 31, 1991

5. Lease Designation and Serial No.
NM-29233

6. If Indian, Alottee or Tribe Name

7. If Unit or CA, Agreement Designation

8. Well Name and Number
NEFF '13' FEDERAL 11008

10

9. API Well No.

30-015-28708

10. Field and Pool, Exploratory Area

LIVINGSTON RIDGE - DELAWARE 34630

11. SEC., T., R., M., or BLK. and Survey or Area

Sec. 13, Township 22-S, Range 31-E

12. County or Parish

EDDY

13. State

NM

17. No. of Acres Assigned To This Well

40

20. Rotary or Cable Tools

ROTARY

22. Approx. Date Work Will Start*

10/15/95

APPLICATION FOR PERMIT TO DRILL OR DEEPEN

1a. Type of Work DRILL ☒ DEEPEN ☐

1b. Type of Well

OIL WELL ☒ GAS WELL ☐ OTHER

SINGLE ZONE ☒

MULTIPLE ZONE ☐

2. Name of Operator
TEXACO EXPLORATION & PRODUCTION INC. 22351

3. Address and Telephone No.
P.O. Box 3109, Midland Texas 79702 688-4606

4. Location of Well (Report location clearly and in accordance with any State requirements.)

At Surface

Unit Letter P : 990 Feet From The SOUTH Line and 990 Feet From The EAST Line

At proposed prod. zone

SAME

14. Distance in Miles and Direction from Nearest Town or Post Office*

32 MILES NORTHEAST OF CARLSBAD, NM.

15. Distance From Proposed* Location to Nearest Property or Lease Line, Ft. (also to nearest drig. unit line, if any)

990'

16. No. of Acres in Lease

640

18. Distance From Proposed Location* to Nearest Well, Drilling, Completed or Applied For, On This Lease, Ft.

1043'

19. Proposed Depth

8500'

21. Elevations (Show whether DF, RT, GR, etc.)

GR-3587

Continued Operation of Water Basin

23.

PROPOSED CASING AND CEMENT PROGRAM

Secretary's Permit

SIZE OF HOLE	GRADE, SIZE OF CASING	WEIGHT PER FOOT	SETTING DEPTH	QUANTITY OF CEMENT
14 3/4	WC40, 11 3/4	42#	800'	400 SACKS - CIRCULATE
11	WC50, 8 5/8	24 & 32#	4400'	1350 SACKS - CIRCULATE
7 7/8	K55, 5 1/2	15.5 & 17#	8500'	1200 SACKS - TOC @ 3500'

CEMENTING PROGRAM:

SURFACE CASING - 400 SACKS CLASS C W/ 2% CACL2 (14.8 PPG, 1.34 CF/S, 6.3 GW/S).

INTERMEDIATE CASING - 1200 SACKS 35/65 POZ CLASS H W/ 6% GEL, 5% SALT, 1/4# FLOCELE (12.4 PPG, 2.14 CF/S, 11.9 GW/S). F/B 150 SACKS CLASS H (15.6 PPG, 1.18 CF/S, 5.2 GV/S).

PRODUCTION CASING - 700 SACKS 35/65 PCZ CLASS H W/ 6% GEL, 5% SALT, 1/4# FLOCELE (12.4 PPG, 2.14 CF/S, 11.9 GW/S). F/B 500 SACKS 50/50 POZ CLASS H W/ 2% GEL, 5% SALT, 1/4# FLOCELE (14.2 PPG, 1.35 CF/S, 6.3 GW/S).

THERE ARE NO OTHER OPERATORS IN THIS QUARTER QUARTER SECTION.

Special Requirements and
Special Stipulations
Attached

In Above Space Describe Proposed Program: If proposal is to deepen, give data on present productive zone and proposed new productive zone. If proposal is to drill or deepen directionally, give pertinent data on subsurface locations and measured true verticle depths. Give blowout preventer program, if any.

24. I hereby certify that the foregoing is true and correct

SIGNATURE C. Wade Howard TITLE Eng. Assistant

DATE 9/12/95

TYPE OR PRINT NAME C. Wade Howard

(This space for Federal or State office use)

PERMIT NO. APPROVAL DATE

Application approval does not warrant or certify that the applicant holds legal or equitable title to those rights in the subject lease which would entitle the applicant to conduct operations thereon.

APPROVED BY Joseph Chesser TITLE Acting State Director DATE 10-24-95

CONDITIONS OF APPROVAL, IF ANY:

Title 18 U.S.C. Section 1001, makes it a crime for any person knowingly and willfully to make to any department or agency of the United States any false, fictitious or fraudulent statements or representations as to any matter within its jurisdiction.

DISTRICT I
P. O. Box 1980, Hobbs, NM 88240

DISTRICT II
P. O. Drawer DC, Artesia, NM 88210

DISTRICT III
1000 Rio Brazos Rd., Aztec, NM 87410

DISTRICT IV
P. O. Box 2088, Santa Fe, NM 87504-2088

State of New Mexico
Energy, Minerals and Natural Resources Department

OIL CONSERVATION DIVISION
PO Box 2088
Santa Fe, NM 87504-2088

Form C-102
Revised February 10, 1994

Instructions on back

Submit to Appropriate District Office

State Lease-4 copies
Fee Lease-3 copies

☐ AMENDED REPORT

WELL LOCATION AND ACREAGE DEDICATION PLAT

¹ API Number		² Pool Code 39360		³ Pool Name Livingston Ridge-Delaware	
⁴ Property Code 11008		⁵ Property Name Neff "13" Federal			⁶ Well Number 10
⁷ GRID No. 22351		⁸ Operator Name TEXACO EXPLORATION & PRODUCTION, INC.			⁹ Elevation 3587'

¹⁰ Surface Location									
UL or lot no. P	Section 13	Township 22-S	Range 31-E	Lat Idn	Feet from the 990'	North/South line South	Feet from the 990'	East/West line East	¹¹ County Eddy

¹¹ Bottom Hole Location If Different From Surface									
UL or lot no.	Section	Township	Range	Lat Idn	Feet from the	North/South line	Feet from the	East/West line	¹² County
¹³ Dedicated Acres 40		¹⁴ Joint or Infill		¹⁵ Consolidation Code		¹⁶ Order No.			

NO ALLOWABLE WILL BE ASSIGNED TO THIS COMPLETION UNTIL ALL INTERESTS HAVE BEEN CONSOLIDATED
OR A NON-STANDARD UNIT HAS BEEN APPROVED BY THE DIVISION.

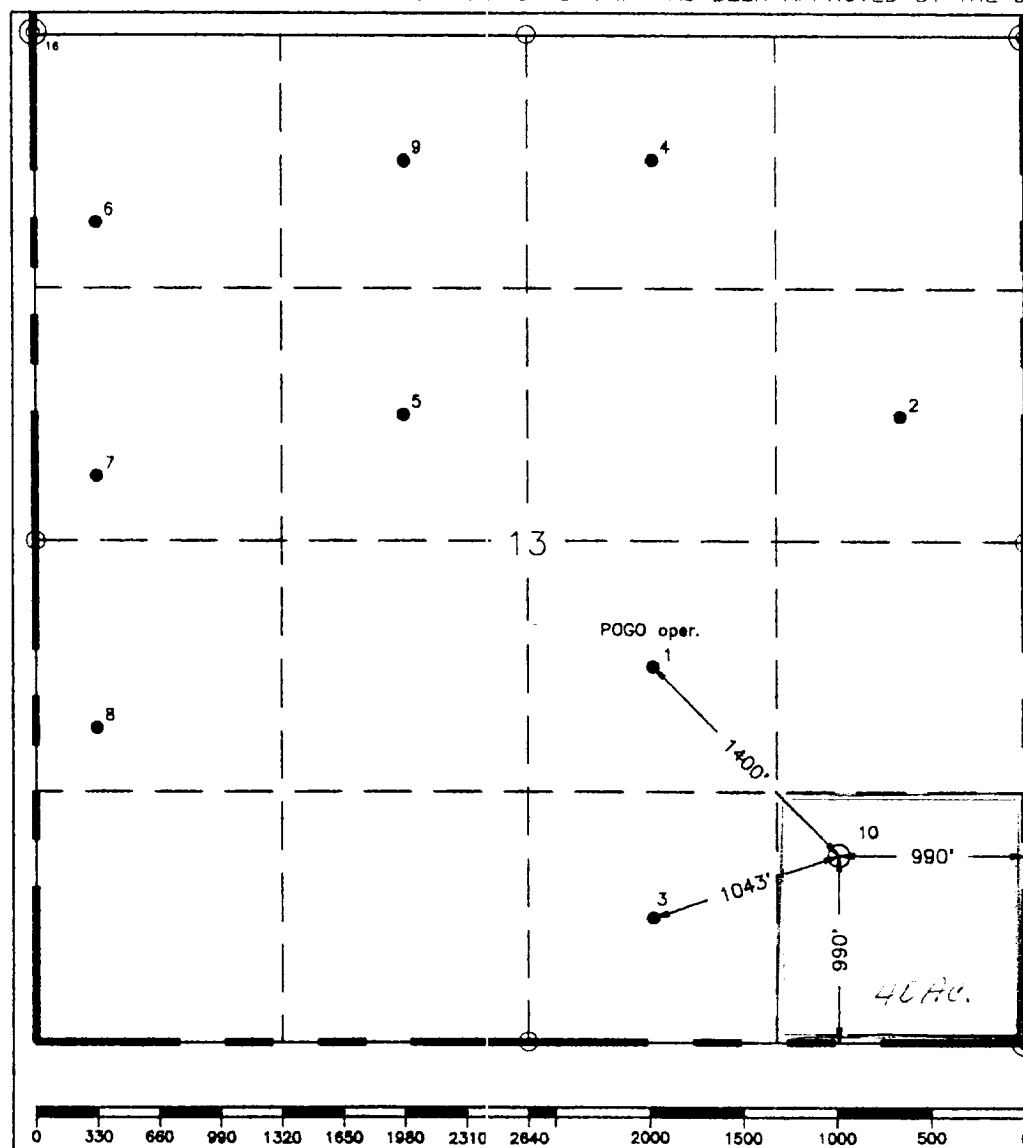

¹⁷ OPERATOR CERTIFICATION I hereby certify that the information contained herein is true and complete to the best of my knowledge and belief.	
Signature C. Wade Howard	
Printed Name C. Wade Howard	
Position Engineer's Assistant	
Company Texaco Expl. & Prod. Inc.	
Date September 11, 1995	
¹⁸ SURVEYOR CERTIFICATION I hereby certify that the well location shown on this plat was plotted from field notes of actual surveys made by me or under my supervision, and that the same is true and correct to the best of my knowledge and belief.	
Date Surveyed September 5, 1995	
Signature & Seal of Professional Surveyor John S. Piper	
Certificate No. 7254 John S. Piper	
Sheet 8 of 8	

○ = Staked Location ● = Producing Well ● = Injection Well ◇ = Water Supply Well ◆ = Plugged & Abandon Well

DRILLING CONTROL
CONDITION II-B 3000 WP
FOR AIR DRILLING OR
WHERE NITROGEN OR AIR BLOWS ARE EXPECTED

H₂S TRIM REQUIRED
 YES X NO

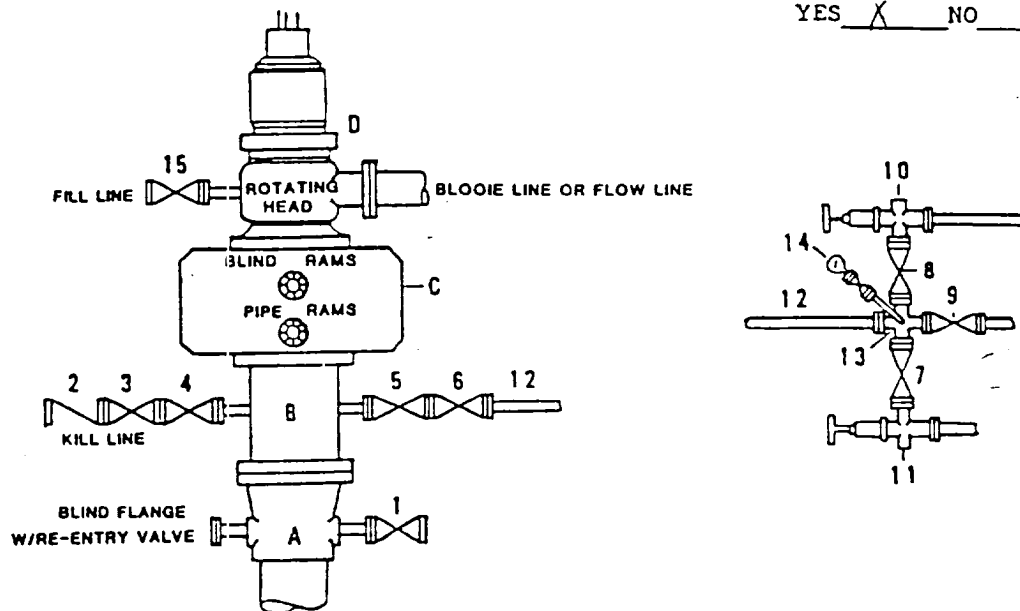

DRILLING CONTROL
MATERIAL LIST - CONDITION II - B

- | | |
|----------------|---|
| A | Texaco Wellhead |
| B | 3000# W.P. drilling spool with a 2" minimum flanged outlet for kill line and 3" minimum flanged outlet for choke line. |
| C | 3000# W.P. Dual ram type preventer, hydraulic operated with 1" steel, 3000# W.P. control lines (where sub-structure height is adequate, 2 - 3000# W.P. single ram type preventers may be utilized). |
| D | Rotating Head with fill up outlet and extended Bloopie Line. |
| 1,3,4,
7,8, | 2" minimum 3000# W.P. flanged full opening steel gate valve, or Halliburton Lo Torc Plug valve. |
| 2 | 2" minimum 3000# W.P. back pressure valve. |
| 5,6,9 | 3" minimum 3000# W.P. flanged full opening steel gate valve, or Halliburton Lo Torc Plug valve. |
| 12 | 3" minimum schedule 80, Grade "B", seamless line pipe. |
| 13 | 2" minimum x 3" minimum 3000# W.P. flanged cross. |
| 10,11 | 2" minimum 3000# W.P. adjustable choke bodies. |
| 14 | Cameron Mud Gauge or equivalent (location optional in choke line). |
| 15 | 2" minimum 3000# W.P. flanged or threaded full opening steel gate valve, or Halliburton Lo Torc Plug valve. |



TEXACO, INC.
 MIDLAND DIVISION
 MIDLAND, TEXAS



SCALE	DATE	EST NO	CRG NO
DRAWN BY			
CHECKED BY			
APPROVED BY			

EXHIBIT C