

DISTRICT I  
P. O. Box 1980  
Hobbs, NM 88241-1980

State of New Mexico  
Energy, Minerals, and Natural Resources Department

Form C-102  
Revised 02-10-94

Instructions on back

DISTRICT II  
P. O. Drawer DD  
Artesia, NM 88211-0719

OIL CONSERVATION DIVISION

P. O. Box 2088  
Santa Fe, New Mexico 87504-2088

Submit to the Appropriate  
District Office  
State Lease - 4 copies  
Fee Lease - 3 copies

DISTRICT III  
1000 Rio Brazos Rd.  
Aztec, NM 87410

☐ AMENDED REPORT

DISTRICT IV  
P. O. Box 2088  
Santa Fe, NM 87507-2088

WELL LOCATION AND ACREAGE DEDICATION PLAT

<sup>1</sup> API Number 30-015-28815	<sup>2</sup> Pool Code 33745	<sup>3</sup> Pool Name Ingle Wells (Delaware)
<sup>4</sup> Property Code	<sup>5</sup> Property Name TODD '36' M STATE	<sup>6</sup> Well Number 13
<sup>7</sup> OGRID No. 6137	<sup>8</sup> Operator Name DEVON ENERGY CORPORATION (NEVADA)	<sup>9</sup> Elevation 3494'

<sup>10</sup> SURFACE LOCATION

UL or lot no.	Section	Township	Range	Lot Ida	Feet from the	North/South line	Feet from the	East/West line	County
M	36	23 SOUTH	31 EAST, N.M.P.M.		1090'	SOUTH	330'	WEST	EDDY

"BOTTOM HOLE LOCATION IF DIFFERENT FROM SURFACE

UL or lot no.	Section	Township	Range	Lot Ida	Feet from the	North/South line	Feet from the	East/West line	County

<sup>12</sup> Dedicated Acres 40	<sup>13</sup> Joint or Infill	<sup>14</sup> Consolidation Code	<sup>15</sup> Order No.
-------------------------------------	-------------------------------	----------------------------------	-------------------------

NO ALLOWABLE WELL BE ASSIGNED TO THIS COMPLETION UNTIL ALL INTERESTS HAVE BEEN  
CONSOLIDATED OR A NON-STANDARD UNIT HAS BEEN APPROVED BY THE DIVISION

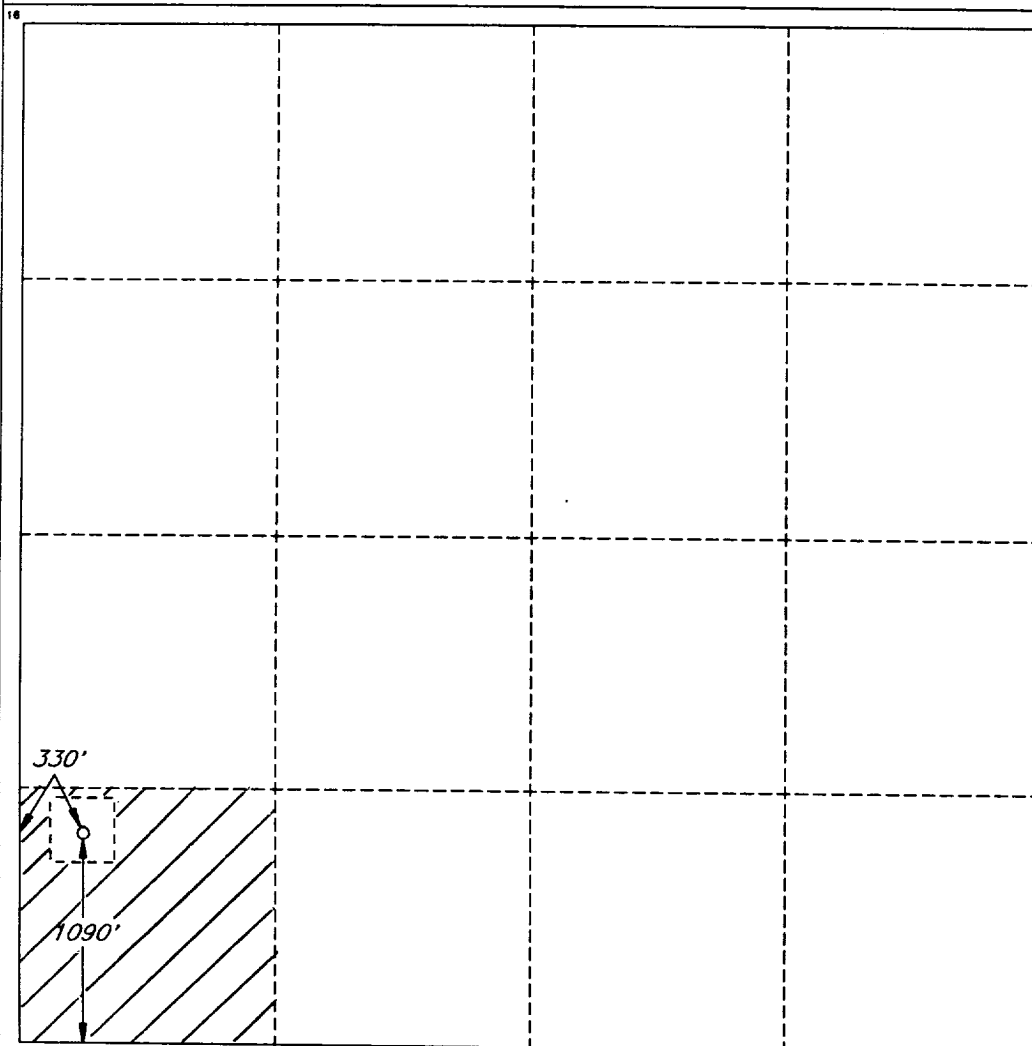

OPERATOR CERTIFICATION

I hereby certify that the information  
contained herein is true and complete  
to the best of my knowledge and belief.

Signature

Printed Name

Gerald T. Pepper

Title

District Engineer

Date

January 5, 1996

SURVEYOR CERTIFICATION

I hereby certify that the well  
location shown on this plat was  
plotted from field notes of actual  
surveys made by me or under  
my supervision, and that the  
same is true and correct to the  
best of my belief.

REVISED : 12-1-95 V.B.

Date of Survey

NOVEMBER 17, 1995

Signature and Seal of  
Professional Surveyor

STATE OF NEW MEXICO  
V. LYNN  
BEZNER  
NO 7920  
V. L. BEZNER  
7920  
JOB #42491-3 LAND SURVEY / V.H.B.