

DISTRICT I  
P. O. Box 1980  
Hobbs, NM 88241-1980

State of New Mexico  
Energy, Minerals, and Natural Resources Department

Form C-102  
Revised 02-10-94  
Instructions on back

DISTRICT II  
P. O. Drawer DD  
Artesia, NM 88211-0719

DISTRICT III  
1000 Rio Brazos Rd.  
Aztec, NM 87410

OIL CONSERVATION DIVISION  
P. O. Box 2088  
Santa Fe, New Mexico 87504-2088

Submit to the Appropriate  
District Office  
State Lease - 4 copies  
Fee Lease - 3 copies

☐ AMENDED REPORT

DISTRICT IV  
P. O. Box 2088  
Santa Fe, NM 87507-2088

WELL LOCATION AND ACREAGE DEDICATION PLAT

1 API Number <b>30-015-28927</b>		2 Pool Code <b>3067c</b>		3 Pool Name <del>Hernadula Bend; Delaware, East</del> <del>Calbra Bluff South Delaware</del>						
4 Property Code		5 Property Name <b>H. F. '12' FEDERAL</b>						6 Well Number <b>2</b>		
7 OGRID No.		8 Operator Name <b>SANTA FE ENERGY RESOURCES, INC.</b>						9 Elevation <b>3014'</b>		
10 SURFACE LOCATION										
UL or lot no. <b>G</b>	Section <b>12</b>	Township <b>23 SOUTH</b>	Range <b>28 EAST, N.M.P.M.</b>	Lot Ida	Feet from the <b>2030'</b>	North/South line <b>NORTH</b>	Feet from the <b>1980'</b>	East/West line <b>EAST</b>	County <b>EDDY</b>	
11 "BOTTOM HOLE LOCATION IF DIFFERENT FROM SURFACE										
UL or lot no.	Section	Township	Range	Lot Ida	Feet from the	North/South line	Feet from the	East/West line	County	
12 Dedicated Acres <b>40</b>		13 Joint or Infill		14 Consolidation Code						15 Order No.

NO ALLOWABLE WELL BE ASSIGNED TO THIS COMPLETION UNTIL ALL INTERESTS HAVE BEEN  
CONSOLIDATED OR A NON-STANDARD UNIT HAS BEEN APPROVED BY THE DIVISION

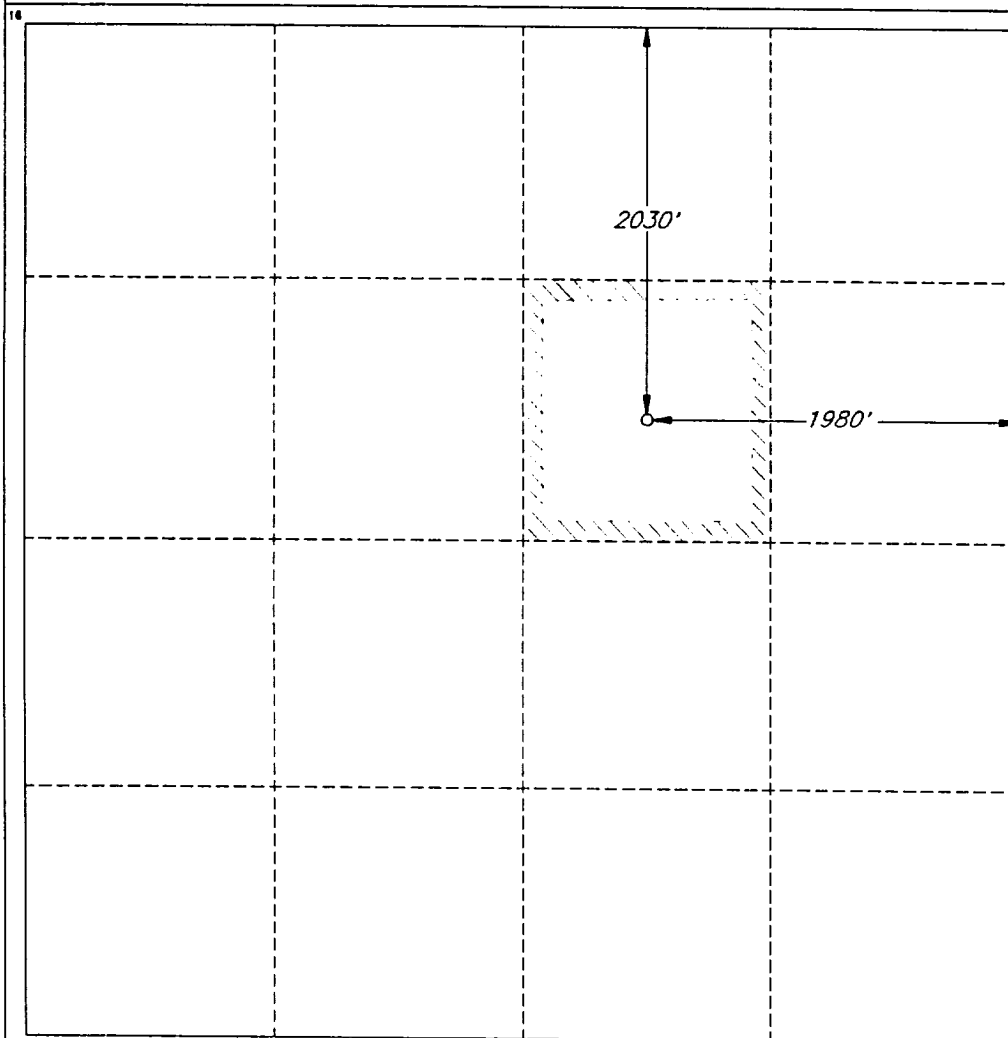

OPERATOR CERTIFICATION

I hereby certify that the information  
contained herein is true and complete  
to the best of my knowledge and belief.

Signature  
*James P. "Phil" Stinson*  
Printed Name  
**James P. "Phil" Stinson**  
Title  
**Agent for Santa Fe Energy**  
Date  
**2-6-96**

SURVEYOR CERTIFICATION

I hereby certify that the well  
location shown on this plat was  
plotted from field notes of actual  
surveys made by me or under  
my supervision, and that the  
same is true and correct to the  
best of my belief.

Date of Survey  
**JANUARY 23 1996**  
Signature and  
Professional Seal  
  
V. LYNN  
BEZNER  
NO 7920  
Certification No.  
**V. L. BEZNER R.P.S. #7920**  
JOB #43441-1 / 49 SE / JSJ