

DISTRICT I
P.O. Box 1980, Hobbs, NM 88240

State of New Mex.
Energy, Minerals and Natural Resources Department

Form C-102
Revised February 10, 1994
Instruction on back
Submit to Appropriate District Office
State Lease - 4 Copies
Fee Lease - 3 Copies

DISTRICT II
P.O. Drawer DD, Artesia, NM 88210

OIL CONSERVATION DIVISION

DISTRICT III
1000 Rio Brazos Rd., Aztec, NM 87410

P.O. Box 2088
Santa Fe, New Mexico 87504-2088

☒ AMENDED REPORT

WELL LOCATION AND ACREAGE DEDICATION PLAT

| | | |
|----------------------------|--|--|
| API Number 30-015-29714 | Pool Code 7-3960 | Undesignated Carlsbad Pool Name (Wolfcamp) East CARLSBAD-MORROW-SOUTH |
| Property Code | Property Name Indian Draw "13" | Well Number 1 |
| OGRID No. 147380 6137 | Operator Name Devon Energy Production Company, L.P. Penwell Energy Inc. | Elevation 3088' |

Surface Location

| UL or lot No. | Section | Township | Range | Lot Idn | Feet from the | North/South line | Feet from the | East/West line | County |
|---------------|---------|----------|-------|---------|---------------|------------------|---------------|----------------|--------|
| K | 13 | 22 S | 27 E | | 1980 | South | 1980 | West | Eddy |

Bottom Hole Location If Different From Surface

| UL or lot No. | Section | Township | Range | Lot Idn | Feet from the | North/South line | Feet from the | East/West line | County |
|---------------------------|-----------------|--------------------|-----------|---------|---------------|------------------|---------------|----------------|--------|
| | | | | | | | | | |
| Dedicated Acres 320 40 | Joint or Infill | Consolidation Code | Order No. | | | | | | |

NO ALLOWABLE WILL BE ASSIGNED TO THIS COMPLETION UNTIL ALL INTERESTS HAVE BEEN CONSOLIDATED
OR A NON-STANDARD UNIT HAS BEEN APPROVED BY THE DIVISION

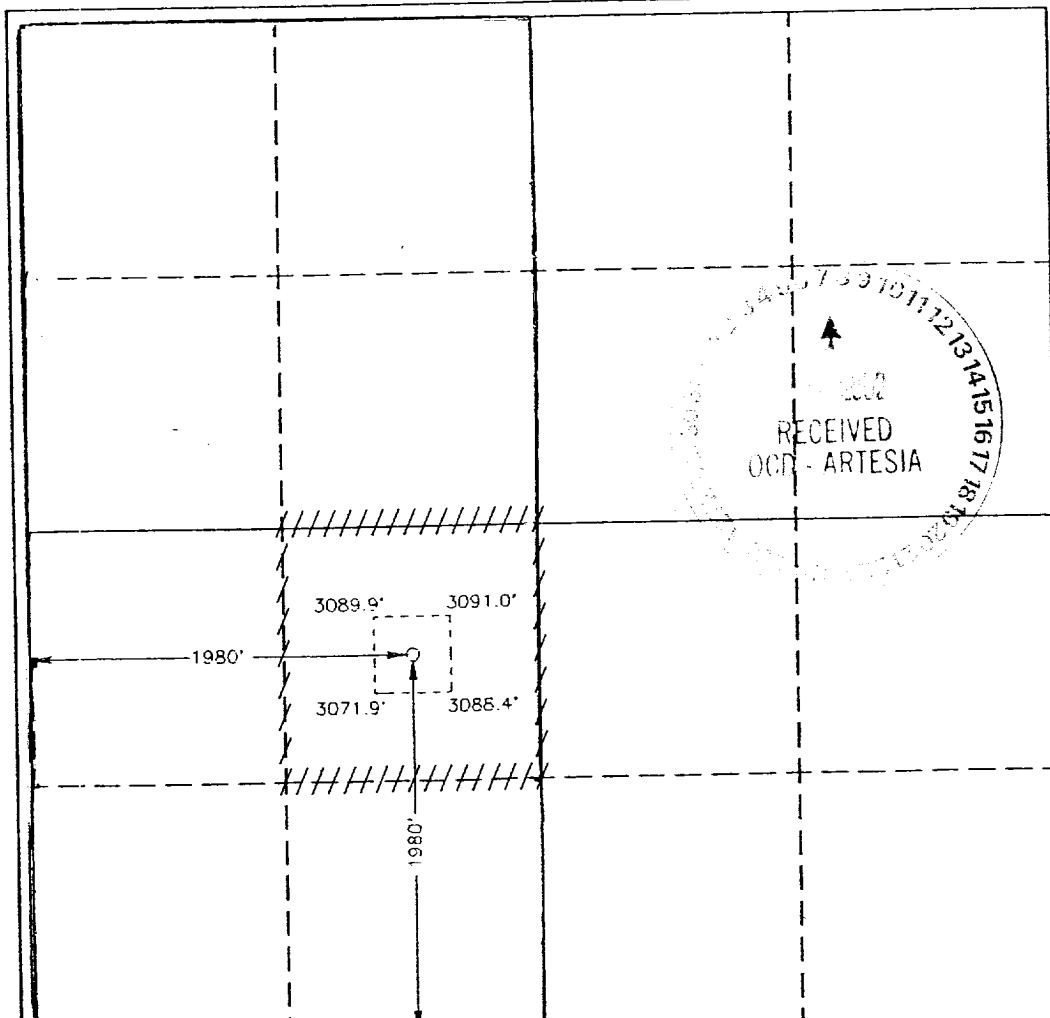

OPERATOR CERTIFICATION

I hereby certify the the information
contained herein is true and complete to the
best of my knowledge and belief.

Joe T. Janica
Signature

Joe T. Janica
Printed Name

Agent

Title
07/10/97

Date

SURVEYOR CERTIFICATION

I hereby certify that the well location shown
on this plat was plotted from field notes of
actual surveys made by me or under my
supervision and that the same is true and
correct to the best of my belief

January 2, 1997

Date Surveyed

Signature & Seal
Professional Surveyor

Joe T. Janica
Signature
W.O. No. 65598
Certificate No. 7977

BASIN SURVEYS

*amended proration unit 5/3/2002 Candi Graham, Engr. Tech. *Candi R. Graham*