

UNITED STATES
DEPARTMENT OF THE INTERIOR
BUREAU OF LAND MANAGEMENT

SUBMIT IN
(See other instructions on
reverse side)

Form approved. *C/SF*

APPLICATION FOR PERMIT TO DRILL OR DEEPEN

1a. TYPE OF WORK: DRILL ☒ DEEPEN ☐

b. TYPE OF WELL: OIL WELL ☒ GAS WELL ☐ Other ☐ SINGLE ZONE ☐ MULTIPLE ZONE ☐

2. NAME OF OPERATOR: DEVON ENERGY CORPORATION (NEVADA) *6137*

3. ADDRESS AND TELEPHONE NO.: 20 N. BROADWAY, SUITE 1500, OKC, OK 73102 (405) 235-3611

4. LOCATION OF WELL (Report location clearly and in accordance with any State requirements)*
At surface 660' FSL & 1980' FEL, Unit O, Section 14-T23S-R31E, Eddy Cnty, NM
At top proposed prod. zone (SAME)

5. LEASE DESIGNATION AND SERIAL NO.: NM-NM0404441

6. IF INDIAN, ALLOTTEE OR TRIBE NAME: N/A

7. UNIT AGREEMENT NAME: N/A

8. FARM OR LEASE NAME, WELL NO.: Todd "140" Federal #15 *29186*

9. API WELL NO.: 30-015- *32153*

10. FIELD AND POOL, OR WILDCAT: Ingle Wells (Delaware)

11. SEC., T., R., M., OR BLOCK AND SURVEY OR AREA: Unit O
Section 14-T23S-R31E

12. COUNTY OR PARISH: Eddy

13. STATE: New Mexico

14. DISTANCE IN MILES AND DIRECTION FROM NEAREST TOWN OR POST OFFICE*: 35 miles WNW of Jal, New Mexico

15. DISTANCE FROM PROPOSED LOCATION TO NEAREST PROPERTY OR LEASE LINE, FT.: 660'
(Also to nearest drg. unit line if any)

16. NO. OF ACRES IN LEASE: 1440

17. NO. OF ACRES ASSIGNED TO THIS WELL: 40

18. DISTANCE FROM PROPOSED LOCATION* TO NEAREST WELL, DRILLING, COMPLETED, OR APPLIED FOR, ON THIS LEASE, FT.: 1866'

19. PROPOSED DEPTH: 8800'

20. ROTARY OR CABLE TOOLS*: Rotary

21. ELEVATIONS (Show whether DF, RT, GR, etc.): GL 3472' *5 1/2"*
Circ. 8" casing per BLM - John Simitz

22. APPROX. DATE WORK WILL START*: third quarter, 1998

23. PROPOSED CASING AND CEMENTING PROGRAM				
SIZE OF HOLE	GRADE, SIZE OF CASING	WEIGHT PER FOOT	SETTING DEPTH	QUANTITY OF CEMENT
17 1/2"	13 3/8" H-40	48#	850'	500 sx 35/65 Poz + 200 sx Class "C"
11"	8 5/8" J-55	32#	4350'	1600 sx 35/65 Poz + 200 sx Class "C"
7 7/8"	5 1/2" J-55	15.5# & 17#	8800'	1st Stage 525 sx Silica Lite Class "H"
			DV Tool +/- 5500'	2nd Stage 225 sx 35/65 Poz + 400 sx Class "H"

Devon Energy proposes to drill to approximately 8800' to test the Delaware for commercial quantities of oil. If the Delaware is deemed non-commercial, the wellbore will be plugged and abandoned as per Federal regulations. Programs to adhere to onshore oil and gas regulations are outlined in the following exhibits and attachments.

Drilling Program, Surface Use and Operating Plan
Exhibits #1 = Blowout Prevention Equipment
Exhibit #2 = Location and Elevation Plat
Exhibits #3 = Road Map and Topo Map
Exhibit #4 = Wells Within 1 Mile Radius
Exhibits #5 = Production Facilities Plat
Exhibit #6 = Rotary Rig Layout
Exhibit #7 = Casing Design
H₂S Operating Plan
Archaeological Survey

The undersigned accepts all applicable terms, conditions, stipulations and restrictions concerning operations conducted on the leased land or portions thereof, as described below.

Lease #: NM-NM0404441

Legal Description: Section 14-T23S-R31E

Bond Coverage: Nationwide

BLM Bond #: CO-1104

IN ABOVE SPACE DESCRIBE PROPOSED PROGRAM: If proposal is to deepen, give data on present productive zone and proposed new productive zone. If proposal is to drill or deepen directionally, give pertinent data on subsurface locations and measured and true vertical depths. Give blowout preventer program, if any.

24.

SIGNED *Candace R. Graham* TITLE Engineering Technician DATE June 15, 1998

*(This space for Federal or State office use)

PERMIT NO. _____ APPROVAL DATE _____

Application approval does not warrant or certify that the applicant holds legal or equitable title to those rights in the subject lease which would entitle the applicant to conduct operations thereon.

CONDITIONS OF APPROVAL, IF ANY:

APPROVED BY *[Signature]* TITLE _____ DATE _____

See Instructions On Reverse Side

DRILLING PROGRAM

Attached to Form 3160-3
Devon Energy Corporation (Nevada)
TODD "140" FEDERAL #15
660' FSL & 1980' FEL
Section 14-T23S-R31E, Unit O
Eddy County, New Mexico

1. Geologic Name of Surface Formation

Permian

2. Estimated Tops of Important Geologic Markers

Rustler	800'
Top of Salt	1100'
Base of Salt	3900'
Bell Canyon	4400'
Cherry Canyon	5600'
Brushy Canyon	7000'
Bone Spring Lime	8300'
Total Depth	8800'

3. Estimated Depths of Possible Fresh Water-, Oil-, or Gas-Bearing Formations

Upper Permian Sands	above 800'	fresh water
Delaware (Bell Canyon)	4400'	oil
Delaware (Cherry Canyon)	6000'	oil
Delaware (Brushy Canyon)	8000'	oil

No other formations are expected to yield oil, gas or fresh water in measurable volumes. The surface fresh water sands will be protected by setting 13 3/8" casing at 850' and circulating cement back to surface. The Potash and Salt intervals will be protected by setting 8 5/8" casing at 4350' and circulating cement to surface. The Delaware intervals will be isolated by setting 5 1/2" casing to total depth and circulating cement above the base of the 8 5/8" casing.

before drilling out the 13 3/8" casing shoe (70% of 48# H-40 casing). Prior to drilling out the 8 5/8" casing shoe, the BOP's and Hydril will be function tested as per BLM drilling Operations Order #2.

Pipe rams will be operated and checked each 24 hour period and each time the drill pipe is out of the hole. These functional tests will be documented on the daily drillers log. A 2" kill line and 3" choke line will be incorporated in the drilling spool below the ram-type BOP. Other accessory BOP equipment will include a kelly cock, floor safety valve, choke lines and choke manifold having 3000 psi WP rating.

6. Types and Characteristics of the Proposed Mud System

The well will be drilled to total depth using brine, cut brine and polymer mud systems. Depths of systems are as follows.

Depth	Type	Weight (ppg)	Viscosity (1/sec)	Water Loss (cc/30 mins)
0-850'	Fresh water	8.8	34-36	No control
850-4350'	Brine water	10.0	28	No control
4350'-TD	Fresh water polymer	8.8	32-36	10-20

The necessary mud products for weight addition and fluid loss control will be on location at all times.

7. Auxiliary Well Control and Monitoring Equipment

- A. A kelly cock will be in the drill string at all times.
- B. A full opening drill pipe stabbing valve having the appropriate connections will be on the rig floor at all times.
- C. Hydrogen Sulfide detection equipment (Compliance Package) will be in operation when drilling out the 13 3/8" casing shoe until the 5 1/2" casing is cemented.

8. Logging, Testing and Coring Program

- A. Drill stem tests will be based on geological sample shows.
- B. The open hole wireline logging program will be as follows.

TD to intermediate casing: Induction / Gamma Ray / Neutron / Density Log.

TD to surface: Neutron with Gamma Ray.

- C. Rotary sidewall cores are planned.
- D. Additional testing will be initiated subsequent to setting the 5 1/2" production casing. Specific intervals will be targeted based on log evaluation, geological sample shows and drill stem tests.

9. Abnormal Pressures, Temperatures and Potential Hazards

No abnormal pressures or temperatures are foreseen. The anticipated bottom hole temperature at total depth is approximately 130 degrees and maximum bottom hole pressure is approximately 2900 psig. No hydrogen sulfide gas has been reported or is known to exist at these depths in this area. No major lost circulation intervals have been encountered in adjacent wells.

10. Anticipated Starting Date and Duration of Operations

A Cultural Resources Examination will be completed by Don Clifton Archaeological Consultant, and submitted to the BLM. Road and location preparation will not be undertaken until approval has been received from the BLM. If approved, the anticipated spud date for the well will be in the third quarter, 1998. The drilling operation should require approximately 21 days. If the well is deemed productive, completion operations will require, at minimum, an additional 30 days of testing to ascertain whether permanent production facilities will be constructed.

SURFACE USE AND OPERATING PLAN

Attachment to Form 3160-3
Devon Energy Corporation (Nevada)
TODD "140" FEDERAL #15
660' FSL & 1980' FEL
Section 14-T23S-R31E, Unit O
Eddy County, New Mexico

1. Existing Roads

- A. The well site and elevation plat for the proposed TODD "140" FEDERAL #15 are reflected on Exhibit #2. This well was staked by Topographic Land Surveyors of Midland, Texas.
- B. All roads into the location are depicted in Exhibit #3. New construction from the County road will be used to access the location. New construction will conform to the specifications outlined in item 2 below.
- C. Directions to location: Travel west-northwest from Jal, NM approximately 35 miles on State Highway #128 to County Road #798, just into Eddy County from Lea County. Turn north (right) on County Road #798 and travel approximately 3.2 miles. Then, turn left (west) onto existing lease road. Go approximately 0.25 mile to proposed TODD "140" FEDERAL #15 location.

2. Proposed Access Road

Access to this location will require the construction of approximately 1320' of new access road from the County road. All new road construction would adhere to the following specifications:

- A. The maximum width of the road will be fifteen (15) feet.
- B. It will be crowned and made of 6 inches of rolled and compacted caliche. Water will be deflected, as necessary, to avoid accumulation and prevent surface erosion.
- C. Surface material will be native caliche. This material will be obtained from a BLM approved pit nearest in proximity to the location.
- D. The average grade will be approximately 1%.

E. No cattle guards, grates or fence cuts will be required.

F. No turnouts are planned.

3. Location of Existing Wells

Exhibit #4 shows all existing wells within a one-mile radius of the proposed TODD "140" FEDERAL #15.

4. Location of Existing and/or Proposed Facilities

A. In the event the well is found productive, a tank battery would be constructed.

1. Exhibit #5 shows the battery facility to be utilized by the TODD "140" FEDERAL #15.
2. The tank battery, all connections and all lines will adhere to API standards.
3. The well will be operated by means of an electric prime mover. Electric power poles will be set along side of the access road.

B. If the well is productive, rehabilitation plans are as follows.

1. The reserve pit will be back-filled after the contents of the pit are dry (within 120 days after completion, weather permitting).
2. Caliche from unused portions of the drill pad will be removed. The original topsoil from the well site will be returned to the location. The drill site will then be contoured to the original natural state.

5. Location and Type of Water Supply

The TODD "140" FEDERAL #15 will be drilled using a combination of brine and fresh water mud systems (outlined in Drilling Program). The water will be obtained from commercial water stations in the area and hauled to location by transport truck using the existing and proposed roads shown in Exhibit #3. Additionally, produced salt water from lease gathering tanks may be utilized. No water well will be drilled on the location.

6. Source of Construction Materials

All caliche utilized for the drilling pad and proposed access road will be obtained from an existing BLM approved pit or from prevailing deposits found under the location. All roads will be constructed of 6" rolled and compacted caliche.

7. Methods of Handling Water Disposal

- A. Drill cuttings will be disposed into the reserve pit.
- B. Drilling fluids will be contained in steel mud tanks. The reserve pit will contain excess drilling fluid or fluid from the well during drilling, cementing and completion operations. The reserve pit will be an earthen pit roughly 125' x 125' x 6', or smaller, in size.
- C. The reserve pit will be fenced on three sides throughout drilling operations and will be totally isolated upon removal of the rotary rig. The pit will be lined using a 5-7 mil plastic to minimize loss of drilling fluids and saturation of the ground with brine water used to drill from 850' to 4350'.
- D. Water produced from the well during completion operations will be disposed into a steel tank or reserve pit, if volumes prove excessive. After placing the well on production through the production facilities, all water will be collected in tanks. Produced oil will be separated into steel stock tanks until sold.
- E. A portable chemical toilet will be available on the location for human waste during the drilling operations.
- F. Garbage, trash and waste paper produced during drilling operations will be collected in a contained trailer and disposed at an approved landfill. All waste

material will be contained to prevent scattering by the wind. All water, fluids, salt or other chemicals will be disposed into the reserve pit. No toxic waste or hazardous chemicals will be generated by this operation.

- G. All waste material will be removed within 30 days after the well is either completed or abandoned. The reserve pit will be completely fenced until it has dried. At the point the reserve pit is found sufficiently dry, it will be backfilled and reclaimed as per BLM specifications. Only the portion of the drilling pad used by the production equipment (pumping unit and tank battery) will remain in use. If the well is deemed non-commercial, only a dry hole marker will remain.

8. Ancillary Facilities

No campsite or other facilities will be constructed as a result of this well.

9. Well Site Layout

- A. The drill pad is shown on Exhibit #6. Approximate dimensions of the pad, pits and general location of the rig equipment are displayed. Top soil will be stored adjacent to the pad until reclamation efforts are undertaken. Only modest cuts will be necessary to build the pad which will be covered with 6" of compacted caliche.
- B. No permanent living facilities are planned, but temporary trailers for the tool pusher, drilling foreman and mud logger may be on location throughout drilling operations.
- C. The reserve pit will be lined using plastic sheeting of 5-7 mil thickness.

10. Plans for Restoration of Surface

- A. After concluding the drilling and/or completion operations, if the well is found non-commercial, the caliche will be removed from the pad and transported to the original caliche pit or used for other drilling locations. The road will be reclaimed as directed by the BLM. The reserve pit area will be broken out and leveled after drying to a condition where these efforts are feasible. The original top soil will again be returned to the pad and contoured, as close as possible, to the original topography.

- B. The pit lining will be buried or hauled away in order to return the location and road to their pristine nature. All pits will be filled and location leveled, weather permitting, within 120 days after abandonment.
- C. The location and road will be rehabilitated as recommended by the BLM.
- D. The reserve pit will be fenced on three sides throughout drilling operations. After the rotary rig is removed, the reserve pit will be fenced on the fourth side to preclude endangering wildlife. The fencing will be in place until the pit is reclaimed.
- E. If the well is deemed commercially productive, the reserve pit will be restored as described in 10 (A) within 120 days subsequent to the completion date. Caliche from areas of the pad site not required for operations will be reclaimed. The original top soil will be returned to the area of the drill pad not necessary to operate the well. These unused areas of the drill pad will be contoured, as close as possible, to match the original topography.

11. Surface Ownership

The well site is owned by the Bureau of Land Management.

Road routes have been approved and the surface location will be restored as directed by the BLM.

12. Other Information

- A. The area surrounding the well site is grassland. The top soil is very sandy in nature. The vegetation is moderately sparse with native prairie grass, sagebrush, yucca and miscellaneous weeds.
- B. There is no permanent or live water in the general proximity of the location.
- C. A Cultural Resources Examination will be completed by Don Clifton Archaeological Consultant, and forwarded to the BLM office in Carlsbad, New Mexico.

13. Lessee's and Operator's Representative

The Devon Energy Corporation (Nevada) representatives responsible for ensuring compliance of the surface use plan are:

Walter Frank
District Engineer

Daryl Lowder
Superintendent

DEVON ENERGY CORPORATION
20 North Broadway, Suite 1500
Oklahoma City, OK 73102

DEVON ENERGY CORPORATION
Post Office Box 250
Artesia, NM 88211-0250

(405) 552-4595 (office)
(405) 364-3504 (home)

(505) 748-3371 (office)
(505) 677-2103 (home)

Certification

I hereby certify that I, or persons under my direct supervision, have inspected the proposed drill site and access road; that I am familiar with the conditions that presently exist; that the statements made in this plan are, to the best of my knowledge, true and correct; and that the work associated with the operations proposed herein will be performed by Devon Energy Corporation (Nevada) and its contractors and subcontractors in conformity with this plan and the terms and conditions under which it is approved.

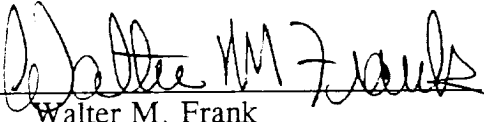
Signed:  Date: 6/2/03
Walter M. Frank
District Engineer

MINIMUM BLOWOUT PREVENTER REQUIREMENTS

3,000 psi Working Pressure

3 MWP

EXHIBIT # 1

STACK REQUIREMENTS

No.	Item	Min. I.D.	Min. Nominal
1	Flowline		
2	Fill up line		2"
3	Drilling nipple		
4	Annular preventer		
5	Two single or one dual hydraulically operated rams		
6a	Drilling spool with 2" min. kill line and 3" min choke line outlets		
6b	2" min. kill line and 3" min. choke line outlets in ram. (Alternate to 6a above.)		
7	Valve Gate <input type="checkbox"/> Plug <input type="checkbox"/>	3-1/8"	
8	Gate valve—power operated	3-1/8"	
9	Line to choke manifold		3"
10	Valves Gate <input type="checkbox"/> Plug <input type="checkbox"/>	2-1/16"	
11	Check valve	2-1/16"	
12	Casing head		
13	Valve Gate <input type="checkbox"/> Plug <input type="checkbox"/>	1-13/16"	
14	Pressure gauge with needle valve		
15	Kill line to rig mud pump manifold		2"

OPTIONAL			
16	Flanged valve	1-13/16"	

CONFIGURATION A

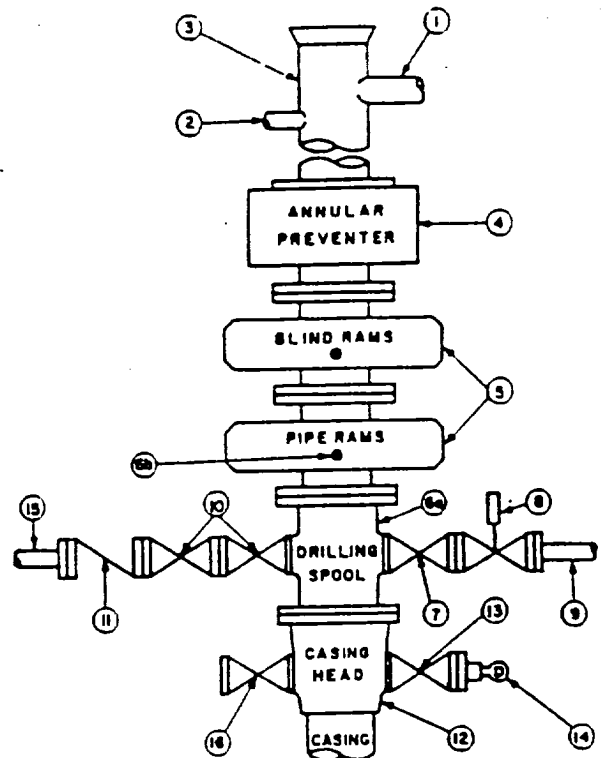

CONTRACTOR'S OPTION TO FURNISH:

1. All equipment and connections above bradenhead or casinghead. Working pressure of preventers to be 3,000 psi, minimum.
2. Automatic accumulator (80 gallon, minimum) capable of closing BOP in 30 seconds or less and, holding them closed against full rated working pressure.
3. BOP controls, to be located near drillers position.
4. Kelly equipped with Kelly cock.
5. Inside blowout preventer or its equivalent on derrick floor at all times with proper threads to fit pipe being used.
6. Kelly saver-sub equipped with rubber casing protector at all times.
7. Plug type blowout preventer tester.
8. Extra set pipe rams to fit drill pipe in use on location at all times.
9. Type RX ring gaskets in place of Type R.

MEC TO FURNISH:

1. Bradenhead or casinghead and side valves.
2. Wear bushing, if required.

GENERAL NOTES:

1. Deviations from this drawing may be made only with the express permission of MEC's Drilling Manager.
2. All connections, valves, fittings, piping, etc., subject to well or pump pressure must be flanged (suitable clamp connections acceptable) and have minimum working pressure equal to rated working pressure of preventers up through choke. Valves must be full opening and suitable for high pressure mud service.
3. Controls to be of standard design and each marked, showing opening and closing position.
4. Chokes will be positioned so as not to hamper or delay changing of choke beans. Replaceable parts for adjustable choke, other bean sizes, retainers, and choke wrenches to be conveniently located for immediate use.
5. All valves to be equipped with handwheels or handles ready for immediate use.
6. Choke lines must be suitably anchored.

7. Handwheels and extensions to be connected and ready for use.
8. Valves adjacent to drilling spool to be kept open. Use outside valves except for emergency.
9. All seamless steel control piping (3000 psi working pressure) to have flexible joints to avoid stress. Hoses will be permitted.
10. Casinghead connections shall not be used except in case of emergency.
11. Do not use kill line for routine fill-up operations.

MINIMUM CHOKE MANIFOLD
3,000, 5,000 and 10,000 PSI Working Pressure

EXHIBIT # 1

3 MWP - 5 MWP - 10 MWP

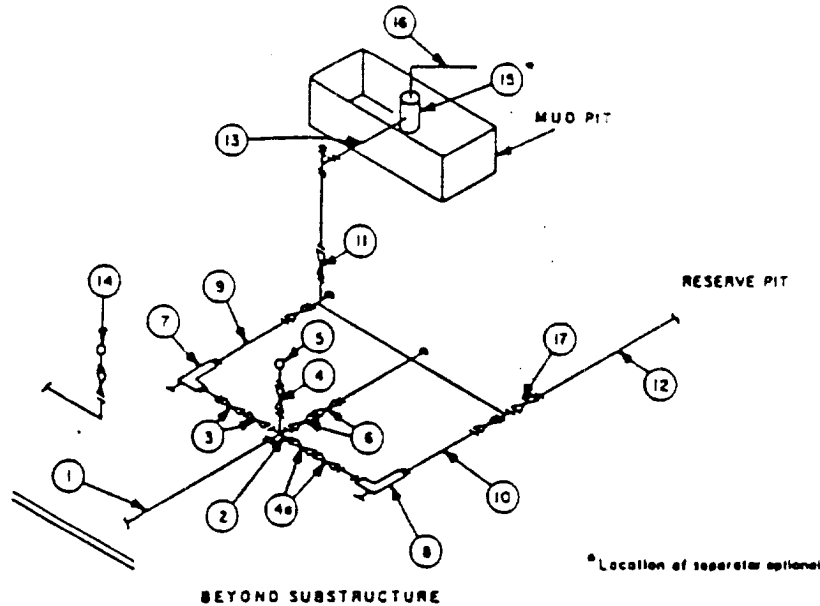

MINIMUM REQUIREMENTS										
No		3,000 MWP			5,000 MWP			10,000 MWP		
		I.D.	NOMINAL	RATING	I.D.	NOMINAL	RATING	I.D.	NOMINAL	RATING
1	Line from drilling spool		3"	3,000		3"	5,000		3"	10,000
2	Cross 3"x3"x3"x2"			3,000			5,000			
	Cross 3"x3"x3"x3"									10,000
3	Valves (1) Gate <input type="checkbox"/> Plug <input type="checkbox"/> (2)	3-1/8"		3,000	3-1/8"		5,000	3-1/8"		10,000
4	Valve Gate <input type="checkbox"/> Plug <input type="checkbox"/> (2)	1-13/16"		3,000	1-13/16"		5,000	1-13/16"		10,000
4a	Valves (1)	2-1/16"		3,000	2-1/16"		5,000	3-1/8"		10,000
5	Pressure Gauge			3,000			5,000			10,000
6	Valves Gate <input type="checkbox"/> Plug <input type="checkbox"/> (2)	3-1/8"		3,000	3-1/8"		5,000	3-1/8"		10,000
7	Adjustable Choke (3)	2"		3,000	2"		5,000	2"		10,000
8	Adjustable Choke	1"		3,000	1"		5,000	2"		10,000
9	Line		3"	3,000		3"	5,000		3"	10,000
10	Line		2"	3,000		2"	5,000		3"	10,000
11	Valves Gate <input type="checkbox"/> Plug <input type="checkbox"/> (2)	3-1/8"		3,000	3-1/8"		5,000	3-1/8"		10,000
12	Lines		3"	1,000		3"	1,000		3"	2,000
13	Lines		3"	1,000		3"	1,000		3"	2,000
14	Remote reading compound standpipe pressure gauge			3,000			5,000			10,000
15	Gas Separator		2'x5'			2'x5'			2'x5'	
16	Line		4"	1,000		4"	1,000		4"	2,000
17	Valves Gate <input type="checkbox"/> Plug <input type="checkbox"/> (2)	3-1/8"		3,000	3-1/8"		5,000	3-1/8"		10,000

(1) Only one required in Class 3M.

(2) Gate valves only shall be used for Class 10M.

(3) Remote operated hydraulic choke required on 5,000 psi and 10,000 psi for drilling.

EQUIPMENT SPECIFICATIONS AND INSTALLATION INSTRUCTIONS

- All connections in choke manifold shall be welded, studded, flanged or Cameron clamp of comparable rating.
- All flanges shall be API 6B or 6BX and ring gaskets shall be API RX or BX. Use only BX for 10 MWP.
- All lines shall be securely anchored.
- Chokes shall be equipped with tungsten carbide seats and needles, and replacements shall be available.
- Choke manifold pressure and standpipe pressure gauges shall be available at the choke manifold to assist in regulating chokes. As an alternate with automatic chokes, a choke manifold pressure gauge shall be located on the rig floor in conjunction with the standpipe pressure gauge.
- Line from drilling spool to choke manifold should be as straight as possible. Lines downstream from chokes shall make turns by large bends or 90° bends using bull plugged tees.
- Discharge lines from chokes, choke bypass and from top of gas separator should vent as far as practical from the well.

Exhibit #1A
NOTES REGARDING BLOWOUT PREVENTERS
Devon Energy Corporation (Nevada)
TODD "140" FEDERAL #15
660' FSL & 1980' FEL
Section 14-T23S-R31E, Unit O
Eddy County, New Mexico

1. Drilling nipple will be constructed so it can be removed mechanically without the aid of a welder. The minimum internal diameter will equal BOP bore.
2. Wear ring will be properly installed in head.
3. Blowout preventer and all associated fittings will be in operable condition to withstand a minimum 3000 psi working pressure.
4. All fittings will be flanged.
5. A full bore safety valve tested to a minimum 3000 psi WP with proper thread connections will be available on the rotary rig floor at all times.
6. All choke lines will be anchored to prevent movement.
7. All BOP equipment will be equal to or larger in bore than the internal diameter of the last casing string.
8. Will maintain a kelly cock attached to the kelly.
9. Hand wheels and wrenches will be properly installed and tested for safe operation.
10. Hydraulic floor control for blowout preventer will be located as near in proximity to driller's controls as possible.
11. All BOP equipment will meet API standards and include a minimum 40 gallon accumulator having two independent means of power to initiate closing operation.

4. Casing Program

Hole Size	Interval	Casing OD	Weight	Grade	Type
30"	0-40'	20"		Conductor	0.30" wall
17 1/2"	0-850'	13 3/8"	48#	H-40	ST&C, new R-3
11"	0-4350'	8 5/8"	32#	J-55	ST&C, new R-3
7 7/8"	0'-TD (8800'±)	5 1/2"	15.5# & 17#	J-55	LT&C, new R-3

Cementing Program

20" Conductor Casing	Cement with Ready-mix to surface.
13 3/8" Surface Casing	Cement to surface using 500 sx Poz (35% Poz, 65% Class C, 6% gel) with 2% CaCl ₂ and 1/4 lb/sx Cellophane flakes + 200 sx Class C with 2% CaCl ₂ and 1/4 lb/sx Cellophane flakes.
8 5/8" Intermediate Casing	Cement to surface using 1600 sx Poz (35% Poz, 65% Class C, 6% gel, 15% salt) with 1/4 lb/sx Cellophane flakes + 200 sx Class C with 2% CaCl ₂ , 1/4 lb/sx Cellophane flakes
5 1/2" Production Casing	Cement 1st stage with 525 sx Silica Lite (Class H) with 3% salt, 0.6% FL additive, 1/4 lb/sx Cellophane flakes
with DV tool at ±5500'	Cement 2nd stage with 225 sx Poz (35% Poz, 65% Class H, 6% gel) with 1/4 lb/sx Cellophane flakes + 400 sx Class H with 4% gel, 5% salt, 1/4 lb/sx Cellophane flakes.

The above cement volumes could be revised pending the caliper measurement from the open hole logs. The top of cement is designed to reach ±50'± above the 8 5/8" casing seat at 4350'.

5. Minimum Specifications for Pressure Control

The blowout preventer equipment (BOP) shown in Exhibit #1 will consist of a (3M system) double ram type (2000 psi WP) preventer and a bag-type (Hydril) preventer (2000 psi WP). Both units will be hydraulically operated and the ram type preventer will be equipped with blind rams on top and 4 1/2" drill pipe rams on bottom. Both BOP's will be installed on the 13 3/8" surface casing and utilized continuously until total depth is reached. All BOP's and associated equipment will be tested to 1200 psi

DISTRICT I
P. O. Box 1980
Hobbs, NM 88241-1980

State of New Mexico
Energy, Minerals, and Natural Resources Department

Form C-102
Revised 02-10-94

Instructions on back

DISTRICT II
P. O. Drawer DD
Artesia, NM 88211-0719

Submit to the Appropriate
District Office
State Lease - 4 copies
Fee Lease - 3 copies

DISTRICT III
1000 Rio Brazos Rd.
Aztec, NM 87410

OIL CONSERVATION DIVISION
P. O. Box 2088
Santa Fe, New Mexico 87504-2088

☐ AMENDED REPORT

DISTRICT IV
P. O. Box 2088
Santa Fe, NM 87507-2088

WELL LOCATION AND ACREAGE DEDICATION PLAT

1 API Number		2 Pool Code 33745		3 Pool Name Ingle Wells (Delaware)					
4 Property Code		5 Property Name TODD 14 0 FEDERAL						6 Well Number 15	
7 OGRID No. 6137		8 Operator Name DEVON ENERGY CORPORATION (NEVADA)						9 Elevation 3472'	
10 SURFACE LOCATION									
UL or lot n.o. 0	Section 14	Township 23 SOUTH	Range 31 EAST, N.M.P.M.	Lot Ida	Feet from the 660'	North/South line SOUTH	Feet from the 1980'	East/West line EAST	County EDDY
11 BOTTOM HOLE LOCATION IF DIFFERENT FROM SURFACE									
UL or lot n.o.	Section	Township	Range	Lot Ida	Feet from the	North/South line	Feet from the	East/West line	County
12 Dedicated Acres 40		13 Joint or Infill		14 Consolidation Code		15 Order No.			

NO ALLOWABLE WELL BE ASSIGNED TO THIS COMPLETION UNTIL ALL INTERESTS HAVE BEEN CONSOLIDATED OR A NON-STANDARD UNIT HAS BEEN APPROVED BY THE DIVISION

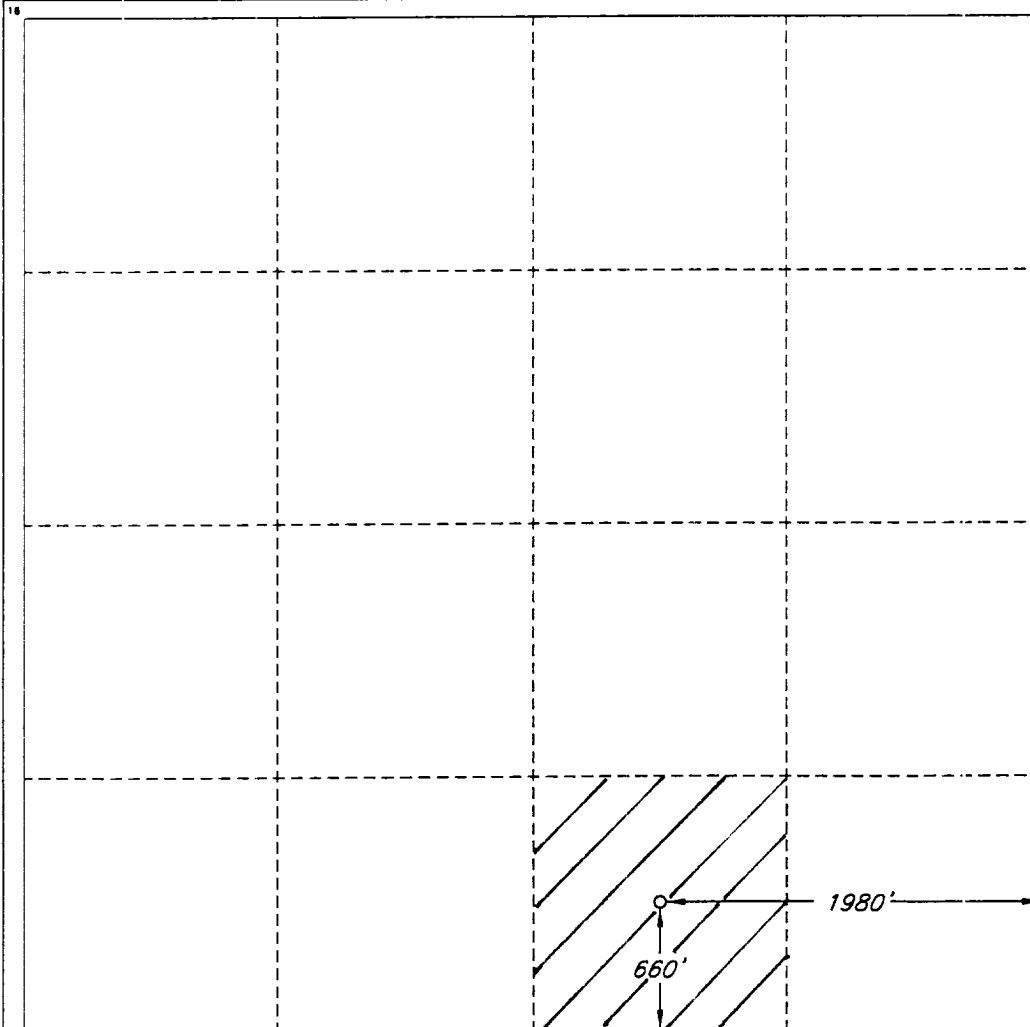

OPERATOR CERTIFICATION

I hereby certify that the information contained herein is true and complete to the best of my knowledge and belief.

Signature

Candace R. Graham

Printed Name

Candace R. Graham

Title

Engineering Technician

Date

SURVEYOR CERTIFICATION

I hereby certify that the well location shown on this plat was plotted from field notes of actual surveys made by me or under my supervision, and that the same is true and correct to the best of my belief.

Date of Survey: 11/11/98

Signature and Seal

ROGER M. ROBBINS
REGISTERED PROFESSIONAL SURVEYOR
12128

Certification No. ROGER M. ROBBINS P.S. #12128

JOB # 58450 / 47 SW / JSJ



LOS MEDANOS & BOOTLEG RIDGE

NAME	LOCATION	ELEVATION	LAT.	LONG.
TODD 14 I #9	1980' FSL & 660' FEL	3479'	N 32°18'09.0"	W 103°44'30.1"
TODD 14 J #10	1980' FSL & 1980' FEL	3491'	N 32°18'09.0"	W 103°44'45.5"
TODD 14 K #11	2086' FSL & 2086' FWL	3493'	N 32°18'10.1"	W 103°44'59.6"
TODD 14 L #12	1980' FSL & 660' FWL	3488'	N 32°18'09.1"	W 103°45'16.2"
TODD 14 M #13	660' FSL & 660' FWL	3485'	N 32°17'56.0"	W 103°45'16.2"
TODD 14 N #14	660' FSL & 1980' FWL	3493'	N 32°17'56.0"	W 103°45'00.8"
TODD 14 O #15	660' FSL & 1980' FEL	3472'	N 32°17'56.0"	W 103°44'45.5"

Review this plot and notify us immediately of any possible discrepancy.

Surveying & Mapping for the Oil & Gas Industry

2903 N. BIG SPRING
MIDLAND, TX. 79705

R 31 E

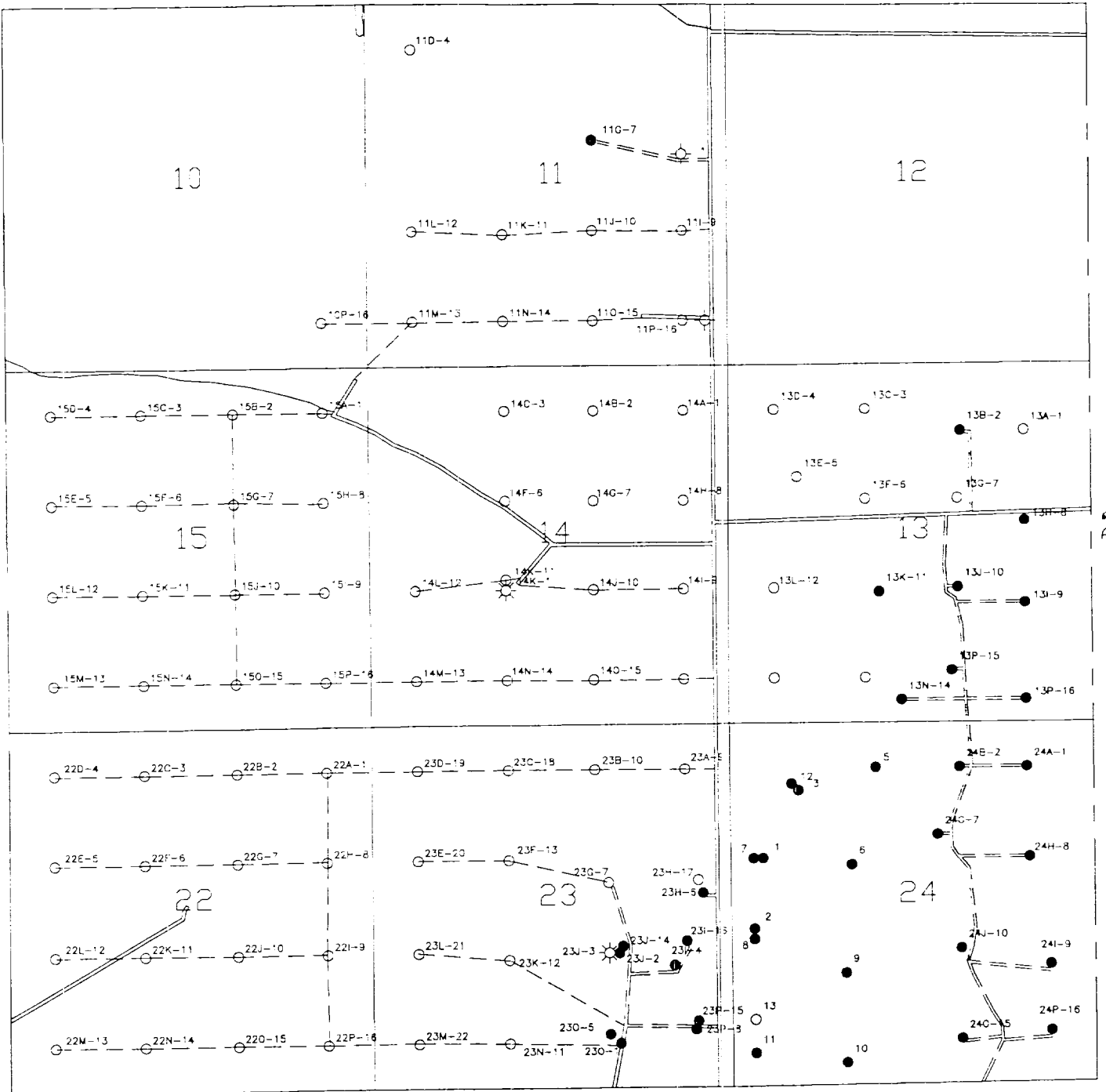

T
23
S



File: 140-15

devon
ENERGY CORPORATION

INGLE WELLS FIELD
EDDY COUNTY, NEW MEXICO

TODD-140 FED-15
EXHIBIT 3

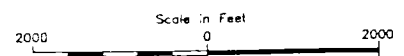

6/98

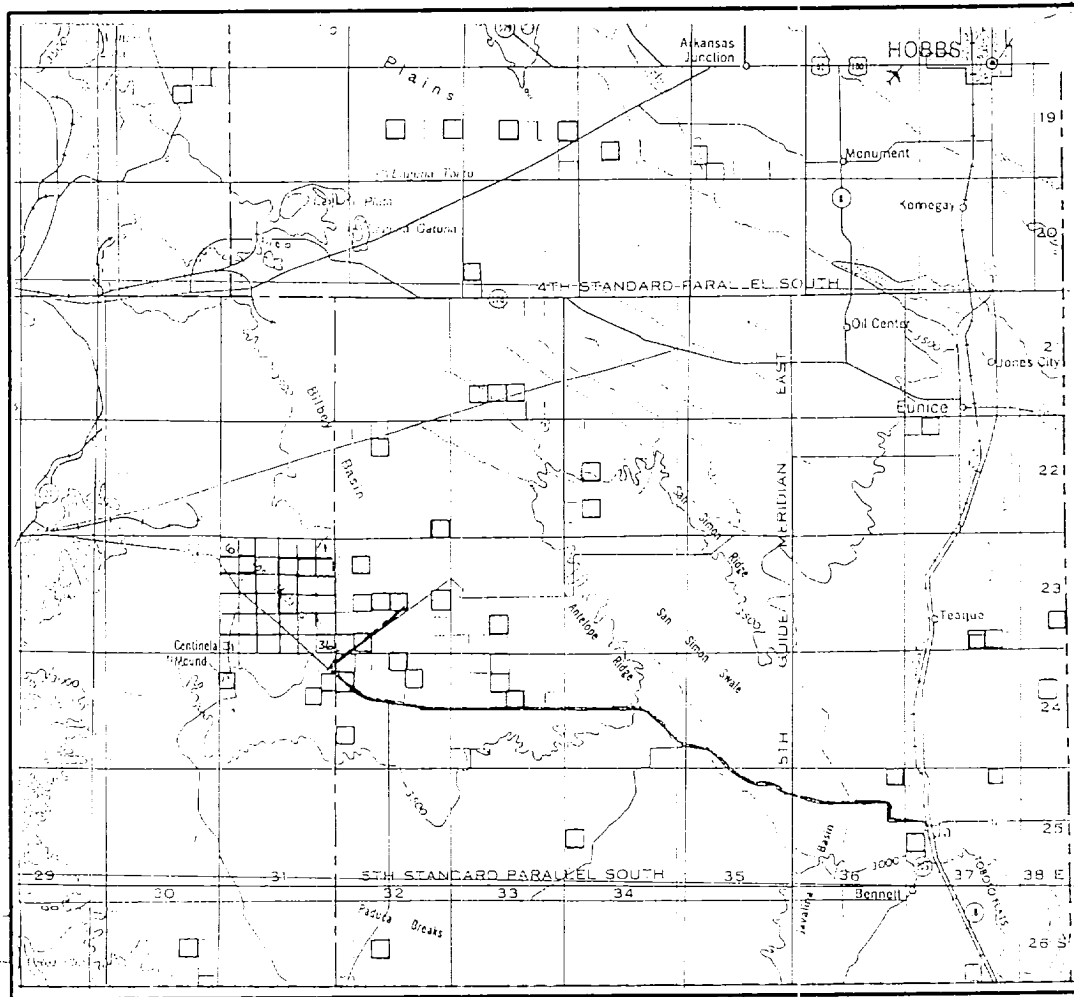
SECTION 10, 11, 13, 14, 15, 22, & 23 TWP 23-S RGE 31-ESURVEY NEW MEXICO PRINCIPAL MERIDIANCOUNTY EDDY STATE NMOPERATOR DEVON ENERGY CORPORATIONLEASE TODD & BARCLAYDISTANCE & DIRECTION FROM THE JCT. OF S.H. 128 &CO. RD. 798, 34.0 MILES WEST OF JAL, GO NORTH 2.1MILES ON CO. RD. 798 TO THE SOUTHEAST CORNER OFSECTION 23

This location has been very carefully staked on the ground according to the best official survey records, maps, and other data available to us.

Review this plot and notify us immediately of any possible discrepancy.

TOPOGRAPHIC LAND SURVEYORS

Surveying & Mapping for the Oil & Gas Industry

1307 N. HOBART
PAMPA, TX. 79065
(800) 658-6382

6709 N. CLASSEN BLVD.
OKLAHOMA CITY, OK. 73116
(800) 654-3219

2903 N. BIG SPRING
MIDLAND, TX. 79705
(800) 767-1653

PLAT SHOWING PROPOSED
WELL LOCATION IN
SECTION 14, T-23-S, R-31-E, N.M.P.M.
EDDY COUNTY, NEW MEXICO

EXHIBIT # 3

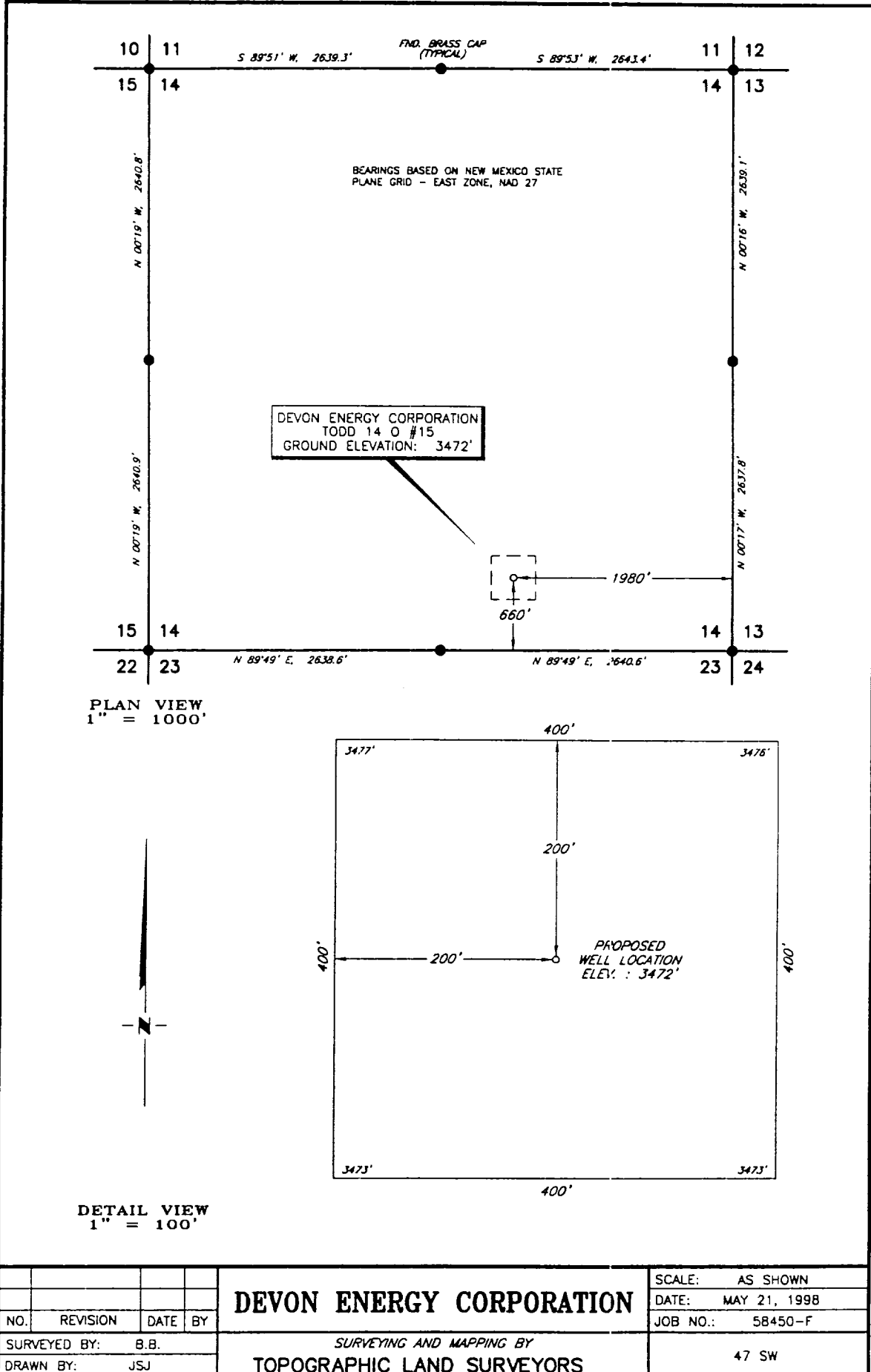

R 31 E

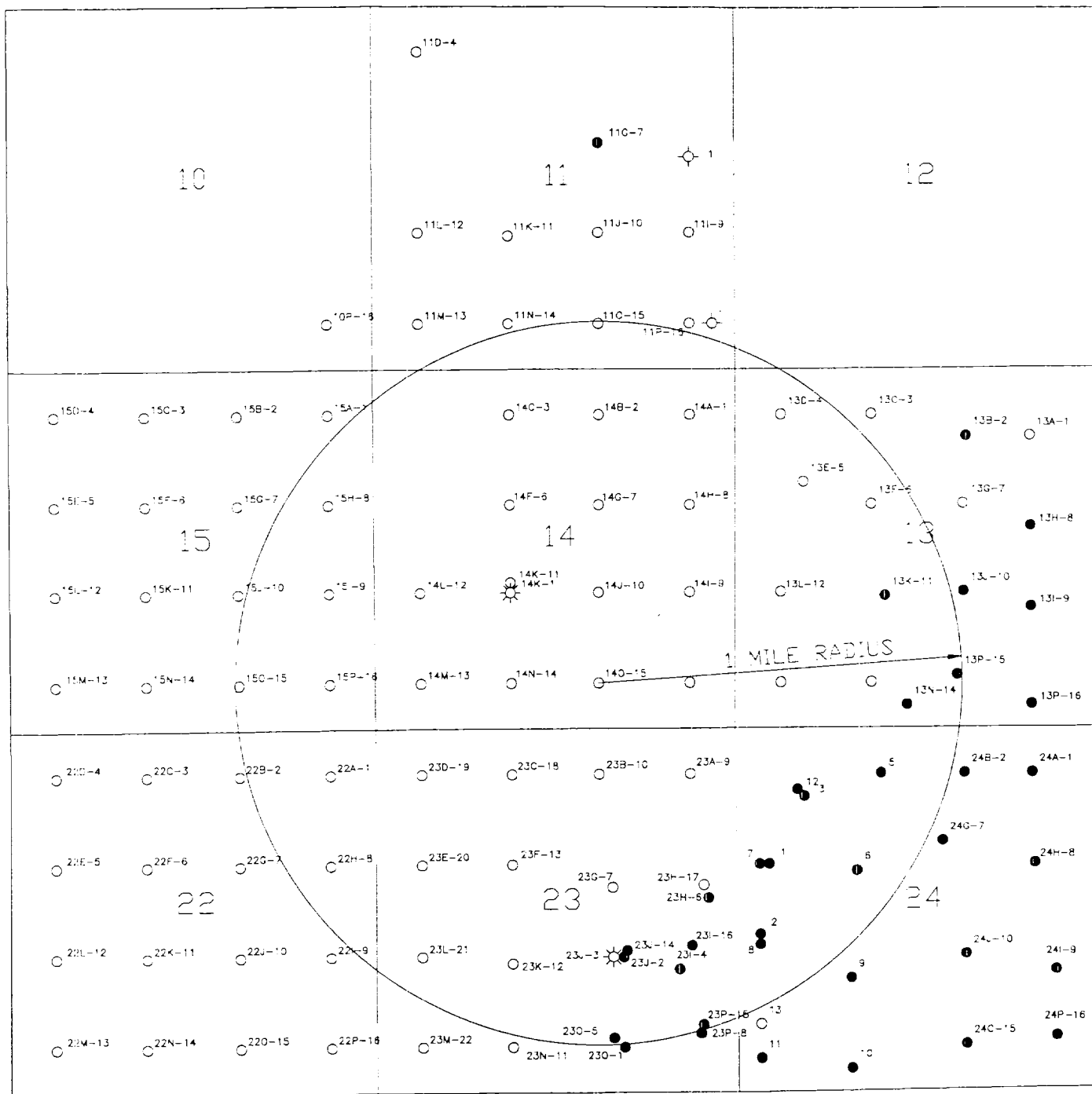

T
23
S



File: 14C-15

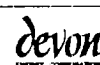

INGLE WELLS FIELD

EDDY COUNTY, NEW MEXICO

WELLS WITHIN 1 MILE RADIUS
TODD-140 FED-15
EXHIBIT 4

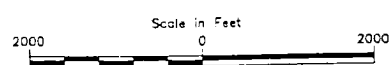

6/98

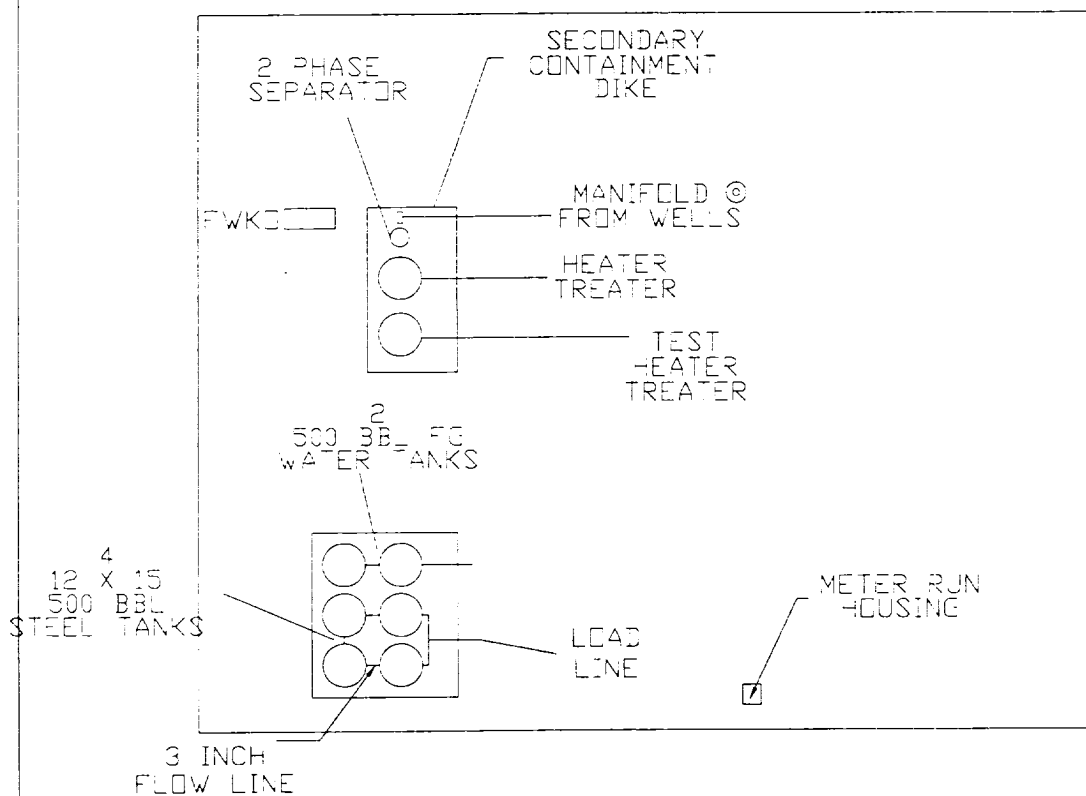

INGLE WELLS FIELD EDDY COUNTY, NEW MEXICO	
PRODUCTION FACILITIES LAYOUT AT TODD-14K FED-1 FOR TODD-140 FED-15	
EXHIBIT 5	
Scale in Feet 25 0 25 50 75 100	
6/98	

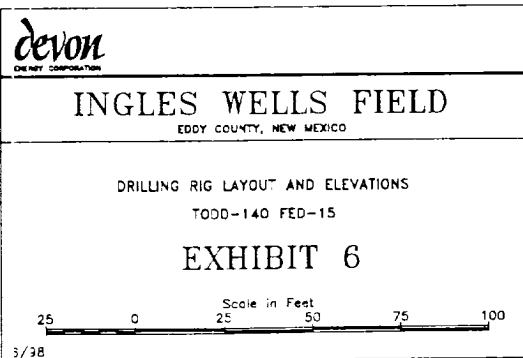

DEVON ENERGY

Operator: DEVON ENERGY CORP	Well Name: TODD FEDERAL AREA
Project ID:	Location: T23S-R31E

Design Parameters:

Mud weight (9.00 ppg) : 0.468 psi/ft
 Shut in surface pressure : 765 psi
 Internal gradient (burst) : 0.100 psi/ft
 Annular gradient (burst) : 0.000 psi/ft
 Tensile load is determined using air weight
 Service rating is "Sweet"

Design Factors:

Collapse : 1.125
 Burst : 1.00
 8 Round : 1.80 (J)
 Buttress : 1.60 (J)
 Body Yield : 1.50 (B)
 Overpull : 0 lbs.

Length (feet)	Size (in.)	Weight (lb/ft)	Grade	Joint	Depth (feet)	Drift (in.)	Cost		
1	850	13-3/8	48.00	H-40	ST&C	850	12.559		
	Collapse Load (psi)	Strgth (psi)	S.F.	Burst Load (psi)	Min Int Strgth (psi)	Yield S.F.	Tension Load (kips)	Strgth (kips)	S.F.
1	397	740	1.864	850	1730	2.04	40.80	322	7.89 J

Prepared by : CHUCK HORSMAN, Oklahoma City, OK

Date : 06-04-1993

Remarks :

Minimum segment length for the 850 foot well is 800 feet.

Surface string:

Next string will set at 4,400 ft. with 10.00 ppg mud (pore pressure of 2,286 psi.) The frac gradient of 1.000 at the casing seat results in an injection pressure of 850 psi. Effective BHP (for burst) is 850 psi.

NOTE: The design factors used in this casing string design are as shown above. As a general guideline, Lone Star Steel recommends using minimum design factors of 1.125 - Collapse (with evacuated casing), 1.0 - Burst, 1.8 - 8 Round Tension, 1.6 - Buttress Tension, and 1.5 - Body Yield. Collapse strength under axial tension was calculated based on the Westcott, Dunlop and Kessler curve. Engineering responsibility for use of this design will be that of the purchaser. Costs for this design are based on a 1990 pricing model. (Version 1.0G)

DEVON ENERGY

Operator: DEVON ENERGY CORP	Well Name: TODD FEDERAL AREA
Project ID:	Location: T23S-R31E

Design Parameters:

Mud weight (9.80 ppg) : 0.509 psi/ft
 Shot in surface pressure : 3487 psi
 Internal gradient (burst) : 0.100 psi/ft
 Annular gradient (burst) : 0.000 psi/ft
 Tensile load is determined using air weight
 Service rating is "Sweet"

Design Factors:

Collapse : 1.125
 Burst : 1.00
 S Round : 1.80 (J)
 Buttress : 9.89 (J)
 Body Yield : 1.50 (S)
 Overpull : 0 lbs.

Length (feet)	Size (in.)	Weight (lb/ft)	Grade	Joint	Depth (feet)	Drift (in.)	Cost		
1	4,400	8-5/8"	32.00	J-55	ST&C	4,400	7.875		
	Collapse			Burst Load (psi)	Min Int Yield Strgth (psi)	Tension			
	Load (psi)	Strgth (psi)	S.F.			Load (kips)	Strgth (kips)	S.F.	
1	2240	2530	1.129	3527	3930	1.11	140.80	372	2.64 J

Prepared by : CHUCK HORSMAN, Oklahoma City, OK

Date : 06-04-1993

Remarks :

Minimum segment length for the 4,400 foot well is 800 feet.

Surface/Intermediate string:

Next string will set at 8,400 ft. with 9.00 ppg mud (pore pressure of 3,927 psi.) The frac gradient of 1.000 at the casing seat results in an injection pressure of 4,400 psi. Effective BHP (for burst) is 3,527 psi.

NOTE: The design factors used in this casing string design are as shown above. As a general guideline, Lone Star Steel recommends using minimum design factors of 1.125 - Collapse (with evacuated casing), 1.0 - Burst, 1.8 - S Round Tension, 1.6 - Buttress Tension, and 1.5 - Body Yield. Collapse strength under axial tension was calculated based on the Westcott, Dunlop and Kessler curve. Engineering responsibility for use of this design will be that of the purchaser. Costs for this design are based on a 1990 pricing model. (Version 1.0G)

DEVON ENERGY

Operator: DEVON ENERGY CORP	Well Name: TODD FEDERAL AREA
Project ID:	Location: T23S-R31E

Design Parameters:

Mud weight (9.00 ppg) : 0.468 psi/ft
 Shut in surface pressure : 3216 psi
 Internal gradient (burst) : 0.120 psi/ft
 Annular gradient (burst) : 0.000 psi/ft
 Tensile load is determined using air weight
 Service rating is "Sweet"

Design Factors:

Collapse : 1.125
 Burst : 1.00
 8 Round : 1.80 (J)
 Buttress : 9.89 (J)
 Body Yield : 1.30 (B)
 Overpull : 0 lbs.

*** WARNING *** Design factor for joint strength exceeded in design!

	Length (feet)	Size (in.)	Weight (lb/ft)	Grade	Joint	Depth (feet)	Drift (in.)	Cost
1	1,200	5-1/2"	17.00	J-55	LT&C	1,200	4.767	
2	6,200	5-1/2"	15.50	J-55	LT&C	7,400	4.825	
3	1,350	5-1/2"	17.00	J-55	LT&C	8,750	4.767	

	Load (psi)	Collapse Strgth (psi)	S.F.	Burst Load (psi)	Min Int Strgth (psi)	Yield S.F.	Load (kips)	Tension Strgth (kips)	S.F.
1	561	3897	6.947	3336	5320	1.59	139.45	247	1.77 J
2	3460	3927	1.135	3956	4810	1.22	119.05	217	1.82 J
3	4091	4910	1.200	4091	5320	1.30	22.95	247	10.76 J

Prepared by : TOM PEPPER, Oklahoma City, OK

Date : 07-10-1995

Remarks :

Minimum segment length for the 8,750 foot well is 500 feet.

The mud gradient and bottom hole pressures (for burst) are 0.468 psi/ft and 4.091 psi, respectively.

NOTE: The design factors used in this casing string design are as shown above. As a general guideline, Lone Star Steel recommends using minimum design factors of 1.125 - Collapse (with evacuated casing), 1.0 - Burst, 1.8 - 8 Round Tension, 1.6 - Buttress Tension, and 1.5 - Body Yield. Collapse strength under axial tension was calculated based on the Westcott, Dunlop and Keeler curve. Engineering responsibility for use of this design will be that of the purchaser. Costs for this design are based on a 1990 pricing model. (Version 1.0G)

DEVON ENERGY CORPORATION

HYDROGEN SULFIDE DRILLING OPERATIONS PLAN

A. Hydrogen Sulfide Training

All rig crews and company personnel will receive training from a qualified instructor in the following areas prior to penetrating any hydrogen sulfide bearing formations during drilling operations:

1. The hazards and characteristics of hydrogen sulfide (H₂S).
2. The proper use and maintenance of the H₂S safety equipment and of personal protective equipment to be utilized at the location such as H₂S detection monitors, alarms and warning systems, and breathing equipment. Briefing areas and evacuation procedures will also be discussed and established.
3. Proper rescue techniques and procedures will be discussed and established.

In addition to the above, supervisory personnel will be trained in the prevention of oil and gas well blowouts in accordance with Minerals Management Service Standards Subpart - 0 - 250 - 212.

Prior to penetrating any known H₂S bearing formation, H₂S training will be required at the rig sight for all rig crews and company personnel that have not previously received such training. This instruction will be provided by a qualified instructor with each individual being required to pass a 20 question test regarding H₂S safety procedures. All contract personnel employed on an unscheduled basis will be required to have received appropriate H₂S training.

This Hydrogen Sulfide Drilling And Operations Plan shall be available at the wellsite during drilling operations.

B. H₂S Safety Equipment And Systems

All H₂S safety equipment and systems will be installed, tested, and operational when drilling operations reach a depth approximately 500' above any known or probable H₂S bearing formation. The safety systems to be utilized during drilling operations are as follows:

1. Well Control Equipment

- (a) Double ram BOP with a properly sized closing unit and pipe rams to accommodate all pipe sizes in use.
- (b) A choke manifold with a minimum of one remote choke.

2. H2S Detection And Monitoring Equipment

- (a) Three (3) H2S detection monitors will be placed in service at the location. One monitor will be placed near the bell nipple on the rig floor; one will be placed at the rig substructure; and, one will be at the working mud pits or shale shaker. This monitoring system will have warning lights and audible alarms that will alert personnel when H2S levels reach 10 ppm.
- (b) One (1) Sensidyne Pump with the appropriate detection tubes will also be available to perform spot checks for H2S concentrations in any remote or isolated areas.

3. Protective Equipment For Essential Personnel

Protective equipment will consist of the following:

- (a) Four (4) - five minute escape packs located at strategic points around the rig.
- (b) Two (2) - thirty minute rescue packs to be located at the designated briefing areas.

4. Visual Warning System

Visual warning system will consist of the following:

- (a) Two wind direction indicators.
- (b) One condition / warning sign which will be posted on the road providing direct access to the location. The sign will contain lettering of sufficient size to be readable at a reasonable distance from the immediate location. The sign will inform the public that a hydrogen sulfide gas environment could be encountered at the location.

5. Mud Program

The mud program has been designed to minimize the volume of H₂S circulated to surface. Proper mud weight and safe drilling practices (for example, keeping the hole filled during trips) will minimize hazards when drilling in H₂S bearing formations.

6. Metallurgy

All drill strings, casings, tubing, wellhead, blowout preventers, drilling spools, kill lines, choke manifold and lines and valves shall be suitable for H₂S service.

7. Communication

Cellular telephone communication will be available in company vehicles.

C. Diagram of Drilling Location

Attached is a diagram representing a typical location layout as well as the location of H₂S monitors, briefing areas and wind direction indicators.

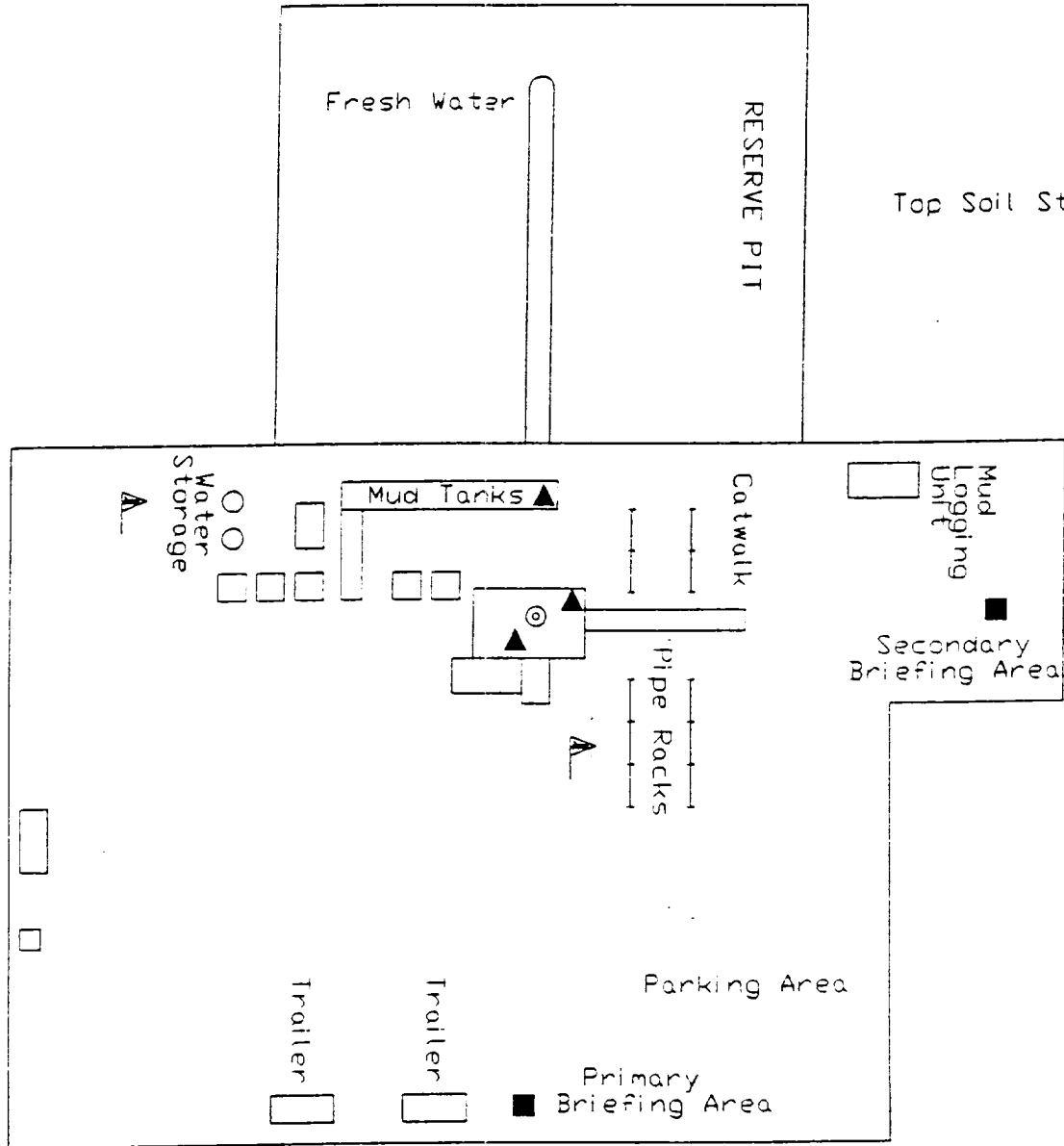

- ▲ H2S MONITORS WITH ALARMS AT THE BELL NIPPLE, SUBSTRUCTURE, AND SHALE SHAKER
- A WIND DIRECTION INDICATORS
- SAFE BRIEFING AREAS WITH CAUTION SIGNS AND PROTECTIVE BREATHING EQUIPMENT

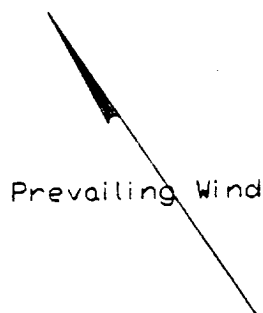

devon

EDDY COUNTY, NEW MEXICO

H2S PLAN

Scale in Feet

25 0 25 50 75 100

4/97

DEVON
ENERGY
CORPORATION

1500 Mid-America Tower
20 North Broadway
Oklahoma City, Oklahoma 73102-8260

405/235-3611
TWX 910-831-3277

May 5, 1989

State of New Mexico
Oil & Gas Conservation Commission
State Capitol Building
Santa Fe, NM 87504

Re: Blanket Plugging Bond
State of New Mexico
No. 56-0130-11003-87

Gentlemen:

Devon Energy Corporation formerly Devon Corporation has changed its name to Devon Energy Corporation (Nevada). In this regard, enclosed is a Rider for the referenced bond to include both company names. Please amend your records.

Very truly yours,



Charlene Newkirk
Lease Records Supervisor

encls

cc: Carolyn Wilson
McEldowney McWilliams

R I D E R

To be attached to and become a part of Bond No. 56-0130-11003-87-1
issued by the United States Fidelity and Guaranty Company, on
behalf of Devon Energy Corporation
as Principal, and in favor of State of New Mexico
as Obligee, in the penalty of Fifty thousand and no/100 - - - - -
Dollars (\$ 50,000.00) for Blanket plugging bond

It is hereby understood and agreed that effective on the
February 10, 1989 the Principal in this
bond shall be Devon Energy Corporation (Nevada)

However, the liability of the Surety in the aggregate to the
Obligee for any and all defaults of the Principal, whether occurring
before or after or partly before and partly after this rider
become effective, shall in no event exceed the penalty stated
in the bond.

Signed, Sealed, and Dated this 3rd day of March 1989.

ATTEST:

Devin Armstrong
Asst. Secretary

Devon Energy Corporation (Nevada)

Marvin C. Lund
By: MARVIN C. LUNDE, JR.
Vice President

UNITED STATES FIDELITY AND GUARANTY COMPANY

By:

Marcia C. Brejda

Attorney-in-fact

TITLE PAGE/ABSTRACT/NEGATIVE SITE REPORT

ROSWELL DISTRICT

1. BLM Report No.	2. (ACCEPTED) (REJECTED)	3. NMCRIS No. 60928
4. Title of Report (Project Title) An Archaeological Survey of 25 Proposed Well Locations, Eddy County, New Mexico.		5. Project Date(s) 05/18/98-0522/98 6. Report Date 05/23/98
7. Consultant Name & Address: Direct Charge: Don Clifton Name: Don Clifton, Archaeological Consultant Address: P. O. Box 30, Pep, N.M. 88126 Authors Name: Don Clifton Field personnel names: Don Clifton Phone (505) 675-2360		8. Permit No. 83-2920-96-K 9. Consultant Report No. 249
10. Sponsor Name and Address: Indiv. Responsible : Wally Frank Name: Devon Energy Corporation Address: 20 N Broadway, Suite 1500, Oklahoma City, Ok 73102 Phone (405) 552-4595		11. For BLM's Use
12. ACREAGE: Total No. acres surveyed: 92.5 SURFACE OWNERSHIP: Federal: 92.5 State: Private:		
13. Location: (Maps attached if negative survey) a. State New Mexico b. County Eddy c. BLM District: Roswell d. Nearest City or town: Carlsbad e. Area: T23S R 31E Sec. 13, 14, 22, 23 f. Well Pad Footages: <div style="display: flex; justify-content: space-between;"> <div style="width: 48%;"> <p>Todd 13L#12= 1980'fsl/660'fwl, Sec. 13</p> <p>Todd 14I#9= 1980'fsl/660'fel, Sec. 14</p> <p>Todd 14J#10= 1980'fsl/1980'fel, Sec. 14</p> <p>Todd 14K#11= 1980'fsl/1980'fwl, Sec. 14</p> <p>Todd 14L#12= 1980'fsl/660'fwl, Sec. 14</p> <p>Todd 14M#13= 660'fsl/660'fwl, Sec. 14</p> <p>Todd 14N#14= 660'fsl/1980'fwl, Sec. 14</p> <p>Todd 14O#15= 660'fsl/1980'fel, Sec. 14</p> <p>Todd 22A#1= 660'fsl/660'fel, Sec. 22</p> <p>Todd 22B#2= 660'fsl/1980'fel, Sec. 22</p> <p>Todd 22C#3= 660'fsl/1980'fwl, Sec. 22</p> <p>Todd 22F#6= 1980'fsl/1980'fwl, Sec. 22</p> <p>Todd 22G#7= 1980'fsl/1980'fel, Sec. 22</p> </div> <div style="width: 48%;"> <p>Todd 22H#8=1980'fsl/660'fel, Sec.22</p> <p>Todd 22I#9= 1980'fsl/660'fel, Sec. 22</p> <p>Todd 22J#10= 1980'fsl/1980'fel, Sec. 22</p> <p>Todd 22K#11= 1980'fsl/1980'fwl, Sec. 22</p> <p>Todd 22N#14= 660'fsl/1980'fwl, Sec. 22</p> <p>Todd 22O#15= 660'fsl/1980'fel, Sec.22</p> <p>Todd 22P#16= 660'fsl/660'fel, Sec. 22</p> <p>Todd 23C#18= 660'fsl/1980'fwl, Sec. 23</p> <p>Todd 23D#19= 660'fsl/660'fwl, Sec. 23</p> <p>Todd 23E#20= 1980'fsl/660'fwl, Sec. 23</p> <p>Todd 23L#21= 1980'fsl/660'fwl, Sec. 23</p> <p>Todd 23M#22= 660'fsl/660'fwl, Sec. 23</p> </div> </div>		

g. Area Surveyed: Block: Impact 400' x 400' x 400'
Surveyed 400' x 400' for each well location
Linear: Impact x
Surveyed x

Map Sources: Los Medanos, N.M. 1985 32103 C-7 Bootleg Ridge, N.M. 1984 32103 C-6

14. a. Records Search:

Location: BLM and ARMS

Date: May 18, 1998

List by LA# all sites within .25 miles of the project:

(Those sites within 500' are to be shown on project map)

LA7183

b. Description of Undertaking: Devon Energy Corporation proposes to develop 25 well locations. Access roads and other facilities will be staked in the future.

c. Environmental Setting (NRCS soil designation, vegetative community; etc.) The project is located on an undulating plain. Soils are sandy with few blowouts present. Vegetation is a grasslands with shinoak, mesquite, yucca, and mixed grasses.

d. Field Methods

Transect intervals: 15m

Crew Size: two

Time in field: Three days

Collections: None

15. Cultural Resource Findings:

a. Identification and description: Seven isolated occurrences were found and recorded.

IO#1- Three golfball-sized pieces of burned caliche in a 12m x 6m blowout at UTM Zone 13, 616540E, 3572880N on Todd 22J#10 well location.

IO#2- Three fist-sized pieces of burned caliche in a 14m x 12m blowout at UTM Zone 13, 616520E, 3572860N, on Todd 22J#10 well location.

IO#3- Lateral portion red chert flake, no use, no cortex; 5 fist-sized fragments of a sandstone burned bifacial basin metate; 4 pieces golfball-sized burned caliche; in 16m x 11m blowout at UTM Zone 13, 616560E, 3572840 adjacent to the east side of Todd 22J#10 well location.

IO#4- Complete grey coarse grey chert flake, no use, 50% cortex, 4.1cm at UTM Zone 13, 616280E, 3574020N on Todd 14M#13 well location.

IO#5- One marble-sized pieces of burned caliche at UTM Zone 13, 617260E, 3573700N on Todd 23D#19 well location.

IO#6- Two pieces of golfball-sized burned caliche in small blowout at UTM Zone 13, 617260E, 3572460N on Todd 23M#22 well location.

IO#7- One marble-sized piece of burned caliche at UTM Zone 13, 618780E, 3574480N on Todd 13L#12 well location.

16. Management Summary (Recommendations):

No Historic Properties were discovered during the archaeological survey.

I certify that the information provided above are correct and accurate and meets all appreciable BLM standards.

Responsible Archaeologist: Signature

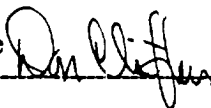

Date

May 23, 1998

[illegible]

BOOTLEG RIDGE, N. MEX.

8W/4 HAT MEBA 15' QUADRANGLE

32103-C6-TF-024

1984

SCALE 1:24 000

1 MILE

