

NEW MEXICO OIL CONSERVATION COMMISSION
Santa Fe, New Mexico

Form C-101
Revised (12/1/55)

NOTICE OF INTENTION TO DRILL

JAN 29 1958

Notice must be given to the District Office of the Oil Conservation Commission and approval obtained before drilling or recompletion begins. If changes in the proposed plan are considered advisable, a copy of this notice showing such changes will be returned to the sender. Submit this notice in QUINTUPLICATE. One copy will be returned following approval. See additional instructions in Rules and Regulations of the Commission. If State Land submit 6 Copies Attach Form C- 128 in triplicate to first 3 copies of form C-101

Midland, Texas

January 27, 1958

(Place)

(Date)

OIL CONSERVATION COMMISSION
SANTA FE, NEW MEXICO

Gentlemen:

You are hereby notified that it is our intention to commence the Drilling of a well to be known as

El Paso Natural Gas Company

(Company or Operator)

Welch Unit

(Lease)

Well No. 3, in M The well is

located 330 feet from the South line and 990 feet from the

West

line of Section 16, T. 26 S, R. 27 E, NMPM.

(GIVE LOCATION FROM SECTION LINE) Pool, Eddy County

If State Land the Oil and Gas Lease is No. E-1719-4

If patented land the owner is

Address

We propose to drill well with drilling equipment as follows: Rotary

The status of plugging bond is Active

Drilling Contractor Jennings Drilling Company

Hobbs, New Mexico

We intend to complete this well in the Delaware

formation at an approximate depth of 2110 feet.

CASING PROGRAM

We propose to use the following strings of Casing and to cement them as indicated:

Size of Hole	Size of Casing	Weight per Foot	New or Second Hand	Depth	Sacks Cement
11"	8-5/8	24#	New	215'	Circulate
7-7/8"	5-1/2	14#	New	Total Depth	200 sx

If changes in the above plans become advisable we will notify you immediately.

ADDITIONAL INFORMATION (If recompletion give full details of proposed plan of work.)

JAN 29 1958

Approved, 19
Except as follows:

OIL CONSERVATION COMMISSION

By M. L. Armstrong

Sincerely yours,

El Paso Natural Gas Company

(Company or Operator)

By Lloyd E. Baskin
Drilling and Production Superintendent

Position

Name

Address 2006 Wilco Building, Midland, Texas

NEW MEXICO OIL CONSERVATION COMMISSION
Well Location and Acreage Dedication Plat

Form G-128
Revised 5/1/57
JAN 29 1958

Section A.

Date JAN. 27, 1958

Operator El Paso Natural Gas Company Lease Welch Unit
Well No. 3 Unit Letter Section 16 Township 26-S Range 27-E NMPM
Located 990 Feet From WEST Line, 330 Feet From SOUTH Line
County EDDY G. L. Elevation 3230 Dedicated Acreage 40 Acres
Name of Producing Formation DELAWARE Pool WELCH-DELAWARE Undersand

1. Is the Operator the only owner* in the dedicated acreage outlined on the plat below?
Yes x No .
2. If the answer to question one is "no," have the interests of all the owners been consolidated by communitization agreement or otherwise? Yes No . If answer is "yes," Type of Consolidation
3. If the answer to question two is "no," list all the owners and their respective interests below:

Owner

Land Description

Section B

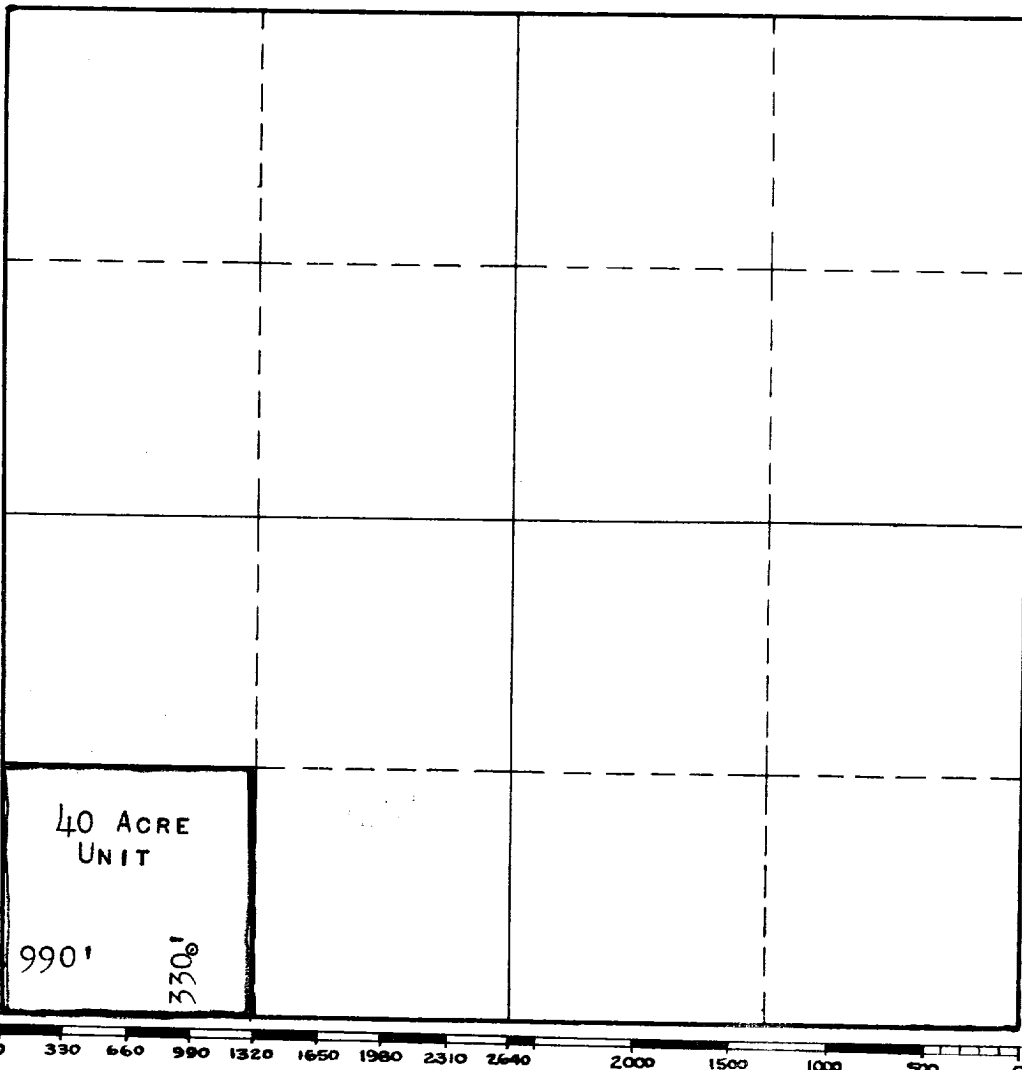

This is to certify that the information in Section A above is true and complete to the best of my knowledge and belief.

El Paso Natural Gas Company

(Operator)

Lloyd R. Baskin

(Representative)

Lloyd R. Baskin

2006 Wilco Building

Address

Midland, Texas

This is to certify that the well location shown on the plat in Section B was plotted from field notes of actual surveys made by me or under my supervision and that the same is true and correct to the best of my knowledge and belief.

Date Surveyed JAN. 27, 1958

W. M. Johnston
Registered Professional
Engineer and Land Surveyor.

Certificate No. 388

(See instructions for completing this form on the reverse side)

INSTRUCTIONS FOR COMPLETION

1. Operator shall furnish and certify to the information called for in Section A.
2. Operator shall outline the dedicated acreage for both oil and gas wells on the plat in Section B.
3. A registered professional engineer or land surveyor registered in the State of New Mexico or approved by the Commission shall show on the plat the location of the well and certify this information in the space provided.
4. All distances shown on the plat must be from the outer boundaries of Section.
5. If additional space is needed for listing owners and their respective interests as required in question 3, Section A, please use space below

OIL CONSERVATION COMMISSION		
ARTESIA DISTRICT OFFICE		
No. Copies Received <u>6</u>		
DISTRIBUTION		
Operator	<u>1</u>	
Surveyor	<u>1</u>	
State Engineer	<u>1</u>	
U. S. G. O.	<u>2</u>	
Land Office	<u>1</u>	
File	<u>1</u>	<input checked="" type="checkbox"/>

* "Owner" means the person who has the right to drill into and to produce from any pool and to appropriate the production either for himself or for himself and another. (65-3-29 (e) NMSA 1953 Comp.)