

(SUBMIT IN TRIPLICATE)

UNITED STATES
DEPARTMENT OF THE INTERIOR
GEOLOGICAL SURVEY

Land Office Las Cruces
Lease No. LC 068823-C
Unit Welch Unit

SUNDRY NOTICES AND REPORTS ON WELLS

NOTICE OF INTENTION TO DRILL	<input checked="" type="checkbox"/>	SUBSEQUENT REPORT OF WATER SHUT-OFF	
NOTICE OF INTENTION TO CHANGE PLANS		SUBSEQUENT REPORT OF SHOOTING OR ACIDIZING	
NOTICE OF INTENTION TO TEST WATER SHUT-OFF		SUBSEQUENT REPORT OF ALTERING CASING	
NOTICE OF INTENTION TO RE-DRILL OR REPAIR WELL		SUBSEQUENT REPORT OF RE-DRILLING OR REPAIR	
NOTICE OF INTENTION TO SHOOT OR ACIDIZE		SUBSEQUENT REPORT OF ABANDONMENT	
NOTICE OF INTENTION TO PULL OR ALTER CASING		SUPPLEMENTARY WELL HISTORY	
NOTICE OF INTENTION TO ABANDON WELL			

(INDICATE ABOVE BY CHECK MARK NATURE OF REPORT, NOTICE, OR OTHER DATA)

February 25, 19 59

Welch Unit
Well No. 7 is located 2310 ft. from N line and 990 ft. from W line of sec. 21

NW/4 Sec. 21
(1/4 Sec. and Sec. No.)

T 26 S
(Twp.)

R 27 E
(Range)

NMPM
(Meridian)

Welch Delaware
(Field)

Eddy
(County or Subdivision)

New Mexico
(State or Territory)

The elevation of the derrick floor above sea level is 3240 ft. G.L.

DETAILS OF WORK

(State names of and expected depths to objective sands; show sizes, weights, and lengths of proposed casings; indicate mudding jobs, cementing points, and all other important proposed work)

We propose to drill this well to approximately 2200 feet in the Delaware Sand formation using rotary drilling equipment. Our casing program is as follows:

Drill 11" hole to approximately 250 feet where 8-5/8" 24# J-55 casing will be set using enough cement to circulate.

Drill out 7-7/8" hole below surface casing to Total Depth where 4-1/2" 9.5# J-55 casing will be set using approximately 200 sacks cement.

I understand that this plan of work must receive approval in writing by the Geological Survey before operations may be commenced.

Company El Paso Natural Gas Products Company

Address 2006 Wilco Building

Midland, Texas

By

Lloyd E. Baskin

Title

Drilling & Production Supt.

NEW MEXICO OIL CONSERVATION COMMISSION
Well Location and Acreage Dedication Plat

Section A.

Date February 25, 1959

Operator El Paso Natural Gas Products Co. Lease Welch Unit ✓
Well No. 7 Unit Letter R Section 21 Township 26 S Range 27 E NMPM
Located 2310 Feet From North Line, 990 Feet From West Line
County Eddy G. L. Elevation 3240 Dedicated Acreage 40 Acres
Name of Producing Formation Delaware Sand Pool Welch Delaware ✓

1. Is the Operator the only owner* in the dedicated acreage outlined on the plat below?
Yes _____ No X.
2. If the answer to question one is "no," have the interests of all the owners been consolidated by communitization agreement or otherwise? Yes X No _____. If answer is "yes," Type of Consolidation Unit Agreement
3. If the answer to question two is "no," list all the owners and their respective interests below:

Owner

Land Description

Section B

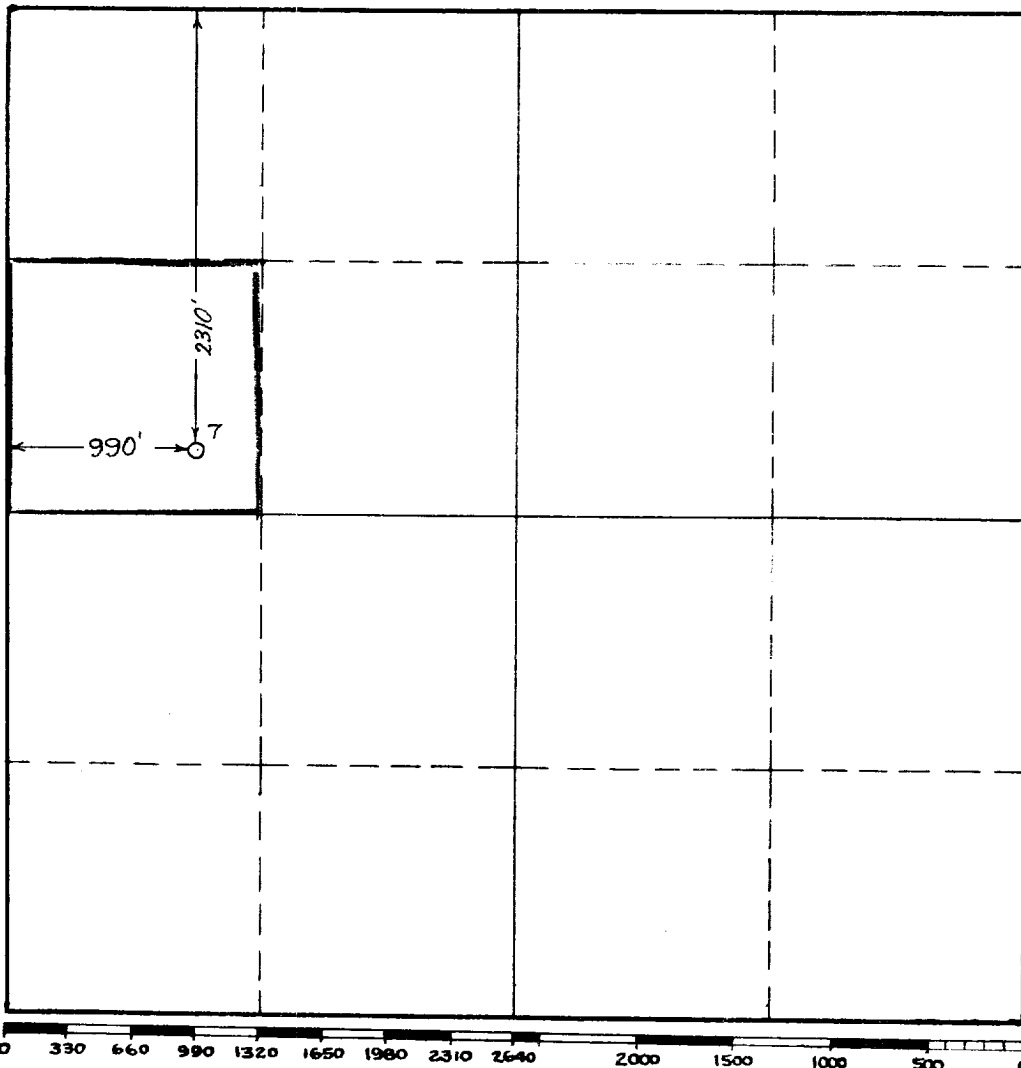

This is to certify that the information in Section A above is true and complete to the best of my knowledge and belief.

El Paso Natural Gas Products Co.

(Operator)

Lloyd E. Baskin
(Representative)

Lloyd E. Baskin

2006 Wilson Building

Address

Midland, Texas

This is to certify that the well location shown on the plat in Section B was plotted from field notes of actual surveys made by me or under my supervision and that the same is true and correct to the best of my knowledge and belief.

Date Surveyed Feb 23, 1959

Lloyd E. Baskin

Registered Professional
Engineer and/or Land Surveyor.

Certificate No. 648

INSTRUCTIONS FOR COMPLETION:

1. Operator shall furnish and certify to the information called for in Section A.
2. Operator shall outline the dedicated acreage for both oil and gas wells on the plat in Section B.
3. A registered professional engineer or land surveyor registered in the State of New Mexico or approved by the Commission shall show on the plat the location of the well and certify this information in the space provided.
4. All distances shown on the plat must be from the outer boundaries of Section.
5. If additional space is needed for listing owners and their respective interests as required in question 3, Section A, please use space below

* "Owner" means the person who has the right to drill into and to produce from any pool and to appropriate the production either for himself or for himself and another. (65-3-29 (e) NMSA 1953 Comp.)