

(SUBMIT IN TRIPLICATE)

Land Office Santa Fe

Lease No. LC 070362

Unit RECEIVED

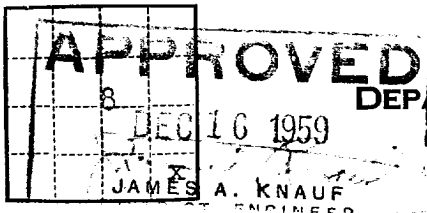

UNITED STATES
DEPARTMENT OF THE INTERIOR
GEOLOGICAL SURVEY

DEC 21 1959

SUNDRY NOTICES AND REPORTS ON WELLS
ARTESIA, OFFICE

NOTICE OF INTENTION TO DRILL.....	X	SUBSEQUENT REPORT OF WATER SHUT-OFF.....
NOTICE OF INTENTION TO CHANGE PLANS.....		SUBSEQUENT REPORT OF SHOOTING OR ACIDIZING.....
NOTICE OF INTENTION TO TEST WATER SHUT-OFF.....		SUBSEQUENT REPORT OF ALTERING CASING.....
NOTICE OF INTENTION TO RE-DRILL OR REPAIR WELL.....		SUBSEQUENT REPORT OF RE-DRILLING OR REPAIR.....
NOTICE OF INTENTION TO SHOOT OR ACIDIZE.....		SUBSEQUENT REPORT OF ABANDONMENT.....
NOTICE OF INTENTION TO PULL OR ALTER CASING.....		SUPPLEMENTARY WELL HISTORY.....
NOTICE OF INTENTION TO ABANDON WELL.....		

(INDICATE ABOVE BY CHECK MARK NATURE OF REPORT, NOTICE, OR OTHER DATA)

December 15, 1959

1-Superior

Well No. _____ is located 660 ft. from [S] line and 660 ft. from [E] line of sec. 8
C 34 1/2 S 25 S 29 E N.M.P.M.
(1/4 Sec. and Sec. No.) (Twp.) (Range) (Meridian)
Wildcat Eddy New Mexico
(Field) (County or Subdivision) (State or Territory)

The elevation of the derrick floor above sea level is _____ ft.

DEC 16 1959

DETAILS OF WORK

(State names of and expected depths to objective sands; show sizes, weights, and lengths of proposed casings; indicate including joint, cementing points, and all other important proposed work)

With rotary tools plan to drill to test the Delaware sand formation at approximately 3100 feet. Plan to cement 250 feet of 8-5/8 inch OD 24# casing with 50 sacks on top of salt for surface string. If oil is found, will run 3100 feet 5 1/2" OD casing and cement with 100 sacks. Plan to core the Delaware formation.

I understand that this plan of work must receive approval in writing by the Geological Survey before operations may be commenced.

Company Neil H. Mills

Address Box 529

Carlsbad, N.M.

By Neil H. Mills

Title Owner

NEW MEXICO OIL CONSERVATION COMMISSION
Well Location and Acreage Dedication Plat

Section A.

Date 12-11-59

Operator Neil H. Wills Lease Superior-Federal
Well No. 1 Unit Letter P Section 8 Township 25S Range 29E NMPM
Located 660 Feet From South Line, 660 Feet From East Line
County Eddy G. L. Elevation _____ Dedicated Acreage 40 Acres
Name of Producing Formation Delaware Pool Wildcat

1. Is the Operator the only owner* in the dedicated acreage outlined on the plat below?
Yes ☒ No _____.
2. If the answer to question one is "no," have the interests of all the owners been consolidated by communitization agreement or otherwise? Yes _____ No _____. If answer is "yes," Type of Consolidation _____
3. If the answer to question two is "no," list all the owners and their respective interests below:

Owner

Land Description

RECEIVED
DEC 16 1959
GEOLOGICAL SURVEY
ARTESIA, NEW MEXICO

Section B

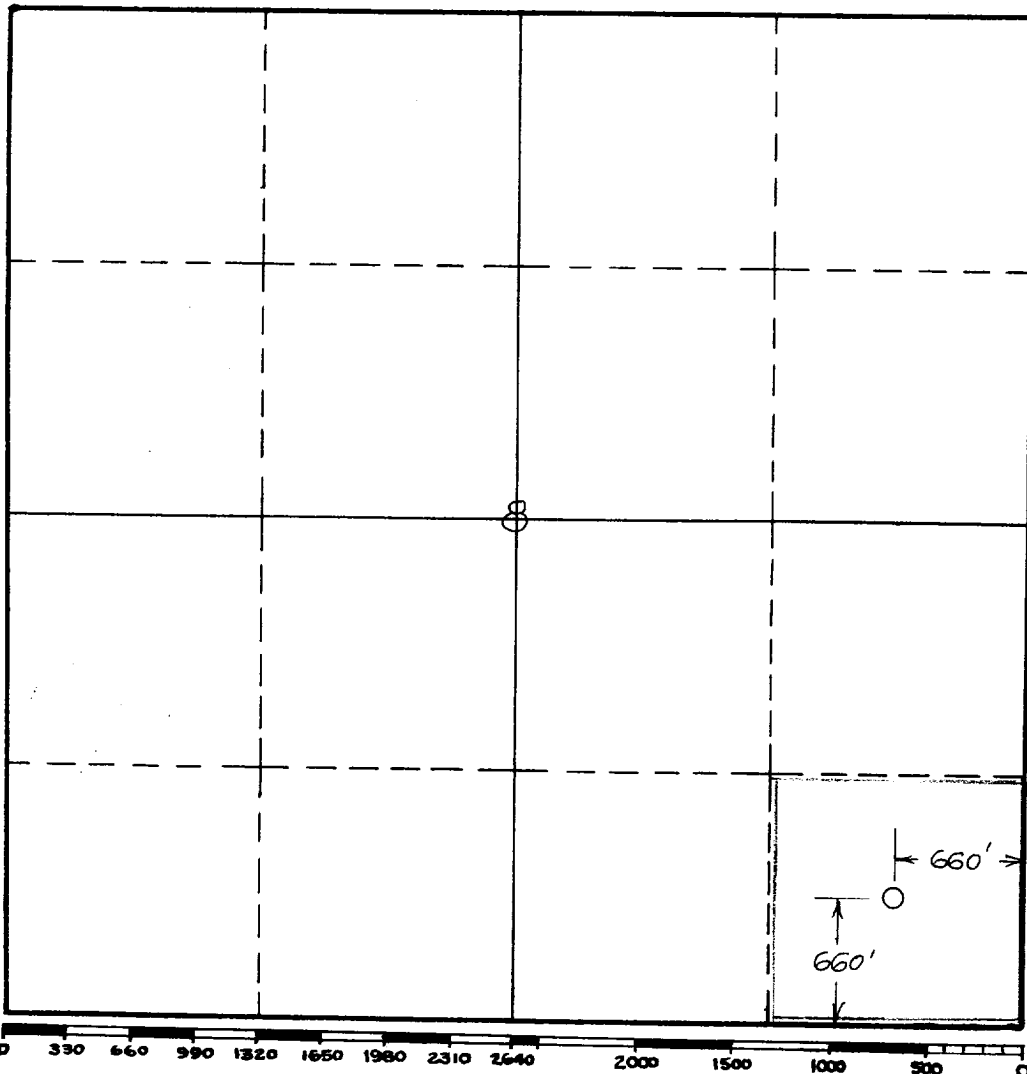

This is to certify that the information in Section A above is true and complete to the best of my knowledge and belief.

Neil H. Wills
(Operator)

(Representative)

Box 529 Carlsbad, N.M.
Address

This is to certify that the well location shown on the plat in Section B was plotted from field notes of actual surveys made by me or under my supervision and that the same is true and correct to the best of my knowledge and belief.

Date Surveyed 12-10-59

Robert H. Riggs
Registered Professional
Engineer and/or Land Surveyor.

Certificate No. 707

(See instructions for completing this form on the reverse side)

INSTRUCTIONS FOR COMPLETION

1. Operator shall furnish and certify to the information called for in Section A.
2. Operator shall outline the dedicated acreage for both oil and gas wells on the plat in Section B.
3. A registered professional engineer or land surveyor registered in the State of New Mexico or approved by the Commission shall show on the plat the location of the well and certify this information in the space provided.
4. All distances shown on the plat must be from the outer boundaries of Section.
5. If additional space is needed for listing owners and their respective interests as required in question 3, Section A, please use space below

* "Owner" means the person who has the right to drill into and to produce from any pool and to appropriate the production either for himself or for himself and another. (65-3-29 (e) NMSA 1953 Comp.)