

NEW MEXICO
OIL CONSERVATION COMMISSION

Form C-128

Well Location and/or Gas Proration Plat

Date 6/11/56

Operator The Texas Company Lease R. T. Wilson-Federal

Well No. 2 Section 24 Township 26 South Range 31 East NMPM

Located 660' Feet From South Line, 660' Feet From East Line,

Eddy County, New Mexico. G. L. Elevation 3,163.7'

Mason North

Name of Producing Formation Delaware Sand Pool (Delaware) Dedicated Acreage 40

(Note: All distances must be from outer boundaries of Section)

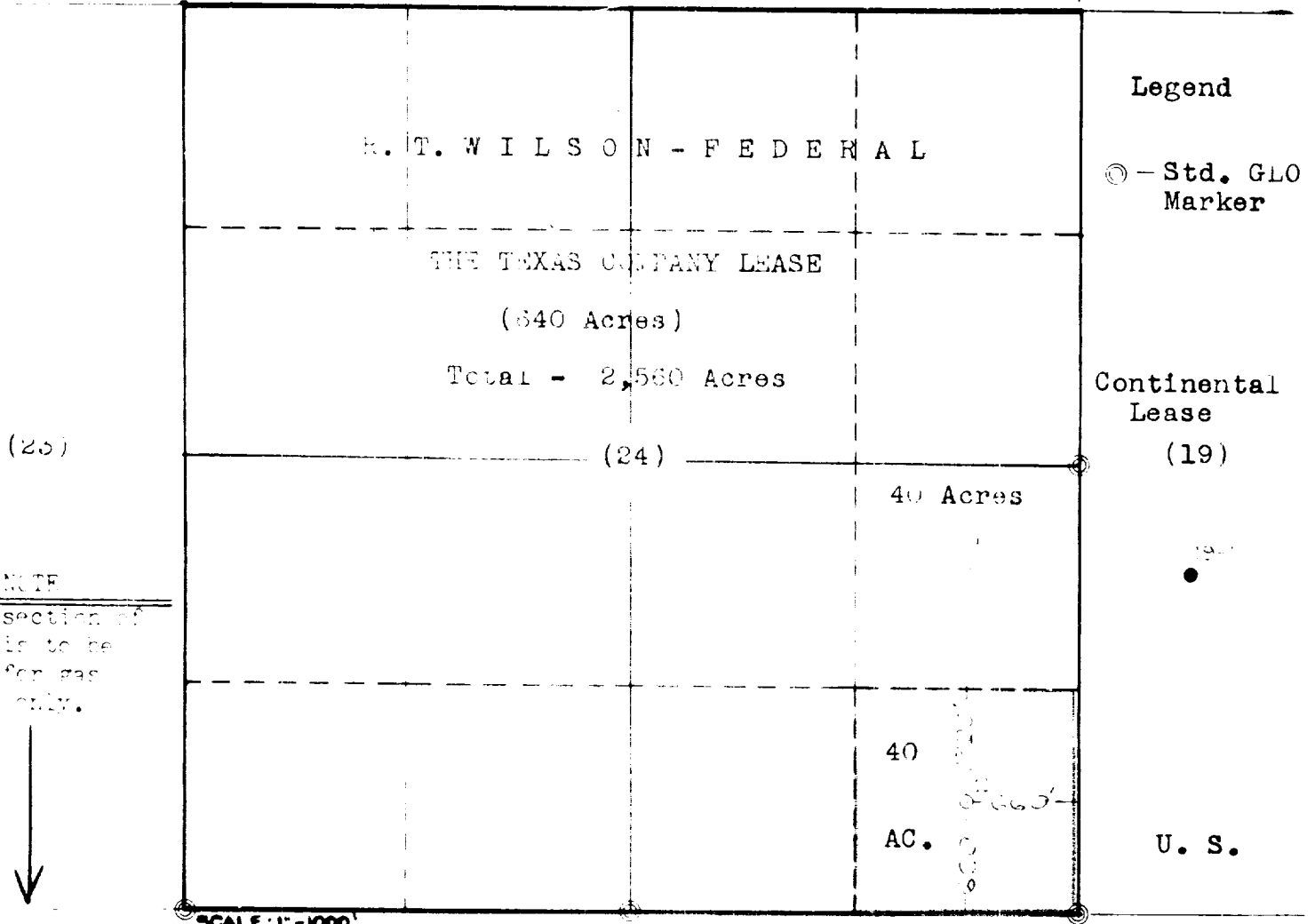

NOTE

This section of form is to be used for gas wells only.

1. Is this Well a Dual Comp. ? Yes No X
2. If the answer to Question 1 is yes, are there any other dually completed wells within the dedicated acreage ? Yes No

Name
Position
Representing
Address

This is to certify that the above plat was prepared from field notes of actual surveys made by me or under my supervision and that the same are true and correct to the best of my knowledge and belief.

Date Surveyed 6/11/56
Registered Professional Engineer and/or Land Surveyor