

(SUBMIT IN TRIPLICATE)

UNITED STATES
DEPARTMENT OF THE INTERIOR
GEOLOGICAL SURVEY

Land Office Las Cruces
Lease No. 068282-B
Unit _____

30-015-09877

SUNDRY NOTICES AND REPORTS ON WELLS

NOTICE OF INTENTION TO DRILL.....	<input checked="" type="checkbox"/>	SUBSEQUENT REPORT OF WATER SHUT-OFF.....	
NOTICE OF INTENTION TO CHANGE PLANS.....		SUBSEQUENT REPORT OF SHOOTING OR ACIDIZING.....	
NOTICE OF INTENTION TO TEST WATER SHUT-OFF.....		SUBSEQUENT REPORT OF ALTERING CASING.....	
NOTICE OF INTENTION TO RE-DRILL OR REPAIR WELL.....		SUBSEQUENT REPORT OF RE-DRILLING OR REPAIR.....	
NOTICE OF INTENTION TO SHOOT OR ACIDIZE.....		SUBSEQUENT REPORT OF ABANDONMENT.....	
NOTICE OF INTENTION TO PULL OR ALTER CASING.....		SUPPLEMENTARY WELL HISTORY.....	
NOTICE OF INTENTION TO ABANDON WELL.....			

(INDICATE ABOVE BY CHECK MARK NATURE OF REPORT, NOTICE, OR OTHER DATA)

January 21, 1956

Well No. 11 is located 990 ft. from N line and 1650 ft. from W line of sec. 25

11 Sec. 25 26 31 N.M.P.M.
(1/4 Sec. and Sec. No.) (Twp.) (Range) (Meridian)

North Mason (Delaware) Kearney New Mexico
(Field) (County or Subdivision) (State or Territory)

The elevation of the derrick floor above sea level is Will Furnish later ft.

DETAILS OF WORK

(State names of and expected depths to objective sands; show sizes, weights, and lengths of proposed casings; indicate mudding jobs, cementing points, and all other important proposed work)

Will drill well with rotary tools to test upper Delaware Sand at approximate depth of 4200'. Will set 900' of 8 5/8" surface pipe and cement to surface. Will run 5 1/2" casing to top of pay sand, if productive, and cement with 125 sacks. If well will not make top allowable, will frac with 1000 gallons and 1000# sand.

I understand that this plan of work must receive approval in writing by the Geological Survey before operations may be commenced.

Company The Ibox Company
Address Box 752
Breckenridge
Texas
By [Signature]
Title Production Superintendent

The Ibex Company

Hanson

11

25

26 C

31 E

990' FWL and 1650' FWL of Section 25

Eddy

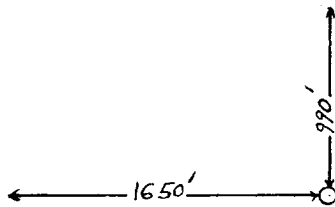

Jan 21, 1956

Jerry D. Ferrel