

NUMBER OF COPIES RECEIVED <b>6</b>	
DISTRIBUTION	
SANTA FE	<b>1</b>
FILE	<b>5</b>
U.S.G.S.	<b>1</b>
LAND OFFICE	
TRANSPORTER	
OIL	
GAS	
PRODUCTION OFFICE	
OPERATOR	<b>1</b>

**NEW MEXICO OIL CONSERVATION COMMISSION**  
Santa Fe, New Mexico

Form C-101  
Revised 12/1/55

**NOTICE OF INTENTION TO DRILL**

Notice must be given to the District Office of the Oil Conservation Commission and approval obtained before drilling or recompletion begins. If changes in the proposed plan are considered advisable, a copy of this notice showing such changes will be returned to the sender. Submit this notice in QUINTUPPLICATE. One copy will be returned following approval. See additional instructions in Rules and Regulations of the Commission. If State Land submit 6 Copies. Attach Form C-128 in triplicate to first 3 copies of Form C-101.

Hobbs, New Mexico

(Place)

July 24, 1964

(Date)

OIL CONSERVATION COMMISSION  
SANTA FE, NEW MEXICO

**36-015-02690**

Gentlemen:

You are hereby notified that it is our intention to commence the Drilling of a well to be known as

Ford Chapman & Associates

(Company or Operator)

State

(Lease)

, Well No. 1

, in N

(Unit)

The well is

located 1980 feet from the West line and 330 feet from the South line of Section 27, T 26 S, R 28 E, NMPM.

(GIVE LOCATION FROM SECTION LINE) Unders. (Tecolote Peak-Dala) Pool, Eddy County

D	C	B	A
E	F	G	H
L	K	J	I
M	N <b>X</b>	O	P

If State Land the Oil and Gas Lease is No. E-6207

If patented land the owner is \_\_\_\_\_

Address \_\_\_\_\_

We propose to drill well with drilling equipment as follows: Cable Tools

The status of plugging bond is Blanket

Drilling Contractor Company Tools

We intend to complete this well in the Delaware formation at an approximate depth of 2750 feet.

**CASING PROGRAM**

We propose to use the following strings of Casing and to cement them as indicated:

Size of Hole	Size of Casing	Weight per Foot	New or Second Hand	Depth	Sacks Cement
<u>11</u>	<u>8 5/8</u>	<u>24#</u>	<u>SH</u>	<u>130</u>	<u>Mudded</u>
<u>7 7/8</u>	<u>5 1/2</u>	<u>14#</u>	<u>SH</u>	<u>2512</u>	<u>Circulated</u>

If changes in the above plans become advisable we will notify you immediately.

ADDITIONAL INFORMATION (If recompletion give full details of proposed plan of work.)

**RECEIVED**

**JUL 27 1964**

**O. C. C.  
ARTERIA, OFFICE**

Approved JUL 27 1964, 19\_\_\_\_  
Except as follows:

Sincerely yours,

Ford Chapman & Associates

(Company or Operator)

By H. L. Smith

Position Agent

Send Communications regarding well to

Name Ford Chapman & Associates

% OIL REPORTS & GAS SERVICES

Address BOX 763 HOBBS, NEW MEXICO

OIL CONSERVATION COMMISSION

By ML Armstrong **INSPECTOR**

NUMBER OF COPIES RECEIVED	
DISTRIBUTION	
SANTA FE	
FILE	
U.S.G.S.	
LAND OFFICE	
TRANSPORTER	OIL GAS
PRODUCTION OFFICE	
OPERATOR	

**NEW MEXICO OIL CONSERVATION COMMISSION**  
**WELL LOCATION AND ACREAGE DEDICATION PLAT**  
 SEE INSTRUCTIONS FOR COMPLETING THIS FORM ON THE REVERSE SIDE

FORM C-128  
 Revised 5/1/57

**SECTION A**

Operator <b>Ford Chapman &amp; Associates</b>		Lease <b>State</b>		Well No. <b>1</b>
Unit Letter <b>N</b>	Section <b>27</b>	Township <b>26 South</b>	Range <b>28 East</b>	County <b>Eddy</b>
Actual Footage Location of Well: <b>1960</b> feet from the <b>West</b> line and <b>330</b> feet from the <b>South</b> line				
Ground Level Elev. <b>3057</b>	Producing Formation <b>Delaware</b>		Pool <b>Undes. (Tecolote Peak-Delaware)</b>	Dedicated Acreage: <b>40</b> Acres

- Is the Operator the only owner in the dedicated acreage outlined on the plat below? YES ☒ NO \_\_\_\_ . ("Owner" means the person who has the right to drill into and to produce from any pool and to appropriate the production either for himself or for himself and another. (65-3-29 (e) NMSA 1935 Comp.)
- If the answer to question one is "no," have the interests of all the owners been consolidated by communitization agreement or otherwise? YES \_\_\_\_ NO \_\_\_\_ . If answer is "yes," Type of Consolidation **RECEIVED**
- If the answer to question two is "no," list all the owners and their respective interests below:

Owner	Land Description
	<b>JUL 27 1964</b>
	<b>O. C. C.</b>
	<b>ARTEBIA, OFFICE</b>

**SECTION B**

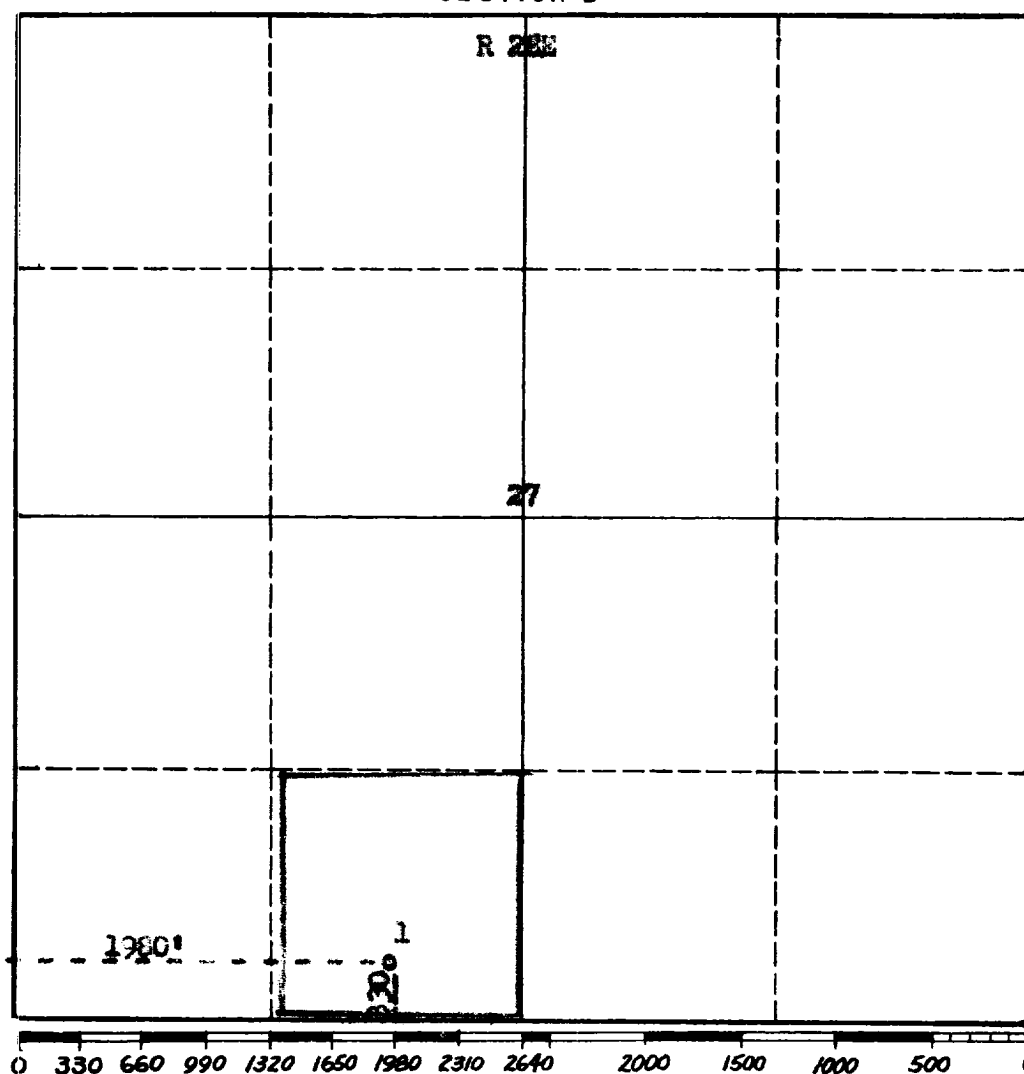

**CERTIFICATION**

I hereby certify that the information in SECTION A above is true and complete to the best of my knowledge and belief.

Name <i>Wanna Holles</i>
Position <b>Agent</b>
Company <b>FORD Chapman &amp; Assoc.</b>
Date <b>July 24, 1964</b>

I hereby certify that the well location shown on the plat in SECTION B was plotted from field notes of actual surveys made by me or under my supervision, and that the same is true and correct to the best of my knowledge and belief.

Date Surveyed <b>June 25, 1964</b>
Registered Professional Engineer and/or Land Surveyor <i>James H. Brown</i>
Certificate No. <b>H.N.L.S. No. 512</b>

T  
26  
S