

UNITED STATES
DEPARTMENT OF THE INTERIOR
GEOLOGICAL SURVEY

30-015-20176
NM 050200-A

APPLICATION FOR PERMIT TO DRILL, DEEPEN, OR PLUG BACK

1. TYPE OF WORK
DRILL ☒ DEEPEN ☐ PLUG BACK ☐

2. NAME OF OPERATOR
SINCLAIR OIL CORPORATION

3. ADDRESS OF OPERATOR
P. O. Box 1920, Hobbs, New Mexico 88240

4. LOCATION OF WELL (Report location clearly and in accordance with any State requirements.)
1980' from the West line and 660' from the North line.

5. LEASE DESIGNATION AND SERIAL NO.
NM 050200-A

6. IF INDIAN, ALLOTTEE OR TRIBE NAME

7. UNIT AGREEMENT NAME

8. FARM OR LEASE NAME
Guadalupe Ridge Unit

9. WELL NO.
1

10. FIELD AND POOL, OR WILDCAT
Wildcat - ~~XXXXXX~~

11. SEC., T., R., M., OR BLK. AND SURVEY OR AREA
22-T26S-R21E

12. COUNTY OR PARISH
Eddy

13. STATE
New Mexico

14. DISTANCE IN MILES AND DIRECTION FROM NEAREST TOWN OR POST OFFICE
Approx. 60 miles west, Carlsbad, New Mex.

15. DISTANCE FROM PROPOSED LOCATION TO NEAREST PROPERTY OR LEASE LINE, FT. (Also to nearest drlg. unit line, if any)

16. NO. OF ACRES IN LEASE
1920

17. NO. OF ACRES ASSIGNED TO THIS WELL
320

18. DISTANCE FROM PROPOSED LOCATION TO NEAREST WELL, DRILLING, COMPLETED, OR APPLIED FOR, ON THIS LEASE, FT.

19. PROPOSED DEPTH
7000'

20. ROTARY OR CABLE TOOLS
Rotary

21. ELEVATIONS (Show whether DF, RT, GR, etc.)

22. APPROX. DATE WORK WILL START
When Approved

PROPOSED CASING AND CEMENTING PROGRAM

SIZE OF HOLE	SIZE OF CASING	WEIGHT PER FOOT	SETTING DEPTH	QUANTITY OF CEMENT
20"	16" Conductor	65#	50'	Circ. to surface 75 sxs
15"	11-3/4"OD	42#	600'	650 sxs. Circ. to surface
10-5/8"	8-5/8"OD	24#	2500'	1700sxs.
7-7/8"	*5-1/2"OD	17#	7000'	600 sxs.

PROPOSED CASING AND CEMENTING PROGRAM CONDITIONS

Drill 20" hole to 50', set 16" conductor pipe and cement to surface.
Drill 15" hole out from under conductor pipe. If conditions of hole permit, drill interval 50-2500', set 8-5/8"OD casing @ 2500' and cement. If conditions of hole do not permit to drill out from under conductor pipe interval 50-2500', then will set 11-3/4"OD casing at depth where needed and cement. Then drill out from under 11-3/4"OD casing to 2500' and cement 8-5/8"OD casing.

At either interval casing is set, fresh water sands will be protected in accordance w/USGS regulations.

* Will run 5-1/2"OD casing only if well is productive.

NOTIFY USGS IN SUFFICIENT TIME TO CEMENTING THE CASING.

IN ABOVE SPACE DESCRIBE PROPOSED PROGRAM: If proposal is to deepen or plug back, give data on present productive zone and proposed new productive zone. If proposal is to drill or deepen directionally, give pertinent data on subsurface locations and measured and true vertical depths. Give blowout preventer program, if any.

24.

SIGNED John H. Humber TITLE Engineer DATE 9-25-68

APPROVED
PERMIT NO.

Subject to compliance with the stipulation for Lands under Jurisdiction of Department of Agriculture attached to this lease.

SEP 26 1968

cc: Mrs. M. M. Khea, Santa Fe, N.M.
cc: Partners
cc: Regional Office
cc: file

*See Instructions On Reverse Side

THIS APPROVAL IS RESCINDED IF OPERATIONS ARE NOT COMMENCED WITHIN 3 MONTHS.
EXPIRES DEC 26 1968

N MEXICO OIL CONSERVATION COMMISS.
WELL LOCATION AND ACREAGE DEDICATION PLAT

Form C-102
Supersedes C-128
Effective 1-1-65

All distances must be from the outer boundaries of the Section.

Operator Sinclair Oil & Gas Company			Lease Guadalupe Ridge Unit		Well No. 1
Unit Letter C	Section 22	Township 26 South	Range 21 East	County Eddy	
Actual Footage Location of Well: 1980 feet from the West line and 660 feet from the North line					
Ground Level Elev.	Producing Formation Strawn		Pool Wildcat	Dedicated Acreage: 320 Acres	

1. Outline the acreage dedicated to the subject well by colored pencil or hachure marks on the plat below.
2. If more than one lease is dedicated to the well, outline each and identify the ownership thereof (both as to working interest and royalty).
3. If more than one lease of different ownership is dedicated to the well, have the interests of all owners been consolidated by communitization, unitization, force-pooling, etc?

☐ Yes ☐ No If answer is "yes," type of consolidation 1968

If answer is "no," list the owners and tract descriptions which have actually been consolidated. (Use reverse side of this form if necessary.)

No allowable will be assigned to the well until all interests have been consolidated (by communitization, unitization, forced-pooling, or otherwise) or until a non-standard unit, eliminating such interests, has been approved by the Commission.

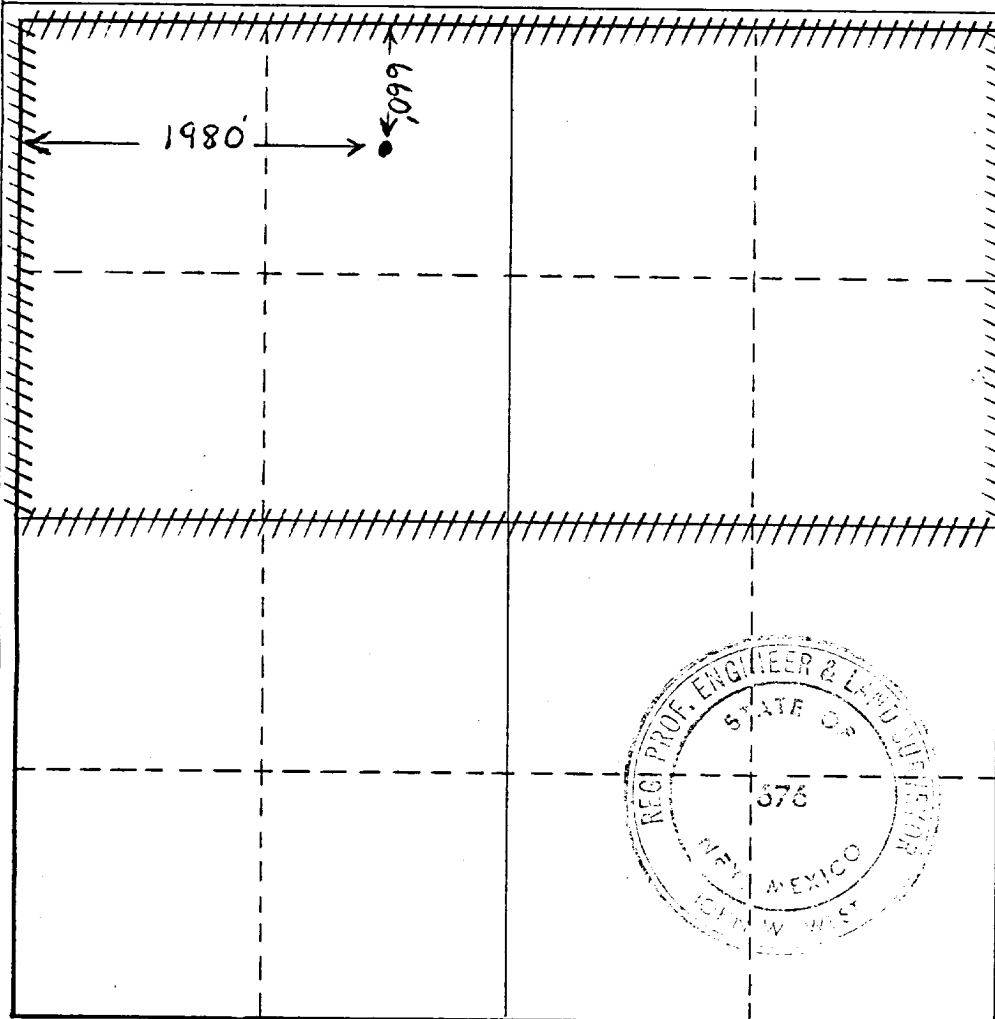

CERTIFICATION

I hereby certify that the information contained herein is true and complete to the best of my knowledge and belief.

[Signature]

Name
R. E. Cross, Jr.

Position
Administrative Clerk

Company
Sinclair Oil & Gas Company

Date
September 20, 1968

I hereby certify that the well location shown on this plat was plotted from field notes of actual surveys made by me or under my supervision, and that the same is true and correct to the best of my knowledge and belief.

Date Surveyed

Registered Professional Engineer and/or Land Surveyor

Certificate No.

