

UNITED STATES
DEPARTMENT OF THE INTERIOR
GEOLOGICAL SURVEY(Other instructions on
reverse side)

Budget Bureau No. 42 R1425.

5. LEASE DESIGNATION AND SERIAL NO.

NM 0472258

6. IF INDIAN, ALLOTTEE OR TRIBE NAME

7. UNIT AGREEMENT NAME

8. FARM OR LEASE NAME

Cities-Federal

9. WELL NO.

1

10. FIELD AND POOL, OR WILDCAT

Wildcat

11. SEC., T., R., M., OR BLK.
AND SURVEY OR AREA

Sec. 34, T25S, R24E

12. COUNTY OR PARISH

Eddy

13. STATE

New Mexico

1a. TYPE OF WORK

DRILL ☒DEEPEN ☐PLUG BACK ☐

b. TYPE OF WELL

OIL
WELL ☒GAS
WELL ☐

OTHER

SINGLE
ZONE ☒MULTIPLE
ZONE ☐

2. NAME OF OPERATOR

Black River Corporation

3. ADDRESS OF OPERATOR

620 Commercial Bank Tower, Midland, Texas 79701

4. LOCATION OF WELL (Report location clearly and in accordance with any State requirements.*)

At surface 1650 Feet FN & WL, Sec. 34, T25S, R24E

At proposed prod. zone
Same

14. DISTANCE IN MILES AND DIRECTION FROM NEAREST TOWN OR POST OFFICE*

10 Miles Southwest of White City

15. DISTANCE FROM PROPOSED*

LOCATION TO NEAREST
PROPERTY OR LEASE LINE, FT. 1650
(Also to nearest drlg. unit line, if any)

18. DISTANCE FROM PROPOSED LOCATION*

TO NEAREST WELL, DRILLING, COMPLETED,
OR APPLIED FOR, ON THIS LEASE, FT. 3250

16. NO. OF ACRES IN LEASE

19. PROPOSED DEPTH
8000 Devonian17. NO. OF ACRES ASSIGNED
TO THIS WELL

40

20. ROTARY OR CABLE TOOLS

Rotary

21. ELEVATIONS (Show whether DF, RT, GR, etc.)

3715' Estimated ground - To be corrected

22. APPROX. DATE WORK WILL START*

April 15, 1971

23. PROPOSED CASING AND CEMENTING PROGRAM

SIZE OF HOLE	SIZE OF CASING	WEIGHT PER FOOT	SETTING DEPTH	QUANTITY OF CEMENT
15	11-3/4	42	350	300 sx.
10-5/8	8-5/8	24	1000	350 sx.

After setting the 11-3/4 inch casing and circulating cement to surface, W.O.C. 24 hours, then drill thru possible lost circulation zone to 1000 feet (after which no lost circulation is anticipated). Set 8-5/8 casing at 1000 feet and if necessary stage cement to surface. W.O.C. 24 hours. 1000 foot depth should be 400 feet into Delaware. Drill to T.D. of 8000 for Devonian Test. Production casing string to be determined at time T.D. is reached.

RECEIVED

APR 8 1971

G. C. C.

ARTESIA, OFFICE

RECEIVED

APR - 7 1971

U. S. GEOLOGICAL SURVEY
ARTESIA, NEW MEXICO

IN ABOVE SPACE DESCRIBE PROPOSED PROGRAM: If proposal is to deepen or plug back, give data on present productive zone and proposed new productive zone. If proposal is to drill or deepen directionally, give pertinent data on subsurface locations and measured and true vertical depths. Give blowout preventer program, if any.

24.

SIGNED

John G. Davis

TITLE

Agent

DATE

4/6/71

(This space for Federal or State office use)

PERMIT NO.

APPROVAL DATE

APPROVED BY

CONDITIONS OF APPROVAL, IF ANY:

TITLE

THIS APPROVAL IS VALID IF OPERATIONS
ARE NOT COMMENCED WITHIN 3 MONTHS.
EXPIRES JUL 7 - 1971

DECLARED WATER BASIN
CANNOT BE USED THE
CASING MUST BE CIRCULATED

NOTIFY US IN SUFFICIENT TIME TO
WITNESS CEMENTING THE CASING.

MEXICO OIL CONSERVATION COMMISSION
WELL LOCATION AND ACREAGE DEDICATION PLAT

Form C-102
Supersedes C-128
Effective 1-1-65

All distances must be from the outer boundaries of the Section.

Owner Black River Corporation			Lease Cities Federal		Well No. 1
Tract Letter F	Section 34	Township 25-S	Range 24-E	County Eddy	
Approximate Location of Well: 1650 feet from the North line and 1650 feet from the West line					
Ground Level Elev.	Producing Formation Permian		Pool Wichita	Dedicated Acreage: 40 Acres	

1. Outline the acreage dedicated to the subject well by colored pencil or hachure marks on the plat below.
2. If more than one lease is dedicated to the well, outline each and identify the ownership thereof (both as to working interest and royalty).
3. If more than one lease of different ownership is dedicated to the well, have the interests of all owners been consolidated by communitization, unitization, force-pooling, etc?

☐ Yes ☐ No If answer is "yes," type of consolidation _____

If answer is "no," list the owners and tract descriptions which have actually been consolidated. (Use reverse side of this form, if necessary.) _____

No allowable will be assigned to the well until all interests have been consolidated (by communitization, unitization, forced-pooling, or otherwise) or until a non-standard unit, eliminating such interests, has been approved by the Commission.

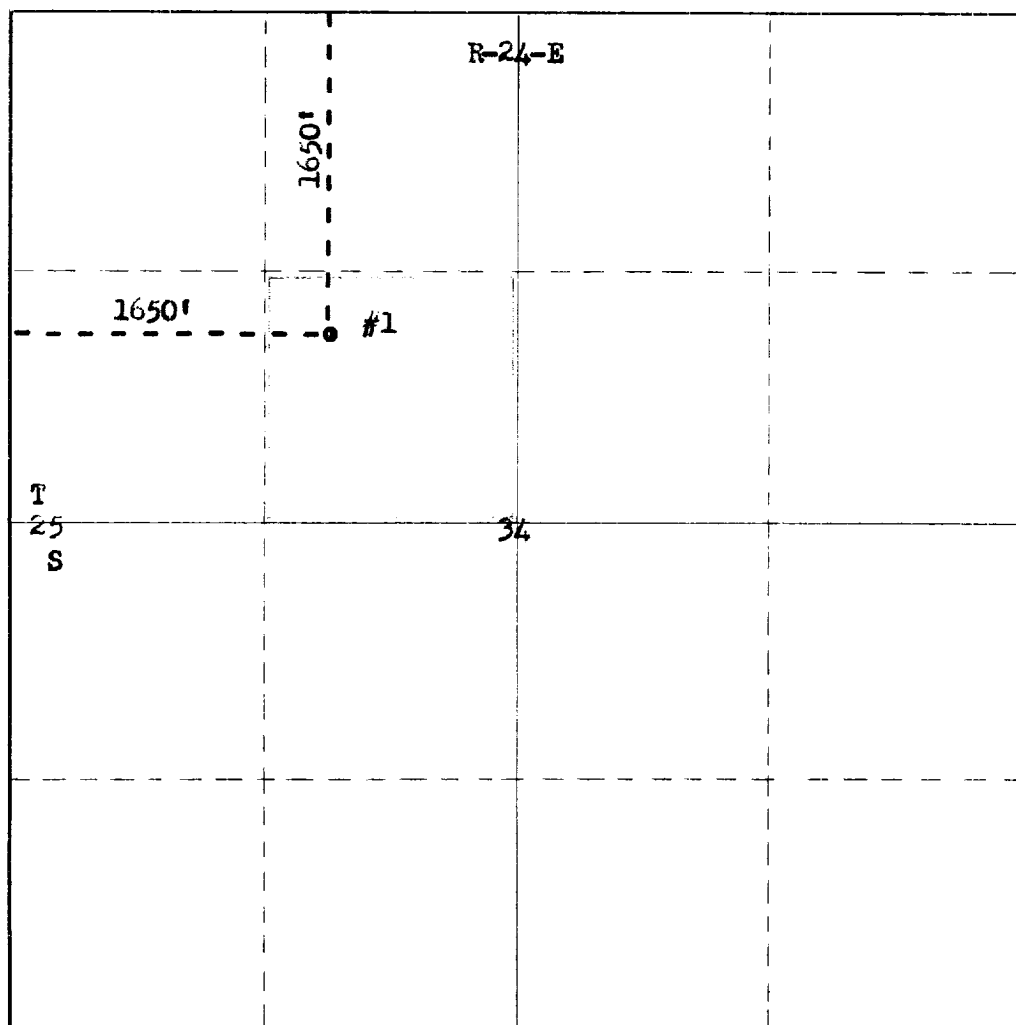

CERTIFICATION

I hereby certify that the information contained herein is true and complete to the best of my knowledge and belief.

John C. Davis
Name

Chief Geologist
Position

W&R
Company

3-17-71 **APR - 2 1971**
Date

U. S. GEOLOGICAL SURVEY
ARTESIA, NEW MEXICO

RECEIVED
I hereby certify that the well location shown on this plat was plotted from field notes of actual surveys made by me under my supervision, and that the same is true and correct to the best of my knowledge and belief.

James H. Brown
Date Surveyed

March 17, 1971

Registered Professional Engineer and/or Land Surveyor

James H. Brown
Certificate No.

542