

NEW MEXICO OIL CONSERVATION COMMISSION
WELL LOCATION AND ACREAGE DEDICATION PLAT

Form O-102
Supersedes O-123
Effective 1-1-65

All distances must be from the outer boundaries of the Section

Owner <i>Black River Corporation</i>			Lessee <i>Cities Federal</i>		Well No. <i>R</i>
Section <i>34</i>	Township <i>25S</i>	Range <i>24E</i>	County <i>Eddy</i>		
Depth of well: <i>2310</i> feet from the <i>South</i> line and <i>2310</i> feet from the <i>East</i> line					
Dedicated Acreage: <i>Morrow</i>		Feet: <i>Undesignated</i>		Dedicated Acreage: <i>320</i>	

1. Outline the acreage dedicated to the subject well by colored pencil or hatchure marks on the plat below.
2. If more than one lease is dedicated to the well, on line each and identify the ownership thereof (both as to working interest and royalty).
3. If more than one lease of different ownership is dedicated to the well, have the interests of all owners been consolidated by communitization, unitization, force-pooling, etc?

RECEIVED

JAN 31 1972

☐ Yes ☐ No If answer is "yes" type of consolidation _____

O. C. C.

If answer is "no" list the owners and tract descriptions which have actually been consolidated. (Use reverse side of this form if necessary.) _____

No allowable will be assigned to the well until all interests have been consolidated (by communitization, unitization, forced-pooling, or otherwise) or until a non-standard unit, eliminating such interests, has been approved by the Commission.

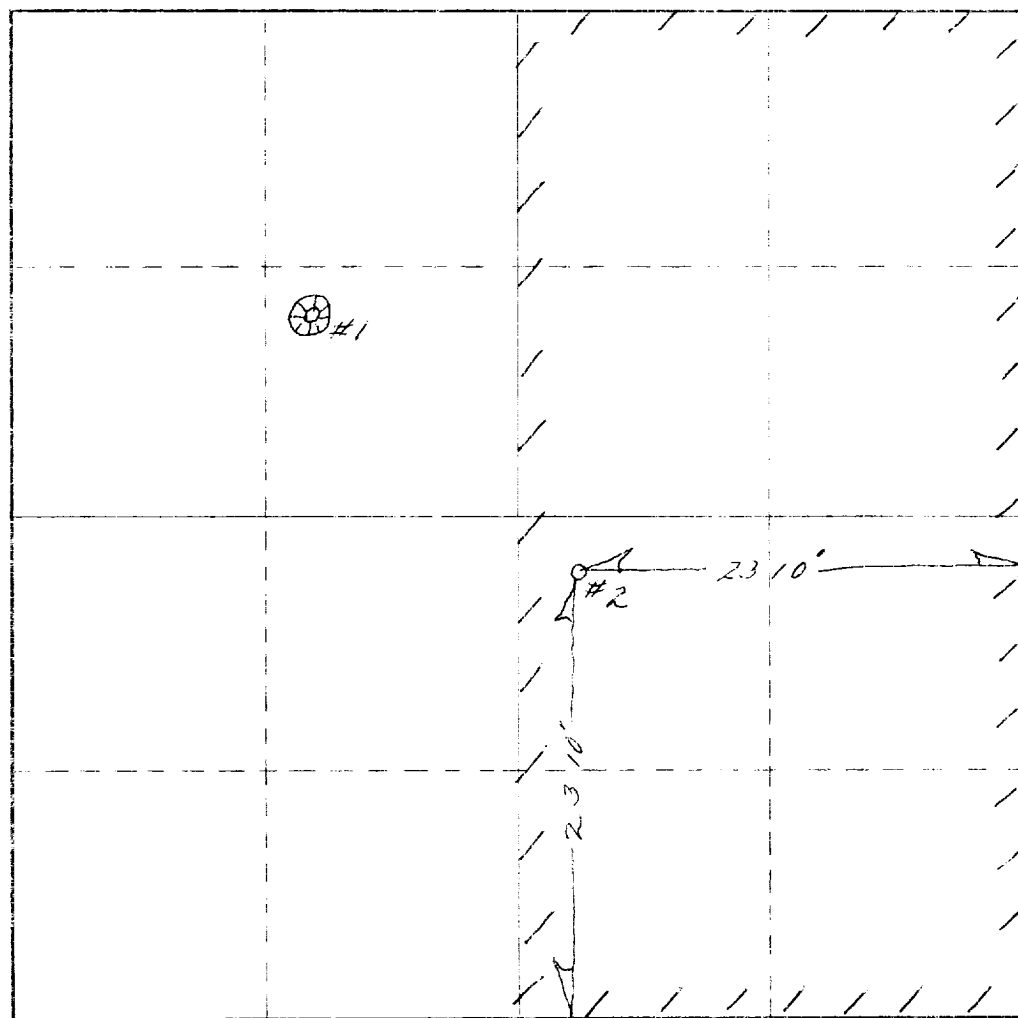

CERTIFICATION

I hereby certify that the information contained herein is true and complete to the best of my knowledge and belief.

Ernest C. Miller

Geologist

Black River Corporation

Jan. 31, 1972

I hereby certify that the well location shown on this plat was plotted from field notes of actual surveys made by me or under my supervision, and that the same is true and correct to the best of my knowledge and belief.

Date Surveyed

July 15, 1971

Registered Professional Engineer and Land Surveyor

Certificate No.

350 560 90 1320 1650 1980 2310 2640 2000 1500 1000 500