

UNITED STATES
DEPARTMENT OF THE INTERIOR
GEOLOGICAL SURVEY

APPLICATION FOR PERMIT TO DRILL, DEEPEN, OR PLUG BACK

1a. TYPE OF WORK

DRILL ☒DEEPEN ☐PLUG BACK ☐

b. TYPE OF WELL

OIL
WELL ☐GAS
WELL ☒

OTHER

SINGLE
ZONE ☐MULTIPLE
ZONE ☒

2. NAME OF OPERATOR

CITIES SERVICE OIL COMPANY

3. ADDRESS OF OPERATOR

P.O. Box 69, Hobbs, N.M. 88240

4. LOCATION OF WELL (Report location clearly and in accordance with any State requirements.)*

At surface

750' FSL & 1980' FEL Sec. 22-255-24E, Eddy Co. N.M.

At proposed prod. zone

Same as above

14. DISTANCE IN MILES AND DIRECTION FROM NEAREST TOWN OR POST OFFICE*

Approx. 9 1/2 miles SW of White City, New Mexico

15. DISTANCE FROM PROPOSED*

LOCATION TO NEAREST
PROPERTY OR LEASE LINE, FT.
(Also to nearest drlg. line, if any)

750'

16. NO. OF ACRES IN LEASE

12.00

17. NO. OF ACRES ASSIGNED
TO THIS WELL

320

18. DISTANCE FROM PROPOSED LOCATION*

TO NEAREST WELL, DRILLING, COMPLETED,
OR APPLIED FOR, ON THIS LEASE, FT.

2040'

19. PROPOSED DEPTH

7200'

20. ROTARY OR CABLE TOOLS

Rotar,

21. ELEVATIONS (Show whether DF, RT, GR, etc.)

3714.11' GR

22. APPROX. DATE WORK WILL START*

5-20-72

23.

PROPOSED CASING AND CEMENTING PROGRAM

SIZE OF HOLE	SIZE OF CASING	WEIGHT PER FOOT	SETTING DEPTH	QUANTITY OF CEMENT
12 1/4"	5 5/8"	24#	750	Circulate
1 7/8"	5 1/2"	14 & 15.5#	7200	350 sacks

It is proposed to drill to a T.D. of 7200' and test the Strawn and Morrow formations.

The blowout prevention program is as follows:

1. One set of blind rams.
2. One set of drill pipe rams.

RECEIVED
MAY - 4 1972
U. S. GEOLOGICAL SURVEY
ARTESIA, NEW MEXICOIN ABOVE SPACE DESCRIBE PROPOSED PROGRAM: If proposal is to deepen or plug b.
zone. If proposal is to drill or deepen directionally, give pertinent data on subs
prevention program, if any.ive data on present productive zone and proposed new productive
locations and measured and true vertical depths. Give blowout

24.

SIGNED

TITLE Dist. Adm. SupervisorDATE 5-3-72

(This space for Federal or State office use)

PERMIT NO.

APPROVAL DATE

DATE

APPROVED
MAY 25 1972
R. L. BEEKMAN
ACTING DISTRICT ENGINEERTHIS APPROVAL IS RESCINDED IF OPERATIONS
ARE NOT COMMENCED WITHIN 3 MONTHS.
EXPIRES
AUG 25 1972
See Instructions On Reverse SideNOTIFY USGS IN SUFFICIENT TIME TO
WITNESS CEMENTING THE 5 3/8" CASING.

Instructions

General: This form is designed for submitting proposals to perform certain well operations, as indicated, on all types of lands and leases for appropriate action by either a Federal or a State agency, or both, pursuant to applicable Federal and/or State laws and regulations. Any necessary special instructions concerning the use of this form and the number of copies to be submitted, particularly with regard to local, area, or regional procedures and practices, either are shown below or will be issued by, or may be obtained from, the local Federal and/or State office.

Item 1: If the proposal is to redrill to the same reservoir at a different subsurface location or to a new reservoir, use this form with appropriate notations. Consult applicable State or Federal regulations concerning subsequent work proposals or reports on the well.

Item 4: If there are no applicable State requirements, locations on Federal or Indian land should be described in accordance with Federal requirements. Consult local State or Federal office for specific instructions.

Item 14: Needed only when location of well cannot readily be found by road from the land or lease description. A plat, or plats, separate or on this reverse side, showing the roads to, and the surveyed location of, the well, and any other required information, should be furnished when required by Federal or State agency offices.

Items 15 and 18: If well is to be, or has been directionally drilled, give distances for subsurface location of hole in any present or objective production zone.

Item 22: Consult applicable Federal or State regulations, or appropriate officials, concerning approval of the proposal before operations are started.

RECEIVED

NEW MEXICO OIL CONSERVATION COMMISSION

WELL LOCATION AND ACREAGE DEDICATION PLAT

MAY 26 1972

Form C-102
Supersedes C-128
Effective 1-1-65

All distances must be from the outer boundaries of the Section.

Operator CITIES SERVICE OIL COMPANY			Lease GOVERNMENT "P"		ARTESIA, OFFICE		Well No. 1
Unit Letter Q	Section 22	Township 25 SOUTH	Range 24 EAST	County EDDY			
Actual Footage Location of Well: 760 feet from the SOUTH line and 1980 feet from the EAST line							
Ground Level Elev. 3714.11'	Producing Formation Morrow		Pool Undes. Washington Ranch Morrow			Dedicated Acreage: 320 Acres	

1. Outline the acreage dedicated to the subject well by colored pencil or hatchure marks on the plat below.
2. If more than one lease is dedicated to the well, outline each and identify the ownership thereof (both as to working interest and royalty).
3. If more than one lease of different ownership is dedicated to the well, have the interests of all owners been consolidated by communitization, unitization, force-pooling, etc?

☐ Yes ☐ No If answer is "yes," type of consolidation _____

If answer is "no," list the owners and tract descriptions which have actually been consolidated. (Use reverse side of this form if necessary.) _____

No allowable will be assigned to the well until all interests have been consolidated (by communitization, unitization, forced-pooling, or otherwise) or until a non-standard unit, eliminating such interests, has been approved by the Commission.

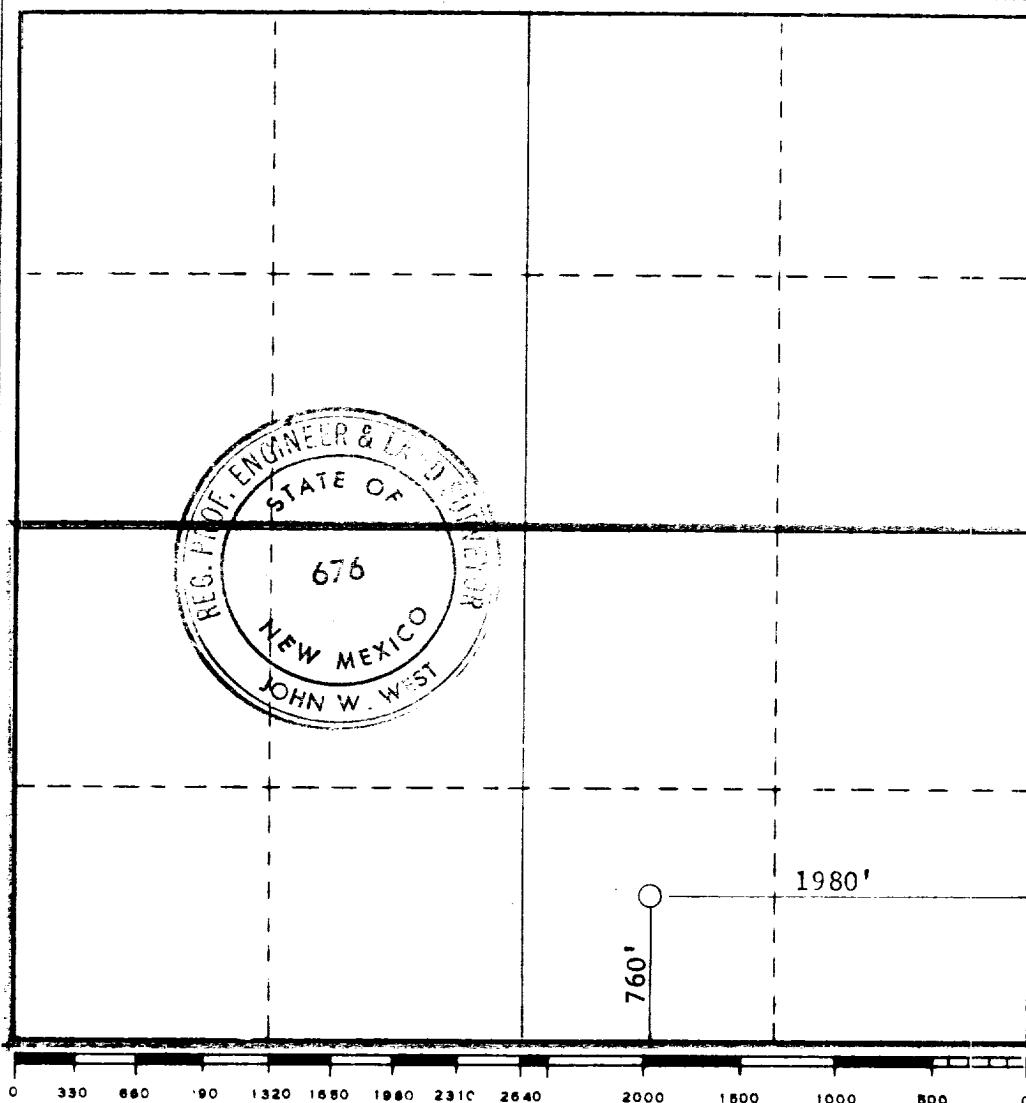

CERTIFICATION

I hereby certify that the information contained herein is true and complete to the best of my knowledge and belief.

Name _____
Position _____
Dist. Admin. Supervisor
Company _____
CITIES SERVICE OIL COMPANY
Date _____
5-3-72

RECEIVED
I, hereby certify that the well location shown on this plat was plotted from field notes of actual survey by me or under my supervision, and that the same is true and correct to the best of my knowledge and belief.

Date Surveyed _____
APRIL 27, 1972
Registered Professional Engineer and/or Land Surveyor
John W. West
Certificate No. _____
676

Government P#1

Mud Program for Government M#3

April 25, 1972

SUBJECT: Recommended Mud Program for Government M #3
1930' FNL, 1980' FEL, Section 27-25S-24E,
Eddy County, New Mexico

0--750': Surface casing 8 5/8" at 750': Drill with Gel fresh water mud flocculated with lime and treated with loss circulation material.

750' - 5000': Production casing 5 1/2" at 7200: Drill with fresh water treated with BENEX and CONDET to prevent solids build up. HYSEAL for seepage loss of fluid.

5000' -- 7200': Mud up with non-dispersed mud using AQUAGEL and FLOSAL for viscosity, DEXTRID and DRISPAC for fluid loss control, DESCO or CC-16 to control flow properties. Maintain following properties: viscosity 33--34 sec/1000 cc, weight 8.8 -- 9.0 lbs/gal., fluid loss below 10 cc. Increase viscosity and weight as hole conditions warrant.

RECEIVED
MAY 15 1972
U.S. DEPARTMENT OF THE INTERIOR
BUREAU OF LAND MANAGEMENT
ALBUQUERQUE, NEW MEXICO