

UNITED STATES
DEPARTMENT OF THE INTERIOR
GEOLOGICAL SURVEY

APPLICATION FOR PERMIT TO DRILL, DEEPEN, OR PLUG BACK

1. TYPE OF WORK

DRILL ☒DEEPEN ☐PLUG BACK ☐

2. TYPE OF WELL

OIL
WELL ☐GAS
WELL ☒

OTHER

SINGLE
ZONE ☐MULTIPLE
ZONE ☐

3. NAME OF OPERATOR

Cities Service Oil Company ✓

RECEIVED

4. ADDRESS OF OPERATOR

Box 4900 - Midland, Texas 79701

JUL 25 1973

5. LOCATION OF WELL. Report location clearly and in accordance with any State requirements.*

At section

1430' PSL & 660' PWL of Sec. 26-T258-R24E

At proposed production zone

Same as above

D. D. C.

ARTESIA, OFFICE

6. DISTANCE IN MILES AND DIRECTION FROM NEAREST TOWN OR POST OFFICE*

Approx. 9-1/2 miles SW of White City, New Mexico

7. DISTANCE FROM PROPOSED*

LOCATION TO NEAREST

PROPERTY OR LEASE LINE, FT.

(Also to nearest dug line, if any)

660' West

8. NO. OF ACRES IN LEASE

320

9. DISTANCE FROM PROPOSED LOCATION*

TO NEAREST WELL, DRILLING, COMPLETED,
OR APPLIED FOR, ON THIS LEASE, FT.

10. PROPOSED DEPTH

7200

11. NO. OF ACRES ASSIGNED
TO THIS WELL

320

12. ROTARY OR CABLE TOOLS

Rotary

13. ELEVATIONS (Show whether DF, RT, GR, etc.)

3675' GR

14. APPROX. DATE WORK WILL START*

8-15-73

15. PROPOSED CASING AND CEMENTING PROGRAM

SIZE OF HOLE	SIZE OF CASING	WEIGHT PER FOOT	SETTING DEPTH	QUANTITY OF CEMENT
17-1/2"	13-3/8"	48#	890'	Circulate
7-1/8"	5-1/2"	14 & 15.5#	7200'	350 Sacks

It is proposed to drill to a T.D. of 7200' and test the Strawn and Morrow formations.

The blowout prevention program is as follows:

1. One set of blind rams.
2. One set of drill pipe rams.
3. One Hydrill.

* 20" casing will be set @ 30' w/Rathole machine and cemented with Redimix. A 12-1/4" hole will be drilled from 890' - 5000' and if conditions dictate 8-5/8" OD 24# casing will be set and cemented at this depth with 1700 sacks of cement.

16. ABOVE SPACE DESCRIBE PROPOSED PROGRAM: If proposal is to deepen or plug b. well. If proposal is to drill or deepen directionally, give pertinent data on subsurface program, if any.

17. Give data on present productive zone and proposed new productive locations and measured and true vertical depths. Also blowout

18. SIGNATURE _____ TITLE Region Oper. Mgr.

DATE July 18, 1973

(This space for Federal or State office use)

PERMIT NO.

APPROVAL DATE

DATE

APPROVED

CONDITIONS OF APPROVAL, IF ANY:

JUL 19 1973

H. L. BECKMAN
ACTING DISTRICT ENGINEERTHIS APPROVAL IS RESCINDED IF OPERATIONS
ARE NOT COMMENCED WITHIN 3 MONTHS.
OCT 19 1973

*See Instructions

DECLARED WATER BASH

CEMENT BEHIND THE

CASING MUST BE CIRCULATED

NOTIFY USGS IN SUFFICIENT TIME TO
WITNESS CEMENTING THE CASING.RECEIVED
JUL 19 1973
U. S. GEOLOGICAL SURVEY
ARTESIA, NEW MEXICOCompliance with well Control
Requirements dated 6-22-73 attached



United States Department of the Interior

GEOLOGICAL SURVEY

P. O. Drawer U
Artesia, New Mexico 88210

June 22, 1973

NOTICE

DRILLING WELL CONTROL REQUIREMENTS FOR DEEP WELLS DRILLED ON FEDERAL OIL AND GAS LEASES IN THE ARTESIA DISTRICT

The following requirements are established in accordance with 30 CFR 221.24, 221.36, and 221.37. Blowout preventer equipment, choke equipment, drilling fluid characteristics, drilling fluid monitors, and the conduct of drilling procedures shall be such as are necessary to prevent the blowout of any well. In addition to all other applicable rules, regulations, and accepted good operating practices, drilling shall be in accordance with the following safety requirements:

1. After setting the 13 3/8" casing string and before drilling into the Welp ramp formation, the blowout preventers and related control equipment shall be pressure tested to rated working pressures by an independent service company. Any equipment failing to test satisfactorily shall be repaired or replaced. This office should be notified in sufficient time for a representative to witness the tests and shall be furnished a copy of the pressure test report. In addition, the pipe rams and bag-type preventer shall be actuated at least once each 24 hours and the blind rams each time the drill pipe is out of the hole.
2. Accumulators shall maintain a pressure capacity reserve at all times to provide for repeated operation of hydraulic preventers.
3. A drill string safety valve in the open position shall be maintained on the rig floor at all times while drilling operations are being conducted.
4. Blowout prevention drills shall be conducted as necessary to insure that each drilling crew is properly trained to carry out emergency duties.
5. Mud system monitoring equipment, with derrick floor indicators and visual and audio alarms, shall be installed and operating before

drilling into the Walpamp
and used until production casing is run and cemented. Monitoring
equipment shall consist of the following:

- (1) A recording pit level indicator to determine pit volume gains and losses.
 - (2) A mud volume measuring device for accurately determining mud volume necessary to fill the hole on trips.
 - (3) A flow sensor on the flow-line to warn of any abnormal mud returns from the well.
6. When coming out of the hole with drill pipe, the annulus shall be filled with mud before the mud level drops below 150 feet. The volume of mud required to fill the hole shall be watched, and any time there is an indication of swabbing, or influx of formation fluids, proper blowout prevention precautions must be taken. The mud shall not be circulated and conditioned except on or near bottom, unless well conditions prevent running the pipe to bottom.
7. A copy of these requirements shall be posted on the rig floor or in the dog house during the drilling of the well.

James A. Knauf
District Engineer

Lease No. NM 0456187
Well No. 1 - Government Q
Drillsite 1980/S 660/W 26-25-24
Depth 7260' Measured
Approved 7-19-73

NEW MEXICO OIL CONSERVATION COMMISSION
WELL LOCATION AND ACREAGE DEDICATION PLAT

Form No. 1
Superseded by Form No. 1A

All distances must be from the outer boundaries of the Section

CITIES SERVICE OIL COMPANY			Lease		Acres
			GOVLT.	"G"	1
Section	Range	Township	Block	Lot	
L	24	25 SOUTH	24 EAST	ENDY	
Section 1973					
Distance from the SOUTH line and		Distance from the WEST line and			
3675'		660			
Morrow		Undes. Washington Ranch Morrow		320	

1. Outline the acreage dedicated to the subject well by colored pencil or tachure marks on the plat below
2. If more than one lease is dedicated to the well, outline each and identify the owner(s) of each (name, address, and locality).
3. If more than one lease of different ownership is dedicated to the well, have the interests of all owners been consolidated by communitization, unitization, force-pooling, etc?

☒ Yes ☐ No If answer is "yes," type of consolidation Force Pooling (Hearing on June 27, 1973)

If answer is "no," list the owners and tract descriptions which have actually been consolidated (if so reverse side of this form if necessary) _____

Are all wells to be assigned to the well until all interests have been consolidated (by communitization, unitization, force-pooling, or otherwise) or until a non-standard unit, eliminating such interests, has been approved by the Commission? _____

CITIES SERVICE BLACK RIVER CORP. ROY G. BARTON, JR. (UNLEASED)	4/6 1/6 1/6	INTERESTS OF PARTICIPATING COMPANIES FOR THIS WELL ARE AS FOLLOWS: CITIES SERVICE 79.1666%
M.P. GRACE C.S.O.	12.5000% 4.1667% 4.1667%	M.P. GRACE BLACK RIVER CORP. R.G. BARTON, JR.
100.0000%		

RECEIVED
 JUL 19 1973
 U.S. GEOLOGICAL SURVEY
 ARTESIA, NEW MEXICO

CERTIFICATION

I hereby certify that the information contained herein is true and complete to the best of my knowledge and belief.

E. P. ...

Region Operation Mgr.

CITIES SERVICE OIL COMPANY

July 18, 1973

I hereby certify that the information contained herein is true and complete to the best of my knowledge and belief.

July 13, 1973

John ...



CITIES SERVICE OIL COMPANY

Box 4906
Midland, Texas 79701
Telephone: 915 684-7131

July 18, 1973

United States Department of the Interior
Geological Survey
Artesia, New Mexico 88210

Re: Application to Drill
Government Q No. 1,
Washington Ranch Pool,
Eddy County, New Mexico

Gentlemen:

Cities Service Oil Company respectfully requests permission to drill the No. 1 Government Q on oil and gas lease New Mexico 0456187 located 1980' FSL and 660' FWL Section 26-25S-24E, N.M.P.M. Eddy County, New Mexico.

The well was approved on May 25, 1972. It was not cased within ninety days and your original approval was withdrawn by letter dated September 27, 1972.

It is now our intent to drill the well and in support of this application, the following data is submitted:

1. Form 9-3310, Application for Permit to Drill
2. Form C-102, Well Location and Acreage Dedication Plat
3. Development Plan which includes the following information:
 - a. Plat showing existing roads, planned access road and nearby wells.
 - b. Plat showing distances from location of Government Q No. 1 to Rattlesnake Springs, Ralph Hood's house, Ralph Hood's fresh water pond and the Washington Ranch Airstrip.
 - c. Plat showing location layout, including position of the rig, mud tanks, reserve pit, pipe racks, etc.
 - d. Blow out preventer diagram showing arrangement of BOP stack.
 - e. Plat showing hook up of BOP's and choke manifold.
 - f. Summary of mud program.

The location falls in an irrigated alfalfa field. It is planned to rig up with the V-door to the east and reserve pit to the north.

Government Q No. 1 is a S.E. offset to Cities Service Oil Co.'s Government M No. 3 and a N.E. offset to Government N No. 2. Both wells are Morrow gas producers flowing to El Paso Natural Gas Company's gas gathering system.

RECEIVED
JUL 19 1973
U. S. GEOLOGICAL SURVEY
ARTESIA, N. M.

July 18, 1973

The planned access road will come in from the south off the blacktopped county road. It will border the east side of Ralph Hood's irrigated alfalfa field 1980' then turn west 660' into the location.

Mr. Ralph Hood is the surface landowner. He lives 2530' N.W. of the location. His address is Pine Springs Route, Carlsbad, New Mexico and his telephone number is 505/785-2307. It is planned to buy water for drilling the well from Mr. Hood and we are still negotiating a damage settlement for the road and location in his alfalfa crop.

If completed as a Morrow gas producer, the Government Q No. 1 will not require a tank battery. A production unit will be set 150' from the well on the drilling pad, and a 100 barrel tank will be set on the same drilling pad to collect small volumes of connate water produced with the gas. The gas purchaser will set a meter run nearby and downstream from the production unit.

There is a possibility of lost returns and the proposed casing program is somewhat flexible depending upon hole conditions. It will consist of:

20' at 30' set with rat hole machine and cemented to base of cellar with Redi-Mix.

13-3/8" at 890' set in 17-1/2" hole with cement circulated.

A 12-1/4" hole will be drilled out from under the 13-3/8" to 5000'. If lost circulation has not developed, the hole size will be reduced at 5000' to 7-7/8" and drilled to TD 7200'. A full string of 5-1/2" casing will be run to TD 7200' and cemented back to 5000'.

If lost circulation is a problem under the 13-3/8", the 12-1/4" hole will be drilled to 5000' and a string of 8-5/8" casing will be run to 5000' and cemented up to the loss zone. Underneath the 8-5/8", a 7-7/8" hole will be drilled to TD 7200' and a 5-1/2" liner will be run and cemented to tie back into the 8-5/8" casing.

If the well is completed as a producer, the pits will be backfilled and levelled, debris removed, and surface equipment fenced. If it is a dry hole, the well will be plugged as per United States Geological Survey requirements, the pits backfilled and levelled and all debris removed.

If further information is needed to evaluate this request, please contact me at the above address.

Yours very truly,

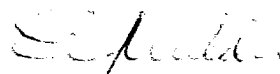

E. Y. Wilder
Operations Manager

EYW/lis

Attachments

RECEIVED
JUL 19 1973
U. S. GEOLOGICAL SURVEY
ARTESIA, NEW MEXICO

GOVERNMENT "Q" No. 1 LOCATOR

1980' FSL, 660' FWL Sec 26-25S-24E

EDDY COUNTY, NEW MEXICO

SCALE 2" = 1 MILE

R24E

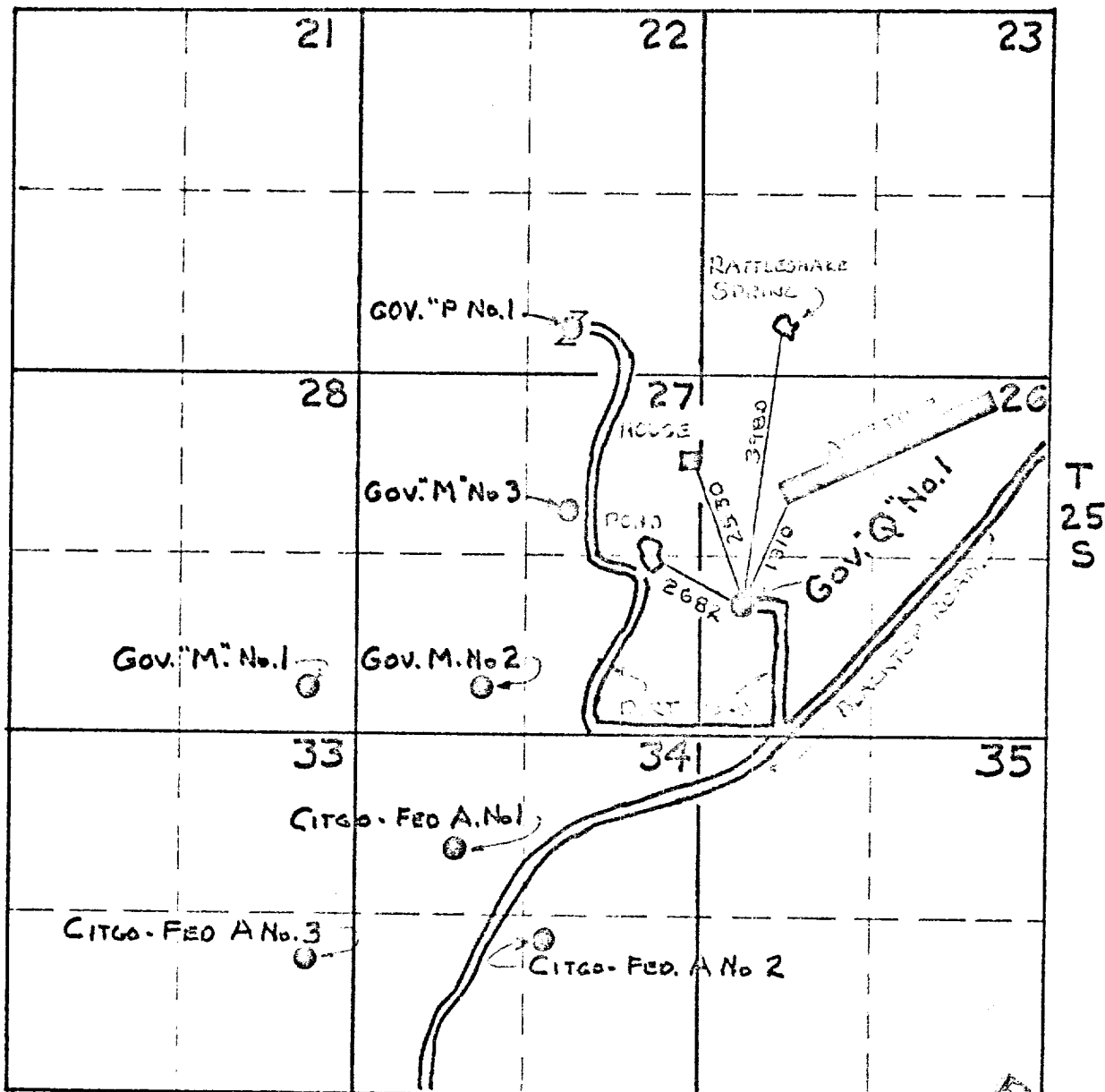

RECEIVED
JUL 19 1973
U. S. GEOLOGICAL SURVEY
FEDERAL BUREAU OF RESEARCH

GOVERNMENT "Q" NO. 1 LOCATION

1980' FSL, 660' FWL SEC. 26-25S-24E.

EDDY COUNTY, NEW MEXICO

RIG UP WITH Y-DOOR TO EAST
RESERVE PIT TO NORTH —

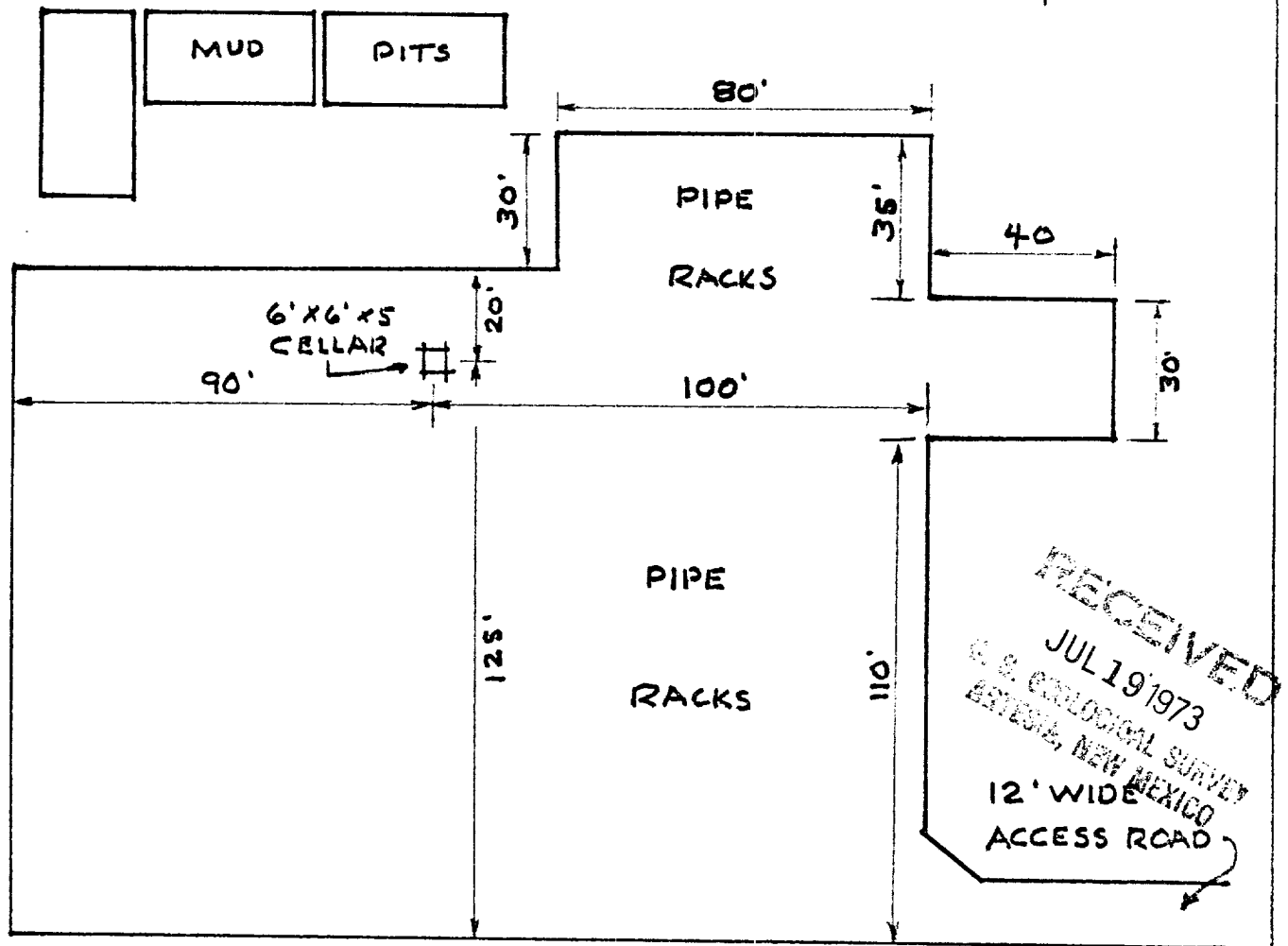
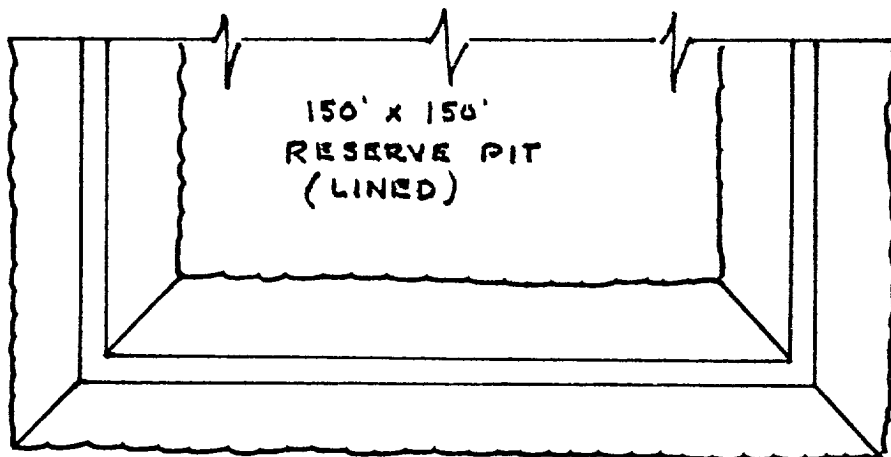

Government Q No. 1

1980' FSL, 660' FWL Section 26, T25S, R24E
Eddy County, New Mexico

Hole Size

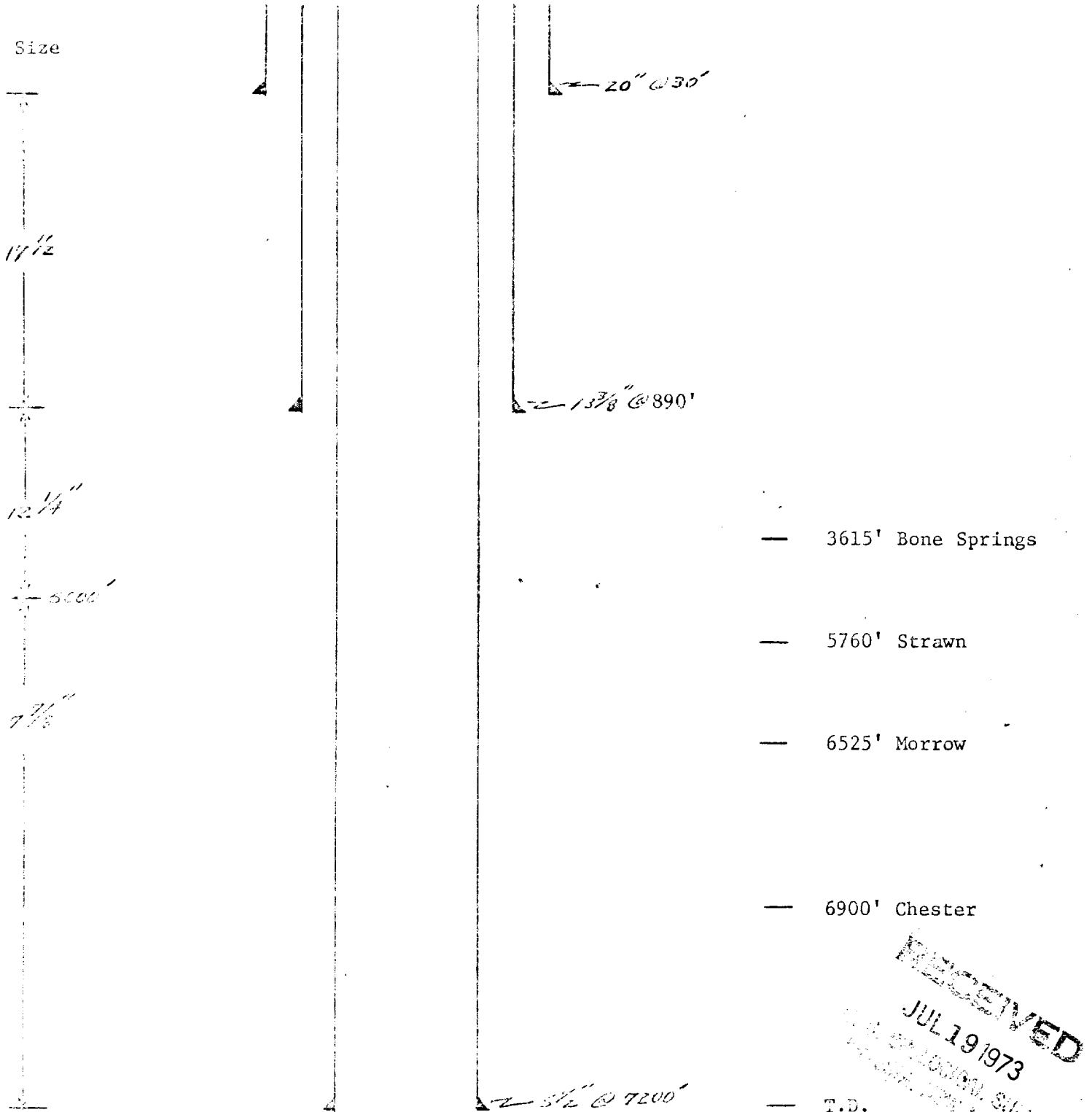

1. 1/2" NPT 2" ADJ.
 2. 1/2" NPT 2" ADJ.

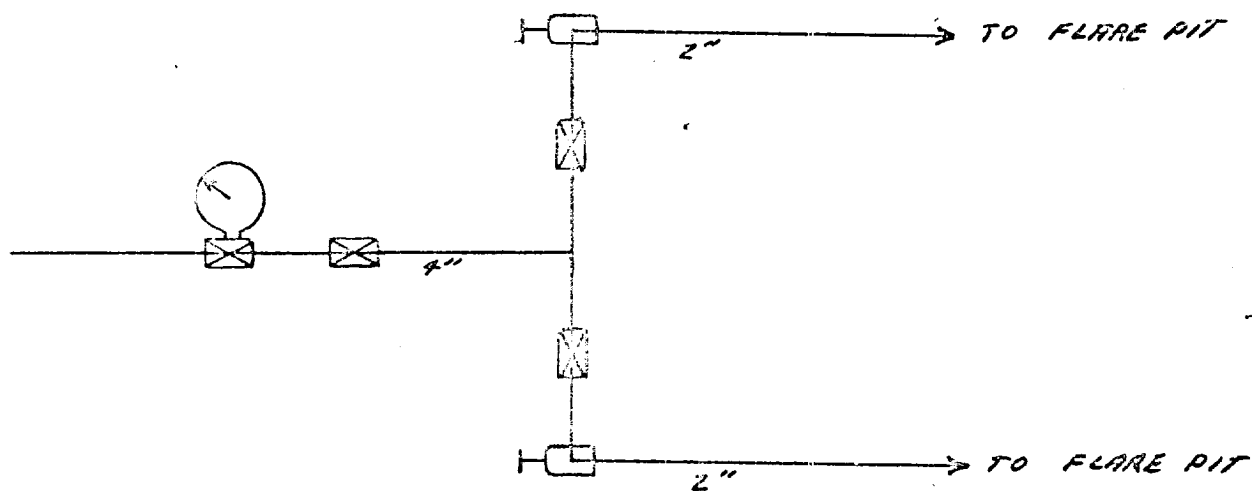

 ADJUSTABLE CHOKE

 3000 # W.P. 2" CAMERON TYPE F GATE VALVE OR EQV.

RECEIVED
 JUL 19 1973
 U.S. GEOLOGICAL SURVEY
 ARTESIAN, NEW MEXICO

FLOW LINE PREVENTER IN WELLBORES

11-11-73 M-3000 3000

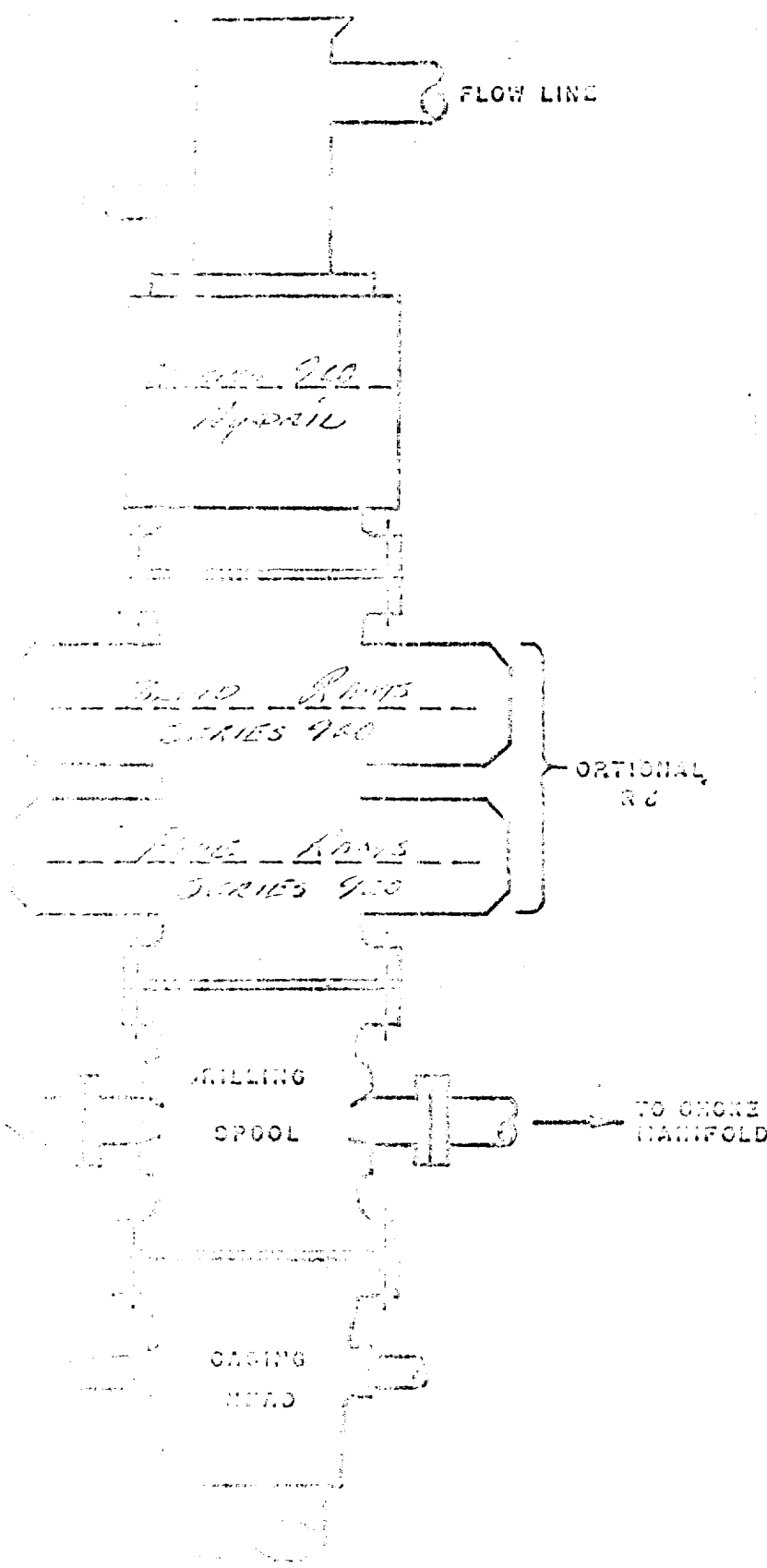

SUFFICIENT ACCUMULATOR VOLUME SHALL BE AVAILABLE TO OPERATE WITH THE FLOW PREVENTER AND PIPE RAIL PREVENTER WITH A SHUT-ACTION THROUGH THE FOLLOWING STEPS: CLOSE-OPEN-CLOSE.

RECEIVED
JUL 19 1973
U. S. DEPARTMENT OF THE ARMY
ARMED FORCES

GOVERNMENT Q #1 MUD PROGRAM
1980' FSL, 660' FWL Section 26, T25S, R24E
Eddy County, New Mexico

Depth 0-890'

Drill with fresh water spud mud 8.5-9.0 PPG.

Depth 890-5400'

Drill with fresh water, M.W. 8.5-9.0 PPG, Vis. 28-35 sec./qt. Add
lost circulation material as needed.

Depth 5500-6400'

Drill with fresh water mud, M.W. 8.5-9.5 PPG, Vis. 30-35 sec./qt.

Depth 6400-7200'

Fresh water mud with water loss control, M.W. 8.5-9.5 PPG, Vis.
30-35 sec./qt., F.L. 6-9 cc.

BB/eh
7/17/73

RECEIVED
JUL 19 1973
U.S. GEOLOGICAL SURVEY
WASHINGTON, D.C. 20506