

RECEIVED

NEW MEXICO OIL CONSERVATION COMMISSION

JUL 5 1972 30-015-20700

Form C-101  
Revised 1-1-65

AMENDED APPLICATION  
North footage changed because of  
topography

O. C. C.

5A. Indicate Type of Lease

STATE ☐ FEE ☒

5. State Oil & Gas Lease No.

7. Unit Agreement Name

8. Farm or Lease Name

Thurman

9. Well No.

1

10. Field and Pool, or Wildcat

Wildcat

12. County

Eddy

19. Proposed Depth

8500

19A. Formation

Devonian

20. Rotary or C.T.

Rotary

21. Elevations (Show whether DF, RT, etc.)

3760 Est.-To be corrected

21A. Kind & Status Plug. Bond

\$10,000 Blanket

21B. Drilling Contractor

Rowan Drilling Co.

22. Approx. Date Work will start

June 30, 1972

PROPOSED CASING AND CEMENT PROGRAM

SIZE OF HOLE	SIZE OF CASING	WEIGHT PER FOOT	SETTING DEPTH	SACKS OF CEMENT	EST. TOP
11	8-5/8	24	750	350 sx.	Circulate
7-7/8	5-1/2	14 - 15.5	TD	300 sx.	6000

It is proposed to drill the 11 inch hole to 750 feet which should be 200 feet into the Delaware formation at which time the 8-5/8 inch casing will be run and cement circulated. After WOC a minimum of 18 hours the casing will be tested to 1000 psi. If test OK, will drill with fresh water the 7-7/8 inch hole to approximately 7500 feet and then change over to a 8.6#/gal, 6.0 c.c. water loss mud system and drill to TD. A double ram BOP with a Hydril BOP will be used during drilling operations. At total depth, if well test appear productive, the 5-1/2 inch casing will be run with cement sufficient to return to approximately 6000 feet from the surface.

APPROVAL VALID  
FOR 90 DAYS UNLESS  
DRILLING COMMENCED,  
EXPIRES 10-17-72

IN ABOVE SPACE DESCRIBE PROPOSED PROGRAM; IF PROPOSAL IS TO DEEPEN OR PLUG BACK, GIVE DATA ON PRESENT PRODUCTION ZONE AND PROPOSED NEW PRODUCTION ZONE. GIVE BLOWOUT PREVENTER PROGRAM, IF ANY.

I hereby certify that the information above is true and complete to the best of my knowledge and belief.

Signed J. T. Berry Title Agent Date July 3, 1972

(This space for State Use)

APPROVED BY W. A. Gressett TITLE OIL AND GAS INSPECTOR DATE JUL 17 1972

CONDITIONS OF APPROVAL, IF ANY:  
Cement must be circulated to  
surface behind 8 7/8" casing  
Notify N.M.O.C.C. in sufficient  
time to witness cementing  
the 8 7/8" casing

**NEW MEXICO OIL CONSERVATION COMMISSION  
WELL LOCATION AND ACREAGE DEDICATION PLAT**

Form C-102  
Supersedes C-128  
Effective 1-1-65

All distances must be from the outer boundaries of the Section.

Operator <b>BLACK RIVER CORP.</b>			Lease <b>THURMAN</b>		Well No. <b>1</b>
Unit Letter <b>C</b>	Section <b>21</b>	Township <b>26 SOUTH</b>	Range <b>24 EAST</b>	County <b>EDDY</b>	
Actual Footage Location of Well: <b>360</b> feet from the <b>NORTH</b> line and <b>1980</b> feet from the <b>WEST</b> line					
Ground Level Elev. <b>3773.5'</b>	Producing Formation <b>DEVONIAN</b>	Pool <b>WILDCAT</b>		Dedicated Acreage: <b>40</b> Acres	

1. Outline the acreage dedicated to the subject well by colored pencil or hachure marks on the plat below.
2. If more than one lease is dedicated to the well, outline each and identify the ownership thereof (both as to working interest and royalty).
3. If more than one lease of different ownership is dedicated to the well, have the interests of all owners been consolidated by communitization, unitization, force-pooling, etc?

☐ Yes ☐ No If answer is "yes," type of consolidation \_\_\_\_\_

If answer is "no," list the owners and tract descriptions which have actually been consolidated. (Use reverse side of this form if necessary.) \_\_\_\_\_

No allowable will be assigned to the well until all interests have been consolidated (by communitization, unitization, forced-pooling, or otherwise) or until a non-standard unit, eliminating such interests, has been approved by the Commission.

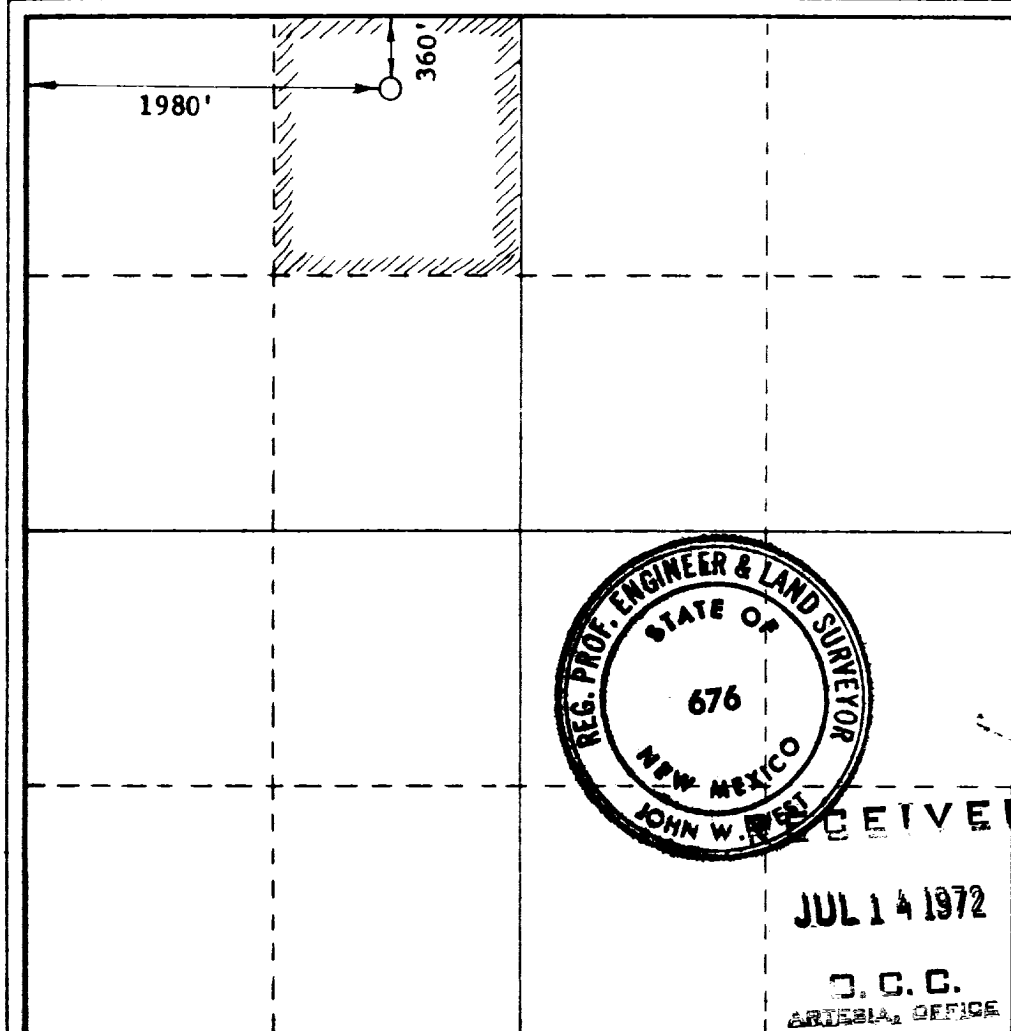

**CERTIFICATION**

I hereby certify that the information contained herein is true and complete to the best of my knowledge and belief.

Name  
*John W. West*

Position  
**AGENT**

Company  
**BLACK RIVER CORP.**

Date  
**JULY 5, 1972**

**RECEIVED**  
I hereby certify that the well location shown on this plat was located from field notes of actual surveys made by me or under my supervision and that the same is true and correct to the best of my knowledge and belief.  
**U. S. GEOLOGICAL SURVEY ARTESIA, NEW MEXICO**

Date Surveyed  
**JULY 4, 1972**

Registered Professional Engineer and/or Land Surveyor

*John W. West*  
Certificate No. **676**

0 330 660 990 1320 1650 1980 2310 2640 2000 1600 1000 500 0

RECEIVED

WELL LOCATION AND ACREAGE DEDICATION PLAT

JUL 5 1972

Form C-102  
Supersedes C-128  
Effective 1-1-65

All distances must be from the outer boundaries of the Section.

Operator <b>Black River Corporation</b>		Lease <b>Thurman</b>		O.C.C. ARTESIA, OFFICE		Well No. <b>1</b>
Unit Letter <b>C</b>	Section <b>21</b>	Township <b>26S</b>	Range <b>24E</b>	County <b>Eddy</b>		
Actual Footage Location of Well: <b>330 360</b> feet from the <b>North</b> line and <b>1980</b> feet from the <b>West</b> line						
Ground Level Elev. <b>3760 Est.</b>	Producing Formation <b>Devonian</b>		Pool <b>Wildcat</b>		Dedicated Acreage: <b>40</b> Acres	

1. Outline the acreage dedicated to the subject well by colored pencil or hachure marks on the plat below.
2. If more than one lease is dedicated to the well, outline each and identify the ownership thereof (both as to working interest and royalty).
3. If more than one lease of different ownership is dedicated to the well, have the interests of all owners been consolidated by communitization, unitization, force-pooling, etc?

☐ Yes ☐ No If answer is "yes," type of consolidation \_\_\_\_\_

If answer is "no," list the owners and tract descriptions which have actually been consolidated. (Use reverse side of this form if necessary.) \_\_\_\_\_

No allowable will be assigned to the well until all interests have been consolidated (by communitization, unitization, forced-pooling, or otherwise) or until a non-standard unit, eliminating such interests, has been approved by the Commission.  
AMENDED APPLICATION

Black River Corporation 0 1			
L. A. Thurman et al			

CERTIFICATION	
I hereby certify that the information contained herein is true and complete to the best of my knowledge and belief.	
Name <i>J. T. Berry</i>	J. T. Berry
Position <i>Agent</i>	Agent
Company <b>Black River Corporation</b>	
Date <b>July 3, 1972</b>	
I hereby certify that the well location shown on this plat was plotted from field notes of actual surveys made by me or under my supervision, and that the same is true and correct to the best of my knowledge and belief.	
Date Surveyed	
Registered Professional Engineer and/or Land Surveyor	
Certificate No.	

