

(May 1963)

UNITED STATES  
DEPARTMENT OF THE INTERIOR  
GEOLOGICAL SURVEY

(Other instructions on  
reverse side)

Budget Bureau No. 12 R1425.

30-611-20710

5. LEASE DESIGNATION AND SERIAL NO.

NM- 0525452-A

6. IF INDIAN, ALLOTTEE OR TRIBE NAME

7. UNIT AGREEMENT NAME

8. FARM OR LEASE NAME

Cities ~~Delaware~~ Federal

9. WELL NO.

10. FIELD AND POOL, OR WILDCAT

Wildcat

11. SEC., T., R., M., OR BLK.  
AND SURVEY OR AREA

Sec. 3, T26S, R24E

12. COUNTY OR PARISH

Eddy

13. STATE

N. M.

1a. TYPE OF WORK

DRILL ☒

DEEPEN ☐

PLUG BACK ☐

b. TYPE OF WELL

OIL  
WELL ☒

GAS  
WELL ☐

OTHER

SINGLE  
ZONE ☒

MULTIPLE  
ZONE ☐

2. NAME OF OPERATOR

Black River Corporation

3. ADDRESS OF OPERATOR

620 Commercial Bank Tower Midland, Texas 79701

4. LOCATION OF WELL (Report location clearly and in accordance with any State requirements.)\*

At surface

2121' FNL & ~~1650~~ FWL of Sec. 3

At proposed prod. zone

Same

14. DISTANCE IN MILES AND DIRECTION FROM NEAREST TOWN OR POST OFFICE\*

12 Miles SW of White's City

15. DISTANCE FROM PROPOSED\*  
LOCATION TO NEAREST  
PROPERTY OR LEASE LINE, FT.

(Also to nearest drlg. unit line, if any)

660

16. NO. OF ACRES IN LEASE

+ 400

17. NO. OF ACRES ASSIGNED  
TO THIS WELL

40

18. DISTANCE FROM PROPOSED LOCATION\*  
TO NEAREST WELL, DRILLING, COMPLETED,  
OR APPLIED FOR, ON THIS LEASE, FT.

141 from Morrow

Well

19. PROPOSED DEPTH

2,000

20. ROTARY OR CABLE TOOLS

Rotary

21. ELEVATIONS (Show whether DF, RT, Gk, etc.)

3725 GR est - to be corrected

22. APPROX. DATE WORK WILL START\*

July 15, 1972

23. PROPOSED CASING AND CEMENTING PROGRAM

SIZE OF HOLE	SIZE OF CASING	WEIGHT PER FOOT	SETTING DEPTH	QUANTITY OF CEMENT
11	8-5/8	24	700	350 SX
7-7/8	4-1/2	9.5	TD	200 SX

It is proposed to drill the 11 inch hole to 750 feet which should be 200 feet into the Delaware formation at which time the 8-5/8 inch casing will be run and cement circulated. After WOC a minimum of 18 hours the casing will be tested to 1000 psi. If test OK, will drill with fresh water the 7-7/8 inch hole to approximately 1300 feet and then change over to a 8.6#/gal, 6.0 c.c. water loss mud system and drill to TD. A double ram BOP will be used during drilling operations. At total depth, if well test appear productive, the 4-1/2 inch casing will be run with cement sufficient to return to approximately 1000 feet from the surface.

RECEIVED  
JUL 7 1972  
U. S. GEOLOGICAL SURVEY  
ARTIFICIAL NEW MEXICO

IN ABOVE SPACE DESCRIBE PROPOSED PROGRAM: If proposal is to deepen or plug back, give data on present productive zone and proposed new productive zone. If proposal is to drill or deepen directionally, give pertinent data on subsurface locations and measured and true vertical depths. Give blowout preventer program, if any.

SIGNED J.T. Berry TITLE Agent DATE July 3, 1972

(This space for Federal or State office use)

PERMIT NO.

APPROVED DATE

APPROVED  
JUL 17 1972  
H. L. BEEKMAN  
ACTING DISTRICT ENGINEER

THIS APPROVAL IS VALID IF OPERATIONS  
ARE NOT COMMENCED WITHIN 3 MONTHS.  
EXPIRES OCT 17 1972  
\*See Instructions On Reverse Side

NEW MEXICO OIL CONSERVATION COMMISSION  
WELL LOCATION AND ACREAGE DEDICATION PLAT

Form No. 1  
Supersedes O.C.C. Form No. 1, 1965

All distances must be from the outer boundaries of the Section

Operator <b>BLACK RIVER CORPORATION</b>			Lease <b>CITIES 3 FEDERAL</b>		Acres <b>3</b>
Unit Letter <b>F</b>	Section <b>3</b>	Township <b>26 SOUTH</b>	Range <b>24 EAST</b>	County <b>EDDY</b>	
Actual Footage Location of Well: <b>2121</b> feet from the <b>NORTH</b> line and <b>1650</b> feet from the <b>WEST</b> line					
Ground Level Elev. <b>DELAWARE</b>	Producing Formation <b>WILDCAT</b>	Pool <b>54.73</b>		Estimated Acreage	

1. Outline the acreage dedicated to the subject well by colored pencil or hatchure marks on the plat below
2. If more than one lease is dedicated to the well, outline each and identify the ownership thereof (both as to working interest and royalty).
3. If more than one lease of different ownership is dedicated to the well, have the interests of all owners been consolidated by communitization, unitization, force-pooling, etc?

☐ Yes ☐ No If answer is "yes," type of consolidation \_\_\_\_\_

If answer is "no," list the owners and tract descriptions which have actually been consolidated (Use reverse side of this form if necessary.) \_\_\_\_\_

No allowable will be assigned to the well until all interests have been consolidated (by communitization, unitization, forced-pooling, or otherwise) or until a non-standard unit, eliminating such interests, has been approved by the Commission.

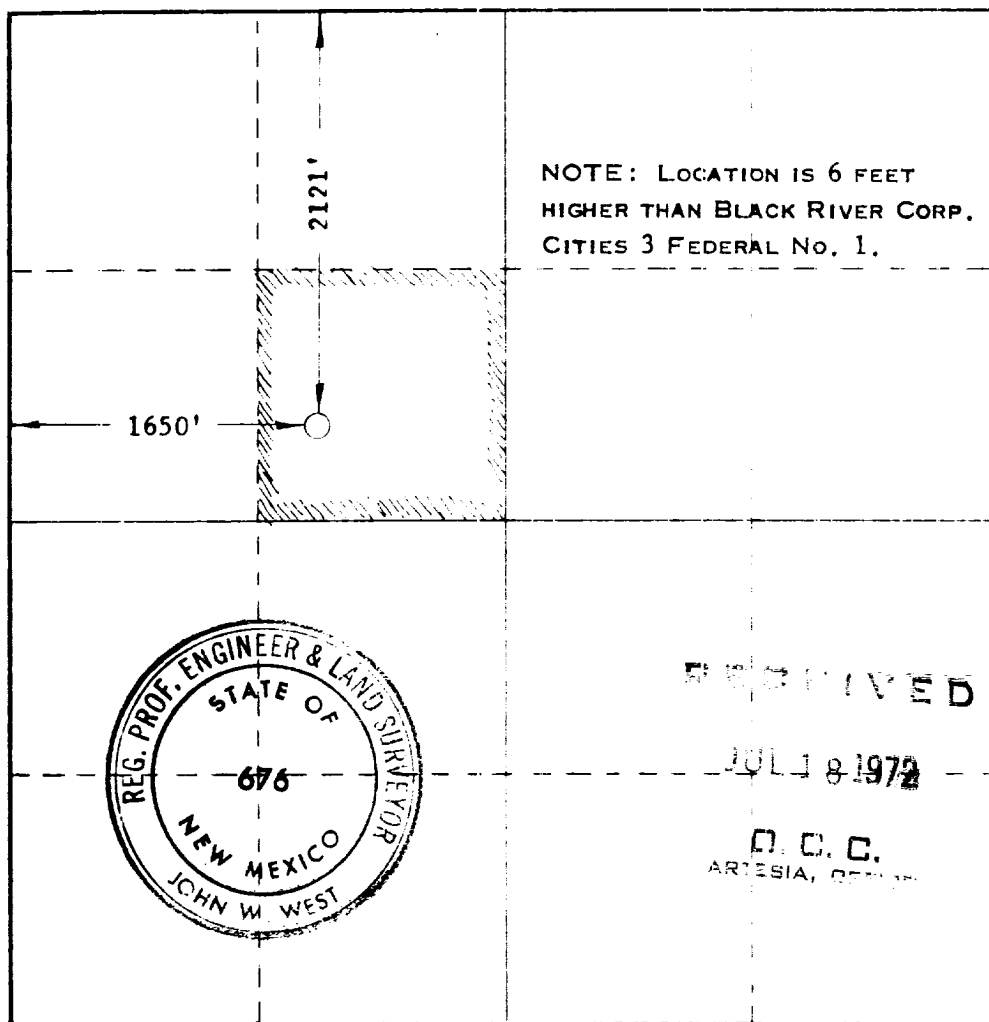

CERTIFICATION

I hereby certify that the information contained herein is true and complete to the best of my knowledge and belief.

Name  
**JOHN W. WEST**  
Title  
**AGENT**  
Company  
**BLACK RIVER CORPORATION**  
Date  
**JULY 14, 1972**

I hereby certify that the well location shown on this plat was obtained from field notes of actual surveys made by me or under my supervision and that the same is true and correct to the best of my knowledge.  
**RECEIVED**  
**JUL 17 1972**  
**U.S. GEOLOGICAL SURVEY**  
**ARTESIA, NEW MEXICO**

Date Surveyed  
**JULY 14, 1972**  
Registered in the State of New Mexico  
Book \_\_\_\_\_ Page \_\_\_\_\_  
Certification No.  
**676**

NEW MEXICO OIL CONSERVATION COMMISSION  
WELL LOCATION AND ACREAGE DEDICATION PLAT

Form C-102  
Supersedes C-128  
Effective 1-1-65

All distances must be from the outer boundaries of the Section.

Operator <b>Black River Corporation</b>			Lease <b>"3"</b>		Well No. <b>3</b>
Unit Letter	Section <b>3</b>	Township <b>T26S</b>	Range <b>24E</b>	County <b>Eddy</b>	
Actual Placement Location of Well: <b>1650</b> feet from the <b>West</b> line and <b>2121.1</b> feet from the <b>North</b> line of Sec 3					
Ground Level Elev. <b>3725 Est</b>	Producing Formation <b>Delaware</b>		Pool <b>Wildcat</b>		Dedicated Acreage: <b>40</b> Acres

1. Outline the acreage dedicated to the subject well by colored pencil or hatchure marks on the plat below.
2. If more than one lease is dedicated to the well, outline each and identify the ownership thereof (both as to working interest and royalty).
3. If more than one lease of different ownership is dedicated to the well, have the interests of all owners been consolidated by communitization, unitization, force-pooling, etc?

☐ Yes ☐ No If answer is "yes," type of consolidation \_\_\_\_\_

If answer is "no," list the owners and tract descriptions which have actually been consolidated. (Use reverse side of this form if necessary.) \_\_\_\_\_

No allowable will be assigned to the well until all interests have been consolidated (by communitization, unitization, forced-pooling, or otherwise) or until a non-standard unit, eliminating such interests, has been approved by the Commission.

Surveyor's Plat to follow

Black River Corporation 0525452			
0			
3			
US			
26 24			

CERTIFICATION

I hereby certify that the information contained herein is true and complete to the best of my knowledge and belief.

*[Signature]*  
J. T. Berry

Position  
Agent

Company  
Black River Corporation

Date  
July 5, 1972

I hereby certify that the well location shown on this plat is based on field notes of surveys made by me or under my supervision, and that the same is true and correct to the best of my knowledge and belief.

**RECEIVED**  
**JUL 7 1972**  
**U.S. GEOLOGICAL SURVEY**  
**ARTESIA, NEW MEXICO**

Date Surveyed

Registered Professional Engineer  
and/or Land Surveyor

Certificate No.

