

UNITED STATES
DEPARTMENT OF THE INTERIOR
GEOLOGICAL SURVEY

Copy to SF,
30-615-21000

APPLICATION FOR PERMIT TO DRILL, DEEPEN, OR PLUG BACK

1a. TYPE OF WORK
 DRILL DEEPEN PLUG BACK

b. TYPE OF WELL
 OIL WELL GAS WELL OTHER
 SINGLE ZONE MULTIPLE ZONE

2. NAME OF OPERATOR
 Midwest Oil Corporation

3. ADDRESS OF OPERATOR
 1500 Wilco Bldg. Midland, Texas

4. LOCATION OF WELL (Report location clearly and in accordance with any State requirements.)
 At surface 1980' FNL & 1980' FWL
 At proposed prod. zone same

14. DISTANCE IN MILES AND DIRECTION FROM NEAREST TOWN OR POST OFFICE*
 6 miles SE White City

15. DISTANCE FROM PROPOSED* LOCATION TO NEAREST PROPERTY OR LEASE LINE, FT. (Also to nearest drlg. unit line, if any)
 1980'

16. NO. OF ACRES IN LEASE
 1072.97

17. NO. OF ACRES ASSIGNED TO THIS WELL
 40

18. DISTANCE FROM PROPOSED LOCATION* TO NEAREST WELL, DRILLING, COMPLETED, OR APPLIED FOR, ON THIS LEASE, FT.
 1700'

20. ROTARY OR CABLE TOOLS

21. ELEVATIONS (Show whether DF, RT, GR, etc.)
 3643.06

22. APPROX. DATE WORK WILL START*
 immediately

5. LEASE DESIGNATION AND SERIAL NO.
 NM 0457116

6. IF INDIAN, ALLOTTEE OR TRIBE NAME

7. UNIT AGREEMENT NAME

8. FARM OR LEASE NAME
 Federal "O"

9. WELL NO.
 1

10. FIELD AND POOL, OR WILDCAT
 Wildcat

11. SEC., T., R., M., OR BLK. AND SURVEY OR AREA
 11-26S-25E

12. COUNTY OR PARISH
 Eddy

13. STATE
 N. Mex.

PROPOSED CASING AND CEMENTING PROGRAM

SIZE OF HOLE	SIZE OF CASING	WEIGHT PER FOOT	SETTING DEPTH	QUANTITY OF CEMENT
17 1/4"	13 3/8"	48#	400'	350 sx
7 7/8"	4 1/2"	9.5#	1700'	To be determined when TD reached

To drill with cable tool to 400'

Series 600 BOP equipment - Cameron - to be used when surface csg is set

RECEIVED
OCT 16 1973
U. S. GEOLOGICAL SURVEY
ARTESIA, NEW MEXICO

IN ABOVE SPACE DESCRIBE PROPOSED PROGRAM: If proposal is to deepen or plug back, give data on present productive zone and proposed productive zone. If proposal is to drill or deepen directionally, give pertinent data on subsurface locations and measured and true vertical depths. Give blowout preventer program, if any.

24. SIGNED Bonnie Husband TITLE Production Clerk DATE 10-12-73
 (This space for Federal or State office use) BH:ng 10-15-73

APPROVED
OCT 25 1973

THIS APPROVAL IS RESCINDED IF OPERATIONS ARE NOT COMMENCED WITHIN 3 MONTHS.
EXPIRES JAN 25 1974
See Instructions On Reverse Side

DECLARED WATER BASIN
CEMENT BEHIND THE CASING MUST BE CIRCULATED

SURFACE DEVELOPMENT PLAN

Midwest Oil Corporation
Federal "O" No. 1
1980' FNL & 1980' FWL
Sec. 11, T25S, R26E
Eddy County, New Mexico

1. Existing roads - See attached map.
2. Planned access roads - See attached plat.
3. Location of wells - No. 1 Federal "N" approximately 2 miles southwest.
4. Lateral roads to well locations - See attached map.
5. Tank batteries and flow lines will be located on well pad.
6. Water supply - Water to be supplied by trucks.
7. Waste disposal - All paper, metal, wood and other waste material will be collected and disposed of in a waste collection pit located northeast of the pad's edge. The waste pit will be covered when the drilling and completion operation is finalized.
8. Produced brine water will be collected in a metal tank & trucked to the nearest available salt water disposal facility.
9. Produced oil will be sold through the best available market in the area.
10. Location layout - See attached plat.
11. Restoration of surface - Reserve pits will be levelled & smoothed after drying. The area will be cleaned of all waste & restored as nearly as possible to its original contour.
12. Blowout preventer equipment will be installed when surface casing is set.

Well to be drilled with water.

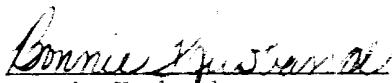
Bonnie Husband

Production Clerk

10-12-73

PAD DESIGN
#1 Federal "0"

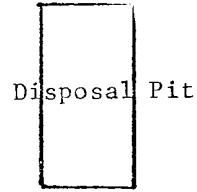

100'

100'

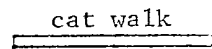
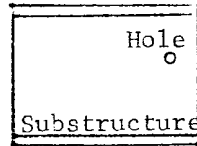
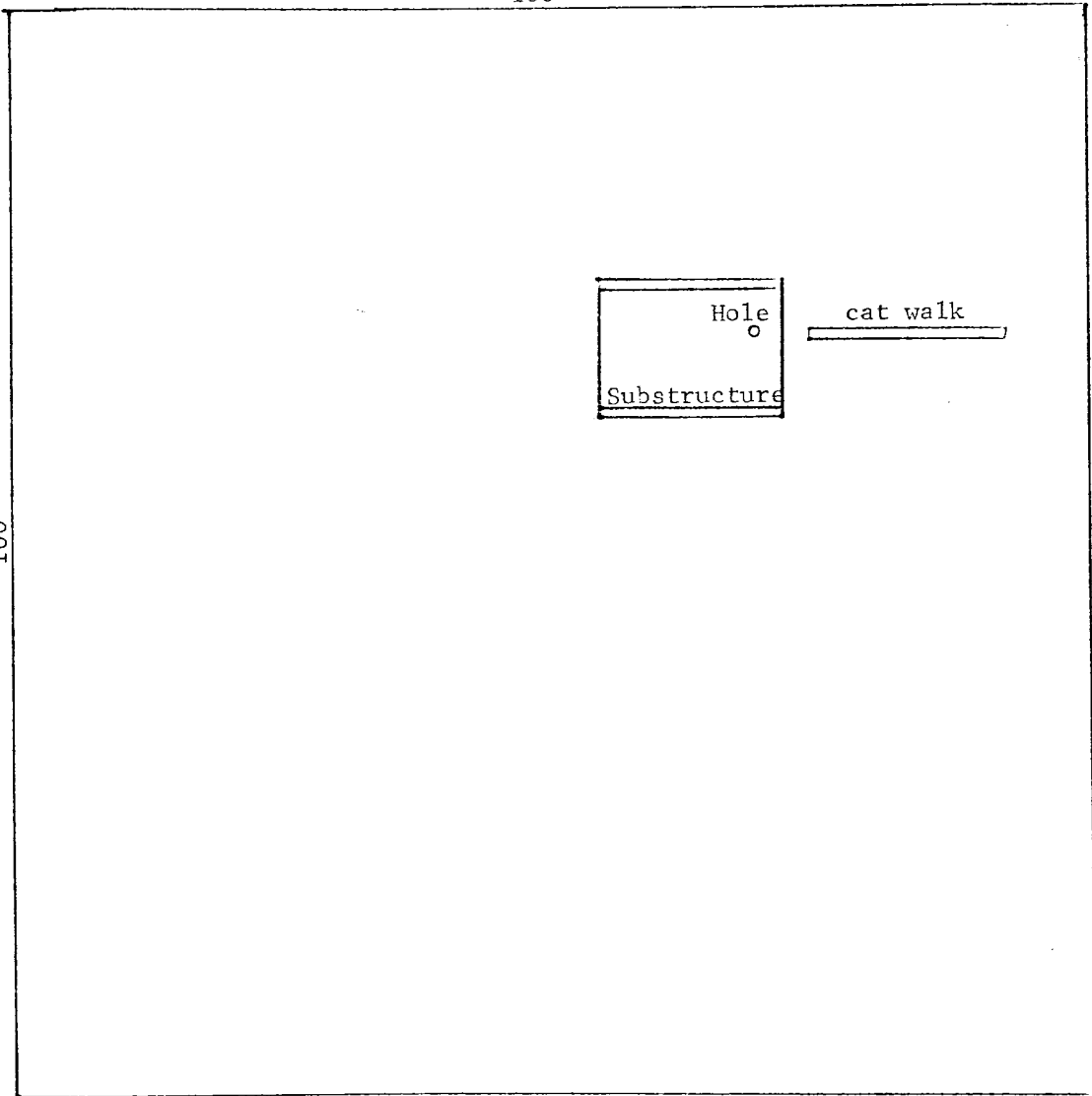

#1 Federal "O"
1980' FNL & 1980' FWL
Sec. 11, T26S, R25E
Eddy County, New Mexico

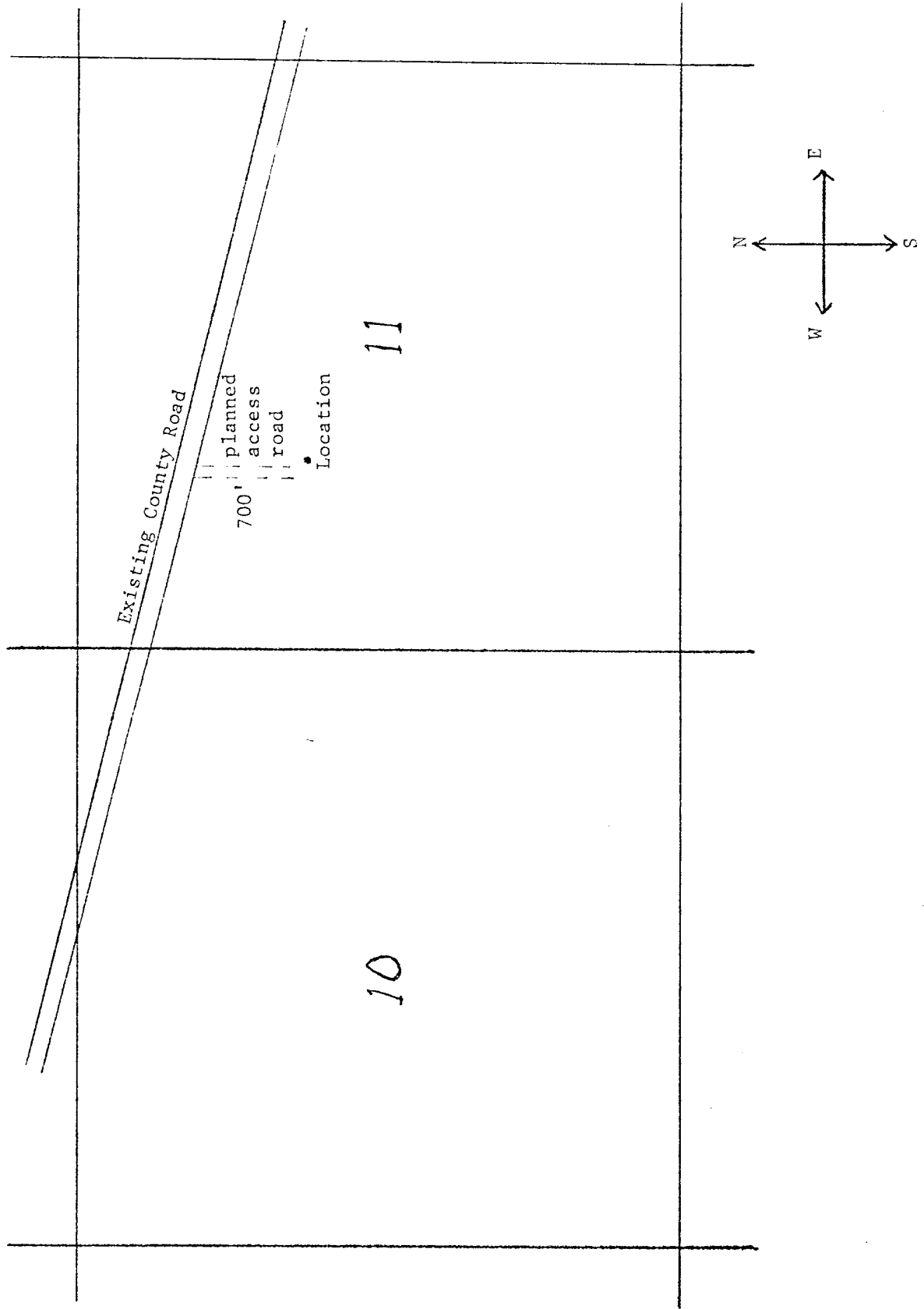

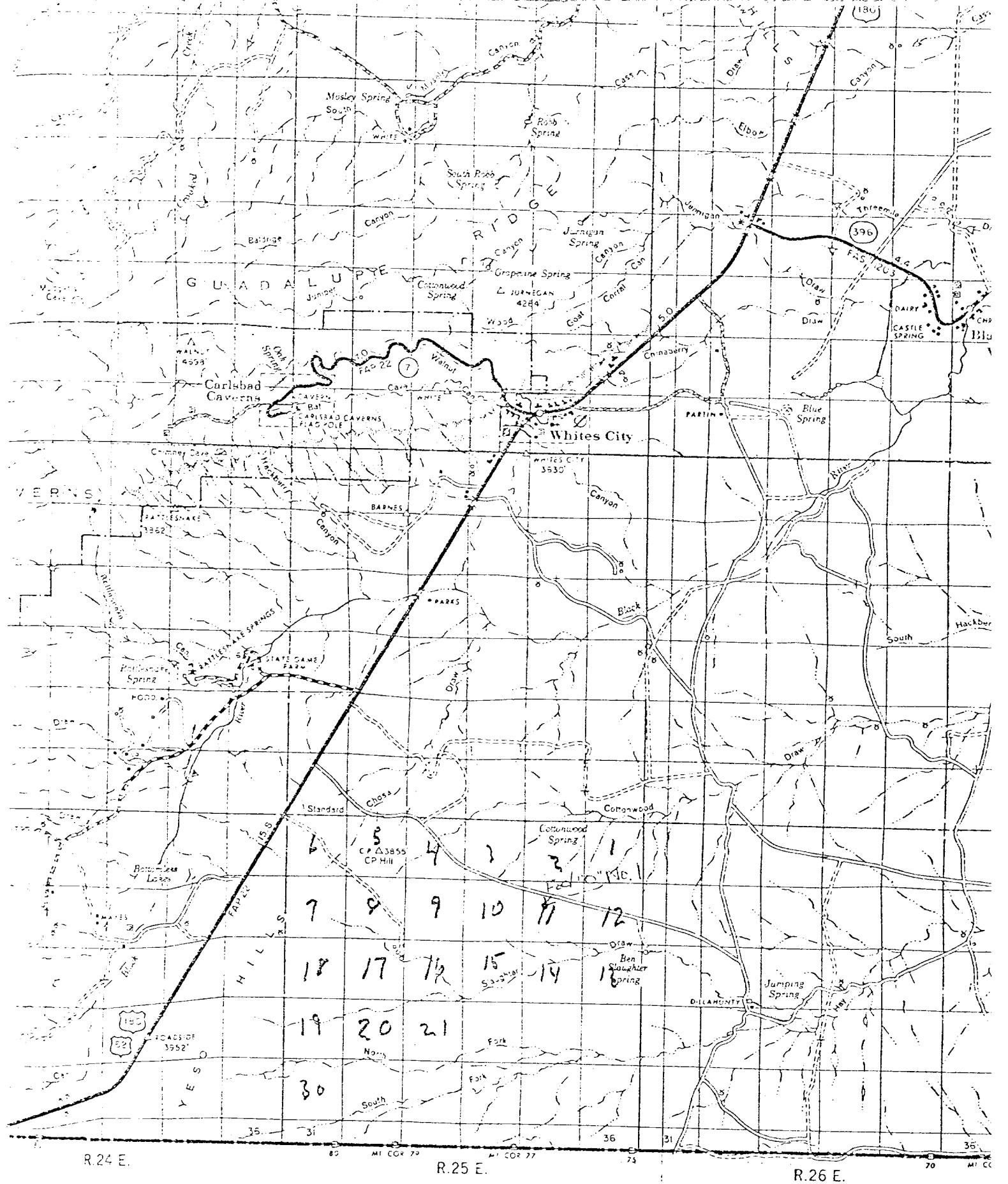

S O N O U N

E X