

UNITED STATES  
DEPARTMENT OF THE INTERIOR  
BUREAU OF LAND MANAGEMENT

NM OIL CONS. COMMISSION  
DRAWER DD  
ARTESIA, NM 88210

FORM APPROVED  
Budget Bureau No. 1004-0135  
Expires: March 31, 1993

**SUNDRY NOTICES AND REPORTS ON WELLS**

Do not use this form for proposals to drill or to deepen or reentry to a different reservoir.  
Use "APPLICATION FOR PERMIT—" for such proposals

**SUBMIT IN TRIPLICATE**

1. Type of Well  
☒ Oil Well ☐ Gas Well ☐ Other (OWWO)

2. Name of Operator

SNOW OIL & GAS, INC.

3. Address and Telephone No.

P.O. BOX 1277 ANDREWS, TEXAS 79714 (915) 524-2371

4. Location of Well (Footage, Sec., T., R., M., or Survey Description)

660 FSL & 1980 FEL (o)  
Sec. 1, T25S, R25E

5. Lease Designation and Serial No.

NM 71560

6. If Indian, Allottee or Tribe Name

7. If Unit or CA, Agreement Designation

8. Well Name and No.

W.C. FEDERAL #1

9. API Well No.

10. Field and Pool, or Exploratory Area

WILDCAT (DELAWARE)

11. County or Parish, State

EDDY, NEW MEXICO

12. CHECK APPROPRIATE BOX(s) TO INDICATE NATURE OF NOTICE, REPORT, OR OTHER DATA

TYPE OF SUBMISSION

- ☒ Notice of Intent  
☐ Subsequent Report  
☐ Final Abandonment Notice

TYPE OF ACTION

- ☐ Abandonment  
☐ Recompletion  
☐ Plugging Back  
☐ Casing Repair  
☐ Altering Casing  
☒ Other Re-entry  
☐ Change of Plans  
☐ New Construction  
☐ Non-Routine Fracturing  
☐ Water Shut-Off  
☐ Conversion to Injection  
☐ Dispose Water

(Note: Report results of multiple completion on Well Completion or Recompletion Report and Log form)

13. Describe Proposed or Completed Operations (Clearly state all pertinent details, and give pertinent dates, including estimated date of starting any proposed work. If well is directionally drilled, give subsurface locations and measured and true vertical depths for all markers and zones pertinent to this work.)\*

- SEE ATTACHMENTS:
1. Application For Permit to Drill, Deepen, or Plug Back (3160-3)
  2. Surface Use and Operations Plan w/ Exhibits
  3. Well Location and Acreage Dedication Plat (C-102)
  4. Supplemental Drilling Data
  5. BOP Diagram

Former: GP II Auggy Inc.  
White City Ut. Fed.  
OTD-11, 850  
P&A-3-19-74

APPROVAL OF THIS APPLICATION DOES NOT WARRANT OR CERTIFY THAT THE APPLICANT HOLDS LEGAL OR EQUITABLE TITLE TO THOSE RIGHTS IN THE SUBJECT LEASE WHICH WOULD ENTITLE THE APPLICANT TO CONDUCT OPERATIONS THEREON

APPROVAL SUBJECT TO  
GENERAL REQUIREMENTS AND  
SPECIAL STIPULATIONS  
ATTACHED

14. I hereby certify that the foregoing is true and correct

Signed Dan W. Snow Title Vice President

Date 8/30/93

(This space for Federal or State office use)

Approved by (ORIG. SGD.) RICHARD L. MANUS Title AREA MANAGER

Date OCT 18 1993

Conditions of approval, if any:

UNITED STATES  
DEPARTMENT OF THE INTERIOR  
BUREAU OF LAND MANAGEMENT

APPLICATION FOR PERMIT TO DRILL, DEEPEN, OR PLUG BACK

1a. TYPE OF WORK

DRILL ☒ & RE-ENTER DEEPEN ☐ PLUG BACK ☐

b. TYPE OF WELL

OIL WELL ☒ GAS WELL ☐ OTHER ☐ SINGLE ZONE ☒ MULTIPLE ZONE ☐

2. NAME OF OPERATOR

SNOW OIL & GAS, INC.

3. ADDRESS OF OPERATOR

P.O. BOX 1277 ANDREWS, TEXAS 79714

4. LOCATION OF WELL (Report location clearly and in accordance with any State requirements.)\*  
At surface

660' FSL & 1980' FEL of Section 1  
At proposed prod. zone

14. DISTANCE IN MILES AND DIRECTION FROM NEAREST TOWN OR POST OFFICE\*

2 miles Southeast of White City, New Mexico

15. DISTANCE FROM PROPOSED\*

LOCATION TO NEAREST  
PROPERTY OR LEASE LINE, FT.  
(Also to nearest drlg. unit line, if any) 660'

16. NO. OF ACRES IN LEASE

640

17. NO. OF ACRES ASSIGNED  
TO THIS WELL

40

18. DISTANCE FROM PROPOSED LOCATION\*  
TO NEAREST WELL, DRILLING, COMPLETED,  
OR APPLIED FOR, ON THIS LEASE, FT.

NONE

19. PROPOSED DEPTH

3700'

20. ROTARY OR CABLE TOOLS

Rotary R.U.

21. ELEVATIONS (Show whether DF, RT, GR, etc.)

3463' GR

22. APPROX. DATE WORK WILL START\*

9-28-93

23.

EXISTING

PROPOSED CASING AND CEMENTING PROGRAM

SIZE OF HOLE	SIZE OF CASING	WEIGHT PER FOOT	SETTING DEPTH	QUANTITY OF CEMENT
17 1/2"	13 3/8	72#	338'	350 sx CMT Circ.
12 1/4	9 5/8	40#	1650'	750 sx CMT Circ.
9 1/2	7 5/8	29.7#, 33.7	8600'	1680 sx Top of Csg @ 5020'

PROPOSED CASING AND CEMENTING PROGRAM

8 3/4	5 1/2	15.5#	3700'	400 sx to Tie Back to 9 5/8 Csg @ 1650'
-------	-------	-------	-------	--

APPROVAL OF THIS APPLICATION DOES NOT WARRANT  
OR CERTIFY THAT THE APPLICANT HOLDS LEGAL OR  
EQUITABLE TITLE TO THOSE RIGHTS IN THE SUBJECT  
LEASE WHICH WOULD ENTITLE THE APPLICANT TO  
CONDUCT OPERATIONS THEREON

APPROVAL SUBJECT TO  
GENERAL REQUIREMENTS AND  
SPECIAL REGULATIONS  
OF THE BUREAU

IN ABOVE SPACE DESCRIBE PROPOSED PROGRAM: If proposal is to deepen or plug back, give data on present productive zone and proposed new productive zone. If proposal is to drill or deepen directionally, give pertinent data on subsurface locations and measured and true vertical depths. Give blowout preventer program, if any.

24.

SIGNED

*Dan W. Snow*

Dan W. Snow

TITLE

Vice President

DATE

8/30/93

(This space for Federal or State office use)

PERMIT NO.

APPROVAL DATE

APPROVED BY

*Area Manager*

TITLE

AREA MANAGER

DATE

CONDITIONS OF APPROVAL, IF ANY:

\*See Instructions On Reverse Side

## SUPPLEMENTAL DRILLING DATA

Snow Oil & Gas, Inc.  
W.C. Federal #1  
660 FSL & 1980 FEL (O)  
Section 1, T25S, R25E  
Eddy County, New Mexico

1. SURFACE FORMATION: Quaternary

2. ESTIMATED GEOLOGIC TOPS:

Base of Salt	1352
Delaware Sand	1611
Manzanita Marker	2626
Brushy Canyon	3320

3. ANTICIPATED HYDROCARBON BEARING ZONES:

Delaware Sand	(oil)	3320
"Cherry Canyon"	(oil)	3535

4. EXISTING CASING:

<u>Casing Size</u>	<u>From</u>	<u>To</u>	<u>Cement</u>
20"	0'	30'	Circ.
13 5/8"	0'	328'	Circ.
9 5/8"	0'	1650'	750 sx
7 5/8"	5020'	8600'	300 sx

5. PROPOSED CASING AND CEMENTING PROGRAM:

<u>Casing Size</u>	<u>From</u>	<u>To</u>	<u>Cement</u>	<u>Grade</u>	<u>Joint</u>
5 1/2"	0'	3700'	400 sx	k-55	LTC or ST & C

A 5 1/2" production string will be run to 3700'.

The 5 1/2" casing string will be cemented with sufficient cement to cover the zones to be tested - approximately 300'.

6. WORKOVER EQUIPMENT:

A double drum workover unit and a reverse unit will be used to drill out the cement plugs above 3700'. All fluids used by the reverse unit will be contained by steel circulating pits.

7. PRESSURE CONTROL EQUIPMENT:

A 3000 psi working pressure B.O.P. will be used while drilling out the cement plugs below the surface casing.

8. CIRCULATING MEDIUM:

Fresh water will be used, no additional viscosity will be needed for hole control. Fresh water to be purchased from commercial source.

9. AUXILIARY EQUIPMENT:

Drill string safety valves will be maintained on the rig floor while drilling operations are in progress.

10. TESTING, LOGGING, AND CORING PROGRAMS:

No DST's are planned.

A GR-CBL will be run after cementing.

No coring is planned.

11. ABNORMAL PRESSURES, TEMPERATURE, OR HYDROGEN SULFIDE GAS:

No abnormal pressures or temperatures are anticipated.

No hydrogen sulfide gas is anticipated.

12. ANTICIPATED START DATE:

The re-entry is anticipated to commence on or about September 28, 1993 with workover, completion, and testing operations to last about 30 days.

# SNOW OIL & GAS, INC

## BOP DIAGRAM WC FEDERAL No.1

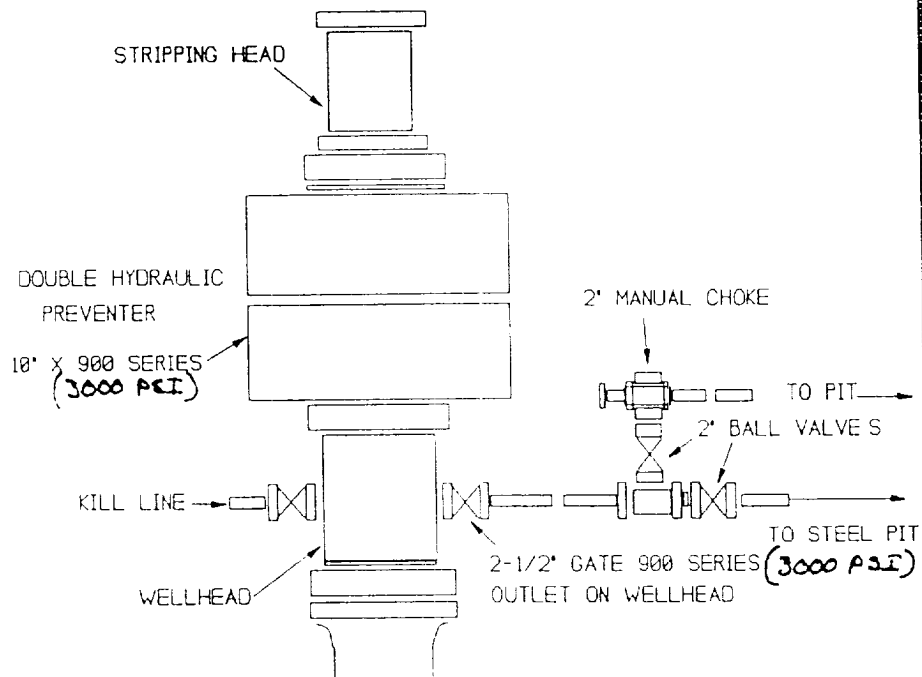

SURFACE USE AND OPERATIONS PLAN

Snow Oil & Gas, Inc.  
W.C. Federal #1  
660 FSL & 1980 FEL (O)  
Sec. 1, T25S, R25E  
Eddy County, New Mexico

LOCATED: 2.00 miles east-southeast of White City, New Mexico

FEDERAL LEASE NUMBER: NM-71560

DATE OF ISSUE: Lease issued February 1, 1988, for 10 years.  
Lease is not currently productive.

LESSEE OF RECORD: Caroline B. Bunn

LEASE AREA: 640.4 Acres

SURFACE OWNERSHIP: Federal

POOL DESIGNATION: Wildcat (Delaware)

POOL RULES: Statewide - 40 Acre spacing for oil

EXHIBITS:

- A. Road Map
- B. Plat with existing wells and roads
- C. Topographic Plat
- D. Wellbore schematic

## SURFACE USE AND OPERATIONS PLAN

### EXISTING ROADS:

- A. Exhibit "A" depicts the road map and shows the location of the proposed re-entry. Point "A" on the plat is on US 180 approximately 1.7 miles southwest of Whites City, New Mexico, where a dirt road goes east. Exit US 180 at this point and proceed east 3/4 mile to a fork, take the left fork and continue along the section line east 1.75 miles to the location.
- B. Exhibit "B" shows existing pertinent roads in the vicinity of the proposed well site. Existing roads to location are color coded in Exhibit "C".

### PLANNED ACCESS ROAD:

No additional roads will be necessary. The existing road will be reconditioned prior to moving in the workover rig. Any fill caliche will be removed from existing pad or purchased from a commercial source. No new areas will be disturbed off of pad or road.

### LOCATION OF EXISTING WELLS:

If the well is completed as a producer, a tank batter will be constructed on the producing well site.

### WATER SUPPLY:

A water well will not be drilled. Water required for reverse drilling operations will be purchased and trucked to the well.

### ADDITIONAL PROCEDURES:

- A. Cement cuttings and drilling fluid will be trucked from the location. The circulating system for the reverse unit will be contained in a steel pit.
- B. Permanent production equipment will be painted to minimize the visual impact.
- C. Water produced during tests will be contained in steel tanks and disposed of off site.
- D. Oil produced during tests will be stored in steel tanks until sold.
- E. Trash, waste paper, garbage, and junk will be contained in a covered steel container and removed from the drill site within thirty days after drilling and/or completion operations cease.

ANCILLARY FACILITIES:

None Required

WELL SITE LAYOUT:

- A. The well site is located on an existing, large caliche pad. Drainage is to the southeast.
- B. No cut and fill will be necessary.

SURFACE RESTORATION:

Upon completion of workover and/or completion operations, all equipment and other material not needed for operations will be removed. The pad area will be cleaned and repaired for production operations of a producer. If the well is abandoned, the restoration will be in accordance with established guidelines.

ADDITIONAL INFORMATION:

- A. The land surface slopes regionally to the southeast. (Exhibit "C")
- B. The top soil in the area is a gravelly loam that includes loose sands and river gravels.
- C. Locally the vegetation cover is moderate and comprises range grasses, yucca, white thorn acacia, typical of semi-arid Chihuahuan desert. Wildlife in the area includes deer, coyotes, rabbits, rodents, reptiles and a variety of birds.
- D. There are no occupied dwellings within a mile of the proposed drill site.
- E. Primary use for the land is oil and gas production, grazing, and wildlife habitat.
- F. The wellsite is located on federal surface.
- G. There is no evidence of any archaeological, historical, or cultural sites in the vicinity of the location.



OPERATOR'S REPRESENTATIVE:

Dan W. Snow, Vice President  
Snow Oil & Gas, Inc.  
P.O. Box 1277  
Andrews, Texas 79714  
Phone 1-915-524-2371

CERTIFICATION:

I hereby certify that I, or persons under my direct supervision, have inspected the proposed drill site and access route; that I am familiar with the conditions which currently exists; that the statements made in this plan are, to the best of my knowledge, true and correct; and, that the work associated with the operation proposed herein will be performed by Snow Oil & Gas, Inc. and its contractors and sub-contractors in conformity with this plan and the terms and conditions under which it is approved. This statement is subject to the provision of 18 U.S.C. 1001 for the filing of a false statement.

BY: \_\_\_\_\_



DATE: \_\_\_\_\_

8/30/93

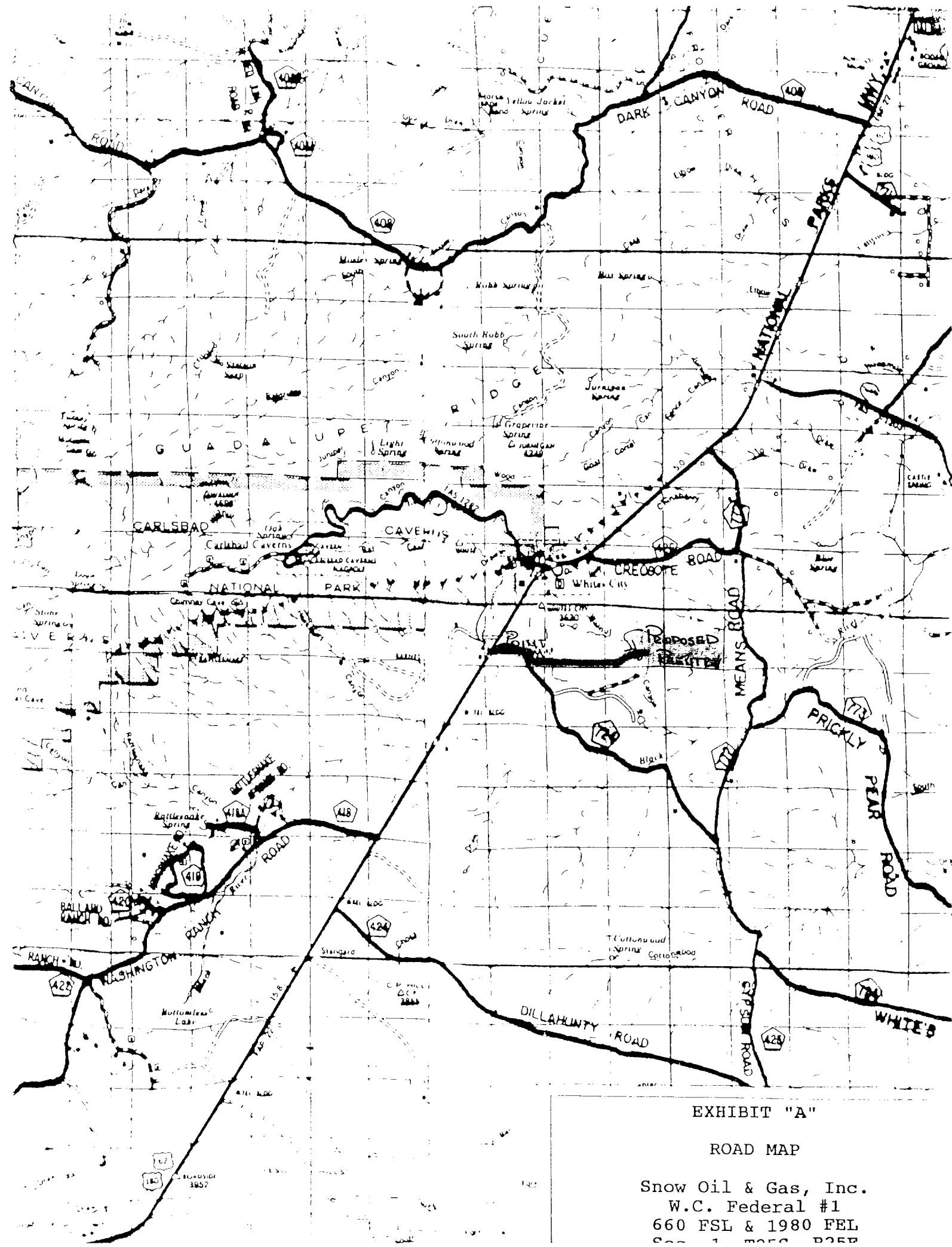

EXHIBIT "A"

ROAD MAP

Snow Oil & Gas, Inc.  
W.C. Federal #1  
660 FSL & 1980 FEL  
SOG 1 3250 0250

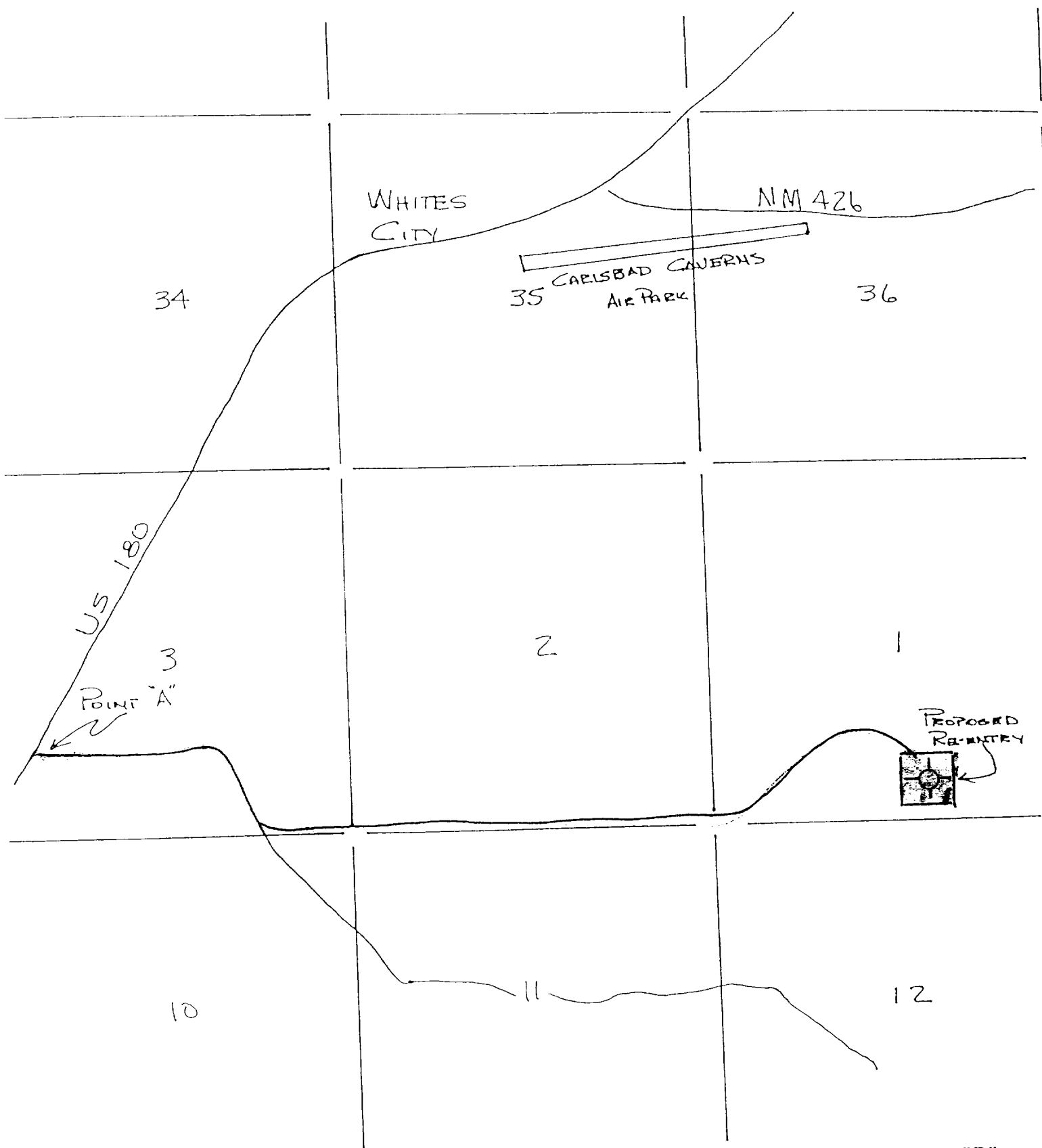

EXHIBIT "B"

EXISTING ROADS & WELLS

LEGEND

- OIL WELL
- ⊕ RUGGED WELL

————— EXISTING ROAD

Snow Oil & Gas, Inc.  
W.C. Federal #1  
660 FSL & 1980 FEL  
Sec. 1. T25S. R25E

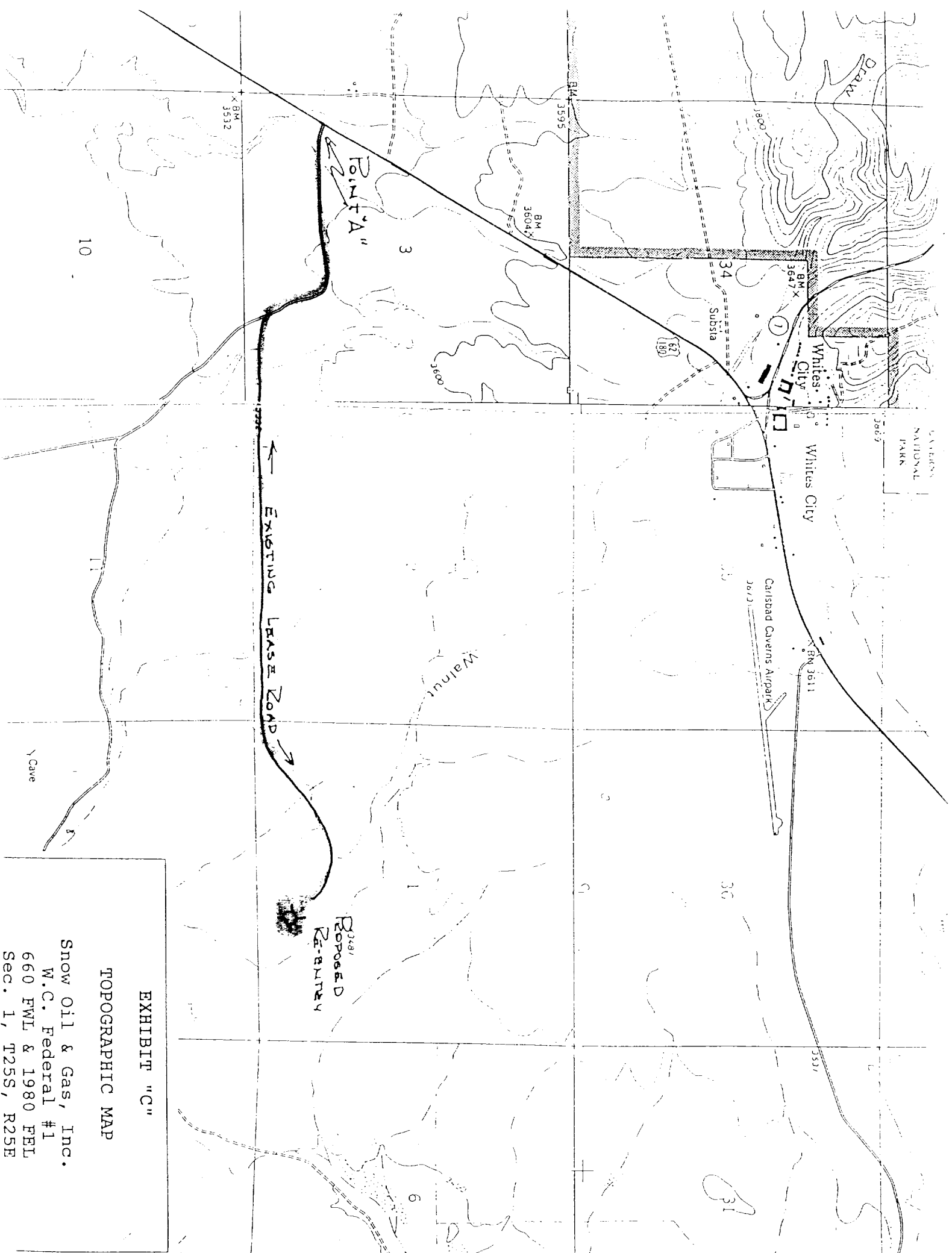

EXHIBIT "C"

TOPOGRAPHIC MAP

Snow Oil & Gas, Inc.  
W.C. Federal #1  
660 FWL & 1980 FEL  
Sec. 1, T25S, R25E

AMERICAN OIL & GAS PET. CO.  
 White City Unit Federal #1  
 660 FSL & 1980 FEL  
 Sec. 1, T25S, R25E

PRESENT

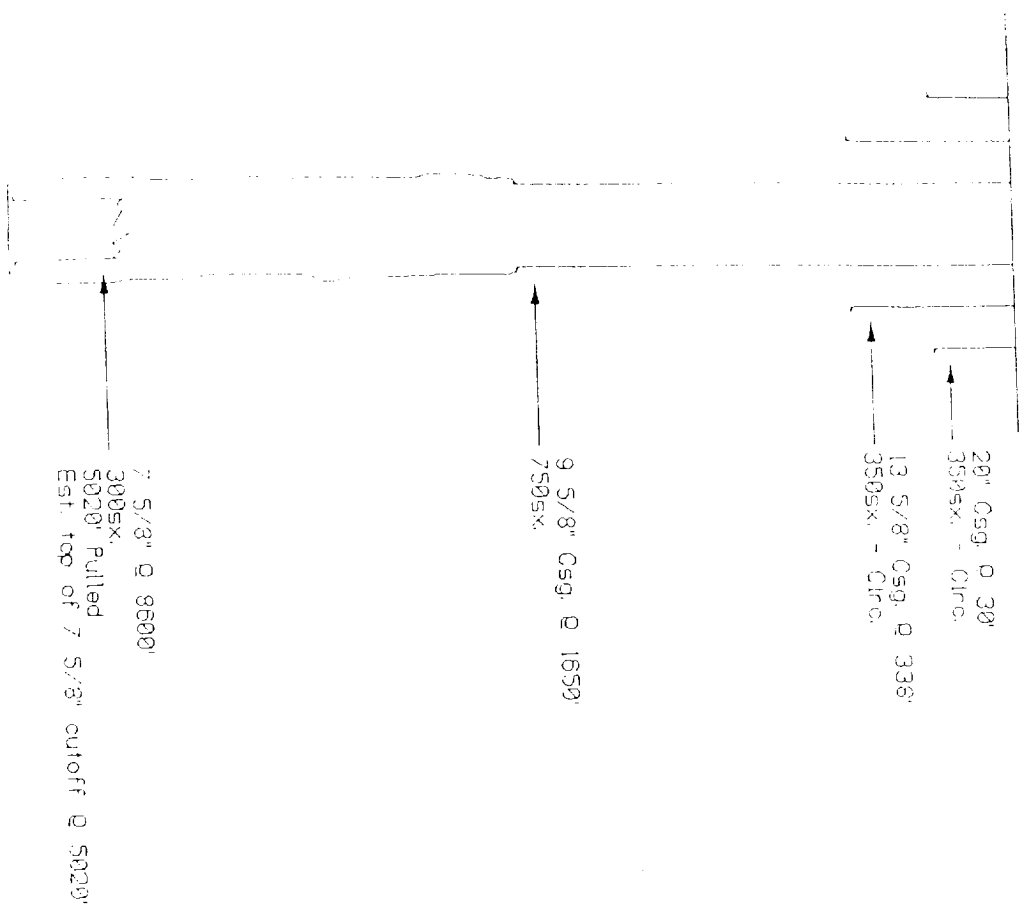

Snow Oil & Gas, Inc.  
 W.C. Federal #1  
 660 FSL & 1980 FEL  
 Sec. 1, T25S, R25E

PROPOSED

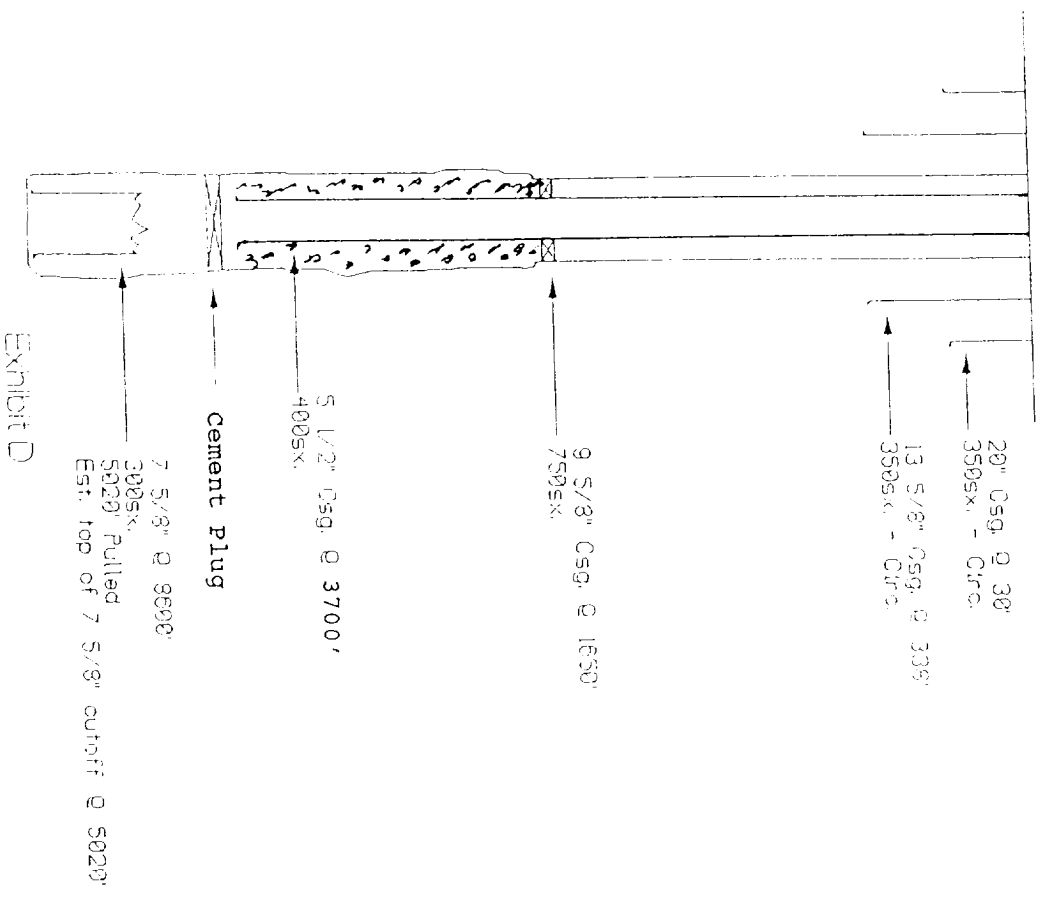

Exhibit D

Submit to Appropriate  
District Office  
State Lease - 4 copies  
Fee Lease - 3 copies

State of New Mexico  
Energy, Minerals and Natural Resources Department

Form C-102  
Revised 1-1-89

**OIL CONSERVATION DIVISION**

**DISTRICT I**  
P.O. Box 1980, Hobbs, NM 88240

P.O. Box 2088  
Santa Fe, New Mexico 87504-2088

**DISTRICT II**  
P.O. Drawer DD, Artesia, NM 88210

**DISTRICT III**  
1000 Rio Brazos Rd., Aztec, NM 87410

**WELL LOCATION AND ACREAGE DEDICATION PLAT**

All Distances must be from the outer boundaries of the section

Operator SNOW OIL & GAS, INC.			Lease W.C. FEDERAL		Well No. 1
Unit Letter O	Section 1	Township 25S	Range 25E	County EDDY	NMPM
Actual Footage Location of Well: 660 feet from the SOUTH line and 1980 feet from the EAST line					
Ground level Elev. 3463	Producing Formation DELAWARE		Pool WILDCAT	Dedicated Acreage: 40 Acres	

1. Outline the acreage dedicated to the subject well by colored pencil or hatchure marks on the plat below.

2. If more than one lease is dedicated to the well, outline each and identify the ownership thereof (both as to working interest and royalty).

3. If more than one lease of different ownership is dedicated to the well, have the interest of all owners been consolidated by communitization, unitization, force-pooling, etc.?

☐ Yes ☐ No If answer is "yes" type of consolidation \_\_\_\_\_

If answer is "no" list the owners and tract descriptions which have actually been consolidated. (Use reverse side of this form if necessary.) \_\_\_\_\_

No allowable will be assigned to the well until all interests have been consolidated (by communitization, unitization, forced-pooling, or otherwise) or until a non-standard unit, eliminating such interest, has been approved by the Division.

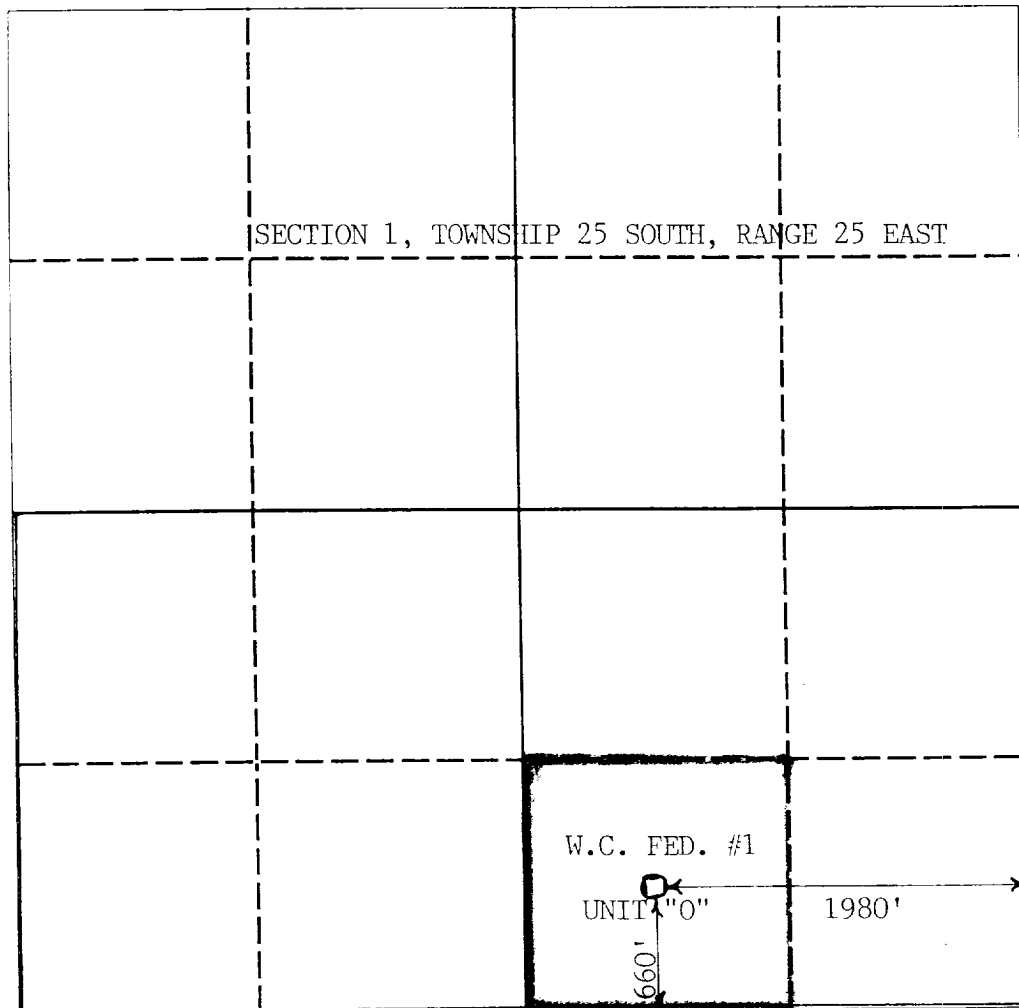

**OPERATOR CERTIFICATION**

I hereby certify that the information contained herein is true and complete to the best of my knowledge and belief.

Signature

Printed Name

DAN W. SNOW

Position

VICE PRESIDENT

Company

SNOW OIL & GAS, INC.

Date

8/30/93

**SURVEYOR CERTIFICATION**

I hereby certify that the well location shown on this plat was plotted from field notes of actual surveys made by me or under my supervision, and that the same is true and correct to the best of my knowledge and belief.

Date Surveyed

Signature & Seal of  
Professional Surveyor

Certificate No.

N. MEXICO OIL CONSERVATION COMMISSION  
WELL LOCATION AND ACREAGE DEDICATION PLAT

Form C-102  
Supersedes C-128  
Effective 1-1-65

All distances must be from the outer boundaries of the Section.

Operator <b>American Quasar Pet. Co.</b>			Lease <b>Arco Federal</b>		Well No. <b>1</b>
Unit Letter <b>0</b>	Section <b>1</b>	Township <b>25S</b>	Range <b>25E</b>	County <b>Eddy</b>	
Actual Footage Location of Well: <b>500</b> feet from the <b>South</b> line and <b>1900</b> feet from the <b>East</b> line					
Ground Level Elev. <b>3463'</b>	Producing Formation <b>Horron</b>		Pool <b>Wildcat</b>	Dedicated Acreage: <b>320</b> Acres	

1. Outline the acreage dedicated to the subject well by colored pencil or hachure marks on the plat below.
2. If more than one lease is dedicated to the well, outline each and identify the ownership thereof (both as to working interest and royalty).
3. If more than one lease of different ownership is dedicated to the well, have the interests of all owners been consolidated by communitization, unitization, force-pooling, etc?

☐ Yes ☐ No If answer is "yes," type of consolidation \_\_\_\_\_

If answer is "no," list the owners and tract descriptions which have actually been consolidated. (Use reverse side of this form if necessary.) \_\_\_\_\_

No allowable will be assigned to the well until all interests have been consolidated (by communitization, unitization, forced-pooling, or otherwise) or until a non-standard unit, eliminating such interests, has been approved by the Commission.

SECTION 1, TWP. 25-S, RNG. 25-E			

660' 1 1930'

CERTIFICATION

I hereby certify that the information contained herein is true and complete to the best of my knowledge and belief.

*[Signature]*  
Name  
**Lynn D. Jones**  
Position  
**Production Supt.**  
Company  
**American Quasar Pet. Co.**  
Date  
**November 16, 1973**

I hereby certify that the well location shown on this plat was plotted from field notes of actual surveys made by me or under my supervision, and that the same is true and correct to the best of my knowledge and belief.

Date Surveyed  
**Nov. 14, 1973**  
Registered Professional Engineer and/or Land Surveyor  
*[Signature]*  
Certificate No.  
**754**