

(May 1963)

SUBMIT TO THE STATE  
(Other instructions on  
reverse side)

BUDGET BUREAU NO. 42-R1425.

UNITED STATES  
DEPARTMENT OF THE INTERIOR  
GEOLOGICAL SURVEY

30-015-21111

5. LEASE DESIGNATION AND SERIAL NO.

NM-0518247

6. IF INDIAN, ALLOTTEE OR TRIBE NAME

7. UNIT AGREEMENT NAME

8. FARM OR LEASE NAME

Eagle Federal

9. WELL NO.

1

10. FIELD AND POOL, OR WILDCAT

Wildcat

11. SEC., T., R., M., OR BLK.  
AND SURVEY OR AREA

T-25-S, R-28-E, Sec. 1

12. COUNTY OR PARISH

Eddy

New Mexico

1a. TYPE OF WORK

DRILL ☒DEEPEN ☐PLUG BACK ☐

b. TYPE OF WELL

OIL  
WELL ☒GAS  
WELL ☐

OTHER

SINGLE  
ZONE ☐MULTIPLE  
ZONE ☒

2. NAME OF OPERATOR

Robert N. Enfield ✓

3. ADDRESS OF OPERATOR

P.O. Box 2431, Santa Fe, N.M. 87501

4. LOCATION OF WELL (Report location clearly and in accordance with any State requirements.)

At surface

At proposed prod. zone 1980 FNL & 660 FWL, T-25-S, R-28-E, Sec. 1  
Delaware

14. DISTANCE IN MILES AND DIRECTION FROM NEAREST TOWN OR POST OFFICE\*

5 miles SE Malaga, New Mexico

15. DISTANCE FROM PROPOSED\*

LOCATION TO NEAREST  
PROPERTY OR LEASE LINE, FT.  
(Also to nearest drlg. unit line, if any)18. DISTANCE FROM PROPOSED LOCATION\*  
TO NEAREST WELL, DRILLING, COMPLETED,  
OR APPLIED FOR, ON THIS LEASE, FT.

none

16. NO. OF ACRES IN LEASE

560.24

19. PROPOSED DEPTH

2800

17. NO. OF ACRES ASSIGNED  
TO THIS WELL

20. ROTARY OR CABLE TOOLS

21. ELEVATIONS (Show whether DF, RT, GR, etc.)

2944 Gr

22. APPROX. DATE WORK WILL START\*

23.

## PROPOSED CASING AND CEMENTING PROGRAM

SIZE OF HOLE	SIZE OF CASING	WEIGHT PER FOOT	SETTING DEPTH	QUANTITY OF CEMENT
11"	8 5/8"	24#	200'	200 sx circulated
6 3/4"	4 1/2"	9.5#	2800'	200 sx

Will use native mud and some gel.

B.O.P. Double Shaeffer 10" - 900 Series Hyd/6000#.

RECEIVED  
FEB 13 1974  
U. S. GEOLOGICAL SURVEY  
ARTESIA, NEW MEXICO

IN ABOVE SPACE DESCRIBE PROPOSED PROGRAM: If proposal is to deepen or plug back, give data on present productive zone and proposed new productive zone. If proposal is to drill or deepen directionally, give pertinent data on subsurface locations and measured and true vertical depths. Give blowout preventer program, if any.

24.

SIGNED

TITLE Operator

DATE 2-8-74

(This space for Federal or State office use)

PERMIT NO.

APPROVAL DATE

APPROVED BY

CONDITIONS OF APPROVAL, IF ANY:

THIS APPROVAL IS REVOCABLE IF OPERATIONS  
ARE NOT COMMENCED WITHIN 3 MONTHS.  
EXPIRES MAY 26 1974

\*See Instructions On Reverse Side

## WELL LOCATION AND ACREAGE DEDICATION PLAT

Supersedes C-128  
Effective 1-1-65

All distances must be from the outer boundaries of the Section.

Operator <i>Robert N. Enfield</i>			Lease <i>Eagle Federal</i>		Well No. <i>1</i>
Unit Letter <i>E</i>	Section <i>1</i>	Township <i>25 South</i>	Range <i>28 East</i>	County <i>Eddy</i>	
Actual Footage Location of Well: <i>1980</i> feet from the <i>North</i> line and <i>660</i> feet from the <i>West</i> line					
Ground Level Elev. <i>2944</i>	Producing Formation <i>Delaware</i>		Pool <i>Wildcat</i>	Dedicated Acreage: <i>40</i> Acres	

1. Outline the acreage dedicated to the subject well by colored pencil or hachure marks on the plat below.
2. If more than one lease is dedicated to the well, outline each and identify the ownership thereof (both as to working interest and royalty).
3. If more than one lease of different ownership is dedicated to the well, have the interests of all owners been consolidated by communitization, unitization, force-pooling, etc?

☒ Yes    ☐ No    If answer is "yes," type of consolidation \_\_\_\_\_

If answer is "no," list the owners and tract descriptions which have actually been consolidated. (Use reverse side of this form if necessary.) \_\_\_\_\_

No allowable will be assigned to the well until all interests have been consolidated (by communitization, unitization, forced-pooling, or otherwise) or until a non-standard unit, eliminating such interests, has been approved by the Commission.

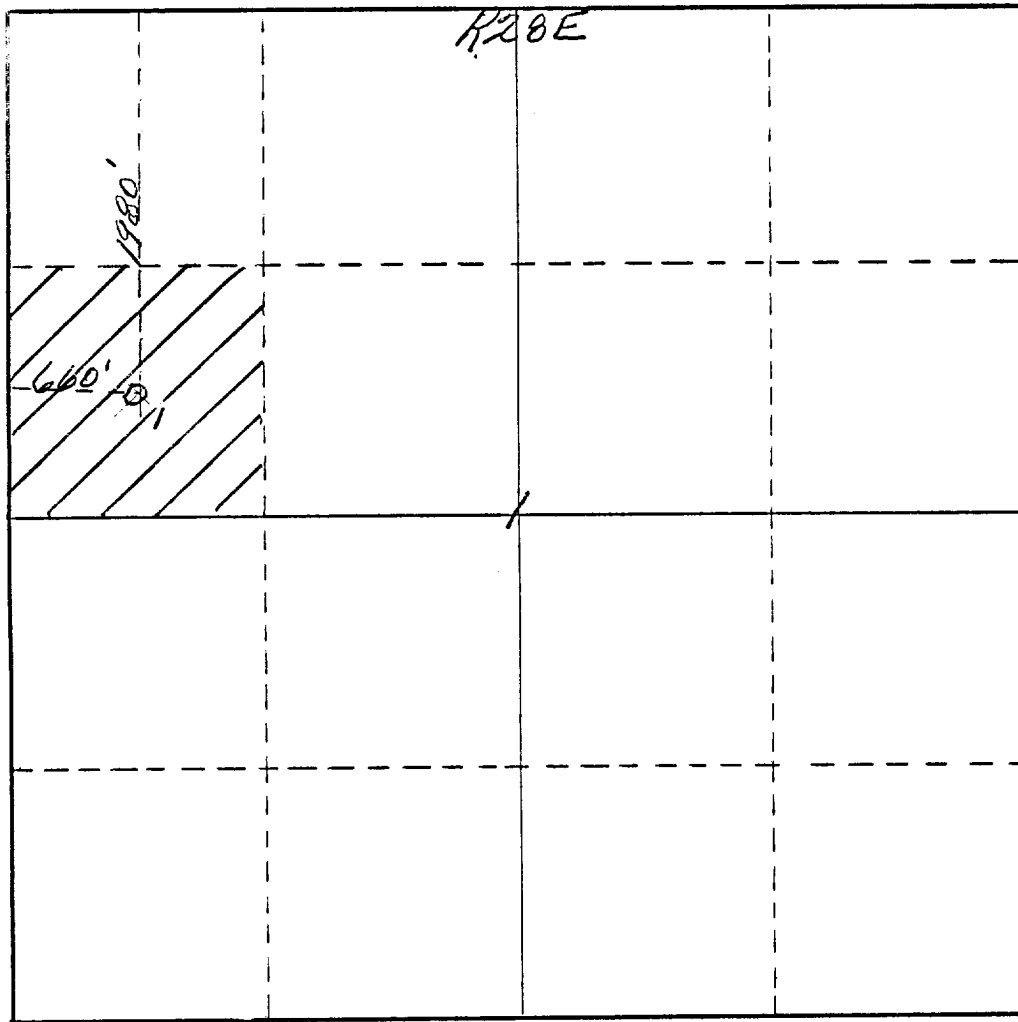

## CERTIFICATION

I hereby certify that the information contained herein is true and complete to the best of my knowledge and belief.

Name

Position

Operator

Company

Robert N. Enfield

Date

February 7, 1974

I hereby certify that the well location shown on this plat was plotted from field notes actually made by me or under my supervision, and that the same is true and correct to the best of my knowledge and belief.

Date Surveyed

February 7th 1974

Registered Professional Engineer and/or Land Surveyor

Certificate No.

542

INSTRUCTIONS FOR SUBMITTING APPLICATIONS TO DRILL  
ONSHORE OIL, GAS, OR GEOTHERMAL STEAM WELLS ON  
PUBLIC DOMAIN AND ACQUIRED LANDS

Each application for permit to drill must be accompanied by a development plan for surface use which should include information in regard to:

- |  |                          |
|--|--------------------------|
| 1. Existing roads.   | See Plat I               |
| 2. Planned access roads.   | See Plat I, approx. 300' |
| 3. Location of wells.  | See Plat I               |
| 4. Lateral roads to wells locations.   | See Plat I               |
| 5. Location of tank batteries and flowlines.   | See Plat 2               |
| 6. Locations and types of water supply.  | Hauled in                |
| 7. Methods for handling waste disposal.  | Burn Pit                 |
| 8. Location of camps.  | None                     |
| 9. Location of airstrips.  | None                     |
| 10. Location layout to include position of the rig,<br>mud tanks, reserve pits, pipe racks, etc.                                     | See Plat 2               |
| 11. Plans for restoration of the surface.  | Clean up and level       |
| 12. Any other information which the Approving Official<br>considers essential to his assessment of the impact<br>on the environment. |                          |

The affected Federal and State surface managing agencies shall have access to or, if feasible, may be provided with copies of such development plans.

**RECEIVED**  
FEB 13 1974  
U. S. GEOLOGICAL SURVEY  
ARTESIA, NEW MEXICO

NEW MEXICO  
(EDDY COUNTY)  
**MALAGA QUADRANGLE**  
15-MINUTE SERIES

CARLSBAD 15 MI.  
LOVING 3 MI.

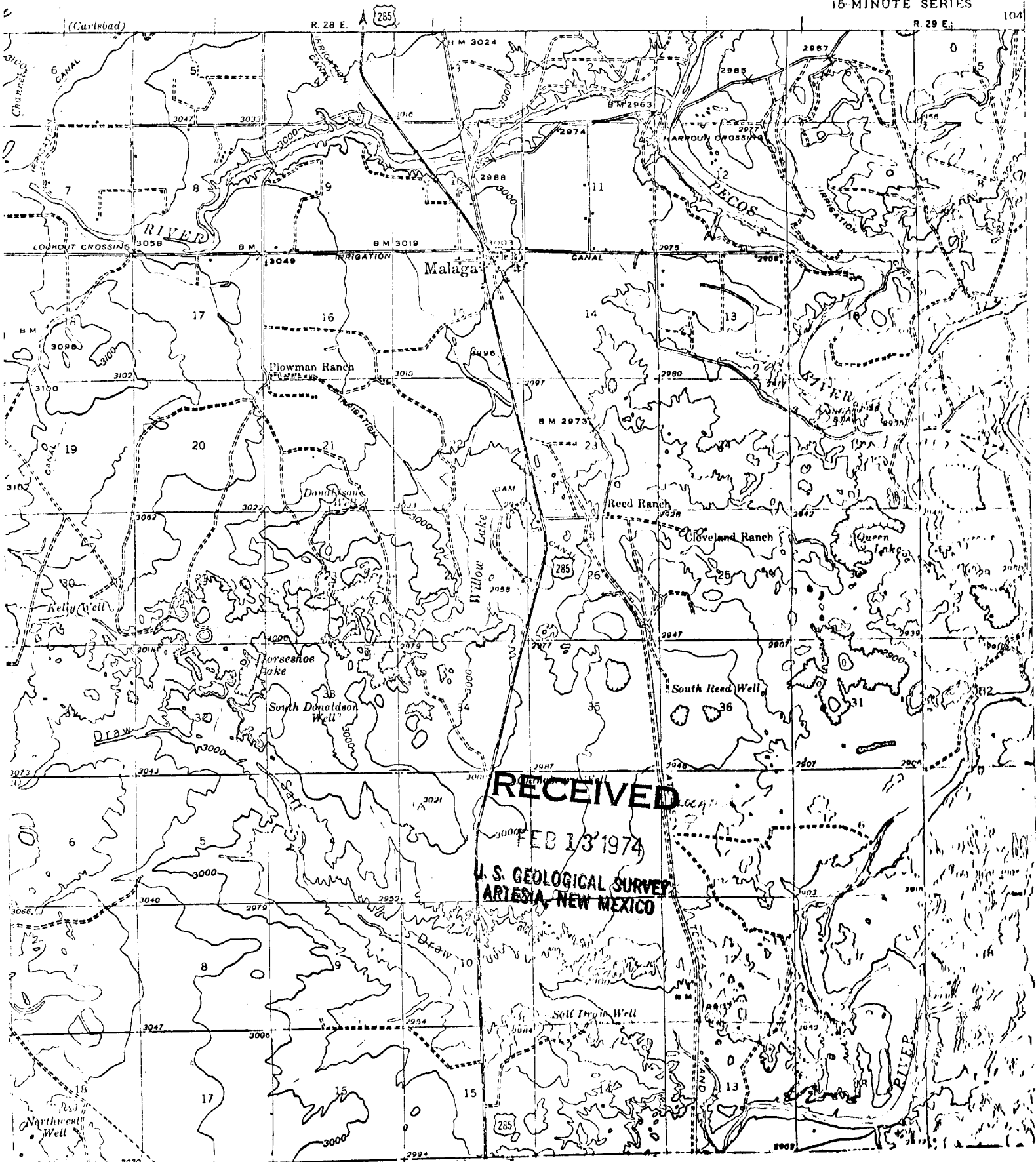

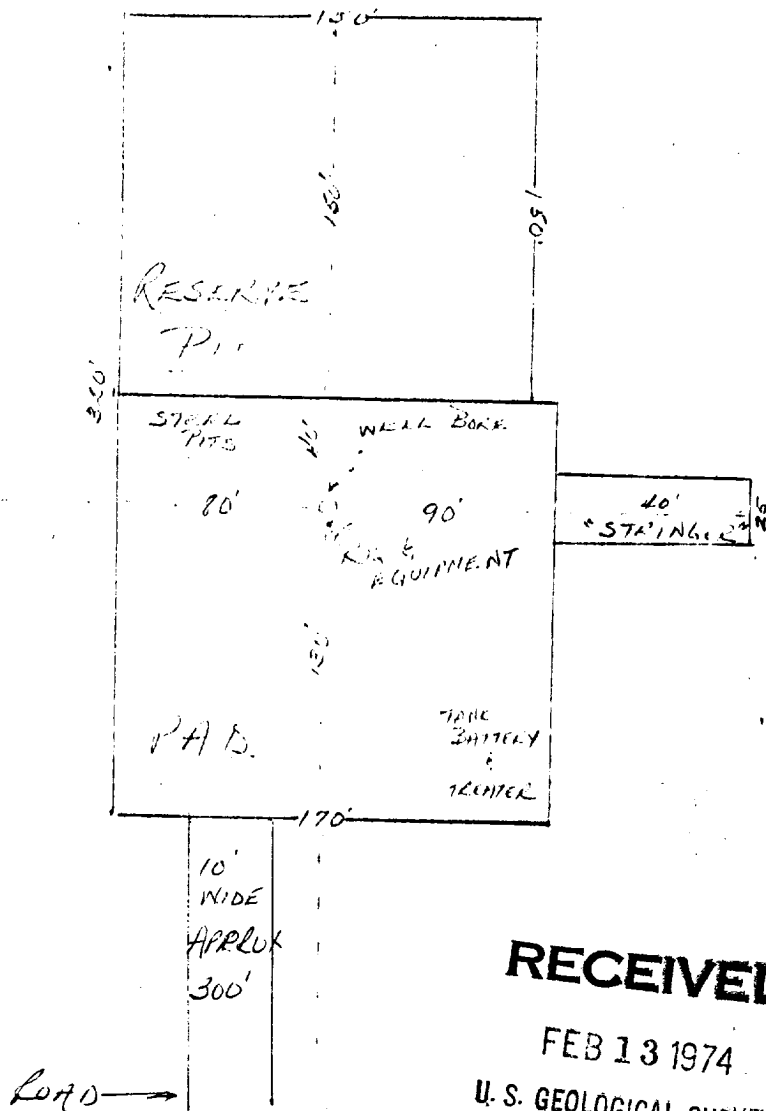

**RECEIVED**

FEB 13 1974

U. S. GEOLOGICAL SURVEY  
ARTESIA, NEW MEXICO

ROBERT N. ENFIELD

EAGLE FEDERAL #1

T-25-S R-28-E