

**N MEXICO OIL CONSERVATION COMMISSION
WELL LOCATION AND ACREAGE DEDICATION PLAT**

Form 1-1-7
Supersedes C-128
Effective 1-1-75

All distances must be from the outer boundaries of the Section

GULF OIL CORPORATION			PECOS IRRIGATION STATE COM			No. 1		
Section	Range	Township	Range	Township	County			
J	20	25 SOUTH	28 EAST	28 EAST	EDDY			
1980 feet to the SOUTH line and 1980 feet to the EAST line Section 20, T. 25 S., R. 28 E., Co. EDDY, N. M. Pool Morrow Wildcat 320 Acres								

1. Outline the acreage dedicated to the subject well by colored pencil or hatchure marks on the plat below.
2. If more than one lease is dedicated to the well, outline each and identify the ownership thereof (both as to working interest and royalty).
3. If more than one lease of different ownership is dedicated to the well, have the interests of all owners been consolidated by communitization, unitization, force-pooling, etc?
☒ Yes ☐ No If answer is "yes," type of consolidation Communitization

RECEIVED

JAN 8 - 1975
O. C. C.
ARTERIAL OFFICE

If answer is "no," list the owners and tract descriptions which have actually been consolidated (Use reverse side of this form if necessary.) _____

No allowable will be assigned to the well until all interests have been consolidated (by communitization, unitization, forced-pooling, or otherwise) or until a non-standard unit, eliminating such interests, has been approved by the Commission.

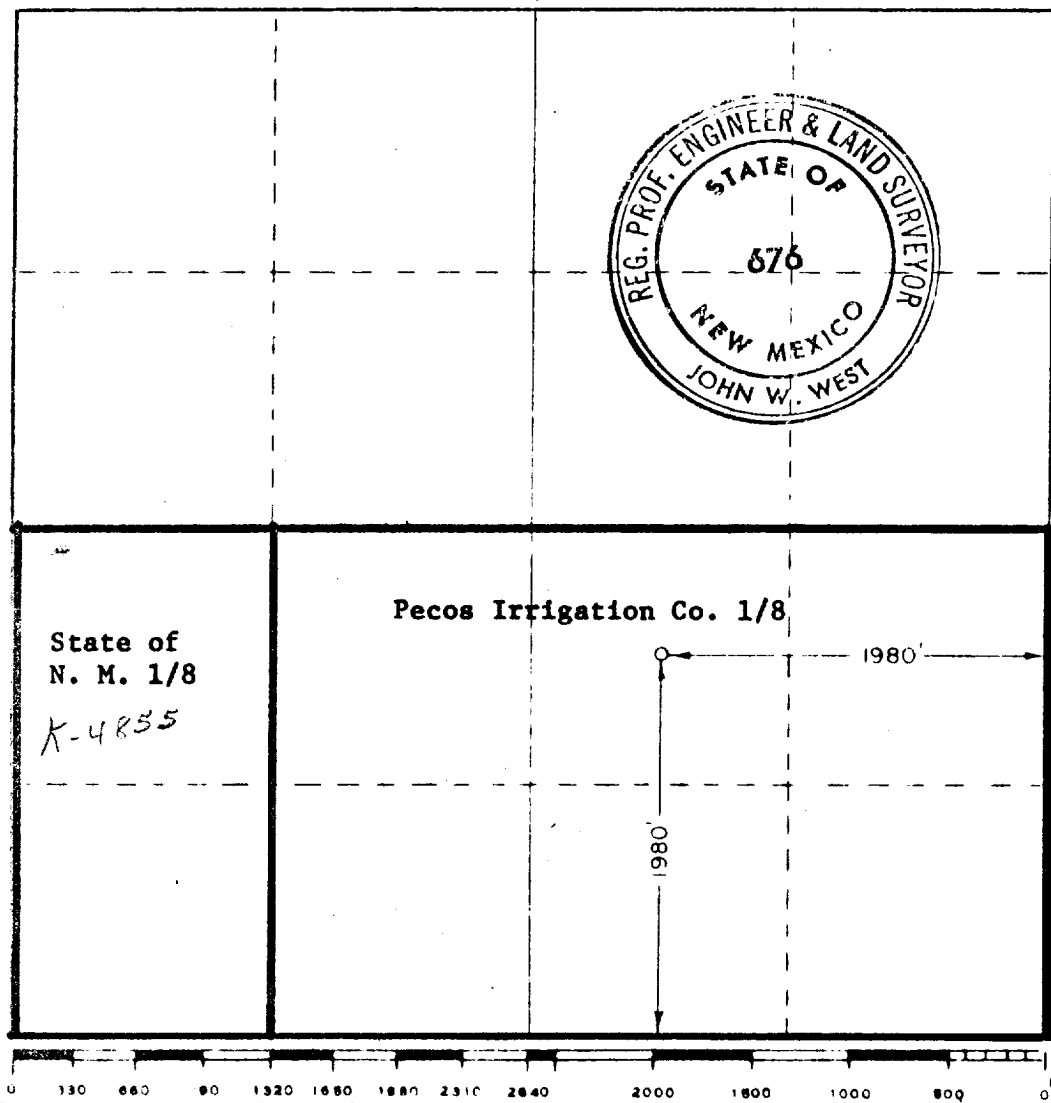

CERTIFICATION	
I hereby certify that the information contained herein is true and complete to the best of my knowledge and belief.	
<i>C. D. Borland</i>	
C. D. BORLAND	
Area Production Manager	
Gulf Oil Corporation	
January 7, 1975	
I hereby certify that the well location shown on this plat was plotted from field notes of actual surveys made by me or under my supervision and that the same is true and correct to the best of my knowledge and belief.	
Date surveyed JANUARY 4, 1975	
Registered Professional Engineer and Land Surveyor	
<i>John W. West</i>	
Certificate No. 676	

