

WELL LOCATION AND ACREAGE DEDICATION PLAT

Supplemental to 1-1-85 C/S
Effective 1-1-85 C/S
45 125
SLU

All data used must be from the outer boundaries of the Section.

Owner Mesa Petroleum Co.		Lease OGDEN STATE		Well No. 1	
Section 2	Township 25 SOUTH	Range 26 EAST	County EDDY		
Actual Footage Location of Well: 1650 feet from the NORTH line and 1650 feet from the WEST line					
Ground Level Elev. 3344.1	Producing Formation MORROW	Pool WHITE CITY PENN	Dedicated Acreage: W/2 320 Acres		

- Outline the acreage dedicated to the subject well by colored pencil or hachure marks on the plat below.
- If more than one lease is dedicated to the well, outline each and identify the ownership thereof (both as to working interest and royalty).
- If more than one lease of different ownership is dedicated to the well, have the interests of all owners been consolidated by communitization, unitization, force-pooling, etc?

☒ Yes ☐ No If answer is "yes," type of consolidation Communitization

If answer is "no," list the owners and tract descriptions which have actually been consolidated. (Use reverse side of this form if necessary.)

No allowable will be assigned to the well until all interests have been consolidated (by communitization, unitization, forced-pooling, or otherwise) or until a non-standard unit, eliminating such interests, has been approved by the Commission.

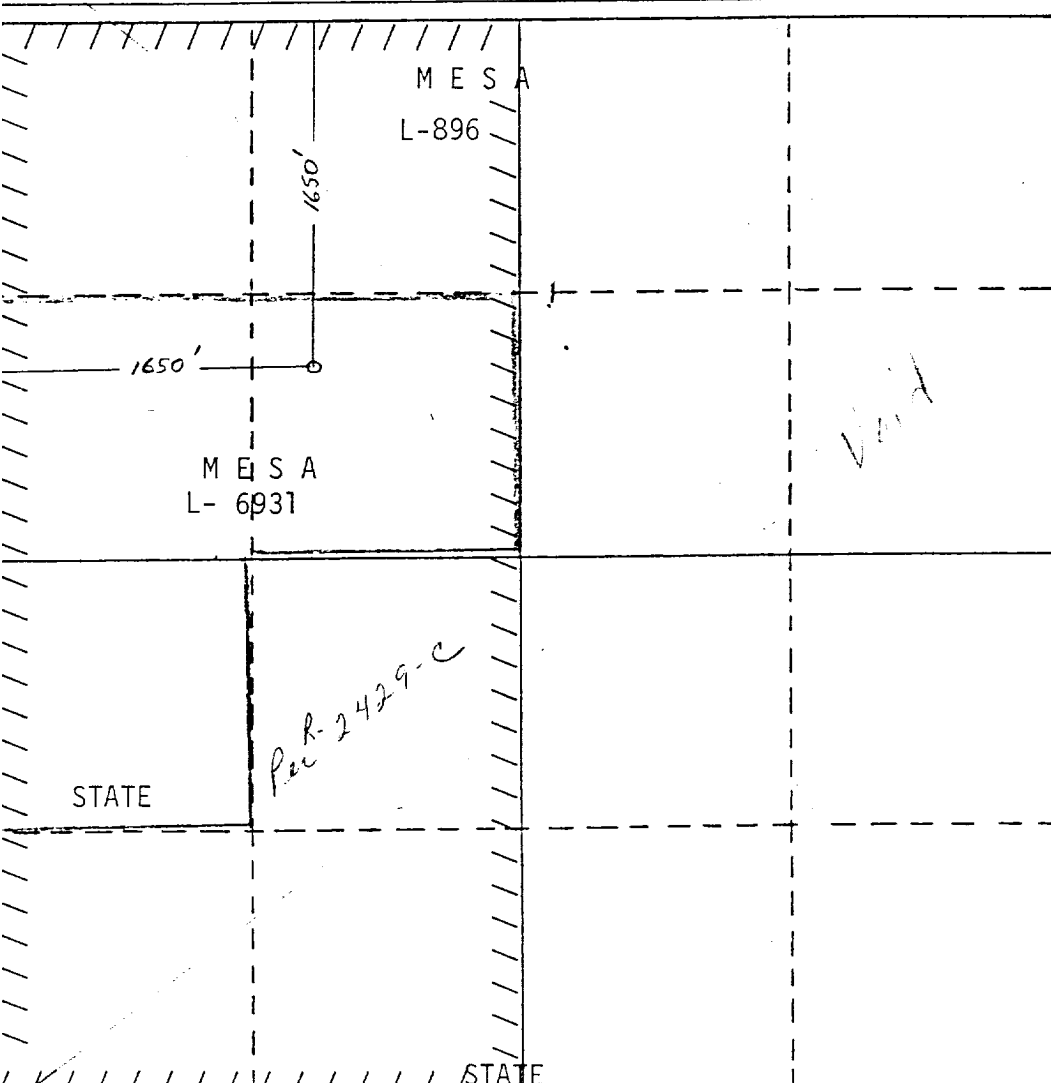

CERTIFICATION

I hereby certify that the information contained herein is true and complete to the best of my knowledge and belief.

R. E. Mathis

Name

R. E. Mathis

Position

Regulatory Coordinator

Company

Mesa Petroleum Co.

Date

May 29, 1981

I hereby certify that the well location shown on this plat was plotted from field notes of actual surveys made by me or under my supervision, and that the same is true and correct to the best of my knowledge and belief.

Date Surveyed

10-30-1976

Registered Professional Engineer and/or Land Surveyor

Certificate No.

330 440 550 660 770 880 990 1000 1500 2000 2500 3000 3500 4000 4500 5000 5500 6000 6500 7000 7500 8000 8500 9000 9500 10000