

**# MEXICO OIL CONSERVATION COMMISSION
WELL LOCATION AND ACREAGE DEDICATION PLAT**

Form C-102
Supersedes C-128
Effective 1-1-65

All distances must be from the outer boundaries of the Section.

Operator Gulf Oil Corp.			Lease Marguardt Federal		Well No. 1
Tract Letter F	Section 1	Township 25 South	Range 26 East	County Eddy	
Actual Footage Location of Well: 1650 feet from the North line and 1650 feet from the West line					
Ground Level Elev. 3326.3	Producing Formation Morrow	Pool White City Penn		Dedicated Acreage: 640 Acres	

1. Outline the acreage dedicated to the subject well by colored pencil or hachure marks on the plat below.
2. If more than one lease is dedicated to the well, outline each and identify the ownership thereof (both as to working interest and royalty).
3. If more than one lease of different ownership is dedicated to the well, have the interests of all owners been consolidated by communitization, unitization, force-pooling, etc?

☐ Yes ☐ No If answer is "yes," type of consolidation _____

If answer is "no," list the owners and tract descriptions which have actually been consolidated. (Use reverse side of this form if necessary.) _____

No allowable will be assigned to the well until all interests have been consolidated (by communitization, unitization, forced-pooling, or otherwise) or until a non-standard unit, eliminating such interests, has been approved by the Commission.

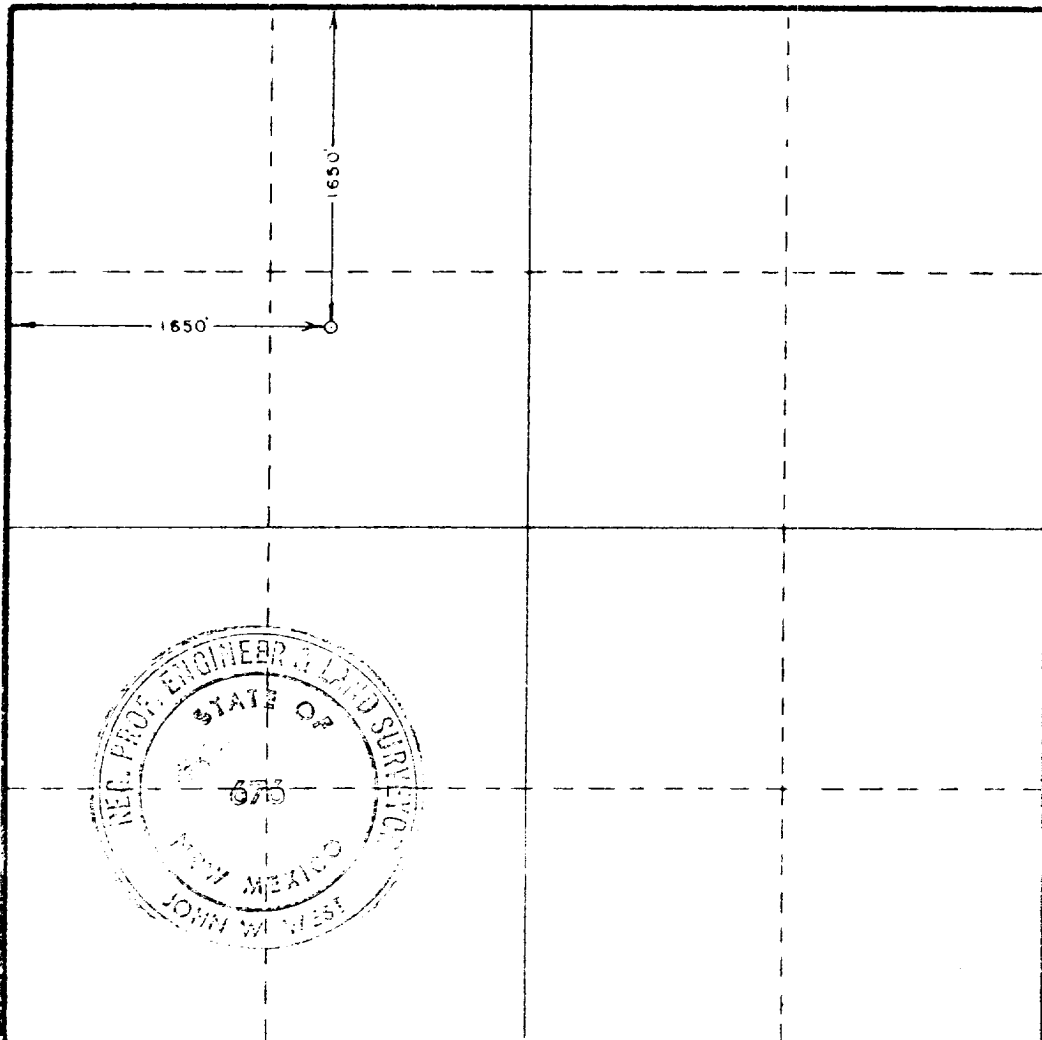

RECEIVED AUG 13 1978 U.S. GEOLOGICAL SURVEY ARTESIAN NEW MEXICO	
I hereby certify that the information contained herein is true and complete to the best of my knowledge and belief.	
Name	C. D. BORLAND
Position	Area Production Manager
Company	GULF OIL CORPORATION
Date	August 7, 1978
I hereby certify that the well location shown on this plat was plotted from field notes of actual surveys made by me or under my supervision, and that the same is true and correct to the best of my knowledge and belief.	
Date Surveyed	August 2, 1978
Registered Professional Engineer and/or Land Surveyor	
Certificate No.	John W. West 676
	Ronald J. Eidson 3239

330 660 990 1320 1650 1980 2310 2640 2970 3300 3630