

MEXICO OIL CONSERVATION COMMISSION
WELL LOCATION AND ACREAGE DEDICATION PLAT

Form C-102
 Supersedes C-128
 Effective 1-1-65

All distances must be from the outer boundaries of the Section

Operator Pauley Petroleum, Inc.			Lease Poker Lake Unit		Well No. 46
Section Letter D	Section 5	Township 25 South	Range 31 East	County Eddy	
Actual Footage Location of Well: 660 feet from the North line and 660 feet from the West line					
Ground Level Elev. 3445.3	Producing Formation Delaware Sand		Pool Wildcat	Dedicated Acreage: 40 Acres	

1. Outline the acreage dedicated to the subject well by colored pencil or hachure marks on the plat below.
2. If more than one lease is dedicated to the well, outline each and identify the ownership thereof (both as to working interest and royalty).
3. If more than one lease of different ownership is dedicated to the well, have the interests of all owners been consolidated by communitization, unitization, force-pooling, etc?

☐ Yes ☐ No If answer is "yes," type of consolidation _____

If answer is "no," list the owners and tract descriptions which have actually been consolidated. (Use reverse side of this form if necessary.) _____

No allowable will be assigned to the well until all interests have been consolidated (by communitization, unitization, forced-pooling, or otherwise) or until a non-standard unit, eliminating such interests, has been approved by the Commission.

RECEIVED

OCT 8 1978

**U.S. GEOLOGICAL SURVEY
 ARTESIA, NEW MEXICO**

CERTIFICATION

I hereby certify that the information contained herein is true and complete to the best of my knowledge and belief

James L. Flinn
 Name

James L. Flinn

Position

Division Manager

Company

PAULEY PETROLEUM INC.

Date

October 4, 1978

I hereby certify that the well location shown on this plat was plotted from field notes of actual surveys made by me or under my supervision, and that the same is true and correct to the best of my knowledge and belief.

Date Surveyed

September 13, 1978

Registered Professional Engineer and/or Land Surveyor

John W. West
 Certificate No. **John W. West**

Ronald J. Eidson **3239**

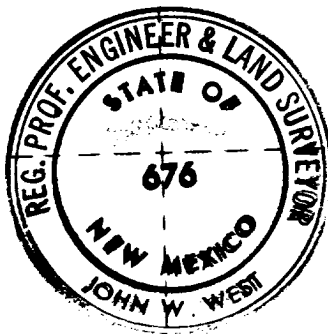
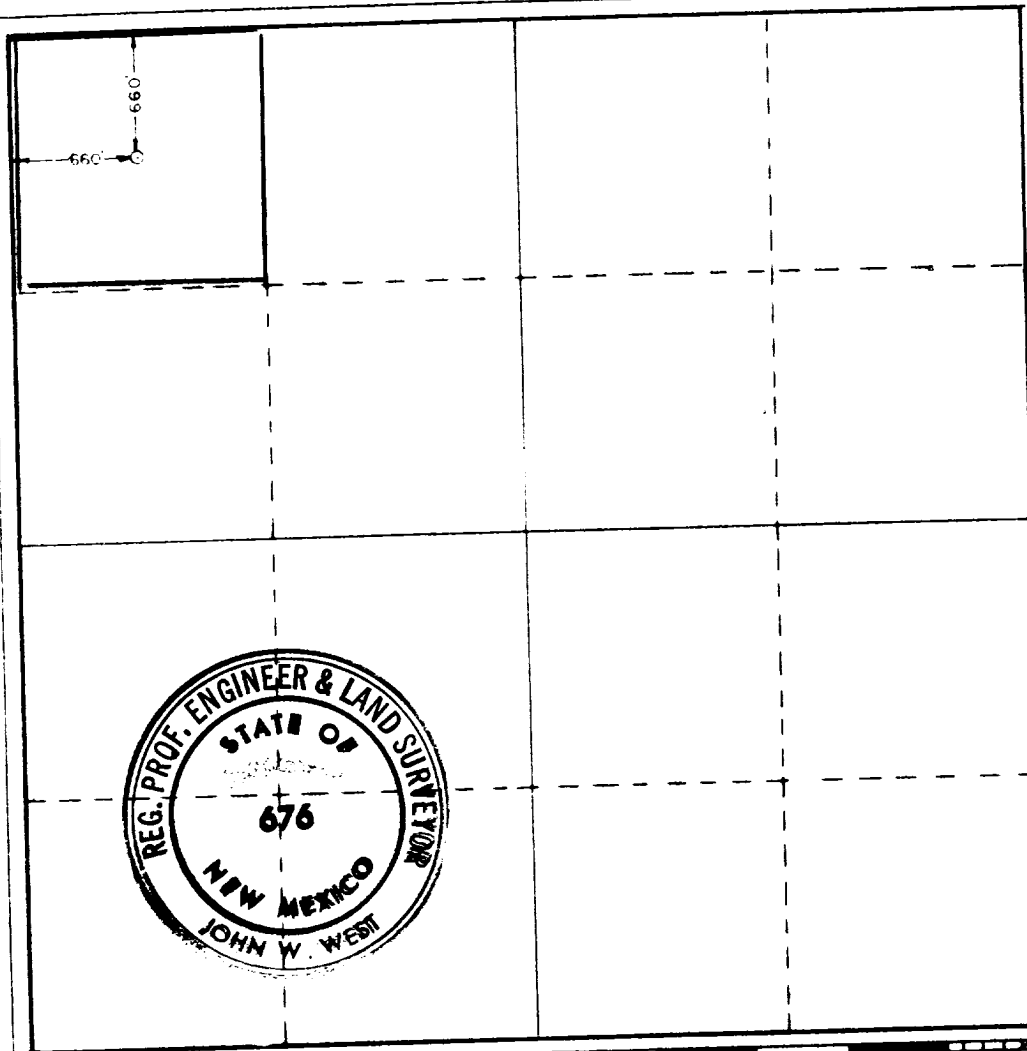

0 330 660 990 1320 1650 1980 2310 2640 2970 3300