

UNITED STATES  
DEPARTMENT OF THE INTERIOR  
GEOLOGICAL SURVEY

30-015-23096

5. LEASE DESIGNATION AND SERIAL NO.

USA-NM-19423

6. IF INDIAN, ALLOTTEE OR TRIBE NAME

7. UNIT AGREEMENT NAME

8. FARM OR LEASE NAME

Coyote Federal

9. WELL NO.

1

10. FIELD AND POOL, OR WILDCAT

Wildcat Delaware

11. SEC., T., R., N., OR BLK.  
AND SURVEY OR AREA

Sec. 34, T-25-S, R-26-E

12. COUNTY OR PARISH 13. STATE

Eddy County N. M.

## APPLICATION FOR PERMIT TO DRILL, DEEPEN, OR PLUG BACK

1a. TYPE OF WORK

DRILL ☒DEEPEN ☐PLUG BACK ☐

b. TYPE OF WELL

OIL  
WELL ☒GAS  
WELL ☐

OTHER

RECEIVED

2. NAME OF OPERATOR

Ford Chapman &amp; Associates

3. ADDRESS OF OPERATOR

Box 2376, Midland, Texas 79702

DEC 12 1979

4. LOCATION OF WELL (Report location clearly and in accordance with any State requirements.)\*

At surface  
660' F/N & E Sec. 34, T-25-S, R-26-E

ARTESIA, OFFICE

At proposed prod. zone

Same

14. DISTANCE IN MILES AND DIRECTION FROM NEAREST TOWN OR POST OFFICE\*

24 miles south of Carlsbad, New Mexico

15. DISTANCE FROM PROPOSED\*

LOCATION TO NEAREST  
PROPERTY OR LEASE LINE, FT.  
(Also to nearest drlg. unit line, if any) 660'

16. NO. OF ACRES IN LEASE

2560

17. NO. OF ACRES ASSIGNED  
TO THIS WELL

40

18. DISTANCE FROM PROPOSED LOCATION\*

TO NEAREST WELL, DRILLING, COMPLETED,  
OR APPLIED FOR, ON THIS LEASE, FT. None

19. PROPOSED DEPTH

2100' (Del Sd)

20. ROTARY OR CABLE TOOLS

Cable Tools

21. ELEVATIONS (Show whether DF, RT, GR, etc.)

3346.8 Gr

22. APPROX. DATE WORK WILL START\*

December 1, 1979

23.

## PROPOSED CASING AND CEMENTING PROGRAM

SIZE OF HOLE	SIZE OF CASING	WEIGHT PER FOOT	SETTING DEPTH	QUANTITY OF CEMENT
12 1/2	10 3/4	42#	150	Circulate
* 6 1/4	4 1/2	9.5#	TD or 4200	100

\*If needed to produce.

If a cave string is needed, 7" will be set and pulled before running 4 1/2" production string.

Supplemental Drilling Data is attached.

RECEIVED  
NOV 23 1979  
U.S. GEOLOGICAL SURVEY  
ARTESIA, NEW MEXICO

IN ABOVE SPACE DESCRIBE PROPOSED PROGRAM: If proposal is to deepen or plug back, give data on present productive zone and proposed new productive zone. If proposal is to drill or deepen directionally, give pertinent data on subsurface locations and measured and true vertical depths. Give blowout preventer program, if any.

24.

SIGNED

TITLE

DATE

11-20-79

(This space for Federal or State office use)

PERMIT NO.

APPROVAL DATE

12-10-79

APPROVED BY

TITLE

DATE

CONDITIONS OF APPROVAL, IF ANY:

NEW MEXICO OIL CONSERVATION COMMISSION  
WELL LOCATION AND ACREAGE DEDICATION PLAT

Form O-102  
Supersedes O-128  
Effective 12-65

All distances must be from the outer boundaries of the Section.

Operator <b>FORD CHAPMAN &amp; ASSOCIATES</b>		Lease <b>Coyote-Federal</b>		Well No. <b>1</b>
Unit Letter <b>A</b>	Section <b>34</b>	Township <b>25 South</b>	Range <b>26 East</b>	County <b>Eddy</b>
Actual Footage Location of Well: <b>660</b> feet from the <b>North</b> line and <b>660</b> feet from the <b>East</b> line				
Ground Level Elev. <b>3346.8</b>	Producing Formation <b>Delaware</b>	Wildcat		Estimated Acreage <b>40</b> Acres

1. Outline the acreage dedicated to the subject well by colored pencil or hatchure marks on the plat below.
2. If more than one lease is dedicated to the well, outline each and show the ownership thereof (both as to working interest and royalty).
3. If more than one lease of different ownership is dedicated to the well, have the interests been consolidated by communitization, unitization, force-pooling, etc.?

RECEIVED  
DEC 12 1979  
O. C. C.  
ARTESIA, OFFICE

RECEIVED  
NOV 23 1979  
U.S. GEOLOGICAL SURVEY  
ARTESIA, NEW MEXICO

☐ Yes ☐ No If answer is "yes," type of consolidation \_\_\_\_\_

If answer is "no," list the owners and tract descriptions which have actually been consolidated on the reverse side of this form if necessary.

No allowable will be assigned to the well until all interests have been consolidated by communitization, unitization, forced-pooling, or otherwise, or until a non-standard unit, eliminating such interests, has been approved by the Commission.

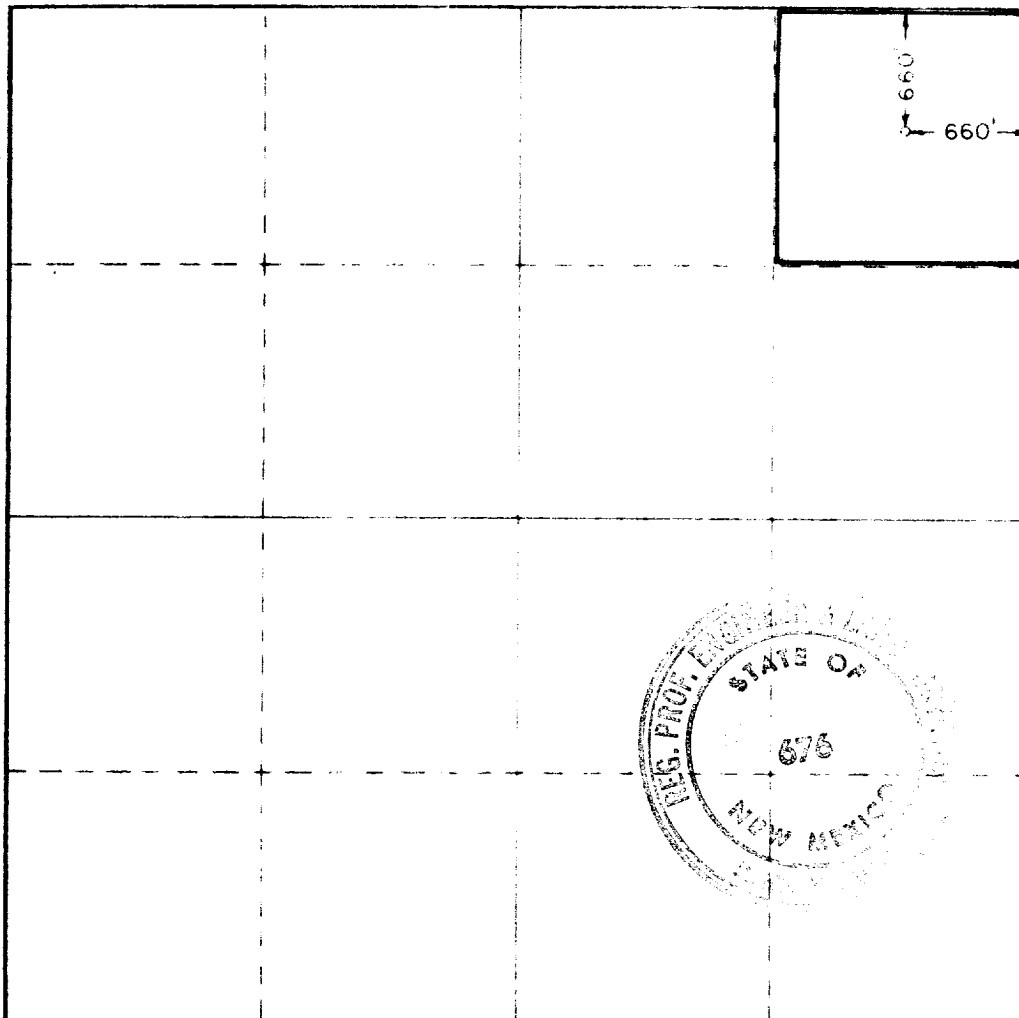

CERTIFICATION

I hereby certify that the information contained herein is true and complete to the best of my knowledge and belief.

*John A. Ruff*  
Agent

Ford Chapman and Associates

11-23-79

I hereby certify that the well location shown on this plat was plotted from field notes of actual surveys made by me or under my supervision and that the same is true and correct to the best of my knowledge and belief.

Date: November 3, 1979

November 3, 1979

Registered Professional Engineer  
and State Surveyor

*John W. West*  
Certificate No. **John W. West 676**

**Ronald J. Eidson 3239**





U.S.G.C.D. COPY  
United States Department of the Interior

RECEIVED

GEOLOGICAL SURVEY

P. O. Drawer U  
Artesia, New Mexico 88210

DEC 12 1979

O. C. C.  
ARTESIA, OFFICE

December 10, 1979

Ford Chapman & Associates  
P. O. Box 2376  
Midland, Texas 79702

Gentlemen:

FORD CHAPMAN & ASSOCIATES Coyote Fed No. 1 660 FNL 660 FEL Sec. 34 T.25S R.26E Eddy County Lease No. NM 19423
--

Above Data Required on Well Sign
----------------------------------

Your APPLICATION FOR PERMIT TO DRILL the above-described well to a depth of 2,100 feet to test the Delaware formation is hereby approved subject to compliance with the OIL AND GAS OPERATING REGULATIONS (30 CFR 221) and the following conditions:

1. Drilling operations authorized are subject to compliance with the GENERAL REQUIREMENTS FOR OIL AND GAS OPERATIONS ON FEDERAL LEASES, dated July 1, 1978.
2. Prior to commencing construction of road, pad, or other associated developments, operator will provide the dirt contractor with a copy of the SURFACE USE PLAN and this approval including the GENERAL REQUIREMENTS.
3. Submit a Daily Report of Operations from spud date until the Well Completion Report (form 9-330) is filed. The progress report should be not less than 8" x 5" in size and each page should identify the well.
4. All permanent above-ground structures and equipment shall be painted in accordance with the attached Painting Requirements. The color used should simulate Sandstone Brown (Federal Standard No. 595A, color 20318 or 30318).
5. Cement behind the 10-3/4" casing must be circulated.
6. Special Stipulations: Follow existing two track to location from abandoned well (BLM).
7. Please have anyone contacting the Survey in regard to this well to identify the well with all of the information required above for the well sign.

Sincerely yours,

GEORGE H. STEWART

George H. Stewart  
Acting District Engineer



SUPPLEMENTAL DRILLING DATA

FORD CHAPMAN AND ASSOCIATES  
WELL NO. 1 COYOTE FEDERAL  
A-34-25S-26

1. SURFACE FORMATION: Salado

2. ESTIMATED TOPS OF GEOLOGIC MARKERS:

Castile	300'
Delaware Lime	2000'
Delaware Sand	2050'

3. ANTICIPATED POSSIBLE WATER AND HYDROCARBON BEARING ZONES:

Fresh Water	None
Oil	2050'

4. PROPOSED CASING AND CEMENTING PROGRAM:

Casing program is shown on form 9-331 C

Cement for surface casing will be circulated.

If a cave string is needed, 7" casing will be set and will be pulled before cementing 4½" production casing.

4½" production casing will be cemented with a minimum of 100 sacks of Class "C" cement.

5. PRESSURE CONTROL EQUIPMENT:

Pressure control equipment will consist of a control valve and oil saver.

6. CIRCULATING MEDIUM:

None, this will be a cable tool hole.

7. AUXILIARY EQUIPMENT:

None anticipated.

8. TESTING, LOGGING AND CORING PROGRAM:

No coring is planned.

Formation tests will be made as warranted by bailing hole down and measuring fluid entry rate.

It is planned that a Gamma Ray - Sonic Log will be run.

9. ABNORMAL PRESSURES, TEMPERATURES OR HYDROGEN SULFIDE GAS:

None anticipated.

10. ANTICIPATED STARTING DATE:

It is planned that drilling operations will commence about December 1, 1979. Duration of drilling and completion operations should be about 15-25 days.

SURFACE USE PLAN  
FOR  
DRILLING, COMPLETING AND PRODUCING

FORD CHAPMAN AND ASSOCIATES  
WELL NO. 1 COYOTE FEDERAL  
660'FNL & 660'FEL SEC. 34-25S-26E  
EDDY COUNTY, NEW MEXICO

**RECEIVED**  
**NOV 23 1979**  
**U.S. GEOLOGICAL SURVEY**  
**ARTESIA, NEW MEXICO**

LOCATED: 20 air miles south of Carlsbad, N. M.  
8 air miles southeast of White City, N. M.

ACCESS: Beginning in Carlsbad at the Pecos-El Paso  
"Y", go 0.2 miles SW to Old Cavern Highway  
Street, turn south and go 20.3 miles (0.7  
miles south of Cottonwood Ranch corral),  
turn west and go 0.9 miles (0.35 miles west  
of gate), turn left on old road and go 0.55  
miles to plugged well (SW-SW Sec 26), turn  
SW and go 0.35 miles to drillsite. See  
attachments "A" & "B").

FEDERAL LEASE: NM 19423

LEASE ISSUED: 11-1-73 for primary term of 10 years.

RECORD LESSEE: 50% - H. N. G. Oil Co.  
50% - Sabine Production Co.

ACRES IN LEASE: 2560

SURFACE OWNERSHIP: Federal

GRAZING PERMITTEE: Elgin Marquardt

POOL: Wildcat (Statewide Rules)

ATTACHMENTS: A. Area Map (1/3" = mile).  
B. Plat showing Existing Roads & Wells.  
C. Topographic Map.  
D. Drilling Pad Layout.

1. EXISTING ROADS:

- A. Existing roads, which are shown on Attachments "A" and "B", are color coded blue.
- B. No repairs to existing roads are considered necessary except for the 0.55 miles of old road going to the plugged well in the SW-SW Sec. 26. This road will be improved by blade scraping.

2. PLANNED ACCESS ROAD:

- A. Length and Width: The proposed new access road will be built in a generally southwest direction and will be approximately 0.3 miles in length and 12 feet in width. The center line of the new road has been staked and flagged with stakes being visible from any one stake to the next. The new road is labeled and color coded orange on Attachment "B".
- B. Surfacing Material: The new road will be covered with the necessary depth of caliche which will be watered, compacted and graded.
- C. Maximum Grade: Less than two percent.
- D. Turnouts: None required.
- E. Drainage Design: New road will be crowned with drainage to each side.
- F. Culverts: None required.
- G. Cuts and Fills: None necessary.
- H. Gates, Cattle Guards: There is a wooden gate at the corral in the center of E $\frac{1}{2}$  Sec. 25 and a wire gate between Secs. 25 and 26. No cattle guards are contemplated.

3. LOCATION OF EXISTING WELLS:

- A. Existing wells in the immediate area are shown on Attachment "B".

4. LOCATION OF EXISTING AND/OR PROPOSED FACILITIES:

- A. There has been previous development on this lease, however existing wells and facilities are owned by another operator and are located 4 miles to the north in Sec. 11.
- B. If the proposed well is productive, the tank battery and flow line will be located on the well pad and no additional surface disturbance will be necessary.

5. LOCATION AND TYPE OF WATER SUPPLY:

- A. It is not contemplated that a water well will be drilled. Water necessary for drilling will be purchased and hauled to the well site over existing and proposed roads shown on Attachment "E".

6. SOURCE OF CONSTRUCTION MATERIALS:

- A. Caliche will be hauled from a pit in SE-NW Sec. 3 on fee land or a pit in SW-NE Sec. 9 on Federal land which was examined by Dr. J. Loring Haskell on 11-21-79. Caliche for surfacing the road and well pad will be trucked over existing and proposed roads shown on Attachment "B".

7. METHODS OF HANDLING WASTE DISPOSAL:

- A. Drill cuttings will be disposed of in the drilling pits.
- B. Drilling fluids will be allowed to evaporate in the drilling pits until the pits are dry.
- C. Water produced during tests will be disposed of in the drilling pits. Oil produced during tests will be stored in test tanks until sold.
- D. Trash, waste paper, garbage, and junk will be buried in a separate trash pit and covered with a minimum of 24 inches of dirt. All waste material will be contained to prevent scattering by the wind. Location of the trash pit is shown on Attachment "D".
- E. All trash and debris will be buried or removed from the wellsite within 30 days after finishing drilling and/or completion operations.



8. ANCILLARY FACILITIES:

- A. None required.

9. WELL SITE LAYOUT:

- A. Attachment "D" shows the relative location of the well pad, mud pit and trash pit with respect to the well bore.
- B. The wellsite is nearly level and no cut and fill is necessary.
- C. The drillsite has been surveyed and the pad area has been staked and flagged.

10. PLANS FOR RESTORATION OF THE SURFACE:

- A. After completion of drilling and/or completion operations, all equipment and other material not needed for operations will be removed. Pits will be filled and the location cleaned of all trash and junk to leave the wellsite in as aesthetically pleasing condition as possible.
- B. Any unguarded pits containing fluids will be fenced until they are filled.
- C. After abandonment, all equipment, trash and junk will be removed and the location cleaned. Any special rehabilitation and/or special revegetation requirements of the surface management agency will be complied with and accomplished as expeditiously as possible.

11. OTHER INFORMATION:

- A. Topography: The land surface is nearly level. Local and regional slope is to the southeast. See Attachment "C".
- B. Soil: Loamy gyp.
- C. Flora and Fauna: The vegetative cover is sparse consisting mostly of greasewood with some mesquite, yucca, cholla and other range weeds and grasses. Only jackrabbits were observed but it is likely that wildlife in the area is that typical of semi-arid desert land and includes coyotes, rodents, reptiles, dove and quail.

- D. Ponds and Streams: None.
- E. Residences and Other Structures: There are no occupied dwellings within three miles of the proposed drillsite. Nearest windmill is approximately one mile to the north.
- F. Archaeological, Historical and Other Cultural Sites: None observed in the area.
- G. Land Use: Grazing and hunting in season.
- H. Surface Ownership: Federal.

12. OPERATOR'S REPRESENTATIVE:

Representative responsible for assuring compliance with the approved Surface Use Plan is:

Ford Chapman  
P. O. Box 2376  
Midland, Texas 79702  
Office Phone: 915-682-3217  
Home Phone: 915-682-0318

13. CERTIFICATION:

I hereby certify that I, or persons under my direct supervision, have inspected the proposed drill site and access route; that I am familiar with the conditions which presently exist; that the statements made in the plan are, to the best of my knowledge, true and correct; and, that the work associated with the operations proposed herein will be performed by Ford Chapman and Associates and its contractors and sub-contractors in conformity with this plan and the terms and conditions under which it is approved.

11-23-79  
Date

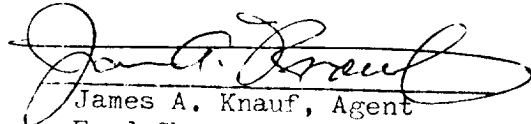
  
James A. Knauf, Agent  
Ford Chapman and Associates

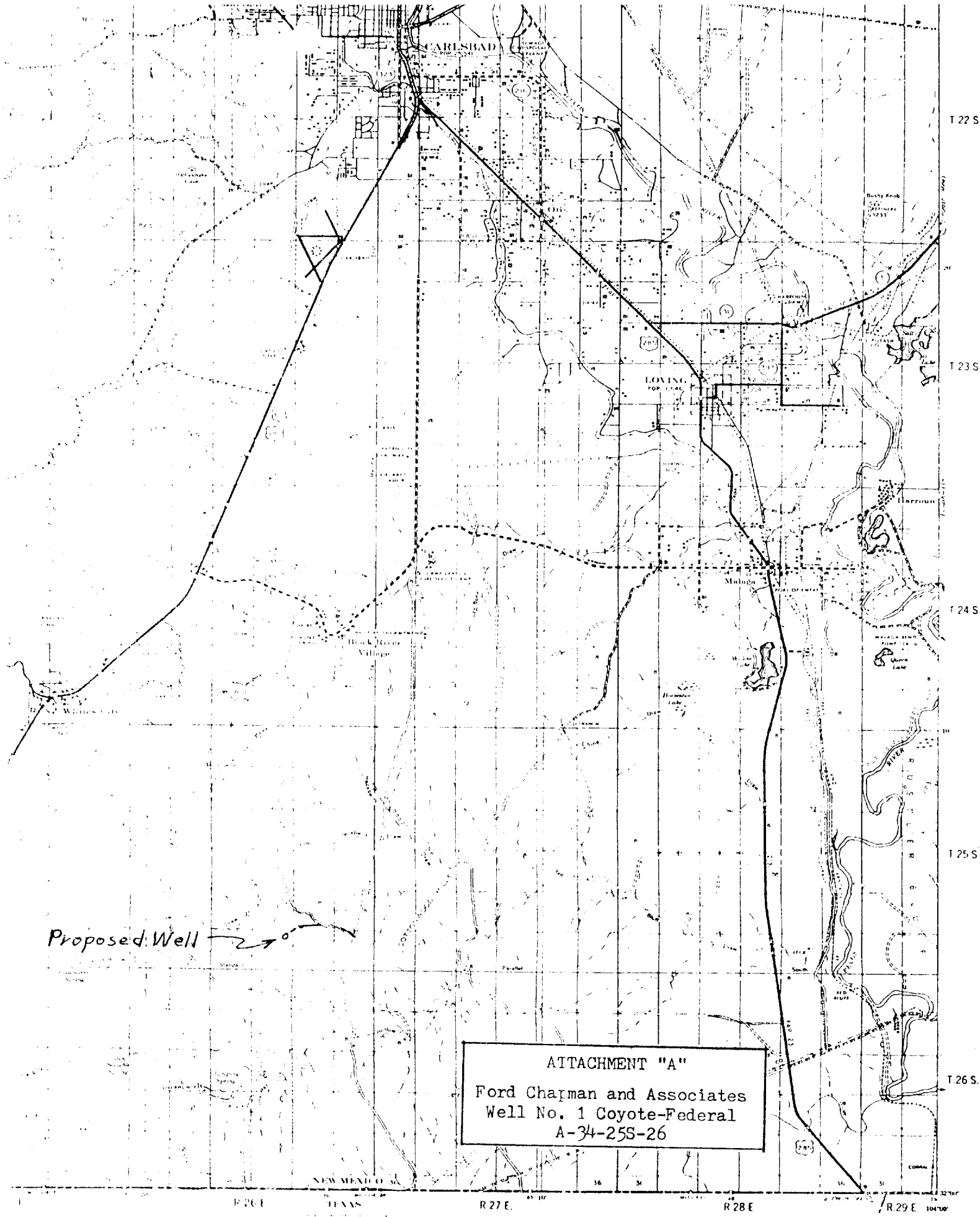

Proposed Well →

ATTACHMENT "A"  
Ford Chapman and Associates  
Well No. 1 Coyote-Federal  
A-34-25S-26

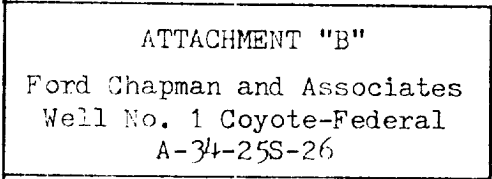

Ford Chapman and Associates  
Well No. 1 Coyote-Federal  
A-34-25S-26



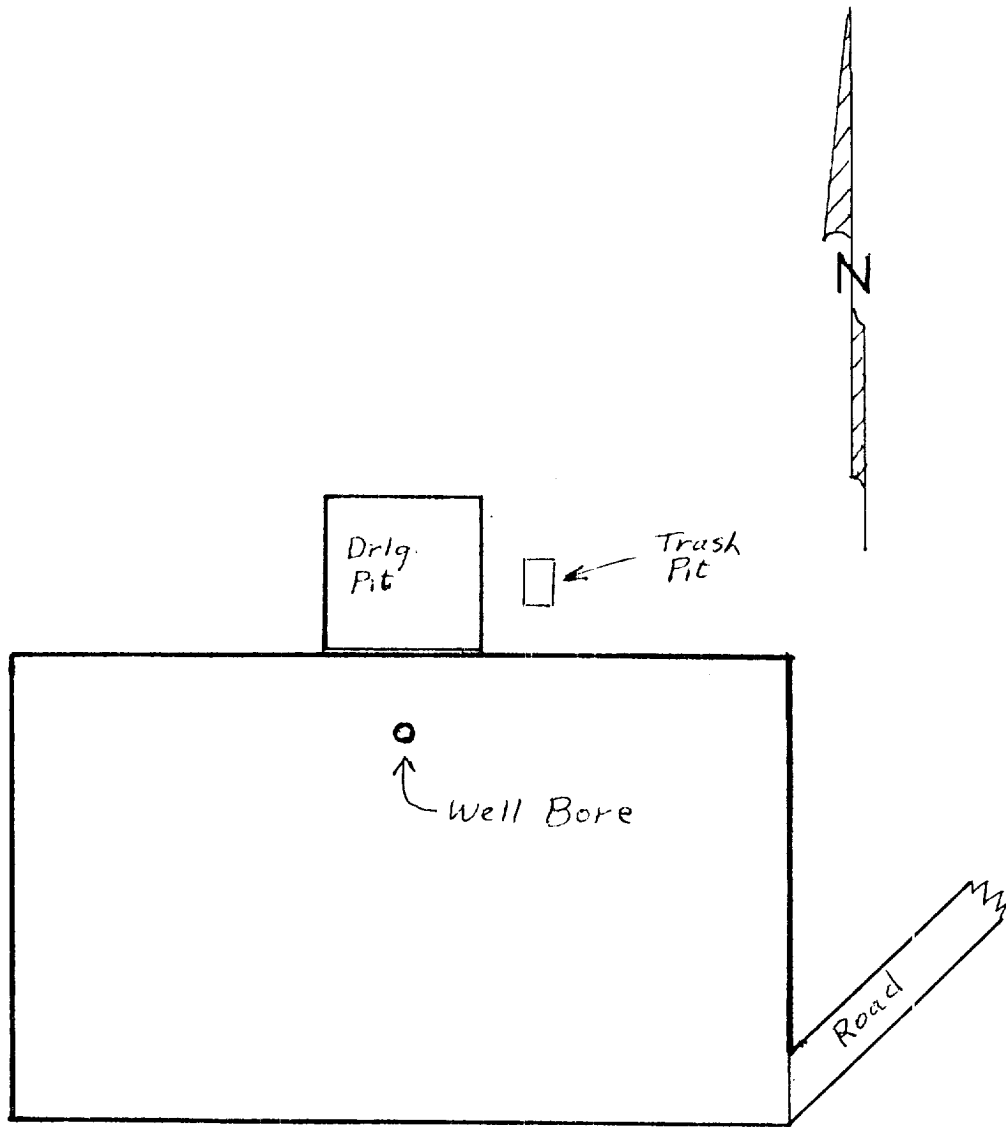

ATTACHMENT "D"  
Ford Chapman and Associates  
Well No. 1 Coyote-Federal  
A-34-25S-26