

UNITED STATES  
DEPARTMENT OF THE INTERIOR  
BUREAU OF LAND MANAGEMENT

OIL CONS COM  
Drawer DD 88210  
Artesia, NM FORM APPROVED  
Budget Bureau No. 1004-0135  
Expires: March 31, 1993

C/SF

**SUNDRY NOTICES AND REPORTS ON WELLS**

Do not use this form for proposals to drill or deepen or reentry to a different reservoir.

Use "APPLICATION FOR PERMIT-" for such proposals

**SUBMIT IN TRIPLICATE**

1. Type of well <input type="checkbox"/> Oil <input checked="" type="checkbox"/> Gas <input type="checkbox"/> Other	5. Lease Designation and Serial No. NM 41645
2. Name of Operator CHEVRON U.S.A. PRODUCTION CO., INC.	6. If Indian, Allottee or Tribe Name
3. Address and Telephone No. P. O. BOX 1150, MIDLAND, TX 79702 Attn: Reggie Holzer (915) 687-7182	7. If Unit or CA, Agreement Designation
4. Location of Well (Footage, Sec., T., R., M., or Survey Description) Section 13, T25S - R26E 1,650' FNL - 1.650' FWL Unit F	8. Well Name and No. Federal 13 <del>NEW</del> Com Well No. 1
	9. API Well No. API No. 3001523492 <del>2000</del>
	10. Field and Pool, or Exploratory Area White City Pennsylvanian
	11. County or Parish, State Eddy County, NM

**CHECK APPROPRIATE BOX(S) TO INDICATE NATURE OF NOTICE, REPORT, OR OTHER DATA**

12 TYPE OF SUBMISSION	TYPE OF ACTION	
<input checked="" type="checkbox"/> Notice of Intent	<input type="checkbox"/> Abandonment	<input type="checkbox"/> Change of Plans
<input type="checkbox"/> Subsequent Report	<input type="checkbox"/> Recompletion	<input type="checkbox"/> New Construction
<input type="checkbox"/> Final Abandonment Notice	<input type="checkbox"/> Plugging Back	<input type="checkbox"/> Non-Routine Fracturing
	<input type="checkbox"/> Casing Repair	<input type="checkbox"/> Water Shut-Off
	<input type="checkbox"/> Altering Casing	<input type="checkbox"/> Conversion to Injection
	<input checked="" type="checkbox"/> Other Vessel Install	<input type="checkbox"/> Dispose Water

(Note: Report results of multiple completion on Well Completion or Recompletion Report and Log form.)

13. Describe Proposed or Completed Operations (Clearly state all pertinent details, and give pertinent dates, including estimate date of starting any proposed work. If well is directionally drilled, give subsurface locations and measured and true vertical depths for all markers and zones pertinent to this work.)\*

Chevron submits for your approval the replacement of the gas production unit with a vertical metering separator on the subject well. Since the flowing tubing pressure has declined over the years, a gas production unit is no longer needed for well control. The new vessel will separate the gas and liquids for measurement and minimize the pressure drop in the system resulting in improved gas flow rates. The vessel will be located on the existing well site and will not require additional surface disturbance. It will be painted with BLM approved colors. The updated process flow diagram is enclosed for you review and approval.

RECEIVED

RECEIVED

AUG 21 1995

AUG 21 1995

OIL CON. DIV.  
DIST. 2

OIL CON. DIV.  
DIST. 2

14. I hereby certify that the foregoing is true and correct

Signed Reggie Holzer Title Sr. Facilities Engineer Date June 29, 1995

(This space for Federal or State office use)

Approved by \_\_\_\_\_ Title \_\_\_\_\_ Date \_\_\_\_\_  
Conditions of approval, if any:

Title 18 U.S.C. Section 1001, makes it a crime for any person knowingly and willfully to make to any department or agency of the United States any false, fictitious or fraudulent statements or representations as to any matter within its jurisdiction.

\*See Instructions on Reverse Side

V-1  
HP SEPARATOR  
24" X 10' VERT.  
MAWP 1440 PSI

I-1  
15'-6" X 16' STEEL  
500 BBL. TANK

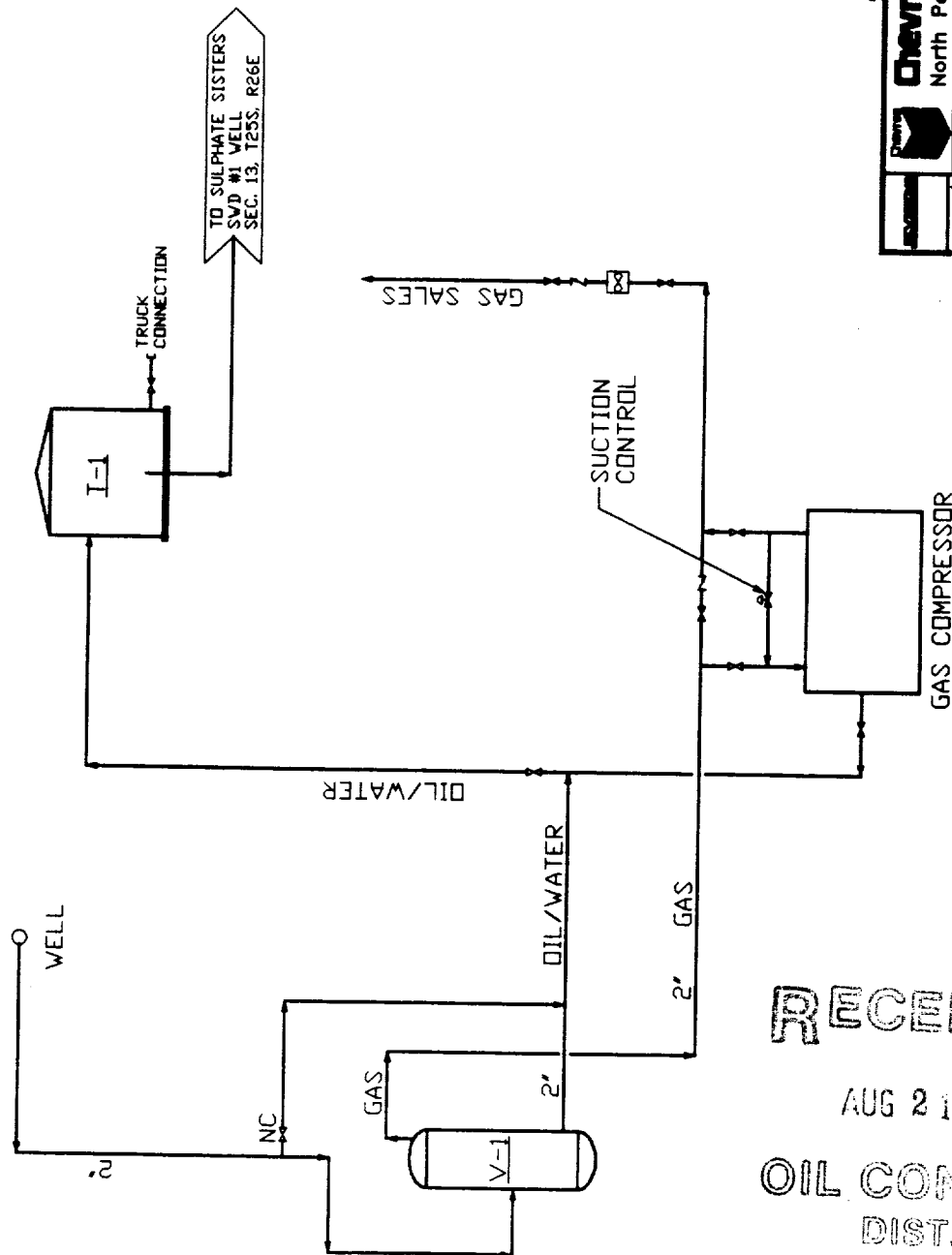

RECEIVED  
AUG 21 1995  
OIL CON. DIV.  
DIST. 2

API 30-015-23492



**U.S.A. Inc.**  
North Permian Profit Center

FEDERAL 13 GAS COM NO. 1  
WHITE CITY PENN FIELD  
SECTION 13, T25S, R26E  
1650' FNL 1650' FWL  
PROCESS FLOW DIAGRAM

Eddy County, NM41645 New Mexico  
04-03-95  
D-MAR-00-06 (TINY 2)