

SURFACE USE AND OPERATIONS PLAN  
TO RE-ENTER A PLUGGED AND ABANDONED WELL

BBC, INC.  
WELL NO.1 ROSS DRAW FEDERAL  
660'FNL & 1980'FWL SEC.33, T.26 S., R.30 E.  
EDDY COUNTY, NEW MEXICO

LOCATED: 19 air miles southeast of Malaga, New Mexico.

FEDERAL LEASE NUMBER: NM-35607.

LEASE ISSUED: March 1, 1979 for 10 years.

RECORD LESSEE: Ellwade Corporation.

ACRES IN LEASE: 369.50.

SURFACE OWNERSHIP: Federal.

GRAZING PERMITTEE: W. D. Johnson  
c/o Columbia Union National Bank & Trust  
Company of Kansas City  
P. O. Box 1933  
Midland, Texas 79702

EXHIBITS: A. Road Map  
B. Plat Showing Existing Wells and Existing Roads  
C. Drilling Rig Layout  
D. Topo Plat

1. EXISTING ROADS:

- A. Exhibit "A" is a road map showing the location of the proposed re-entry well as staked. Point "A" on the plat is on US-285 approximately 13 miles south of Malaga, New Mexico, and between mileposts Nos. 3 and 4. To reach the well site from this point, exit US-285 to the east on the paved road. From this point, cross the railroad at 2.4, the river at 3.7 miles and pass a ranch house at 6.5 miles. About 0.5 mile past the ranch house turn south through the cattle guard. From this point cross Brush Draw at 1.7 miles. The road forks at 1.8 miles - keep right. The road forks again at 2.3 miles - go left. From this point, go southeasterly 2.3 miles and turn south and go 1.6 miles to intersect an east-west pipeline road. Turn east onto the pipeline road and go 1.7 miles. The proposed well site is then 660' south of this point.
- B. Exhibit "B" is a plat showing existing roads in the vicinity of the well site. Existing roads are color coded.
- C. Any repairs to existing roads do not appear necessary at the present time.

2. PLANNED ACCESS ROAD:

- A. No new road will be needed. The road constructed to drill the well originally is adequate and will be used.

3. LOCATION OF EXISTING WELLS:

- A. Existing wells in the area are shown on Exhibit "B".

4. LOCATION OF EXISTING AND/OR PROPOSED FACILITIES:

- A. This well is to be re-entered and completed for salt water disposal. Necessary injection facilities will be located on the existing well pad.

5. LOCATION AND TYPE OF WATER SUPPLY:

- A. It is not contemplated that a water well will be drilled. Water necessary for re-entry operations will be trucked to the well site.

6. SOURCE OF CONSTRUCTION MATERIALS:

- A. Any caliche needed for construction work will be taken from an existing pit on Federal land in the SW $\frac{1}{4}$ SW $\frac{1}{4}$  of Section 27, T.26 S., R.30 E., Eddy County, New Mexico. Location of the caliche pit is shown on Exhibit "B".

7. METHODS OF HANDLING WASTE MATERIAL:

- A. Drill cuttings will be disposed of in the drilling pits.
- B. Drilling fluids will be allowed to evaporate in the drilling pits until the pits are dry.
- C. Water produced during tests will be disposed of in the drilling pits.
- D. Oil produced during tests will be stored in test tanks until sold.
- E. Trash, waste paper, garbage and junk will be buried in a separate trash pit and covered with a minimum of 24 inches of dirt. All waste material will be contained to prevent scattering by the wind. Location of the trash pit is shown on Exhibit "C".
- F. All trash and debris will be buried or removed from the well site within 30 days after completion of drilling and/or completion operations.

8. ANCILLARY FACILITIES:

- A. None required.

9. WELL SITE LAYOUT:

- A. Exhibit "C" shows the existing well pad and existing access road. Equipment needed to accomplish re-entry will consist only of an oil well pulling unit. The existing pad size is adequate. It may be necessary to re-open a small pit in the old pit area.
- B. Archaeological examination of the well site area was accomplished prior to drilling the well originally.

10. PLANS FOR RESTORATION OF THE SURFACE:

- A. After completion of recompletion operations, all equipment and other material not needed for operations will be removed. Pits will be filled on the location will be cleaned of all trash and junk to

leave the well site in an as aesthetically pleasing condition as possible.

- B. Any unguarded pits containing fluids will be fenced until they are filled.
- C. After abandonment, all equipment, trash and junk will be removed and the well site will be cleaned. Any special rehabilitation and/or special revegetation requirements of the surface management agency will be complied with and will be accomplished as expeditiously as possible.

11. OTHER INFORMATION:

- A. Topography: The land surface in the area is relatively level. Regionally, land slope is to the southwest.
- B. Soil: Top soil at the well site is sandy loam.
- C. Flora and Fauna: The vegetative cover is sparse and consists of mesquite, greasewood, yucca, weeds and range grasses. Wildlife in the area is that typical of semi-arid desert land and includes coyotes, rabbits, rodents, reptiles, dove and quail.
- D. Ponds and Streams: There are no lakes, rivers, streams or ponds in the area.
- E. Residences and Other Structures: There are no occupied dwellings or windmills within two miles of the proposed well site.
- F. Archaeological, Historical and Other Cultural Sites: None observed in the area.
- G. Land Use: Oil and gas production, grazing, and hunting in season.
- H. Surface Ownership: Federal.

12. OPERATOR'S REPRESENTATIVE:

The representative responsible for assuring compliance with

the approved Surface Use and Operations Plan is:

Nolan H. Brunson, Jr.  
BBC, Inc.  
101 E. Marland, Suite 112  
Hobbs, New Mexico 88240  
Office Phone: 505-393-6169

13. CERTIFICATION:

I hereby certify that I, or persons under my direct supervision, have inspected the proposed drill site and access route; that I am familiar with the conditions which presently exist; that the statements made in this plan are, to the best of my knowledge, true and correct; and, that the work associated with the operations proposed herein will be performed by BBC, INC. and its contractors and sub-contractors in accordance with this plan and the terms and conditions under which it was approved.

9-26-83

Date: \_\_\_\_\_

  
Arthur R. Brown, Agent for  
BBC, INC.

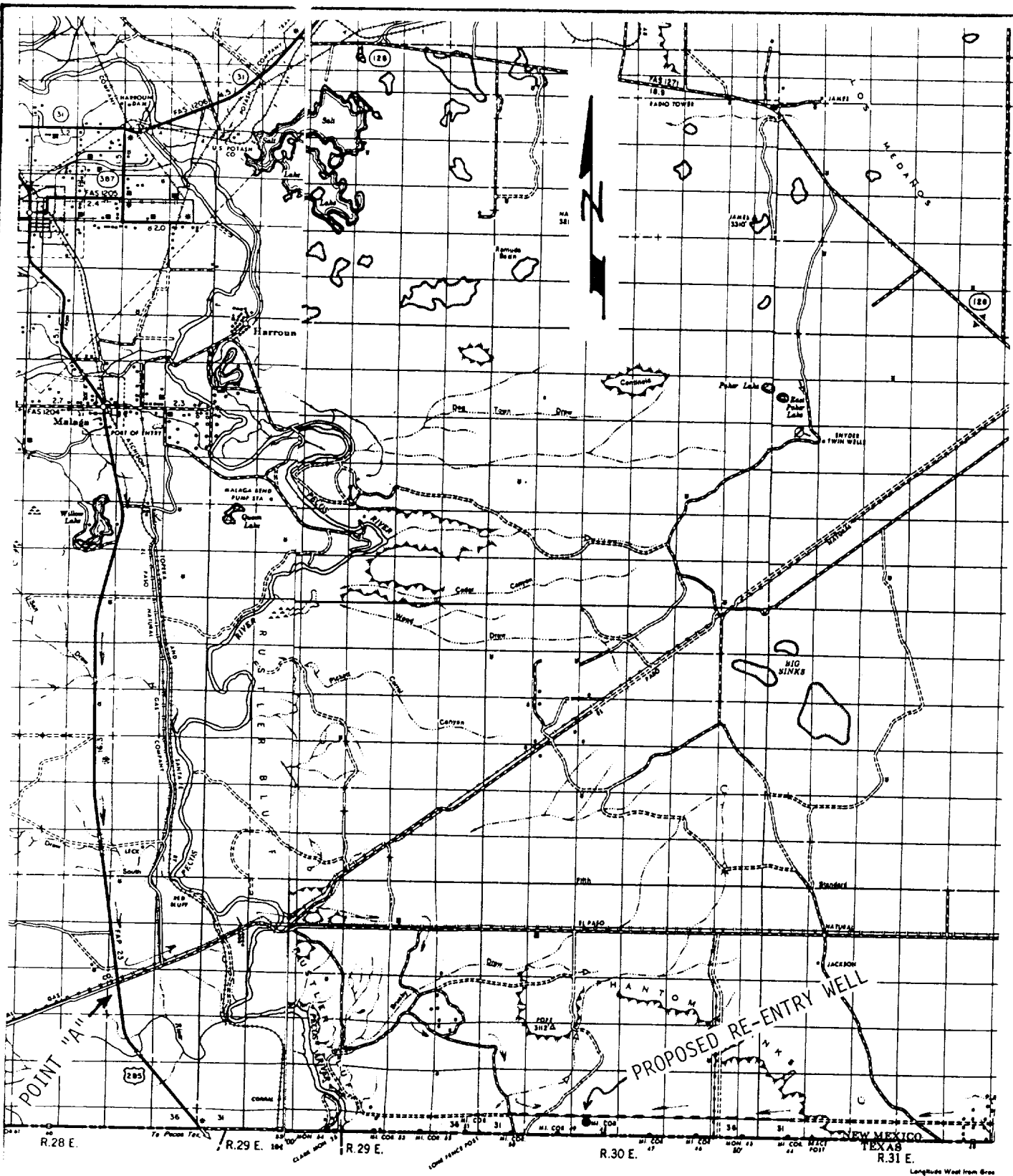

# EXHIBIT "A"

BBC, INC.  
 WELL NO.1 ROSS DRAW FEDERAL  
 660'FNL & 1980'FWL SEC.33, T.26 S., R.30 E.  
 EDDY COUNTY, N.M. SCALE: 1/3" = 1 MI.

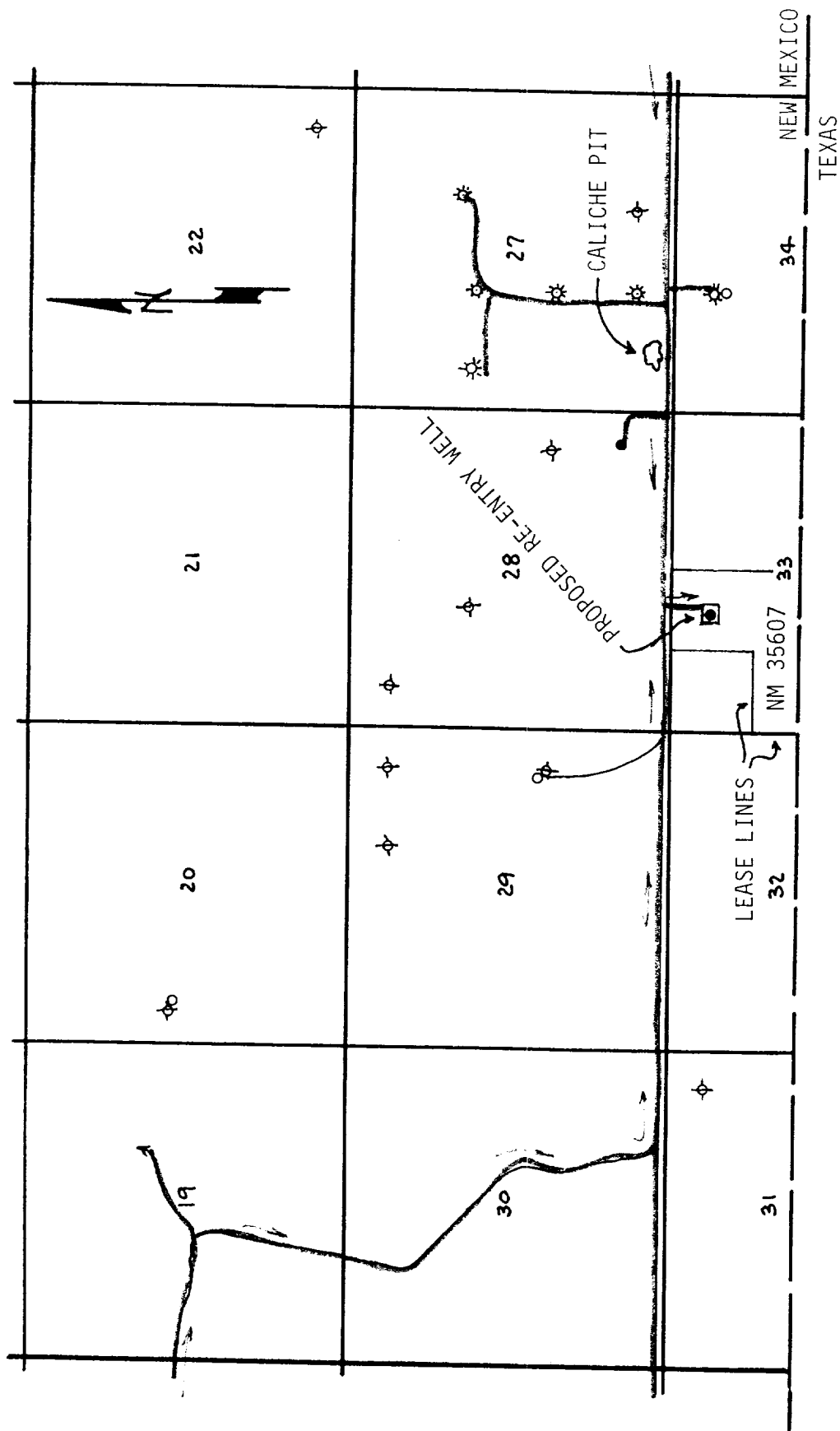

# LEGEND:

- Oil Well
- Gas Well
- Plugged Well
- Proposed Re-Entry
- Existing Caliche Road

## EXHIBIT "B"

BBC, INC.

WELL NO.1 ROSS DRAW FEDERAL  
660'FNL & 1980'FWL SEC.33, T.26 S., R.30 E.  
EDDY COUNTY, N.M. SCALE: 2" = 1 MI.

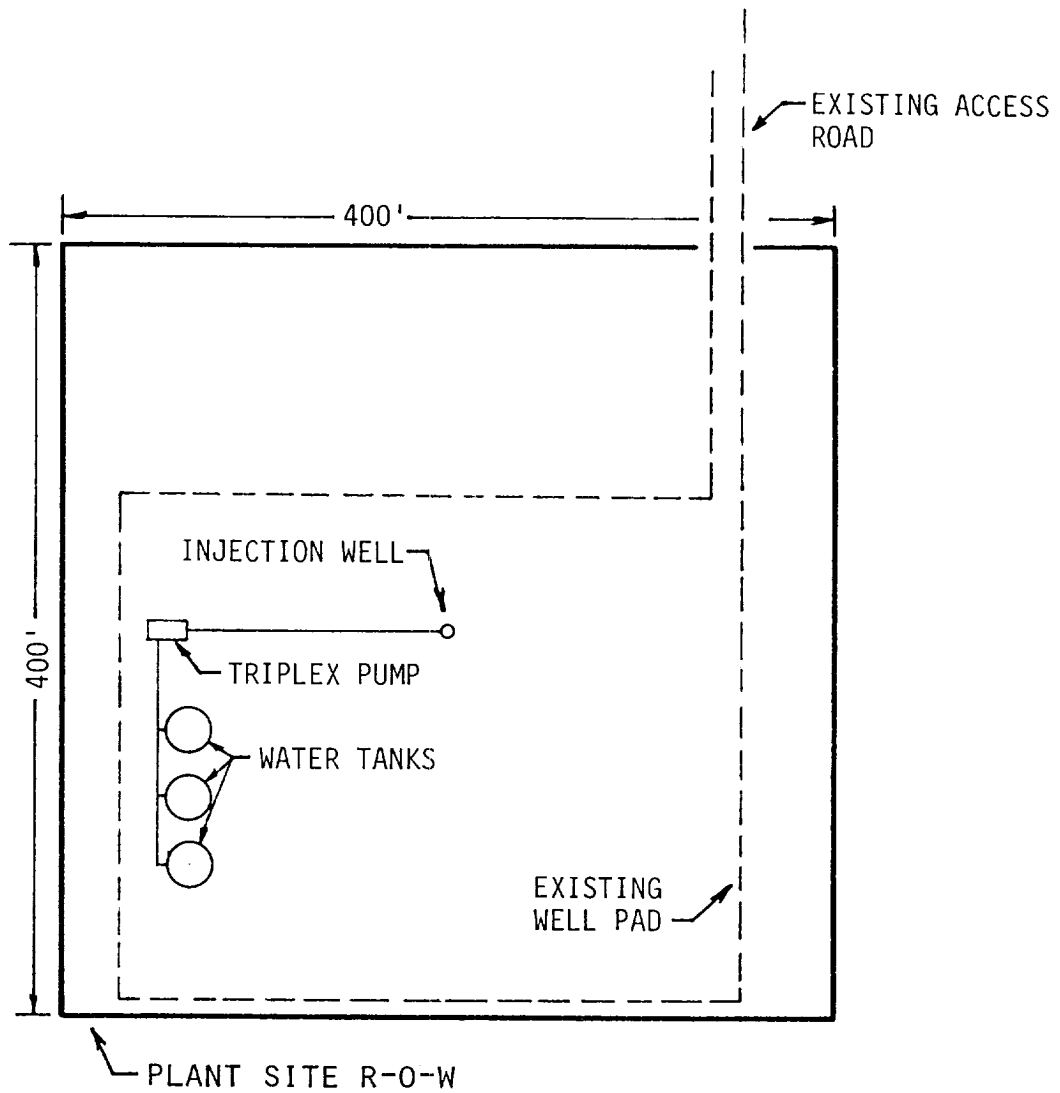

EXHIBIT "C"

BBC, INC.

PLANT SITE LAYOUT  
SALT WATER DISPOSAL FACILITY

WELL NO.1 ROSS DRAW FEDERAL  
660' FNL & 1980' FWL SEC.33, T.26 S., R.30 E.  
EDDY COUNTY, N.M.



UNITED STATES  
DEPARTMENT OF THE INTERIOR  
GEOLOGICAL SURVEY

**SUNDRY NOTICES AND REPORTS ON WELLS**

(Do not use this form for proposals to drill or to deepen or plug back to a different reservoir. Use Form 9-331-C for such proposals.)

1. oil ☐ well gas ☐ well other ☒ DRY HOLE
2. NAME OF OPERATOR  
IKE LOVELADY, INC. ✓
3. ADDRESS OF OPERATOR  
101 E. MARLAND, #105, HOBBS, NM 88240
4. LOCATION OF WELL (REPORT LOCATION CLEARLY. See space 17 below.)  
AT SURFACE: 660' FNL AND 1980' FWL OF SEC. 33  
AT TOP PROD. INTERVAL:  
AT TOTAL DEPTH:
16. CHECK APPROPRIATE BOX TO INDICATE NATURE OF NOTICE, REPORT, OR OTHER DATA

REQUEST FOR APPROVAL TO:

- TEST WATER SHUT-OFF ☐  
FRACTURE TREAT ☐  
SHOOT OR ACIDIZE ☐  
REPAIR WELL ☐  
PULL OR ALTER CASING ☐  
MULTIPLE COMPLETE ☐  
CHANGE ZONES ☐  
ABANDON\* ☐  
(other) ☐

SUBSEQUENT REPORT OF:

RECEIVED BY  
NOV 09 1983  
O. C. D.  
ARTESIA, OFFICE  
XXK

5. LEASE  
NM-35607
6. IF INDIAN, ALLOTTEE OR TRIBE NAME
7. UNIT AGREEMENT NAME
8. FARM OR LEASE NAME  
ROSS DRAW FEDERAL COM
9. WELL NO.  
1
10. FIELD OR WILDCAT NAME  
WILDCAT
11. SEC., T., R., M., OR BLK. AND SURVEY OR AREA  
SEC. 33, T. 26 S., R. 30 E.
12. COUNTY OR PARISH  
EDDY
13. STATE  
NEW MEXICO
14. API NO.
15. ELEVATIONS (SHOW DF, KDB, AND WD)  
2965 KB

RECEIVED  
NOTE: Report results of multiple completion or zone change on Form 9-331-C.  
NOV 07 1983  
OIL & GAS

17. DESCRIBE PROPOSED OR COMPLETED OPERATIONS (Clearly state all pertinent details, and give pertinent dates, including estimated date of starting any proposed work. If well is directionally drilled, give subsurface locations and measured and true vertical depths for all markers and zones pertinent to this work.)\*

THIS WELL PREVIOUSLY PLUGGED BACK TO 11,265 FEET AND HOLE FILLED WITH 10# FLUID.

PERMANENT ABANDONMENT OF THIS WELL COMPLETED BY PLACING PLUGS AS FOLLOWS:

60 sack cement plug in interval 7150-7300 feet

Set bridge plug at 4620 feet and capped with 35 feet of cement.

Abandonment work completed 11-7-83

Subsurface Safety Valve: Manu. and Type \_\_\_\_\_ Set @ \_\_\_\_\_ Ft.

18. I hereby certify that the foregoing is true and correct

SIGNED Arthur R. Brown TITLE Agent DATE November 7, 1983

(ORIG. SGD.) DAVID R. GLASS (This space for Federal or State office use)

APPROVED BY \_\_\_\_\_ TITLE \_\_\_\_\_ DATE \_\_\_\_\_  
CONDITIONS OF APPROVAL, IF ANY

NOV 7 1983

## NM OIL CONS. COMMISSION

Drawer DD

Artesia, NM 88210 UNITED STATES

DEPARTMENT OF THE INTERIOR  
GEOLOGICAL SURVEY

SUBMIT IN DUPLICATE\*

(See other in-  
structions on  
reverse side)Form approved,  
Budget Bureau No. 42-R355.5.

## WELL COMPLETION OR RECOMPLETION REPORT AND LOG

RECEIVED BY

1a. TYPE OF WELL:		OIL WELL <input type="checkbox"/>	GAS WELL <input type="checkbox"/>	DRY <input checked="" type="checkbox"/>	Other <input type="checkbox"/>		
b. TYPE OF COMPLETION:		NEW WELL <input checked="" type="checkbox"/>	WORK OVER <input type="checkbox"/>	DEEP-EN <input type="checkbox"/>	PLUG BACK <input type="checkbox"/>	DIFF. RESVR. <input type="checkbox"/>	Other <input type="checkbox"/>
2. NAME OF OPERATOR		IKE LOVELADY, INC. ✓				ARTESIA, OFFICE	
3. ADDRESS OF OPERATOR		101 E. MARLAND, #105, HOBBS, NEW MEXICO 88240					
4. LOCATION OF WELL (Report location clearly and in accordance with any State requirements)*		At surface 660' FNL AND 1980' FWL OF SECTION 33					
At top prod. interval reported below							
At total depth							
14. PERMIT NO.		DATE ISSUED		12. COUNTY OR PARISH		13. STATE	
				EDDY		NEW MEXICO	
15. DATE SPUDDED	16. DATE T.D. REACHED	17. DATE COMPL. (Ready to prod.)	18. ELEVATIONS (DF, RKB, RT, GR, ETC.)*		19. ELEV. CASINGHEAD		
5-21-81	10-12-81	-	2965 KB				
20. TOTAL DEPTH, MD & TVD	21. PLUG, BACK T.D., MD & TVD	22. IF MULTIPLE COMPL., HOW MANY*	23. INTERVALS DRILLED BY	ROTARY TOOLS	CABLE TOOLS		
14,365'	-	-	→	ALL			
24. PRODUCING INTERVAL(S), OF THIS COMPLETION—TOP, BOTTOM, NAME (MD AND TVD)*					25. WAS DIRECTIONAL SURVEY MADE		
NONE					NO		
26. TYPE ELECTRIC AND OTHER LOGS RUN					27. WAS WELL CORED		
GR-CNL LATEROLOG					NO		
28. CASING RECORD (Report all strings set in well)							
CASING SIZE	WEIGHT, LB./FT.	DEPTH SET (MD)	HOLE SIZE	CEMENTING RECORD		AMOUNT PULLED	
20"	CONDUCTOR	70'	26"	CEMENTED TO SURFACE		NONE	
13-3/8"	68#	3290'	17-1/2"	3815 SACKS		NONE	
9-5/8"	47# & 53.5#	11,580'	12-1/4"	2880 SACKS		NONE	
29. LINER RECORD				30. TUBING RECORD			
SIZE	TOP (MD)	BOTTOM (MD)	SACKS CEMENT*	SCREEN (MD)	SIZE	DEPTH SET (MD)	PACKER SET (MD)
7-5/8"	11,371	13,707	630	-			
4-1/2"	13,471	14,365	150	-			
31. PERFORATION RECORD (Interval, size and number)				32. ACID, SHOT, FRACTURE, CEMENT SQUEEZE, ETC.			
14,282-14,290		12,414-12,445		DEPTH INTERVAL (MD)		AMOUNT AND KIND OF MATERIAL USED	
14,216-14,240		12,000-12,036		14,282-14,290		1500 Gals. Acid	
14,157-14,167		11,876-11,961		14,216-14,240		3000 Gals. Acid	
13,435-13,560				14,157-14,167		2000 Gals. Acid	
				CONTINUED ON BACK			
33.* PRODUCTION							
DATE FIRST PRODUCTION		PRODUCTION METHOD (Flowing, gas lift, pumping—size and type of pump)				WELL STATUS (Producing or shut-in)	
						PLUGGED & ABD.	
DATE OF TEST	HOURS TESTED	CHOKE SIZE	PROD'N. FOR TEST PERIOD	OIL—BBL.	GAS—MCF.	WATER—BBL.	GAS-OIL RATIO
FLOW. TUBING PRESS.	CASING PRESSURE	24-HOUR RATE	PROD. TEMP.	GAS—MCF.	WATER—BBL.	OIL GRAVITY-API (CORR.)	
34. DISPOSITION OF GAS (Sold, used for fuel, vented, etc.)				TEST WITNESSED BY			
35. LIST OF ATTACHMENTS				OIL & GAS			
WELL LOG, DEVIATION TESTS				ROSWELL, NEW MEXICO			
36. I hereby certify that the foregoing and attached information is complete and correct as determined from all available records							
SIGNED		TITLE		Agent		DATE	
Arthur R. Brown						11-7-83	

\*(See Instructions and Spaces for Additional Data on Reverse Side)

# INSTRUCTIONS

**General:** This form is designed for submitting a complete and correct well completion report and log on all types of lands and leases to either a Federal agency or a State agency, or both, pursuant to applicable Federal and/or State laws and regulations. Any necessary special instructions concerning the use of this form and the number of copies to be submitted, particularly with regard to local, area, or regional procedures and practices, either are shown below or will be issued by, or may be obtained from, the local Federal and/or State office. See instructions on items 22 and 24, and 23, below regarding separate reports for separate completions.

If not filed prior to the time this summary record is submitted, copies of all currently available logs (drillers, geologists, sample and core analysis, all types electric, etc.), formation and pressure tests, and directional surveys, should be attached hereto, to the extent required by applicable Federal and/or State laws and regulations. All attachments should be listed on this form, see item 35.

**Item 4:** If there are no applicable State requirements, locations on Federal or Indian land should be described in accordance with Federal requirements. Consult local State or Federal office for specific instructions.

**Item 18:** Indicate which elevation is used as reference (where not otherwise shown) for depth measurements given in other spaces on this form and in any attachments.

**Items 22 and 24:** If this well is completed for separate production from more than one interval zone (multiple completion), so state in item 22, and in item 24 show the producing interval, or intervals, top(s), bottom(s) and name(s) (if any) for only the interval reported in item 33. Submit a separate report (page) on this form, adequately identified, for each additional interval to be separately produced, showing the additional data pertinent to such interval.

**Item 29: "Sacks Cement":** Attached supplemental records for this well should show the details of any multiple stage cementing and the location of the cementing tool.

**Item 33:** Submit a separate completion report on this form for each interval to be separately produced. (See instruction for items 22 and 24 above.)

37. SUMMARY OF POROUS ZONES: SHOW ALL IMPORTANT ZONES OF POROSITY AND CONTENTS THEREOF: CORED INTERVALS; AND ALL DRILL-STEM TESTS, INCLUDING DEPTH INTERVAL TESTED, CUSHION USED, TIME TOOL OPEN, FLOWING AND SHUT-IN PRESSURES, AND RECOVERIES		38. GEOLOGIC MARKERS													
FORMATION	TOP	BOTTOM	DESCRIPTION, CONTENTS, ETC.												
			NAME												
			MEAS. DEPTH												
			TRUE VERT. DEPTH												
			Delaware Lime	3290											
			Delaware Sand	3336											
			Bone Springs	7182											
			Wolfcamp	11,752											
			Morrow	13,400											
			CONTINUED FROM OTHER SIDE:												
			<table border="1"> <thead> <tr> <th>DEPTH INTERVAL</th> <th>ACID</th> </tr> </thead> <tbody> <tr> <td>13,435-13,560</td> <td>6500 Gals. Acid</td> </tr> <tr> <td>12,414-12,445</td> <td>7500 Gals. Acid</td> </tr> <tr> <td>12,000-12,036</td> <td>8250 Gals. Acid</td> </tr> <tr> <td>11,876-11,961</td> <td>15,000 Gals. Acid</td> </tr> </tbody> </table>			DEPTH INTERVAL	ACID	13,435-13,560	6500 Gals. Acid	12,414-12,445	7500 Gals. Acid	12,000-12,036	8250 Gals. Acid	11,876-11,961	15,000 Gals. Acid
DEPTH INTERVAL	ACID														
13,435-13,560	6500 Gals. Acid														
12,414-12,445	7500 Gals. Acid														
12,000-12,036	8250 Gals. Acid														
11,876-11,961	15,000 Gals. Acid														

# NEW MEXICO OIL CONSERVATION COMMISSION

RECEIVED NOV 25 1981

OPERATOR Ike Lovelady, Inc. ADDRESS 407 C & K Petroleum  
 FIELD \_\_\_\_\_ LEASE Ross Draw WELL NO. 1  
 LOCATION Section 33-T-26-S R-30-E Eddy County, NM

## DEVIATION RECORD

DEPTH	DEGREES	DEPTH	DEGREES	DEPTH	DEGREES	DEPTH	DEGREES
575	3/4	3,907	3/4	11,613	1		
950	2 1/2	4,469	1	12,027	1		
1,052	2 1/2	4,998	1 1/4	13,207	1		
1,144	2 1/2	5,208	1/2	13,565	1 1/4		
1,239	2 1/4	5,910	1	13,706	1 3/4		
1,390	1 1/2	6,502	3/4	13,884	1		
1,612	1 1/4	6,673	1	14,130	1		
1,800	1 3/4	7,155	1 1/2				
2,018	1 3/4	7,255	1 1/2				
2,302	2 1/2	7,653	1 1/2				
2,460	2 1/4	8,118	2				
2,530	2 1/4	8,588	1 3/4				
2,800	1 3/4	8,962	1 3/4				
3,147	2 1/2	9,270	1 3/4				
3,210	2 1/4	9,607	3/4				
3,290	13/4	10,137	1/2				
3,487	1	10,640	1.14				

Certification of personal knowledge of Deviation Record:

I hereby certify that I have personal knowledge of the data and facts placed on this form, and that such information is true and complete.

*[Signature]*