

UNITED STATES
DEPARTMENT OF THE INTERIOR
GEOLOGICAL SURVEY

30-015-24034

APPLICATION FOR PERMIT TO DRILL, DEEPEN, OR PLUG BACK

1a. TYPE OF WORK

DRILL ☒

DEEPEN ☐

PLUG BACK ☐

b. TYPE OF WELL

OIL
WELL ☒

GAS
WELL ☐

OTHER

SINGLE
ZONE ☒

MULTIPLE
ZONE ☐

2. NAME OF OPERATOR

J. C. Williamson

3. ADDRESS OF OPERATOR

1385 Midland National Bank Tower Midland, Texas

4. LOCATION OF WELL (Report location clearly and in accordance with any State requirements.)

At surface
660' FSL & 660' FWL

At proposed prod. zone

660' FSL & 660' FWL

14. DISTANCE IN MILES AND DIRECTION FROM NEAREST TOWN OR POST OFFICE*

14 Miles SE of Malaga, New Mexico

15. DISTANCE FROM PROPOSED*
LOCATION TO NEAREST
PROPERTY OR LEASE LINE, FT.
(Also to nearest drig. unit line, if any)

660

16. NO. OF ACRES IN LEASE

280

17. NO. OF ACRES ASSIGNED
TO THIS WELL

40

18. DISTANCE FROM PROPOSED LOCATION*
TO NEAREST WELL, DRILLING, COMPLETED,
OR APPLIED FOR, ON THIS LEASE, FT.

None

19. PROPOSED DEPTH

4800'

20. XXXXX OR CABLE TOOLS

above 2900
Cable tools below 2900

21. ELEVATIONS (Show whether DF, RT, GR, etc.)

2887.5 GR

22. APPROX. DATE WORK WILL START*

December 25, 1981

23. PROPOSED CASING AND CEMENTING PROGRAM

SIZE OF HOLE	SIZE OF CASING	WEIGHT PER FOOT	SETTING DEPTH	QUANTITY OF CEMENT
10"	8 5/8"	24#	700'	300 sx (sufficient to circulate)
8"	7"	23#	2900'	300 sx THE BACK TO BASE OF SALT
6 1/4"	4 1/2"	10.5#	4800'	300 sx

RECEIVED
DEC 04 1981

OIL & GAS
U.S. GEOLOGICAL SURVEY
ROSWELL, NEW MEXICO

IN ABOVE SPACE DESCRIBE PROPOSED PROGRAM: If proposal is to deepen or plug back, give data on present productive zone, and proposed new productive zone. If proposal is to drill or deepen directionally, give pertinent data on subsurface locations and measured and true vertical depths. Give blowout preventer program, if any.

24.

SIGNED

J. C. Williamson

TITLE Operator

DATE 11/30/81

(This space for Federal or State office use)

PERMIT NO.

APPROVED

APPROVAL DATE

APPROVED BY

CONDITIONS OF APPROVAL, IF ANY:

DEC 22 1981

JAMES A. GILLHAM
DISTRICT SUPERVISOR

*See Instructions On Reverse Side

Posted ID-1
API + NL Book
12-31-81

**OIL CONSERVATION COMMISSION
WELL LOCATION AND ACREAGE DEDICATION PLAT**

Form C-102
Supersedes C-128
Effective 1-1-65

All distances must be from the outer boundaries of the Section.

Operator J.C. Williamson			Lease UCBHW Federal		Well No. 1
Unit Letter M	Section 25	Township 26 South	Range 29 East	County Eddy County	
Actual Footage Location of Well:					
660 feet from the South line and		660 feet from the West line			
Ground Level Elev. 2887.5	Producing Formation Middle Delaware	Pool Brushy Draw	Dedicated Acreage: 40 Acres		

1. Outline the acreage dedicated to the subject well by colored pencil or hachure marks on the plat below.
2. If more than one lease is dedicated to the well, outline each and identify the ownership thereof (both as to working interest and royalty).
3. If more than one lease of different ownership is dedicated to the well, have the interests of all owners been consolidated by communitization, unitization, force-pooling, etc?

☐ Yes ☒ No If answer is "yes," type of consolidation _____

If answer is "no," list the owners and tract descriptions which have actually been consolidated. (Use reverse side of this form if necessary.) _____

No allowable will be assigned to the well until all interests have been consolidated (by communitization, unitization, forced-pooling, or otherwise) or until a non-standard unit, eliminating such interests, has been approved by the Commission.

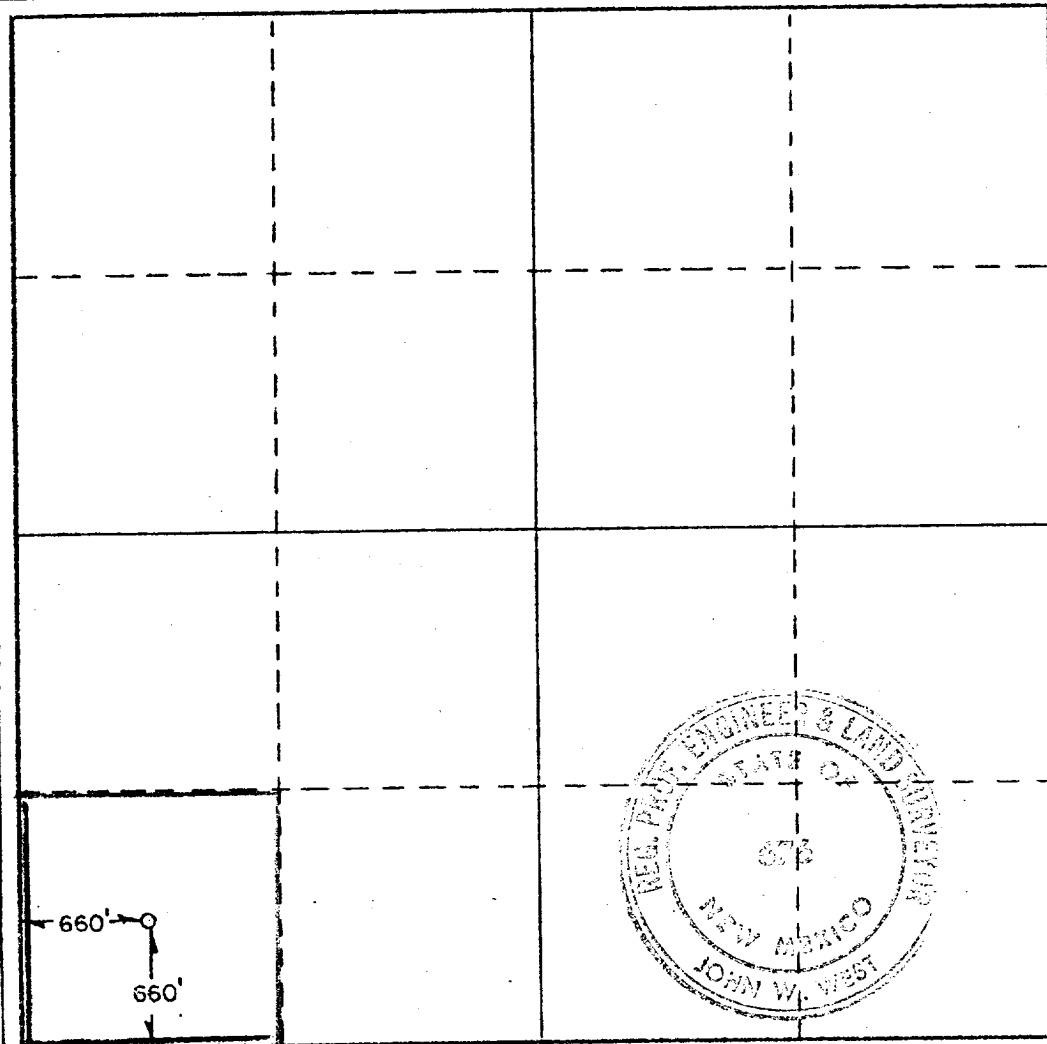

CERTIFICATION

I hereby certify that the information contained herein is true and complete to the best of my knowledge and belief.

Name
J.C. Williamson

Position
Operator

Company
Independent

Date
December 1, 1981

I hereby certify that the well location shown on this plat was plotted from field notes of actual surveys made by me or under my supervision, and that the same is true and correct to the best of my knowledge and belief.

Date Surveyed
9/16/81

Registered Professional Engineer and/or Land Surveyor

[Signature]
Certificate No. **JOHN W. WEST 878**
PATRICK A. ROMERO 6263
Ronald J. Eidson 3239

0 330 660 990 1320 1650 1980 2310 2640 2970 3300 3630 3960 4290 4620 4950 5280 5610 5940 6270 6600

SUPPLEMENTAL DRILLING DATA

J. C. WILLIAMSON
WELL #1 UCBHWW

1. SURFACE FORMATION: Quaternary Alluvium

2. ESTIMATED TOPS OF GEOLOGIC MARKERS:

Rustler Anhydrite	450'
Lamar	3000'
Ramsey Sand	3025'
Olds Sand	3050'
Top Cherry Canyon	4150'

3. ANTICIPATED POSSIBLE WATER AND HYDROCARBON BEARING ZONES:

Fresh Water	above 600 feet
Delaware (Oil)	3025 - 3075 feet
Cherry Canyon (Oil)	4000 - 4200 feet

4. PROPOSED CASING AND CEMENTING PROGRAM:

Casing program is shown on Form 9-331 C.

Hole for surface casing will be drilled to a depth below fresh water zones. Surface casing will then be run to bottom and cemented to the surface to protect fresh water zones. 10 3/4" pipe will be run and pulled prior to running and cementing of the 8 5/8" casing at 700 feet to facilitate drilling the last of the surface water sands.

Pipe will be run and cemented at 2900 feet, prior to entering Delaware section.

8 5/8" surface casing will be cemented to the surface with Class "C" cement.

7" protection casing will be cemented with 150 sacks of Class "C" cement at 2900 feet.

4 1/2" in production casing will be cemented at total depth or shallowing if significant shows are encountered in its Middle Delaware formation.

5. PRESSURE CONTROL EQUIPMENT:

Pressure control equipment will consist of a control valve and oil saver until the 7" casing is set, at such time a manual Blow-out preventer will be put on the hole before it is deepened to total depth.

6. CIRCULATING MEDIUM:

This will be a cable tool hole down to 2900'. Water and mud will be the drilling fluid; below 2900', 8.6# mud will be used to deepen the cable to portion of the hole to around 4800 feet.

7. AUXILIARY EQUIPMENT:

Not applicable.

8. TESTING, LOGGING AND CORING PROGRAM:

No coring is planned.

Formation test will be made as warranted by bailing hole down and measuring fluid entry rate.

It is planned that a Gamma Ray - Neutron will be run when total depth is reached.

9. ABNORMAL PRESSURES, TEMPERATURES OR HYDROGEN SULFIDE GAS:

None anticipated.

10. ANTICIPATED STARTING DATE:

It is planned that operating will commence on December 26, 1981.

1. EXISTING ROADS:

- A. Exhibit "A" is a portion of a road map showing the location of its prepared well. Access to the location will be gained by using an existing road which comes out of the Jal-Orla cut of Highway. (Highway 652). See Point A.
- B. Exhibit "B" is a plat showing existing roads in the vicinity of the well site. Existing roads are shown in blue.
- C. The road leading directly to the location will need to be graded but no new surfacing will be needed.

2. PLANNED ACCESS ROAD:

Approximately 1/8 mile of new road will need to be made starting at its existing road due south of the location.

- A. Surfacing Material: No surfacing material should be needed for the prepared location. If necessary, 4" of caliche, watered and compacted will be used.
- B. Maximum Grade: Two Percent.
- C. Turnouts: None Required.
- D. Drainage Design: New road will have a drop of six inches from the center on each side.
- E. Culverts: None required.
- F. Cuts and Fills: None necessary. Only clearing and minor leveling will be required.
- G. Gates and Cattle Guards: No new gates or cattle guards will be required.

3. LOCATION OF EXISTING WELLS:

- A. Existing wells in the area are shown on Exhibit "B".

4. LOCATION OF EXISTING AND/OR PROPOSED FACILITIES:

- A. There are no existing facilities on the lease.
- B. If the proposed well is completed for production, the tank battery for this well will be on the west side of the drilling location pad.

5. LOCATION AND TYPE OF WATER SUPPLY:

- A. It is not planned that a water well will be drilled. Water necessary for drilling will be purchased and hauled to the well site over existing and proposed roads.

6. SOURCE OF CONSTRUCTION MATERIALS:

Construction materials if needed, and no need is anticipated, will be hauled from an existing caliche pit located approximately 5 miles east of the prepared location.

7. METHODS OF HANDLING WASTE DISPOSAL:

- A. Drill cuttings will be disposed of in the drilling pit.
- B. Drilling fluid will be allowed to evaporate in the drilling pit until the pit is dry.
- C. Water produced during test will be disposed of in the drilling pit. Oil produced during test will be stored in test tanks until sold, if possible.
- D. Current laws and regulations pertaining to the disposal of human waste will be complied with.
- E. Trash, waste paper, garbage and junk will be buried in a separate trash pit and covered with a minimum of 24 inches of dirt. All waste material will be contained to prevent scattering by the wind. Location of the trash pit is shown on Exhibit "D".
- F. All trash and debris will be buried or removed from the well site within 30 days after finishing drilling and/or completion operations.

8. ANCILLARY FACILITIES:

- A. None Required.

9. WELL SITE LAYOUT:

- A. Exhibit "D" shows the relative location and dimensions of the well pad, mud pit, trash pit, and the location of major rig components.
- B. Only minor leveling of the well site will be required. No significant cut and fill will be necessary.
- C. The pad and pit area has been staked and flagged.

10. PLANS FOR RESTORATION OF THE SURFACE:

- A. After completion of drilling and/or completion operations, all equipment and other material not needed for operations will be removed. Pits will be filled and the location cleaned of all trash, junk and all material buried so as to leave the well site in an as aesthetically pleasing condition as possible.
- B. Any unguarded pits containing fluids will be fenced until they are filled.
- C. After abandonment, all equipment, trash and junk will be removed or buried and the location cleaned. Any special rehabilitation and/or special revegetation requirements of the surface management

agency will be complied with and accomplished as expeditiously as possible.

11. OTHER INFORMATION:

- A. Topography: The land surface is relatively level. Regional slope is to the southwest.
- B. Soil: The top soil at the well site is a gravelly, loamy sand.
- C. Flora and Fauna: The vegetative cover is sparse and consists of mesquite, grease wood, yucca, weeds and range grasses. Wildlife in the area is that typical of semi-arid desert land and includes coyotes, rabbits, rodents, reptiles, dove and quail.
- D. Ponds and Streams: The Pecos River is approximately two and one-half miles West of the proposed well site. Red Bluff Reservoir is approximately two and one-half miles Southwest of the well site.
- E. Residence and Other Structures: There are no occupied dwellings or windmills within two miles of the proposed well site.
- F. Archaeological, Historical, and Other Cultural Sites: None observed in the area.
- G. Land Use: Grazing and hunting in season.
- H. Surface Ownership: Federal

12. OPERATORS'S REPRESENTATIVE:

Representative responsible for assuring compliance with the approved Surface Use Plan is:

J. C. Williamson
1385 Midland National Bank Tower
Midland, Texas 79701
Office Phone: 915-682-1797
Home Phone: 915-682-8357

13. CERTIFICATION:

I hereby certify that I, or persons under my direct supervision, have inspected the proposed drill site and access route; that I am familiar with the conditions which presently exist; that the statements made in the plan are, to the best of my knowledge, true and correct; and, that the work associated with the operations proposed herein will be performed by J. C. Williamson and its contractors and subcontractors in conformity with this plan and the term and conditions under which it is approved.

Dec 2 1981

Date

J. C. Williamson
J. C. Williamson, Operator

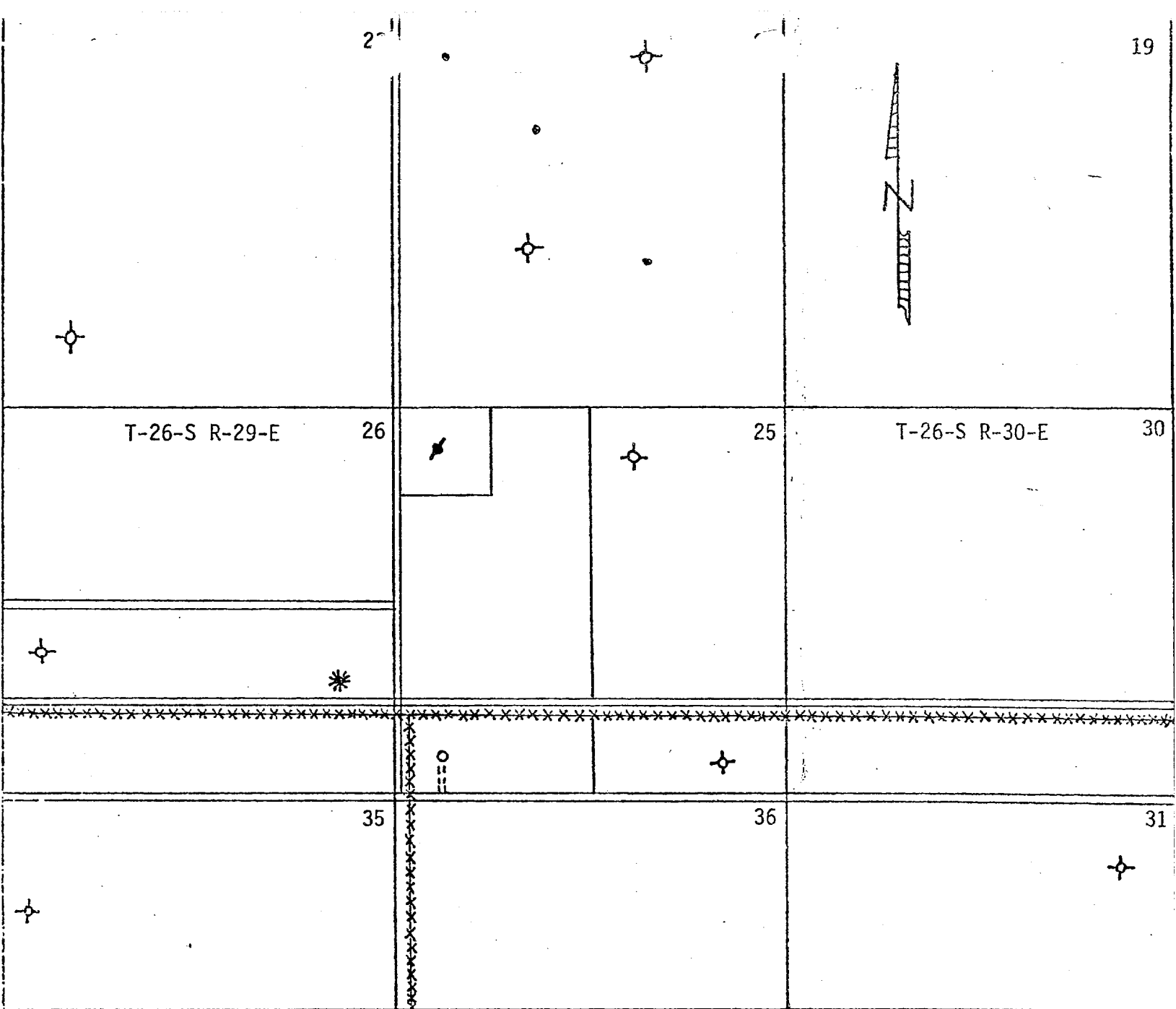

Legend:

- ⊙ Proposed Well Location
- Oil Well * Gas Well
- ⊕ Plugged Well
- Existing Roads
- ***** Barbed Wire Fence
- - - - - Lease Lines

EXHIBIT "B"

J. C. Williamson
 Well #1 UCBHWW Federal
 660' FSL & 660' FWL
 Sec. 25, T-26-S R-29-E
 Eddy County, New Mexico

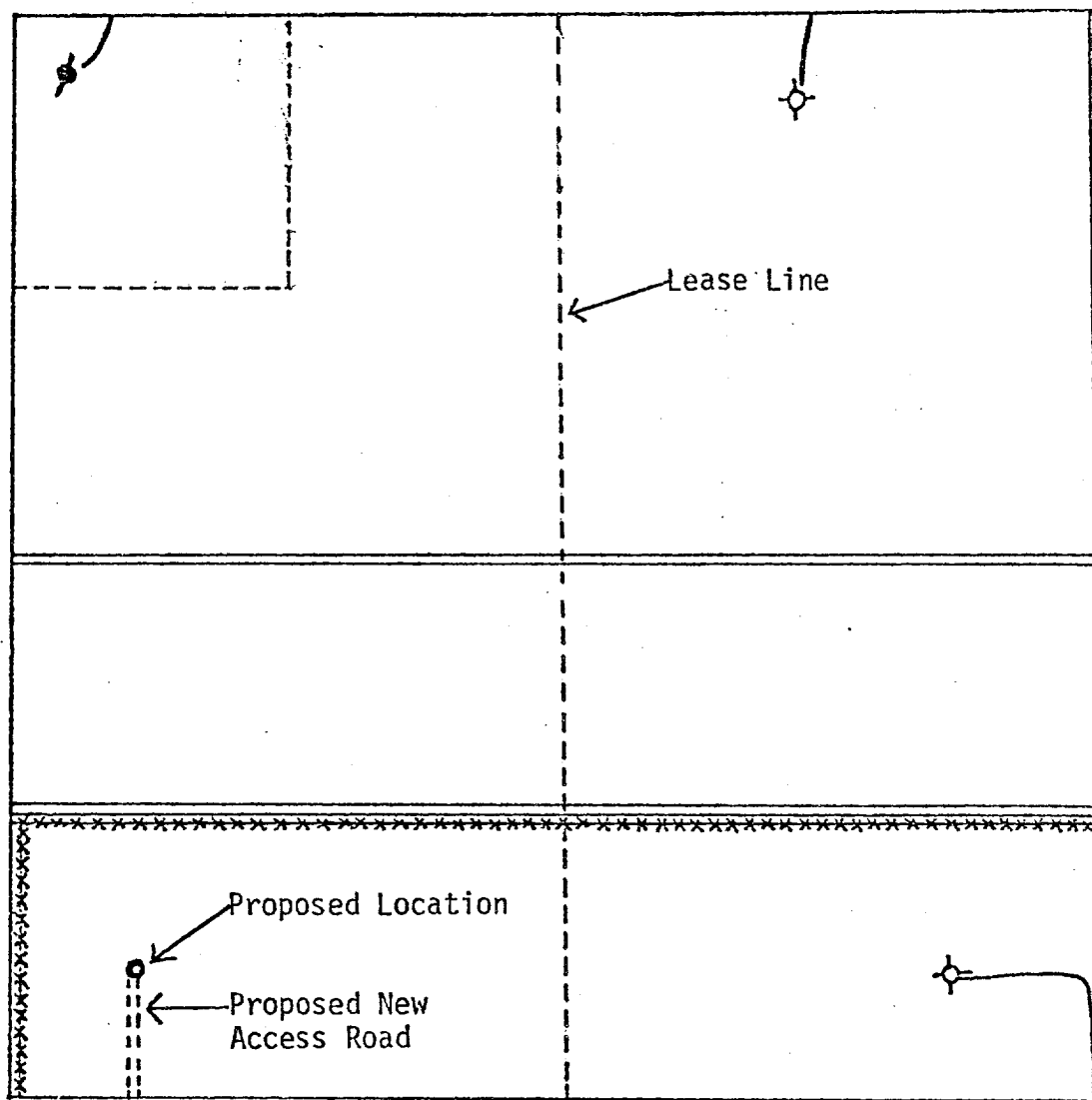

EXHIBIT "C"

J. C. Williamson
Well #1 UCBHWM Federal
660' FSL & 660' FWL
Sec. 25, T-26-S R-29-E
Eddy County, New Mexico

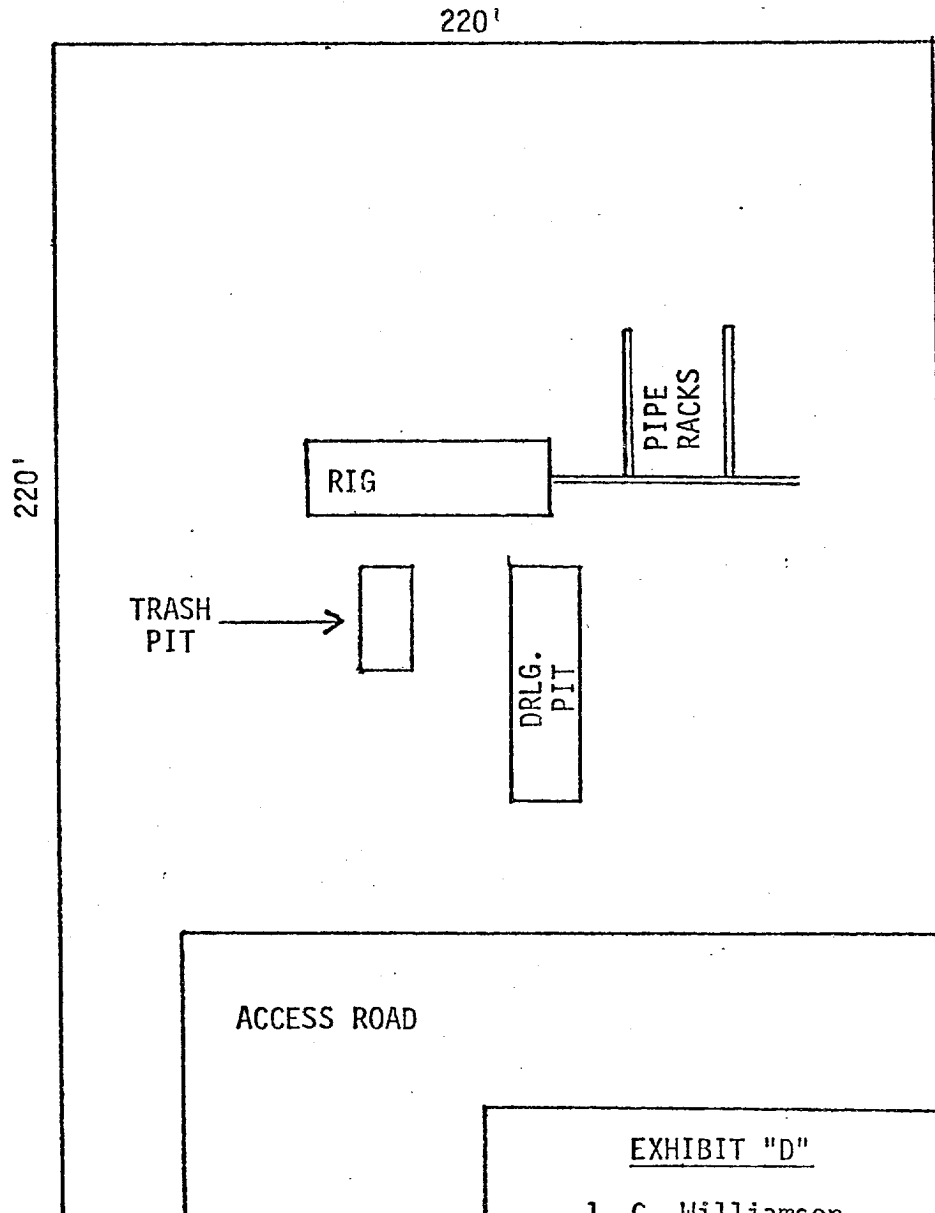

EXHIBIT "D"

J. C. Williamson
#1 UCBHWW
Scale: 1" = 50"