

RECEIVED

UNITED STATES Artesia, NM 88

DEPARTMENT OF THE INTERIOR
GEOLOGICAL SURVEY

OCT 27 1982

O. C. SUNDRY NOTICES AND REPORTS ON WELLS

ARTESIA OFFICE Do not use this form for proposals to drill or to deepen or plug back to a different reservoir. Use Form 9-331-C for such proposals.)

1. oil ☒ gas ☐
well well other

2. NAME OF OPERATOR

J. C. Williamson ✓

3. ADDRESS OF OPERATOR

P. O. Box 16 Midland, Texas 79702

4. LOCATION OF WELL (REPORT LOCATION CLEARLY. See space 17 below.)

AT SURFACE: 1980' FSL & 660' FWL

AT TOP PROD. INTERVAL: 1980' FSL & 660' FWL

AT TOTAL DEPTH: 1980' FSL & 660' FWL

16. CHECK APPROPRIATE BOX TO INDICATE NATURE OF NOTICE, REPORT, OR OTHER DATA

REQUEST FOR APPROVAL TO:

SUBSEQUENT REPORT OF:

TEST WATER SHUT-OFF ☐FRACTURE TREAT ☐SHOOT OR ACIDIZE ☐REPAIR WELL ☐PULL OR ALTER CASING ☐MULTIPLE COMPLETE ☐CHANGE ZONES ☐ABANDON* ☐(other) ☒

5. LEASE

NM 35607

6. IF INDIAN, ALLOTTEE OR TRIBE NAME

7. UNIT AGREEMENT NAME

8. FARM OR LEASE NAME

UCBHW Federal

9. WELL NO.

2

10. FIELD OR WILDCAT NAME

Brushy Draw and Cherry Canyon

11. SEC., T., R., M., OR BLK. AND SURVEY OR AREA

Section 25,

T-26-S, R-29-E

12. COUNTY OR PARISH

Eddy

13. STATE

New Mexico

14. API NO.

15. ELEVATIONS (SHOW DF, KDB, AND WD)

2918.5 GR

(NOTE: Report results of multiple completion or zone change on Form 9-330.)

17. DESCRIBE PROPOSED OR COMPLETED OPERATIONS (Clearly state all pertinent details, and give pertinent dates, including estimated date of starting any proposed work. If well is directionally drilled, give subsurface locations and measured and true vertical depths for all markers and zones pertinent to this work.)*

We are requesting permission to build a surface flow line not buried from the UCBHW Federal #2 to the UCBHW Federal #1 battery. Distance is 1,320'.

Subsurface Safety Valve: Manu. and Type _____

Set @ _____ Ft.

18. I hereby certify that the foregoing is true and correct

SIGNED

TITLE Prod. Secretary

DATE 10/18/82

(This space for Federal or State office use)

APPROVED BY

CONDITIONS OF APPROVAL IF ANY:

No bleeding.

APPROVED

(Sgd.) PETER W. CHESTER

OCT 26 1982

FOR See Instructions on Reverse Side

JAMES A. GILLHAM
DISTRICT SUPERVISOR

WELL LOCATION AND ACREAGE DEDICATION PLAT

All distances must be from the outer boundaries of the Section

J. C. Williamson ✓		UCBHW Fed.		2
Section Letter L	Section 25	Range 26 South	Range 29 East	County Eddy

Actual Well Location of Well:

1980	feet from the	south	line and	660	feet from the	west
Ground Level Elev. 2918.5'	Producing Formation BRUSHY CANYON		Foot	40	Production Design BRUSHY DRAW Cherry Canyon	

1. Outline the acreage dedicated to the subject well by colored pencil or hatchure marks on the plat below.
2. If more than one lease is dedicated to the well, outline each and identify the ownership thereof (both as to working interest and royalty) N/A
3. If more than one lease of different ownership is dedicated to the well, have the interests of all owners been consolidated by communitization, unitization, force-pooling, etc?

☐ Yes ☐ No If answer is "yes," type of consolidation N/A

If answer is "no," list the owners and tract descriptions which have actually been consolidated (Use reverse side of this form if necessary.) N/A

No allowable will be assigned to the well until all interests have been consolidated (by communitization, unitization, forced-pooling, or otherwise) or until a non-standard unit, eliminating such interests, has been approved by the Commission.

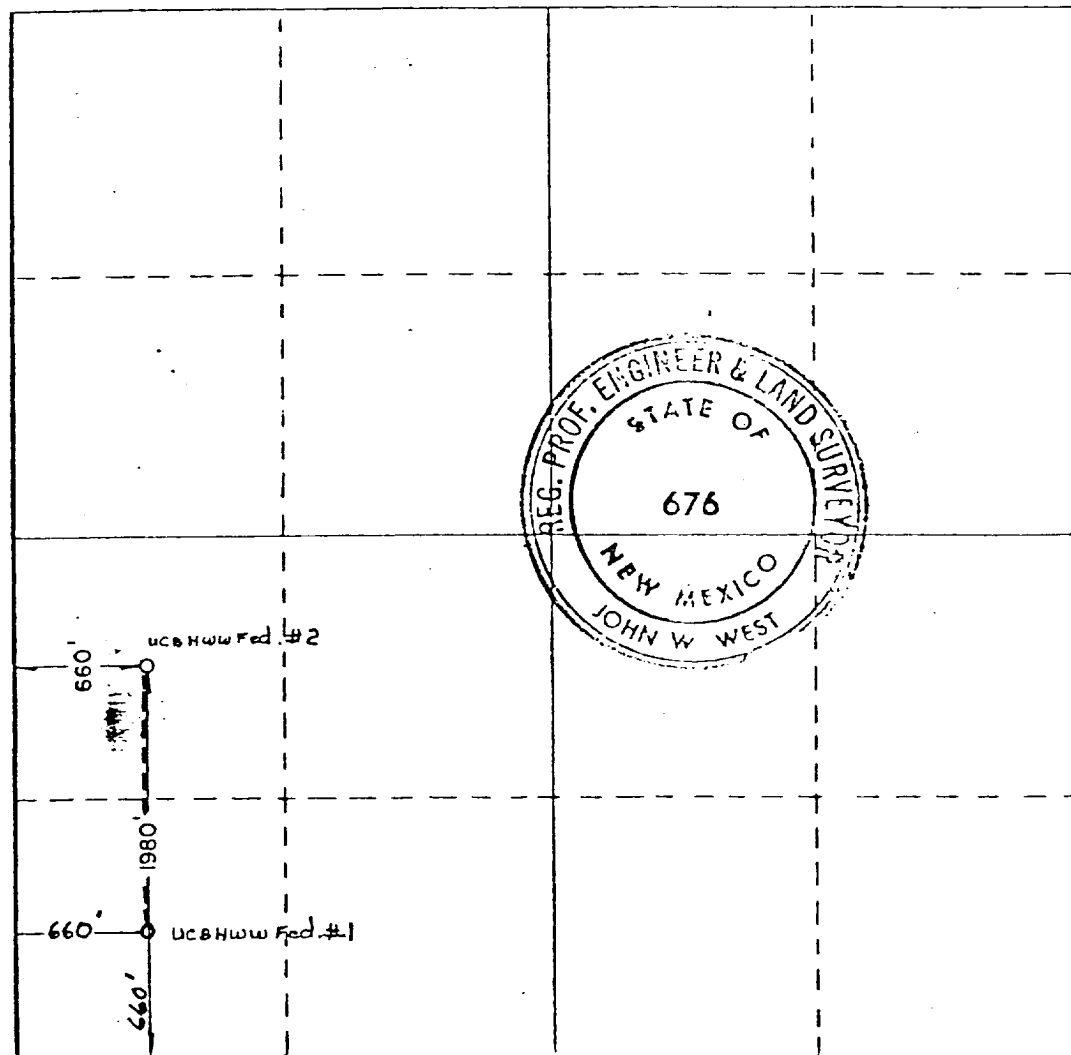

CERTIFICATION

I hereby certify that the information contained herein is true and complete to the best of my knowledge and belief.

Jamie V. Crawford

Jamie V. Crawford

Position

Production Secretary

Company

J. C. Williamson

Date

8/5/82

I hereby certify that the well location shown on this plat was plotted from field notes of actual surveys made by me or under my supervision, and that the same is true and correct to the best of my knowledge and belief.

Date Surveyed

6-26-82

Registered Professional Engineer and/or Land Surveyor

John W. West

Certificate No. JOHN W. WEST 676
PATRICK A. ROMERO 6683
Ronald J. Eidson 3239