

NO. OF COPIES RECEIVED	
DISTRIBUTION	
SANTA FE	1
FILE	1
U.S.G.S.	2
LAND OFFICE	1
OPERATOR	1

# NEW MEXICO OIL CONSERVATION COMMISSION

O+5 - NMOCD - Drawer DD 1 - Foreman  
 Artesia, NM 88210  
 1 - Midland - Laura Rich. 1 - File  
 1 - Engr. - PJB

30-015-24287

Form C-101  
 Revised 1-1-65

5A. Indicate Type of Lease
STATE <input checked="" type="checkbox"/> FEE <input type="checkbox"/>
5. State Oil & Gas Lease No.
16 2204

## APPLICATION FOR PERMIT TO DRILL, DEEPEN, OR PLUG BACK

1a. Type of Work	7. Unit Agreement Name
b. Type of Well DRILL <input checked="" type="checkbox"/> DEEPEN <input type="checkbox"/> PLUG BACK <input type="checkbox"/> OIL WELL <input checked="" type="checkbox"/> GAS WELL <input type="checkbox"/> OTHER <input type="checkbox"/>	8. Farm or Lease Name Salt Mountain State 36
2. Name of Operator Getty Oil Company	9. Well No. 1
3. Address of Operator P.O. Box 730 Hobbs, NM 88240	10. Field and Pool, or Wildcat X Used Brushy Canyon
4. Location of Well UNIT LETTER D LOCATED 660 ARTESIA OFFICE North LINE AND 660 FEET FROM THE West LINE OF SEC. 36 TWP. 26S RGE. 29E NMPM	12. County Eddy
19. Proposed Depth 5500	19A. Formation Brushy Canyon
20. Rotary or C.T. Rotary	
21. Elevations (Show whether DF, RT, etc.) 2881.5 GL	21A. Kind & Status Plug. Bond Blanket
21B. Drilling Contractor Pending	22. Approx. Date Work will start Immediately

23.

## PROPOSED CASING AND CEMENT PROGRAM

SIZE OF HOLE	SIZE OF CASING	WEIGHT PER FOOT	SETTING DEPTH	SACKS OF CEMENT	EST. TOP
12 1/4	8 5/8	24	600	300	Surface
7 7/8	5 1/2	15.5	5500	880	Surface

- The above casing program will be used to drill the Brushy Canyon and any productive formation. The mud system will be fresh water from surface to 600' and brine and brackish water from 600' to approximately 5000'. A low water loss mud system will be used in the pay interval from approximately 5000' to TD, 5500'. The Brushy Canyon will be selectively perforated according to electric logs.
- See attachment for BOP's and choke manifold.

APPROVAL VALID FOR 180 DAYS  
 PERMIT EXPIRES 4-9-83  
 UNLESS DRILLING UNDERWAY

IN ABOVE SPACE DESCRIBE PROPOSED PROGRAM; IF PROPOSAL IS TO DEEPEN OR PLUG BACK, GIVE DATA ON PRESENT PRODUCTIVE ZONE AND PROPOSED NEW PRODUCTIVE ZONE. GIVE BLOWOUT PREVENTER PROGRAM, IF ANY.

I hereby certify that the information above is true and complete to the best of my knowledge and belief.

Signed [Signature] Title Area Superintendent Date 9-28-82

(This space for State Use)

APPROVED BY [Signature] TITLE OIL AND GAS INSPECTOR DATE OCT 5 1982

CONDITIONS OF APPROVAL, IF ANY:

DPW  
 PJB

# NEW MEXICO OIL CONSERVATION COMMISSION WELL LOCATION AND ACREAGE DEDICATION PLAT

Form C-102  
Supersedes C-128  
Effective 1-1-65

All distances must be from the outer boundaries of the Section.

Operator <b>GETTY OIL COMPANY</b>				Lease <b>36</b>		Well No. <b>1</b>	
Unit Letter <b>D</b>	Section <b>36</b>	Township <b>26 South</b>	Range <b>29 East</b>	County <b>Eddy</b>		Salt Mountain State <b>36</b>	
Actual Footage Location of Well: <b>660</b> feet from the <b>North</b> line and <b>660</b> feet from the <b>West</b> line							
Ground Level Elev. <b>2881.5'</b>	Producing Formation <b>Brushy Canyon</b>		Pool <b>Brushy</b>	Dedicated Acreage: <b>40</b> Acres		<del>Wildcat Cherry Canyon</del>	

1. Outline the acreage dedicated to the subject well by colored pencil or hachure marks on the plat below.
2. If more than one lease is dedicated to the well, outline each and identify the ownership thereof (both as to working interest and royalty).
3. If more than one lease of different ownership is dedicated to the well, have the interests of all owners been consolidated by communitization, unitization, force-pooling, etc?  
☐ Yes ☒ No If answer is "yes," type of consolidation \_\_\_\_\_

If answer is "no," list the owners and tract descriptions which have actually been consolidated. (Use reverse side of this form if necessary.) \_\_\_\_\_

No allowable will be assigned to the well until all interests have been consolidated (by communitization, unitization, forced-pooling, or otherwise) or until a non-standard unit, eliminating such interests, has been approved by the Commission.

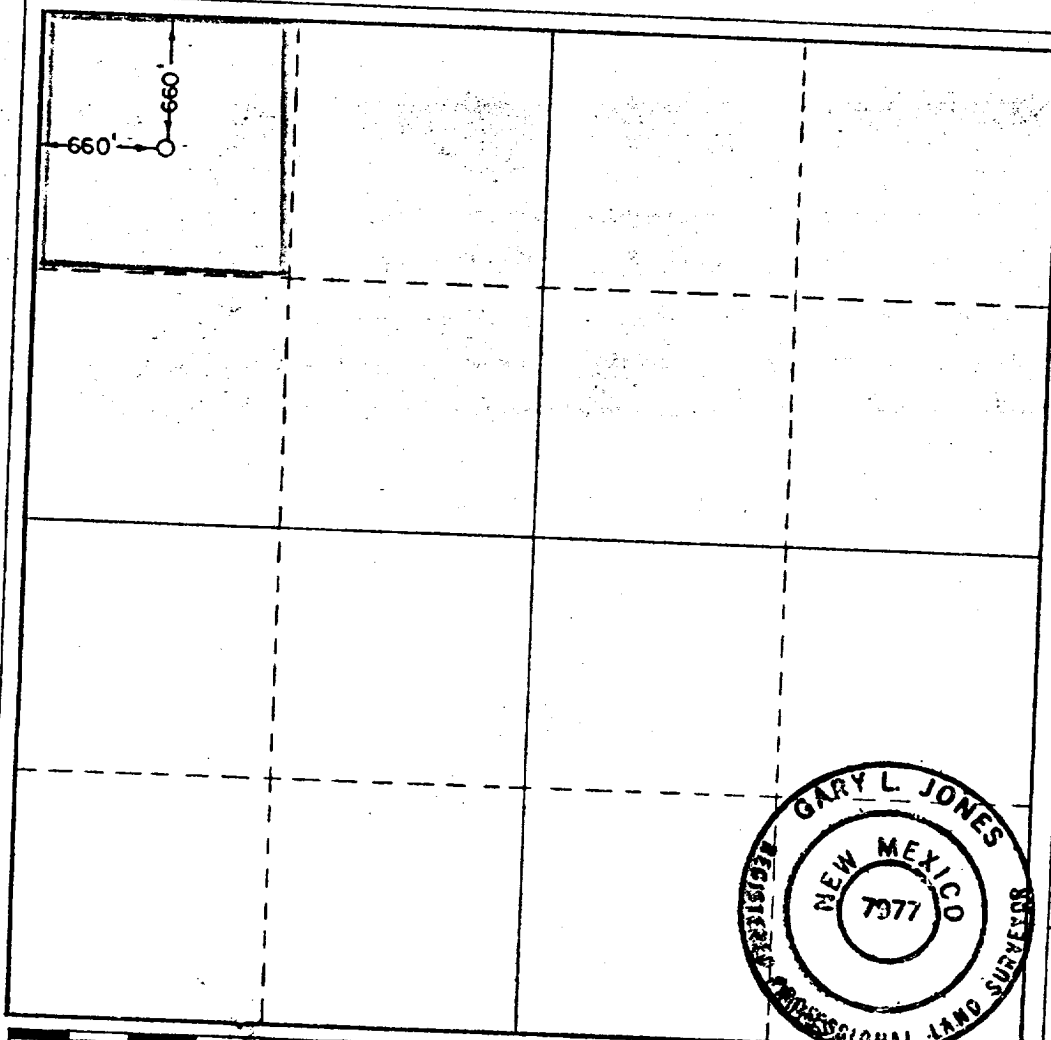

## CERTIFICATION

I hereby certify that the information contained herein is true and complete to the best of my knowledge and belief.

D.R. Crockett

Name *D.R. Crockett*

Position  
Area Superintendent

Company  
Getty Oil Company

Date  
September 27, 1982

I hereby certify that the well location shown on this plat was plotted from field notes of actual surveys made by me or under my supervision, and that the same is true and correct to the best of my knowledge and belief.

Date Surveyed  
September 21, 1982  
Registered Professional Engineer  
and/or Land Surveyor

*Gary L. Jones*  
Certificate No.

7977

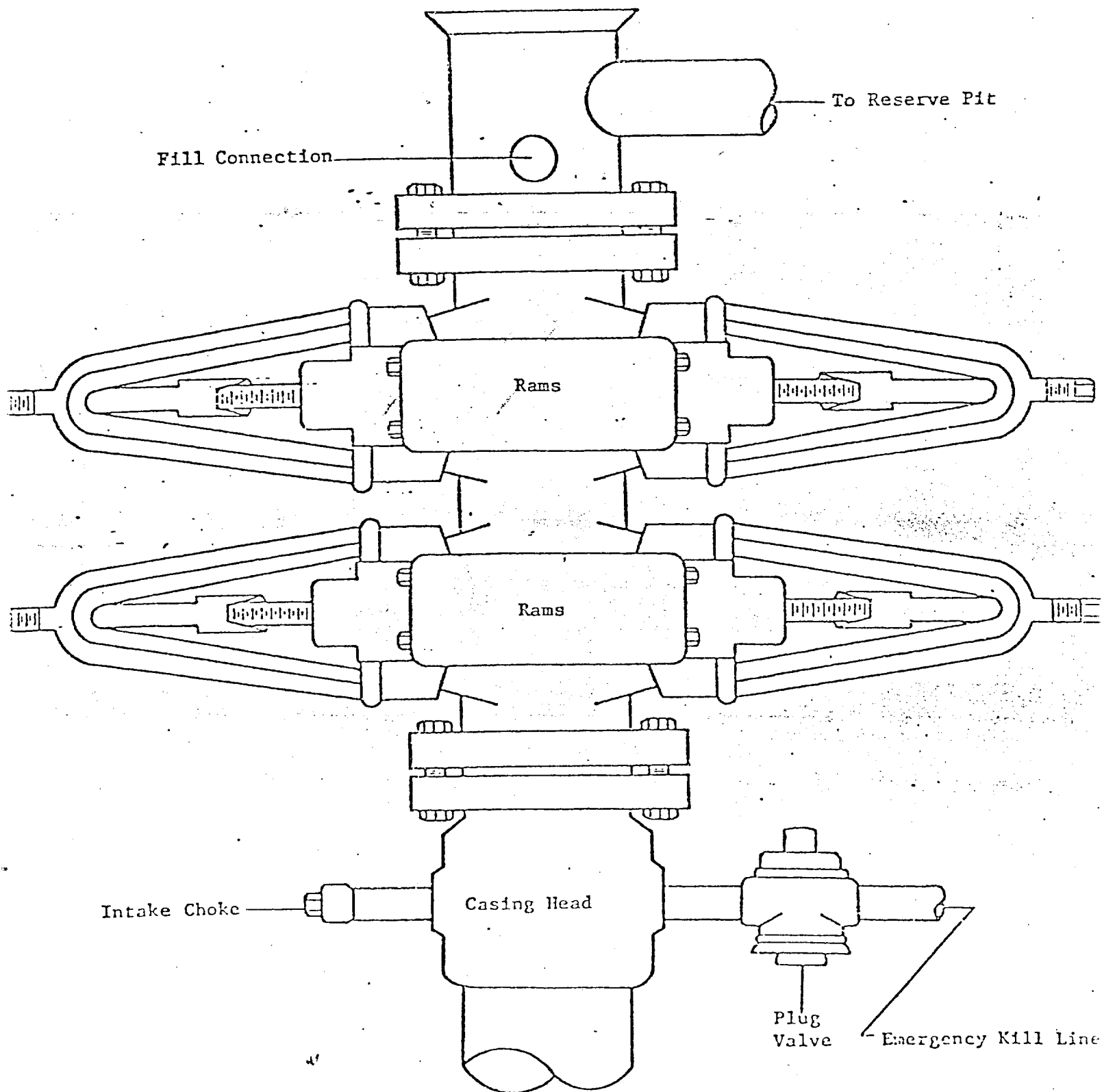

FIGURE I  
GETTY OIL COMPANY

5000 PSI WORKING PRESSURE  
DRILLING CONTROL HOOK-UP