

UNITED STATES
DEPARTMENT OF THE INTERIOR
GEOLOGICAL SURVEY
NEW OIL CONSTRUCTION COMMISSION
Artesia, NM 8821030-015-24341
5. LEASE DESIGNATION AND SERIAL NO.NM-17046
6. IF INDIAN, ALLIOTTEE OR TRIBE NAME

7. UNIT AGREEMENT NAME

8. FARM OR LEASE NAME

Joseph Federal

9. WELL NO.

10. FIELD AND POOL, OR WILDCAT

x Wildcat - *Delaware*
11. SEC., T., R., M., OR BLK.
AND SURVEY OR AREA

Sec. 11-T26S-R28E

12. COUNTY OR PARISH 13. STATE

Eddy NM

17. NO. OF ACRES ASSIGNED
TO THIS WELL

40

20. ROTARY OR CABLE TOOLS

Rotary

22. APPROX. DATE WORK WILL START*

ASAP

APPLICATION FOR PERMIT TO DRILL, DEEPEN, OR PLUG BACK

1a. TYPE OF WORK

DRILL ☒DEEPEN ☐PLUG BACK ☐

b. TYPE OF WELL

OIL

☒

GAS

☐

OTHER

2. NAME OF OPERATOR

Yates Petroleum Corporation

3. ADDRESS OF OPERATOR

207 S. 4th, Artesia, New Mexico 88210

4. LOCATION OF WELL (Report location clearly and in accordance with any State requirements.)*

At surface

660' FNL and 1980' FEL

At proposed prod. zone

same

14. DISTANCE IN MILES AND DIRECTION FROM NEAREST TOWN OR POST OFFICE*

6.5 miles south of Malaga, NM.

15. DISTANCE FROM PROPOSED*

LOCATION TO NEAREST

PROPERTY OR LEASE LINE, FT.

(Also to nearest drlg. unit line, if any)

660'

18. DISTANCE FROM PROPOSED LOCATION*

TO NEAREST WELL, DRILLING, COMPLETED,
OR APPLIED FOR, ON THIS LEASE, FT.

16. NO. OF ACRES IN LEASE

360

19. PROPOSED DEPTH

appr. 6300'

21. ELEVATIONS (Show whether DF, RT, GR, etc.)

2969.0' GL

23. PROPOSED CASING AND CEMENTING PROGRAM

SIZE OF HOLE	SIZE OF CASING	WEIGHT PER FOOT	SETTING DEPTH	QUANTITY OF CEMENT
17 1/2"	13 3/8"	conductor	40'	redimix CIRCULATE
12 1/4"	8 5/8"	24#	775'	500 sx CIRCULATE
7 7/8"	5 1/2"	15.5#	TD	300 sx CIRCULATE

We propose to drill and test the Delaware and intermediate formations. One joint of conductor pipe will be set and cemented. Approximately 775' of intermediate casing will be set and cement circulated. If commercial, 5 1/2" production casing will be run and stimulated as needed.

MUD PROGRAM: FW gel to 775', Brine to TD.

BOP PROGRAM: BOP's will be installed on 8 5/8" casing and tested daily.

IN ABOVE SPACE DESCRIBE PROPOSED PROGRAM: If proposal is to deepen or plug back, give data on present productive zone and proposed new productive zone. If proposal is to drill or deepen directionally, give pertinent data on subsurface locations and measured and true vertical depths. Give blowout preventer program, if any.

24. SIGNED Glenn Rod TITLE Regulatory Manager

DATE 11/10/82

(This space for Federal or State office use)

PERMIT NO.

APPROVED

APPROVAL DATE

(ORIG. SGD.) DAVID R. GLASS

APPROVED BY

CONDITIONS OF APPROVAL, IF ANY

NOV 12 1982

JAMES A. GILHAM
DISTRICT SUPERVISOR

RECEIVED

NOV 10 1982

OIL & GAS
PERMITTING SERVICE
ROSEMILL, NEW MEXICO

NEW MEXICO OIL CONSERVATION COMMISSION
WELL LOCATION AND ACREAGE DEDICATION PLAT

Form C-102
Supersedes C-128
Effective 1-1-65

All distances must be from the outer boundaries of the Section.

Operator YATES PETROLEUM CORPORATION			Lease Joseph Federal		Well No. 1
Tract Letter B	Section 11	Township 26 South	Range 28 East	County Eddy	
Amount of the Location of Well: 660 feet from the North line and 2310 feet from the East line.					
Producing Elev. 2975.	Producing Formation Delaware	Pool Wildcat		Dedicated Acreage 40 Acres	

1. Outline the acreage dedicated to the subject well by colored pencil or hatchure marks on the plat below.
2. If more than one lease is dedicated to the well, outline each and identify the ownership thereof (both as to working interest and royalty).
3. If more than one lease of different ownership is dedicated to the well, have the interests of all owners been consolidated by communitization, unitization, force-pooling, etc?

☐ Yes ☐ No If answer is "yes," type or consolidation _____

If answer is "no," list the owners and tract descriptions which have actually been consolidated. (Use reverse side of this form if necessary.) _____

No allowable will be assigned to the well until all interests have been consolidated (by communitization, unitization, forced-pooling, or otherwise) or until a non-standard unit, eliminating such interests, has been approved by the Commission.

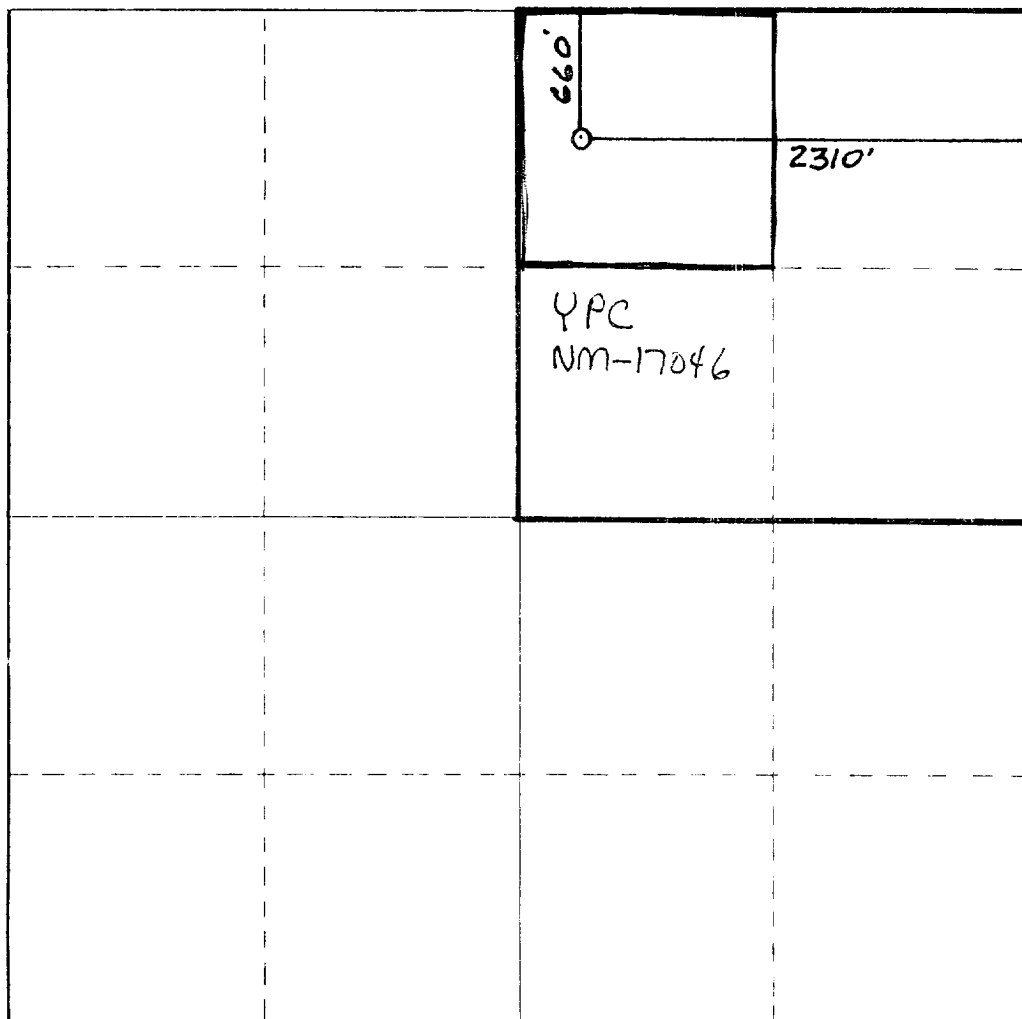

CERTIFICATION

I hereby certify that the information contained herein is true and complete to the best of my knowledge and belief.

Gliserio Rodriguez
Name

Gliserio Rodriguez
Position

Regulatory Manager
Company

Yates Petroleum Corp.
Date

11/15/82

DAN R. REDDY
I hereby certify that the well location shown on this plat was plotted from field notes of actual surveys made by me or under my supervision and that the same is true and correct to the best of my knowledge and belief.
DAN R. REDDY
REGISTERED PROFESSIONAL ENGINEER

Date Surveyed

November 13, 1982

Registered Professional Engineer
and/or Land Surveyor

Dan R. Reddy
Certificate No.

NM PE&LS #5412

330 660 990 1320 1650 1980 2310 2640 2970 3300 3630 3960 4290 4620 4950 5280 5610 5940 6270 6600

UNITED STATES
DEPARTMENT OF THE INTERIOR
GEOLOGICAL SURVEY

SUNDRY NOTICES AND REPORTS ON WELLS

(Do not use this form for proposals to drill or to deepen a well back to a different reservoir. Use Form 9-331-C for such proposals.)

1. oil ☒ well gas ☐ well other ☐ **NOV 22 1982**
2. NAME OF OPERATOR
Yates Petroleum Corporation
3. ADDRESS OF OPERATOR
207 S. 4th, Artesia, New Mexico
4. LOCATION OF WELL (REPORT LOCATION CLEARLY. See space 17 below.)
AT SURFACE: 660' FNL and 2310' FEL
AT TOP PROD. INTERVAL:
AT TOTAL DEPTH: same
16. CHECK APPROPRIATE BOX TO INDICATE NATURE OF NOTICE, REPORT, OR OTHER DATA

- REQUEST FOR APPROVAL TO: SUBSEQUENT REPORT OF:
- | | | |
|----------------------|-------------------------------------|--------------------------|
| TEST WATER SHUT-OFF | <input type="checkbox"/> | <input type="checkbox"/> |
| FRACTURE TREAT | <input type="checkbox"/> | <input type="checkbox"/> |
| SHOOT OR ACIDIZE | <input type="checkbox"/> | <input type="checkbox"/> |
| REPAIR WELL | <input type="checkbox"/> | <input type="checkbox"/> |
| PULL OR ALTER CASING | <input checked="" type="checkbox"/> | <input type="checkbox"/> |
| MULTIPLE COMPLETE | <input type="checkbox"/> | <input type="checkbox"/> |
| CHANGE ZONES | <input type="checkbox"/> | <input type="checkbox"/> |
| ABANDON* | <input type="checkbox"/> | <input type="checkbox"/> |
- (other) change location and mud program

17. DESCRIBE PROPOSED OR COMPLETED OPERATIONS (Clearly state all pertinent details, and give pertinent dates, including estimated date of starting any proposed work. If well is directionally drilled, give subsurface locations and measured and true vertical depths for all markers and zones pertinent to this work.)*

Change location from: 660' FNL and 1980' FEL
to: 660' FNL and 2310' FEL plat enclosed.

Change casing program from: 17 1/2" hole-13 3/8" csg-conductor @40'
12 1/4" hole-8 5/8" 24# csg-@775'
7 7/8" hole-5 1/2" 15.5# csg-to TD.

to: 12 1/4" hole-8 5/8" csg 24#-@2600' CIRCULATE
7 7/8" hole-4 1/2" csg 9.5#-to TD CIRCULATE

Change mud program to: Spud mud & brine 2600', cut brine to TD.
Subsurface Safety Valve: Manu. and Type Set @ Ft.

18. I hereby certify that the foregoing is true and correct

SIGNED: *Glenn B. Stewart* TITLE: Regulatory Manager DATE: 11/15/82

(Orig. Sgd.) GEORGE H. STEWART for Federal or State office use)

APPROVED BY: *James A. Gillham* TITLE: DATE: **NOV 22 1982**

JAMES A. GILLHAM
DISTRICT SUPERVISOR

*See Instructions on Reverse Side

5. LEASE
NM-17046
6. IF INDIAN, ALLOTTEE OR TRIBE NAME
7. UNIT AGREEMENT NAME
8. FARM OR LEASE NAME
Joseph Federal
9. WELL NO.
1
10. FIELD OR WILDCAT NAME
Wildcat
11. SEC., T., R., M., OR BLK. AND SURVEY OR AREA
Sec. 11-T26S-R28E
12. COUNTY OR PARISH
Eddy
13. STATE
NM
14. API NO.
15. ELEVATIONS (SHOW DF, KDB, AND WD)
2975.0' GL

(NOTE: Report results of multiple completion or zone change on Form 9-330.)

W MEXICO OIL CONSERVATION COMM. ON
WELL LOCATION AND ACREAGE DEDICATION PLAT

Form C-102
Supersedes C-128
Effective 1-1-65

All distances must be from the outer boundaries of the Section

Operator YATES PETROLEUM CORPORATION		Lease Joseph Federal		Well No. 1
Unit Letter B	Section 11	Township 26 South	Range 28 East	County Eddy
Actual Footage Location of Well: 660 feet from the North line and 1980 feet from the East line				
Ground Level Elev. 2969.	Producing Formation DELAWARE	Pool WILDCAT	Estimated Acreage 40	

1. Outline the acreage dedicated to the subject well by colored pencil or hatchure marks on the plat below.
2. If more than one lease is dedicated to the well, outline each and identify the ownership thereof (both as to working interest and royalty).
3. If more than one lease of different ownership is dedicated to the well, have the interests of all owners been consolidated by communitization, unitization, force-pooling, etc?

☐ Yes ☐ No If answer is "yes," type of consolidation _____

If answer is "no," list the owners and tract descriptions which have actually been consolidated. (Use reverse side of this form if necessary.) _____

No allowable will be assigned to the well until all interests have been consolidated (by communitization, unitization, forced-pooling, or otherwise) or until a non-standard unit, eliminating such interests, has been approved by the Commission.

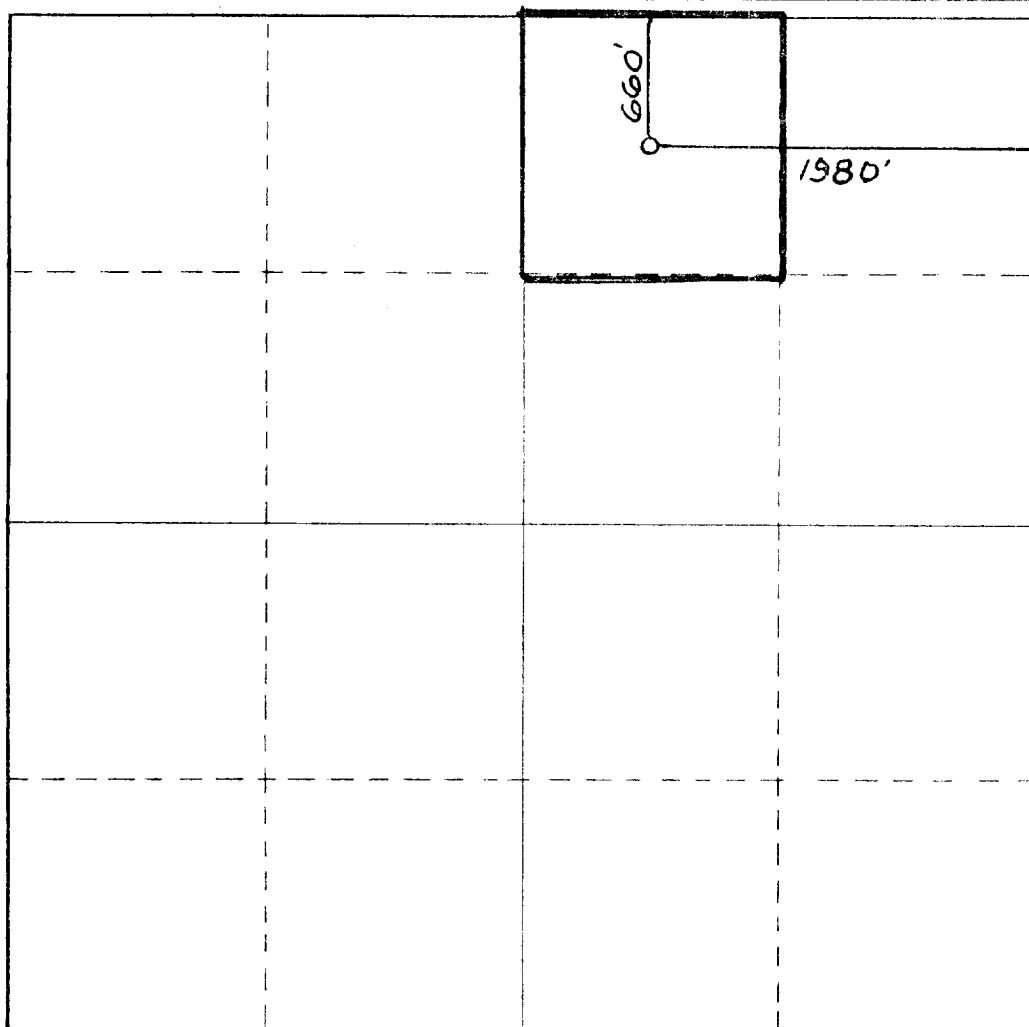

CERTIFICATION

I hereby certify that the information contained herein is true and complete to the best of my knowledge and belief.

Gliserio Rodriguez
Name

GLISERIO RODRIGUEZ
Position

REGULATORY MANAGER
Company

YATES PETROLEUM CORP.
Date

11-8-82

I hereby certify that the well location shown on this plat was plotted from field notes of actual surveys made by me or under my supervision and that the same is true and correct to the best of my knowledge and belief.

Date Surveyed

October 17, 1982

Registered Professional Engineer
and/or Land Surveyor

Dan R. Reddy
Certificate No.

NM P&LS #5412

0 330 660 990 1320 1650 1980 2310 2640 2970 3300 3630 3960 4290 4620 4950 5280 5610 5940 6270 6600

YATES PETROLEUM CORPORATION
Joseph Federal #1
Section 11-T26S-R28E
660' FNL and 1980' FEL

In conjunction with Form 9-331C, Application for Permit to Drill subject well, Yates Petroleum Corporation submits the following ten items of pertinent information in accordance with USGS requirements.

1. The geologic surface formation is alluvium/cobble

2. The estimated tops of geologic markers are as follows:

<u>Rustler Anhydrite</u>	<u>800'</u>
<u>Base Salt</u>	<u>2415'</u>
<u>Lamar Limestone</u>	<u>2600'</u>
<u>Ramsey Sand</u>	<u>2650'</u>
<u>Cherry Canyon</u>	<u>3470'</u>
<u>Brushy Canyon</u>	<u>5090'</u>
<u>Bone Springs Lime</u>	<u>6300'</u>

3. The estimated depths at which anticipated water, oil or gas formations are expected to be encountered:

Water: 150'

Oil or Gas: 2800' - 2900'

4. Proposed Casing Program: See Form 9-331C.

5. Pressure Control Equipment: See Form 9-331C and Exhibit B.

6. Mud Program: See Form 9-331C.

7. Auxiliary Equipment: Kelly Cock; pit level indicators and flow sensor equipment;
sub with full-opening valve on floor, drill pipe connection.

8. Testing, Logging and Coring Program:

Samples: none
DST's: none
Coring: none
Logging: as required

9. No abnormal pressures or temperatures are anticipated.

10. Anticipated starting date: As soon as possible after approval.

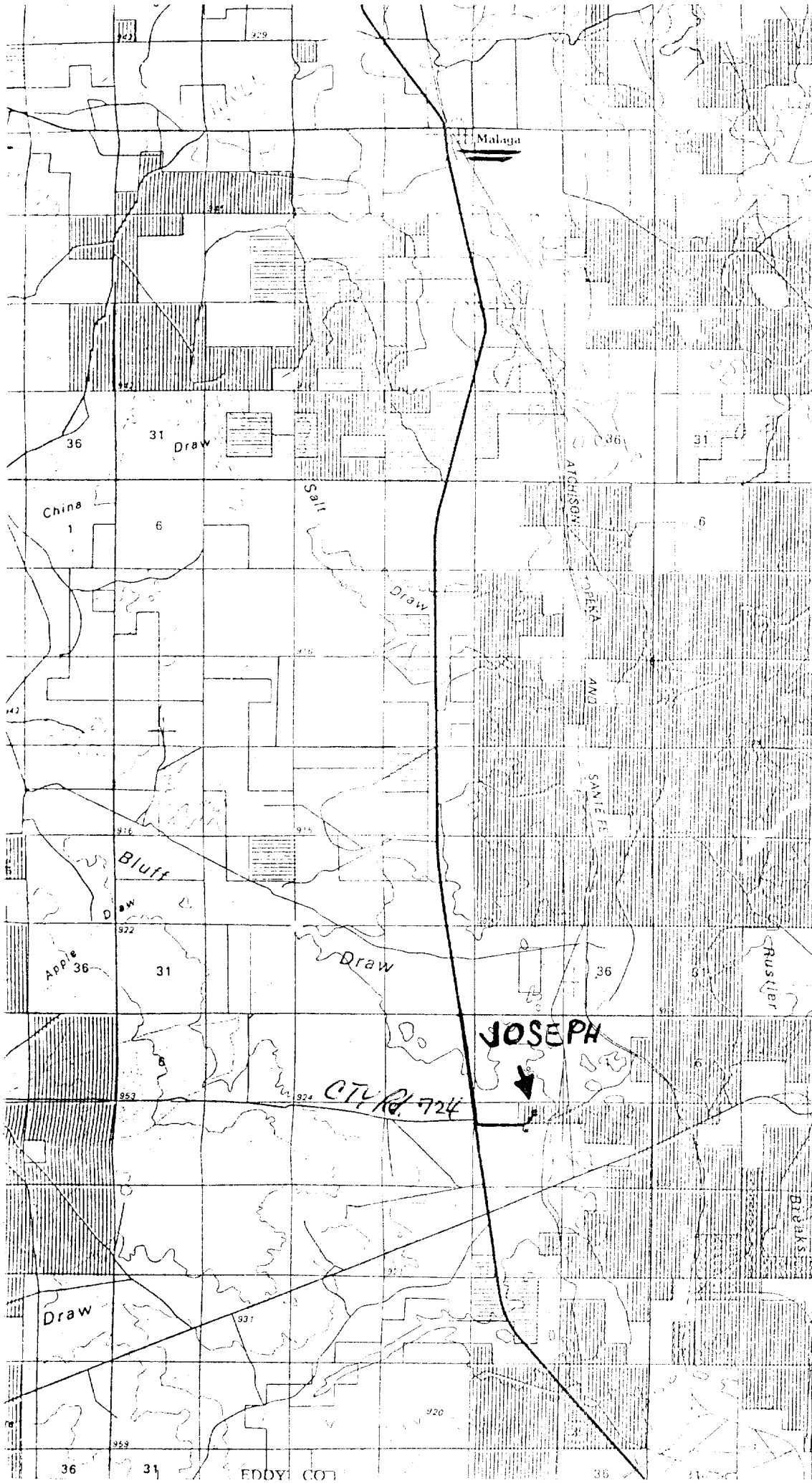

T 24 S

36

T 25 S

35°09'00"N
106°00'00"W
(CENTRAL ZONE)

T 26 S

MINERALS OWNED BY THE FEDERAL GOVERNMENT

Mineral Rights

- All minerals
- Coal only
- Oil and Gas only
- Oil, Gas, and Coal only
- Other
- No symbol indicates no Federal minerals

EXHIBIT 1

YATES PETROLEUM CORP.

JOSEPH FEDERAL #1
SEC. 11-T26S-R28E
660' FNL-1980' FEL
EDDY CTY, NM

NOTE TO MAP USER

The surface and minerals maps and overprints are published as planning and management tools. Some of the surface and mineral rights, may have been patented lands due to the lands not available to BLM with respect to the acquisition. Tracts less than 40 acres are omitted because of the map scale. Private lands may be restricted records in the respective office of the Bureau of Land Management or other relevant agencies should be checked for any specific tract of land. In the BLM maps should be reported to the Bureau of Land Management of the maps were obtained.

EXHIBIT B

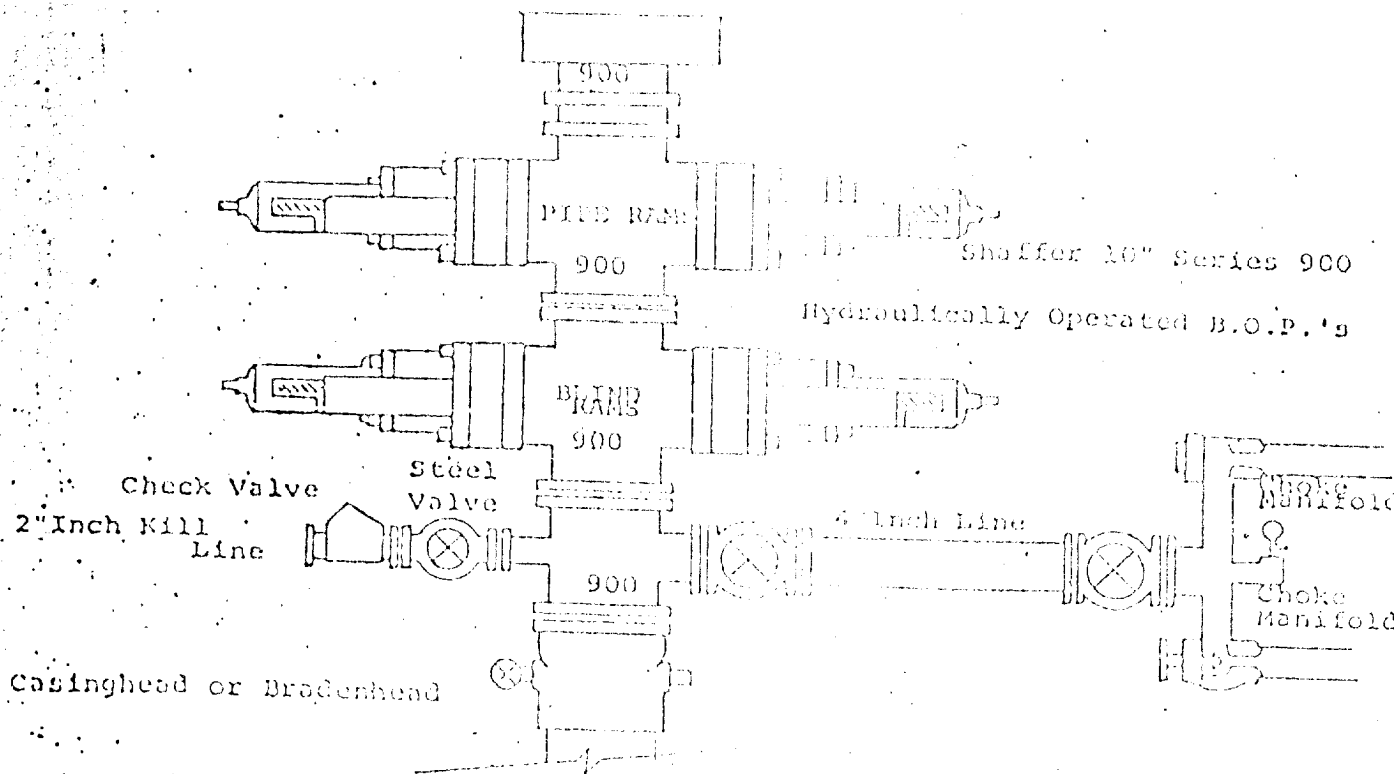

THE FOLLOWING CONSTITUTE MINIMUM REQUIREMENTS FOR WELLHEADS

1. All preventers to be hydraulically operated with secondary manual controls installed prior to drilling out from under casing.
2. Choke outlet to be a minimum of 4" diameter.
3. Kill line to be of all steel construction or 2" minimum diameter.
4. All connections from operating manifolds to preventers to be all steel. hole or tube a minimum of one inch in diameter.
5. The available closing pressure shall be at least 15% in excess of that required with sufficient volume to operate the B.O.P.'s.
6. All connections to and from preventer to have a pressure rating equivalent to that of the B.O.P.'s.
7. Inside blowout preventer to be available on rig floor.
8. Operating controls located a safe distance from the rig floor.
9. Hole must be kept filled on trips below intermediate casing. Operator not responsible for blowouts resulting from not keeping hole full.
10. D. P. float must be installed and used below zone of first gas intrusion.

YATES PETROLEUM CORP.

Exhibit C

Reserve Pit
bottom to be at
ground level to
1 ft.

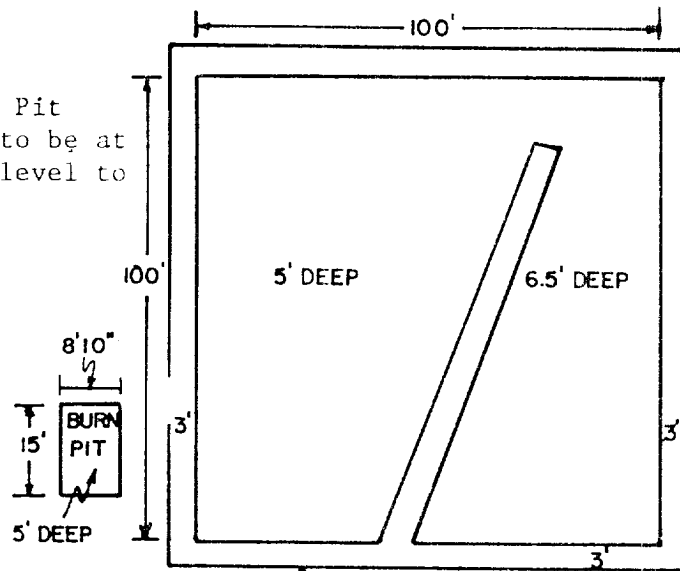

NOTE:

Inside walls must be as
high and wide as outer
walls of pit.

