

UNITED STATES
DEPARTMENT OF THE INTERIOR
GEOLOGICAL SURVEY
MINERALS COMMISSION
Brewer DD
Artesia, NM 88210
RECEIVED
MAY 17 1983

APPLICATION FOR PERMIT TO DRILL, DEEPEN, OR PLUG BACK

1a. TYPE OF WORK

DRILL ☒DEEPEN ☐PLUG BACK ☐

b. TYPE OF WELL

OIL
WELL ☒GAS
WELL ☐OTHER ☐SINGLE
ZONE ☒MULTI
ZONE ☐

2. NAME OF OPERATOR

NEW TEX OIL COMPANY

O. C. D.

3. ADDRESS OF OPERATOR

ARTESIA, OFFICE

P. O. BOX 297, HOBBS, NEW MEXICO 88241-0279

4. LOCATION OF WELL (Report location clearly and in accordance with any State requirements.)*

At surface

740' FNL AND 330' FWL OF SECTION 35

At proposed prod. zone

14. DISTANCE IN MILES AND DIRECTION FROM NEAREST TOWN OR POST OFFICE*

16 MILES SOUTH-SOUTHEAST OF MALAGA, NEW MEXICO

15. DISTANCE FROM PROPOSED*

LOCATION TO NEAREST
PROPERTY OR LEASE LINE, FT.
(Also to nearest drlg. unit line, if any)

330'

16. NO. OF ACRES IN LEASE

56.19

17. NO. OF ACRES ASSIGNED
TO THIS WELL

35.61

18. DISTANCE FROM PROPOSED LOCATION*
TO NEAREST WELL, DRILLING, COMPLETED,
OR APPLIED FOR, ON THIS LEASE, FT.

-

19. PROPOSED DEPTH

6750'

20. ROTARY OR CABLE TOOLS

ROTARY

21. ELEVATIONS (Show whether DF, RT, GR, etc.)

2890.4 GR

22. APPROX. DATE WORK WILL START*

UPON APPROVAL

23.

PROPOSED CASING AND CEMENTING PROGRAM

SIZE OF HOLE	SIZE OF CASING	WEIGHT PER FOOT	SETTING DEPTH	QUANTITY OF CEMENT
17-1/2"	13-3/8"	48#	450'	SUFFICIENT TO CIRCULATE
12-1/4"	8-5/5"	24#	2900'	200 SACKS
7-7/8"	4-1/2"	9.5# & 10.5#	6750'	SUFFICIENT TO TIE-BACK TO 8-5/8"

PRODUCING ZONE WILL BE PERFORATED AND STIMULATED AS NECESSARY.

SEE ATTACHED FOR: SUPPLEMENTAL DRILLING DATA

BOP SKETCH

SURFACE USE AND OPERATIONS PLAN

*Ante 2 p 9
5-20-83*

[RECEIVED]

MAY 3 1983

OIL & GAS

IN ABOVE SPACE DESCRIBE PROPOSED PROGRAM: If proposal is to deepen or plug back, give data on present productive zone and proposed new productive zone. If proposal is to drill or deepen directionally, give pertinent data on subsurface locations and measured and true vertical depths. Give blowout preventer program, if any.

24.

SIGNED

Arthur R. Brown

TITLE

AGENT

DATE MAY 2, 1983

(This space for Federal or State office use)

PERMIT NO.

APPROVAL DATE

APPROVED BY

A. D. Lopez

TITLE

Acting Asst. District

DATE

5/13/83

CONDITIONS OF APPROVAL, IF ANY:

Supervisor for Minerals

NEW MEXICO OIL CONSERVATION COMMISSION
WELL LOCATION AND ACREAGE DEDICATION PLAT

Form C-102
Supersedes C-128
Effective 1-1-65

All distances must be from the outer boundaries of the Section

Operator New Tex Oil Company			Lease Stateline Federal		Well No. 1
Unit Letter D	Section 35	Township 26 South	Range 29 East	County Eddy	
Actual Footage Location of Well: 740 feet from the north line and 330 feet from the west line					
Ground Level Elev. 2890.4'	Producing Formation CHERRY CANYON		Pool BRUSH DRAW - CHERRY CANYON		Dedicated Acreage: 35.61

1. Outline the acreage dedicated to the subject well by colored pencil or hachure marks on the plat below.
2. If more than one lease is dedicated to the well, outline each and identify the ownership thereof (both as to working interest and royalty).
3. If more than one lease of different ownership is dedicated to the well, have the interests of all owners been consolidated by communitization, unitization, force-pooling, etc?

☐ Yes ☐ No If answer is "yes," type of consolidation _____

If answer is "no," list the owners and tract descriptions which have actually been consolidated. (Use reverse side of this form if necessary.) _____

No allowable will be assigned to the well until all interests have been consolidated (by communitization, unitization, forced-pooling, or otherwise) or until a non-standard unit, eliminating such interests, has been approved by the Commission.

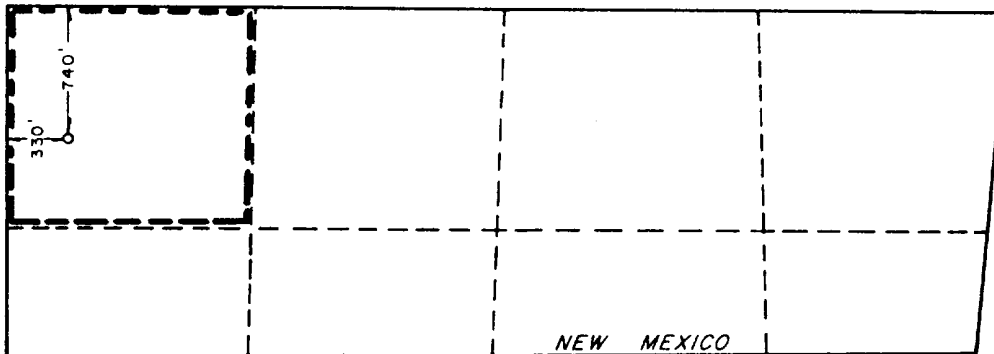

NEW MEXICO
LOVING CO, TEXAS

CERTIFICATION

I hereby certify that the information contained herein is true and complete to the best of my knowledge and belief

Arthur R. Brown
Name
Arthur R. Brown

Position
Agent

Company
NEW TEX OIL COMPANY

Date
MAY 2, 1983

I hereby certify that the well location shown on this plat was plotted from field notes of actual surveys made by me or under my supervision, and that the same is true and correct to the best of my knowledge and belief.

Date Surveyed
April 14, 1983

Registered Professional Engineer and/or Land Surveyor

Ronald J. Eidson

Certificate No. **JOHN W. WEST 676**
Ronald J. Eidson 3239

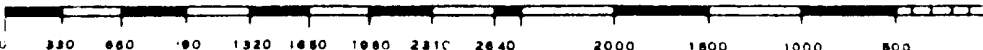
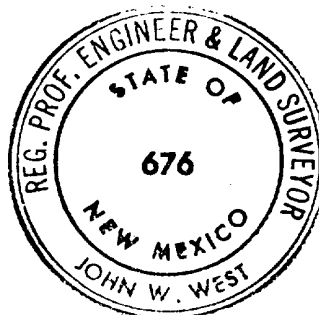

SUPPLEMENTAL DRILLING DATA

NEW TEX OIL COMPANY WELL NO.1 STATELINE FEDERAL

1. SURFACE FORMATION: Quaternary.

2. TOPS OF GEOLOGIC MARKERS:

Castile	1200'
Bell Canyon	2950'
Cherry Canyon	3890'
Brushy Canyon	5200'

3. ANTICIPATED POSSIBLE HYDROCARBON BEARING ZONES:

Bell Canyon	Oil
Cherry Canyon	Oil
Brushy Canyon	Oil

4. PROPOSED CASING AND CEMENTING PROGRAM:

<u>CASING SIZE</u>	<u>SETTING DEPTH</u>		<u>WEIGHT</u>	<u>GRADE</u>	<u>JOINT</u>
	<u>FROM</u>	<u>TO</u>			
13-3/8"	0	450'	48#	H-40	STC
8-5/8"	0	2400'	24#	K-55	STC
"	2400'	2900'	24#	S-80	STC
4-1/2"	0	400'	10.5#	K-55	STC
"	400'	5700'	9.5#	K-55	STC
"	5700'	6750'	10.5#	K-55	STC

13-3/8" surface casing will be cemented with approximately 400 sacks of Class "C" cement. Cement to circulate.

8-5/8" casing will be cemented with approximately 200 sacks of Class "C" cement.

4-1/2" casing will be cemented with sufficient Light cement, tailed-in with 200 sacks of Class "C" cement, to tie back to 8-5/8" casing.

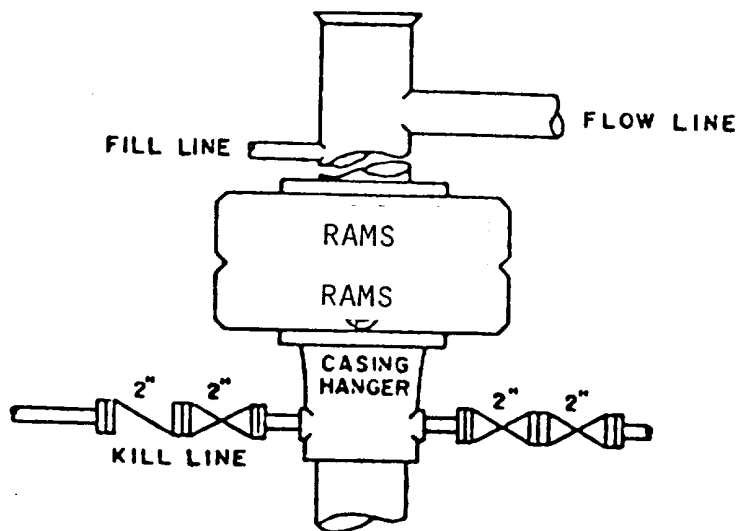

BOP STACK

SERIES 900

DEPTH INTERVAL

BELOW 13-3/8" CASING SEAT

BOP ARRANGEMENT

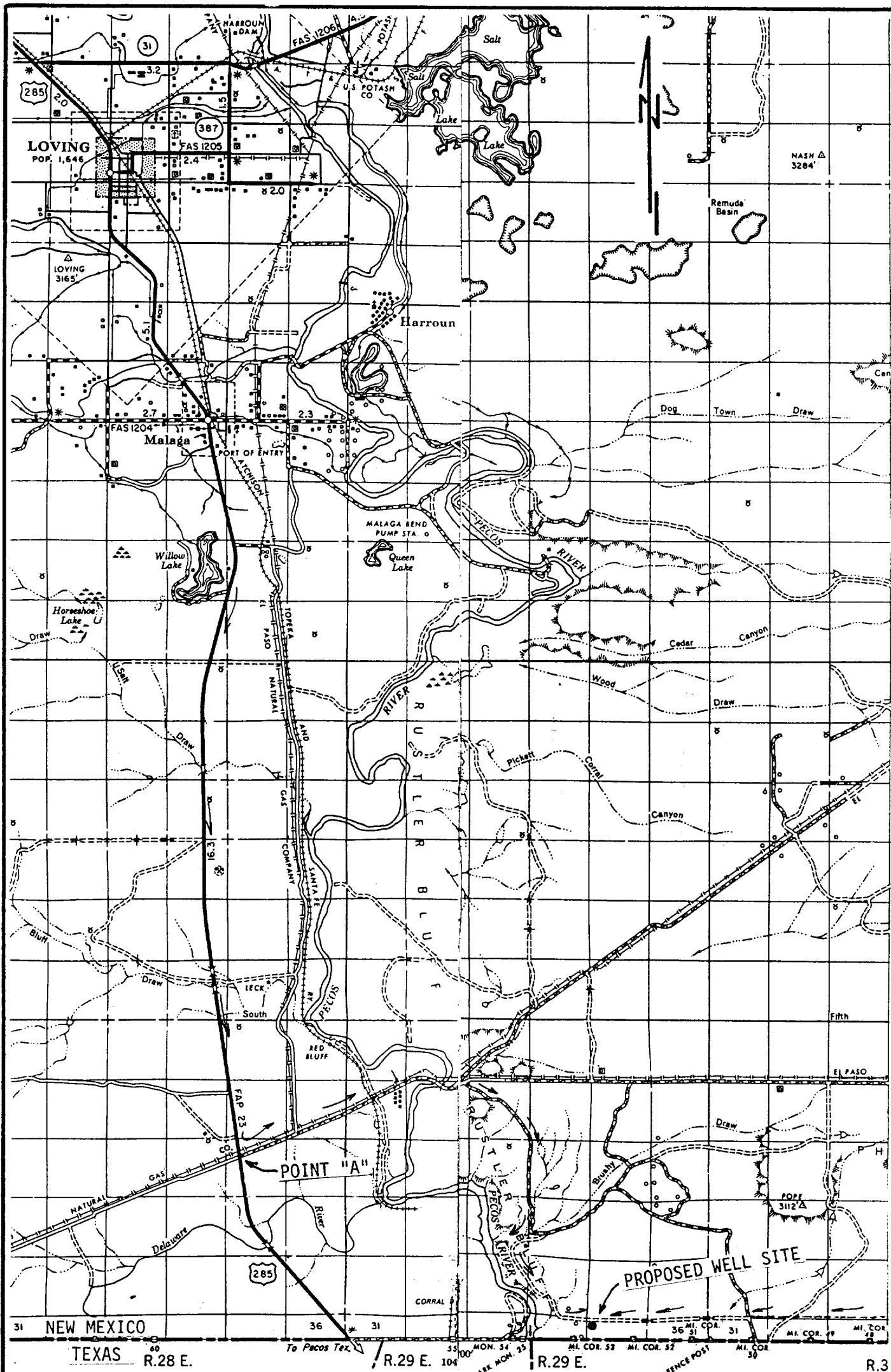

EXHIBIT "A"

NEW TEX OIL COMPANY
WELL NO.1 STATELINE FEDERAL
740'FNL & 330'FWL SEC.35, T.26 S., R.29 E.
EDDY COUNTY, N.M. SCALE: 1/2" = 1 MI.



EXISTING COUNTY MAINTAINED ROAD

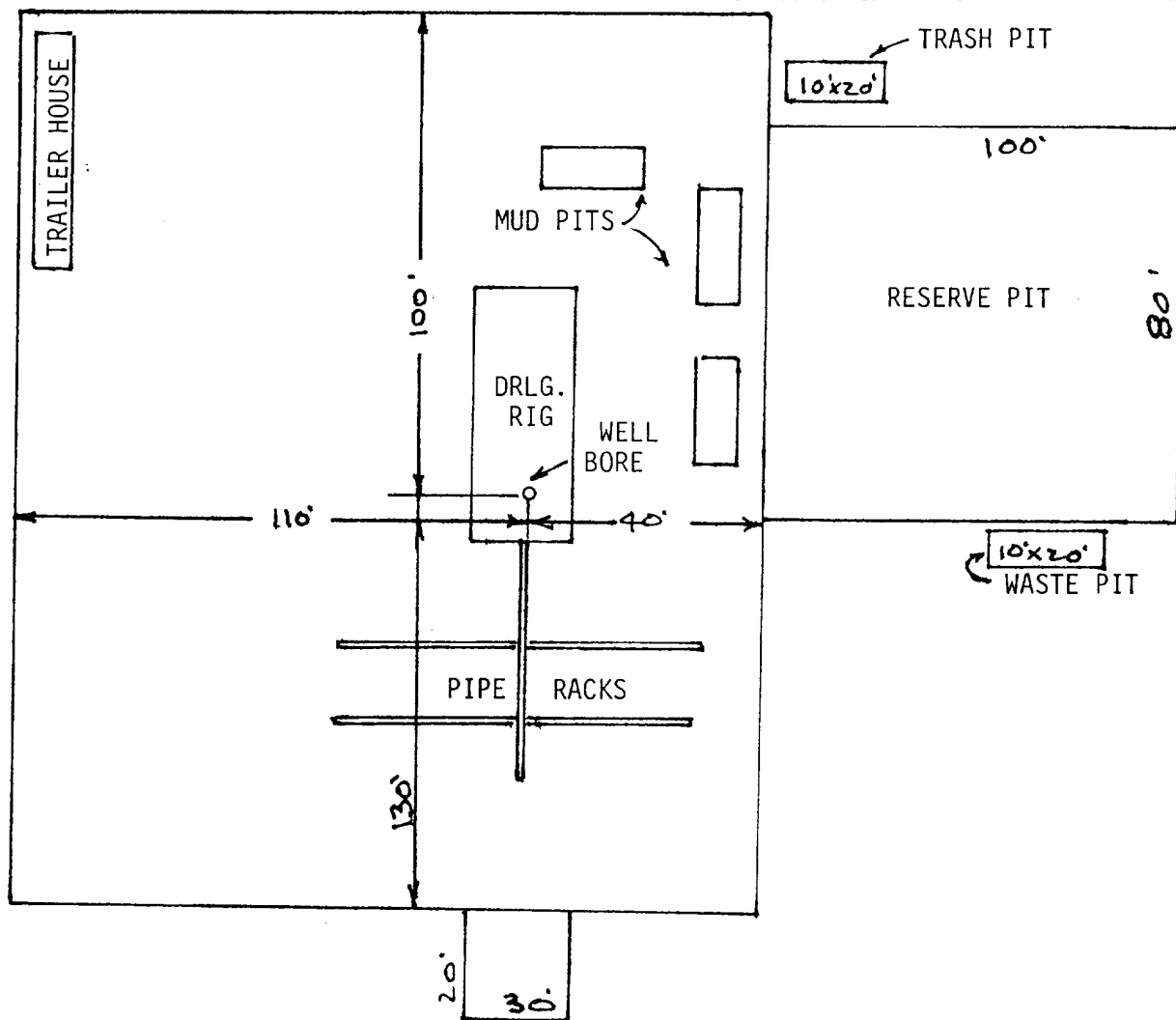

EXHIBIT "C"

NEW TEX OIL COMPANY
WELL NO.1 STATELINE FEDERAL
DRILLING RIG LAYOUT
SCALE: None