

NO. OF COPIES RECEIVED	
DISTRIBUTION	
SANTA FE	✓
FILE	✓
U.S.G.S.	2
LAND OFFICE	✓
OPERATOR	✓

NEW MEXICO OIL CONSERVATION COMMISSION

Form C-101

Revised 1-1-85

30-615-24724

RECEIVED BY

DEC 6 1983

O.C.R.

5A. Indicate Type of Lease

STATE ☒

FEE ☐

5. State Oil & Gas Lease No.

B-10678

APPLICATION FOR PERMIT TO DRILL, DEEPEN, OR PLUG BACK

1a. Type of Work DRILL <input checked="" type="checkbox"/> DEEPEN <input type="checkbox"/> PLUG BACK <input type="checkbox"/>		7. Unit Agreement Name Poker Lake Unit	
b. Type of Well OIL WELL <input checked="" type="checkbox"/> GAS WELL <input type="checkbox"/> OTHER <input type="checkbox"/>		8. Farm or Lease Name POKER LAKE UNIT STATE	
2. Name of Operator C. CLYDE HAMBLIN (915-686-0431) % Jubilee Energy Corporation ✓ (Tom Garber)		9. Well No. 63	
3. Address of Operator 3100 North A Street, Suite E-103, Midland, Texas 79701		10. Field and Pool, or Wildcat Corral Canyon	
4. Location of Well UNIT LETTER N LOCATED 665 FEET FROM THE South LINE AND 2015 FEET FROM THE West LINE OF SEC. 8 TWP. 25S RGE. 30E NMPM		12. County Eddy	
19. Proposed Depth 4000'		19A. Formation Delaware	20. Rotary or C.T. Rotary
21. Elevations (Show whether DF, RT, etc.) 3201' G.L.	21A. Kind & Status Plug. Bond One-Well (Pending)	21B. Drilling Contractor Marc Drilling Inc.	22. Approx. Date Work will start 12-20-83

23.

PROPOSED CASING AND CEMENT PROGRAM

SIZE OF HOLE	SIZE OF CASING	WEIGHT PER FOOT	SETTING DEPTH	SACKS OF CEMENT	EST. TOP
12 1/4"	9 5/8"	29.3#	400'	175	Surface
7 7/8"	5 1/2"	13.0#	4000'	200	600' Above Pay

Posted at 109
FD-1 & 2/1 Bork
12-23-83

Pay zone will be selectively perforated and stimulated as needed for optimum production.

Attached are: 1. Well Location and Acreage Dedication Plat
2. BOP Sketch

IN ABOVE SPACE DESCRIBE PROPOSED PROGRAM: IF PROPOSAL IS TO DEEPEN OR PLUG BACK, GIVE DATA ON PRESENT PRODUCTIVE ZONE AND PROPOSED NEW PRODUCTIVE ZONE. GIVE BLOWOUT PREVENTER PROGRAM, IF ANY.

I hereby certify that the information above is true and complete to the best of my knowledge and belief.

Signed James A. Knaut Title Agent Date December 15, 1983
(This space for State Use)

APPROVED BY W. H. Wilburn TITLE OIL AND GAS INSPECTOR DATE DEC 21 1983

CONDITIONS OF APPROVAL, IF ANY:

EXICO OIL CONSERVATION COMMISS
WELL LOCATION AND ACREAGE DEDICATION PLAT

Form C-102
Supersedes C-128
Effective 1-1-65

All distances must be from the outer boundaries of the Section

Operator C. CLYDE HAMBLIN		Lease POKER LAKE UNIT		Well No. 63	
Section N	Section 8	Township 25 SOUTH	Range 30 EAST	County EDDY	
Actual Footage Location of Well:					
665 feet from the SOUTH line and		2015 feet from the WEST line			
Ground Level Elev. 3201.0	Producing Formation Delaware Sand	Pool Coral Canyon	Dedicated Acreage: 40 Acres		

1. Outline the acreage dedicated to the subject well by colored pencil or hatchure marks on the plat below.
2. If more than one lease is dedicated to the well, outline each and identify the ownership thereof (both as to working interest and royalty).
3. If more than one lease of different ownership is dedicated to the well, have the interests of all owners been consolidated by communitization, unitization, force-pooling etc?

☐ Yes ☐ No If answer is "yes," type of consolidation _____

If answer is "no," list the owners and tract descriptions which have actually been consolidated. (Use reverse side of this form if necessary.) _____

No allowable will be assigned to the well until all interests have been consolidated (by communitization, unitization, forced-pooling, or otherwise) or until a non-standard unit eliminating such interests, has been approved by the Commission.

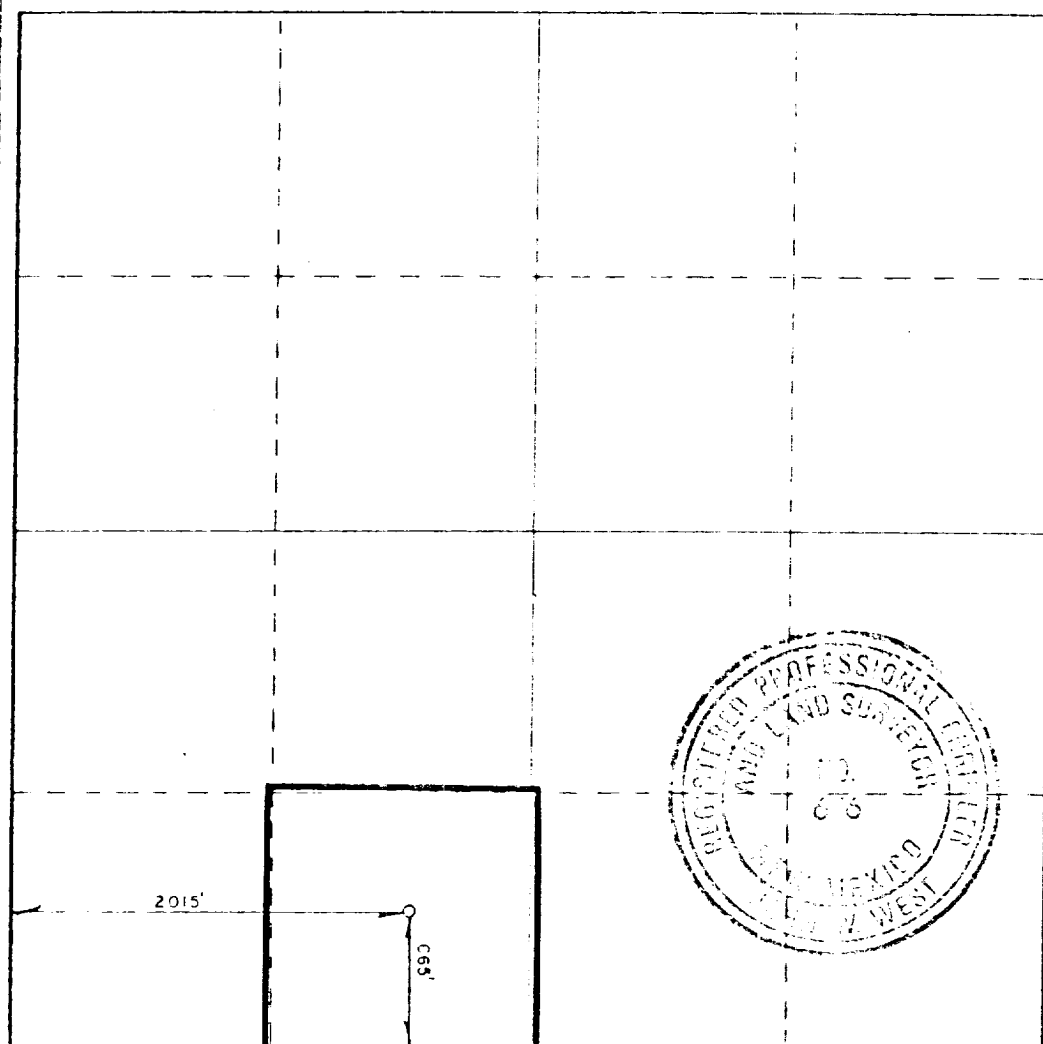

CERTIFICATION

I hereby certify that the information contained herein is true and complete to the best of my knowledge and belief.

James A. Knauf
James A. Knauf

Position

Agent

Company

C. CLYDE HAMBLIN

Date

12-15-83

12-15-83

I hereby certify that the well location shown on this plat was plotted from field notes of actual surveys made by me or under my supervision, and that the same is true and correct to the best of my knowledge and belief.

Date Surveyed

DECEMBER 10, 1983

Registered Professional Engineer and/or Land Surveyor

James A. Knauf

Certificate No.

N.M. P.E. & L.S. #676

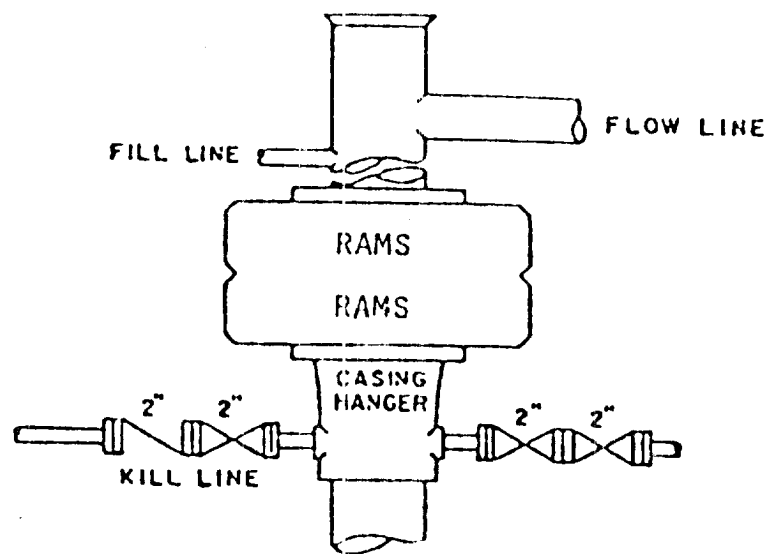

BOP ARRANGEMENT