

UNITED STATES  
DEPARTMENT OF THE INTERIOR  
BUREAU OF LAND MANAGEMENT

RECEIVED BY  
(Other instructions on  
reverse side)

OCT 25 1984

30-015-25069  
Form approved.  
Budget Bureau No. 1004-0136  
Expires August 31, 1985

APPLICATION FOR PERMIT TO DRILL, DEEPEN, OR PLUG BACK

1a. TYPE OF WORK

DRILL ☒

DEEPEN ☐

PLUG BACK ☐

b. TYPE OF WELL

OIL  
WELL ☒

GAS  
WELL ☐

OTHER

SINGLE  
ZONE ☐

MULTIPLE  
ZONE ☐

2. NAME OF OPERATOR

J.C. Williamson

3. ADDRESS OF OPERATOR

P.O. BOX 16 Midland, Texas 79702

4. LOCATION OF WELL (Report location clearly and in accordance with any State requirements.)\*

At surface

660' FNL & 660' FWL

At proposed prod. zone

660' FNL & 660' FWL

14. DISTANCE IN MILES AND DIRECTION FROM NEAREST TOWN OR POST OFFICE\*

12-1/2 Miles S.E. of Malaga, New Mexico

15. DISTANCE FROM PROPOSED\*

LOCATION TO NEAREST  
PROPERTY OR LEASE LINE, FT.  
(Also to nearest drlg. unit line, if any)

660'

16. NO. OF ACRES IN LEASE

280

17. NO. OF ACRES ASSIGNED  
TO THIS WELL

40

18. DISTANCE FROM PROPOSED LOCATION\*

TO NEAREST WELL, DRILLING, COMPLETED,  
OR APPLIED FOR, ON THIS LEASE, FT.

660'

19. PROPOSED DEPTH

6350'

20. ROTARY OR CABLE TOOLS

Rotary

21. ELEVATIONS (Show whether DF, RT, GR, etc.)

2878.0' GR

22. APPROX. DATE WORK WILL START\*

October 15, 1984

23.

PROPOSED CASING AND CEMENTING PROGRAM

SIZE OF HOLE	SIZE OF CASING	WEIGHT PER FOOT	SETTING DEPTH	QUANTITY OF CEMENT
17-1/2"	13-3/8"	35#	450'	425 sx circulate
11"	8-5/8"	24# & 32#	2900'	150 sx tie back to base of salt
7-7/8"	4-1/2"	10.5#	6350'	1350 sx in 2 stages



15-10-1984  
APPROVED  
11-2-84

IN ABOVE SPACE DESCRIBE PROPOSED PROGRAM: If proposal is to deepen or plug back, give data on present productive zone and proposed new productive zone. If proposal is to drill or deepen directionally, give pertinent data on subsurface locations and measured and true vertical depths. Give blowout preventer program, if any.

24.

SIGNED

*[Signature]*

TITLE

Agent

DATE

October 3, 1984

(This space for Federal or State office use)

PERMIT NO.

APPROVAL DATE

AREA MANAGER

APPROVED BY

TITLE

CARLSBAD RESOURCES AREA

CONDITIONS OF APPROVAL, IF ANY:

DATE

10-25-84

APPROVAL SUBJECT TO  
GENERAL REQUIREMENTS AND  
SPECIAL STIPULATIONS

\*See Instructions On Reverse Side

NEW MEXICO OIL CONSERVATION COMMISSION  
WELL LOCATION AND ACREAGE DEDICATION PLAT

Form C-102  
Supersedes C-128  
Effective 1-1-65

All distances must be from the outer boundaries of the Section

Operator J. C. Williamson		Lease Holly Federal A		Well No. 4
Tract Letter D	Section 26	Township 26 South	Range 29 East	County Eddy
Actual Footage Location of Well: 660 feet from the north line and 660 feet from the west line				
Ground Level Elev. 2878.0'	Producing Formation Delaware	Pool Brushy Draw Delaware	Dedicated Acreage: 40 Acres	

1. Outline the acreage dedicated to the subject well by colored pencil or hatchure marks on the plat below.
2. If more than one lease is dedicated to the well, outline each and identify the ownership thereof (both as to working interest and royalty).
3. If more than one lease of different ownership is dedicated to the well, have the interests of all owners been consolidated by communitization, unitization, force-pooling, etc?

☐ Yes ☐ No If answer is "yes," type of consolidation \_\_\_\_\_

If answer is "no," list the owners and tract descriptions which have actually been consolidated. (Use reverse side of this form if necessary.) \_\_\_\_\_

No allowable will be assigned to the well until all interests have been consolidated (by communitization, unitization, forced-pooling, or otherwise) or until a non-standard unit, eliminating such interests, has been approved by the Commission.

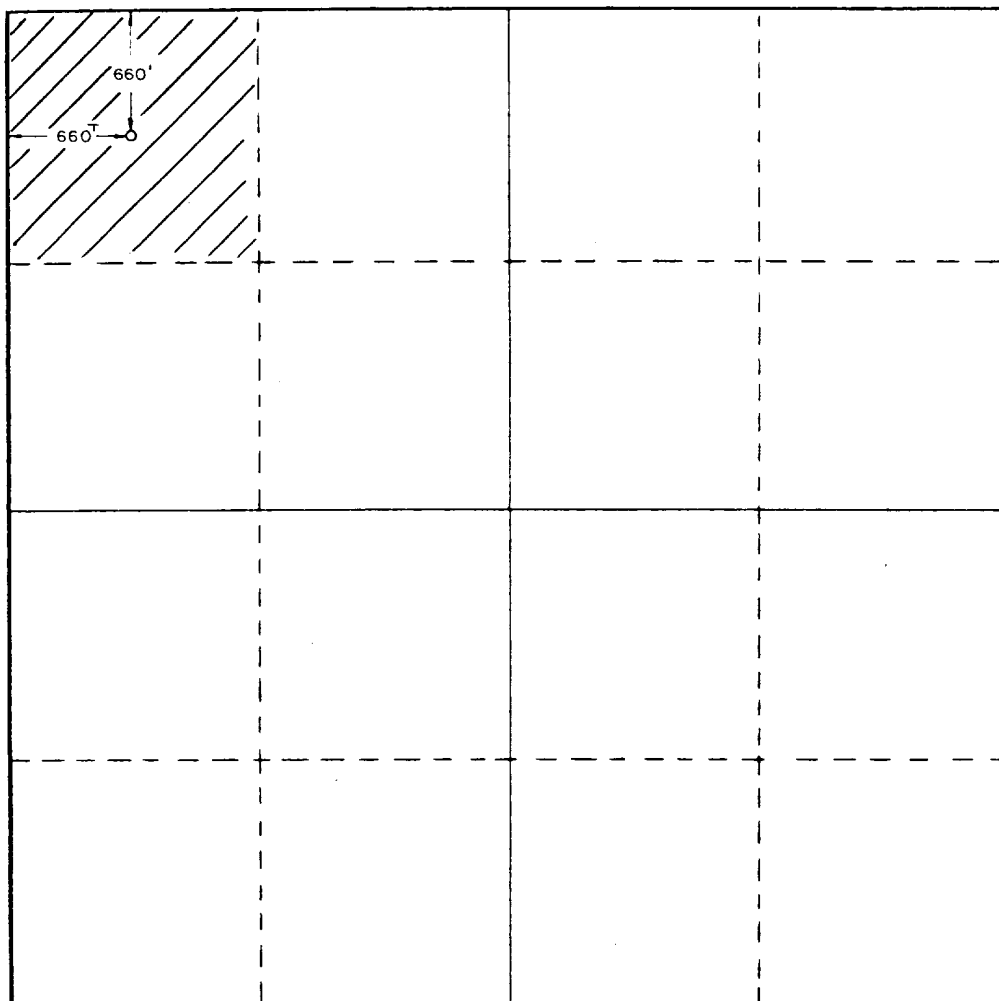

CERTIFICATION

I hereby certify that the information contained herein is true and complete to the best of my knowledge and belief.

Name *Jan Pfister*  
Jan Pfister

Position  
Agent

Company  
J.C. Williamson

Date  
October 3, 1984

I hereby certify that the well location shown on this plat was plotted from field notes of actual surveys made by me or under my supervision, and that the same is true and correct to the best of my knowledge and belief.

Date Surveyed  
September 22, 1984

Registered Professional Engineer  
and/or Land Surveyor

*John W. West*  
Certificate No. JOHN W. WEST, 676  
RONALD J. EIDSON, 3239



## EXHIBIT "E"

### BOP Diagram

After 13-3/8" surface casing has been set and cement circulated to the surface, an 11" double ram BOP, as shown below will be put on the hole. This blowout preventer will be connected to a hydraulically controlled closing unit. The pressure rating on this BOP is 3000#, and will have blank and 4-1/2" pipe rams.

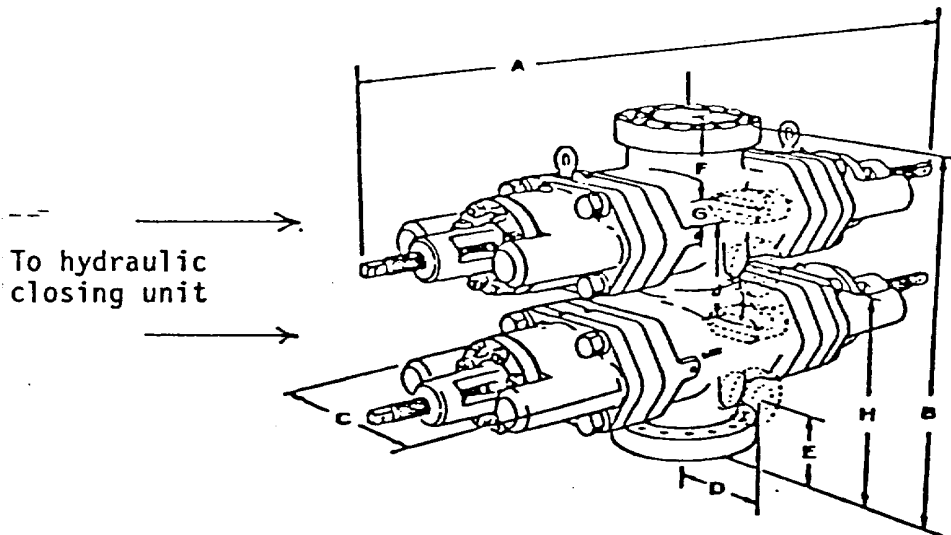

J.C. Williamson  
HOLLY FEDERAL "A" #4

## SUPPLEMENTAL DRILLING DATA

J. C. WILLIAMSON  
HOLLY FEDERAL "A" #4

1. SURFACE FORMATION: Quaternary Alluvium

2. ESTIMATED TOPS OF GEOLOGIC MARKERS:

Rustler Anhydrite	400'
Lamar Shale	3000'
Ramsey Sand	3025'
Olds Sand	3025'
Top Cherry Canyon	4150'
Top Brushy Canyon	5100'

3. ANTICIPATED POSSIBLE WATER AND HYDROCARBON BEARING ZONES:

Fresh Water	above 100'
Delaware (oil)	3025'
Brushy Canyon (oil)	5100' - 5150'; 5600' - 5650'
Lower Brushy Canyon (oil)	6150' - 6200'

4. PROPOSED CASING AND CEMENTING PROGRAM:

Casing program is shown on Form 9-331 C.

Hole for surface casing will be drilled to a depth below fresh water zones. 12-3/4" surface casing will be run to 450 feet, below all fresh water zones and will be cemented to the surface with 425 sacks of Class "C" cement. The pipe will be run open ended with the bottom joint belled out and notched with no centralizers and no plug used to displace the cement. 30-60' of cement will be left inside the pipe and at this depth there is virtually no uncertainty about the depth to which the cement is displaced.

8-5/8" casing will be run and cemented at 2900 feet, prior to entering Delaware section and will be cemented with 150 sacks of Class "C" cement at 2900 feet, tying same back into salt section.

4-1/2" casing will be run to total depth and will be cemented at a total depth if significant shows are encountered in the Brushy Canyon formation, with 1350 sacks Class "C" cement 50-50 poz in stages with DV tool set at 4600 feet plus or minus.

5. PRESSURE CONTROL EQUIPMENT:

Pressure control equipment will consist of a 3000# double ram hydraulically controlled blow out preventer and a 3000# choke manifold.

6. CIRCULATING MEDIUM:

The circulating medium will be fresh water down to 450 feet and brine water in the rest of the hole.

WASTE PIT

125'

125'

TRASH PIT

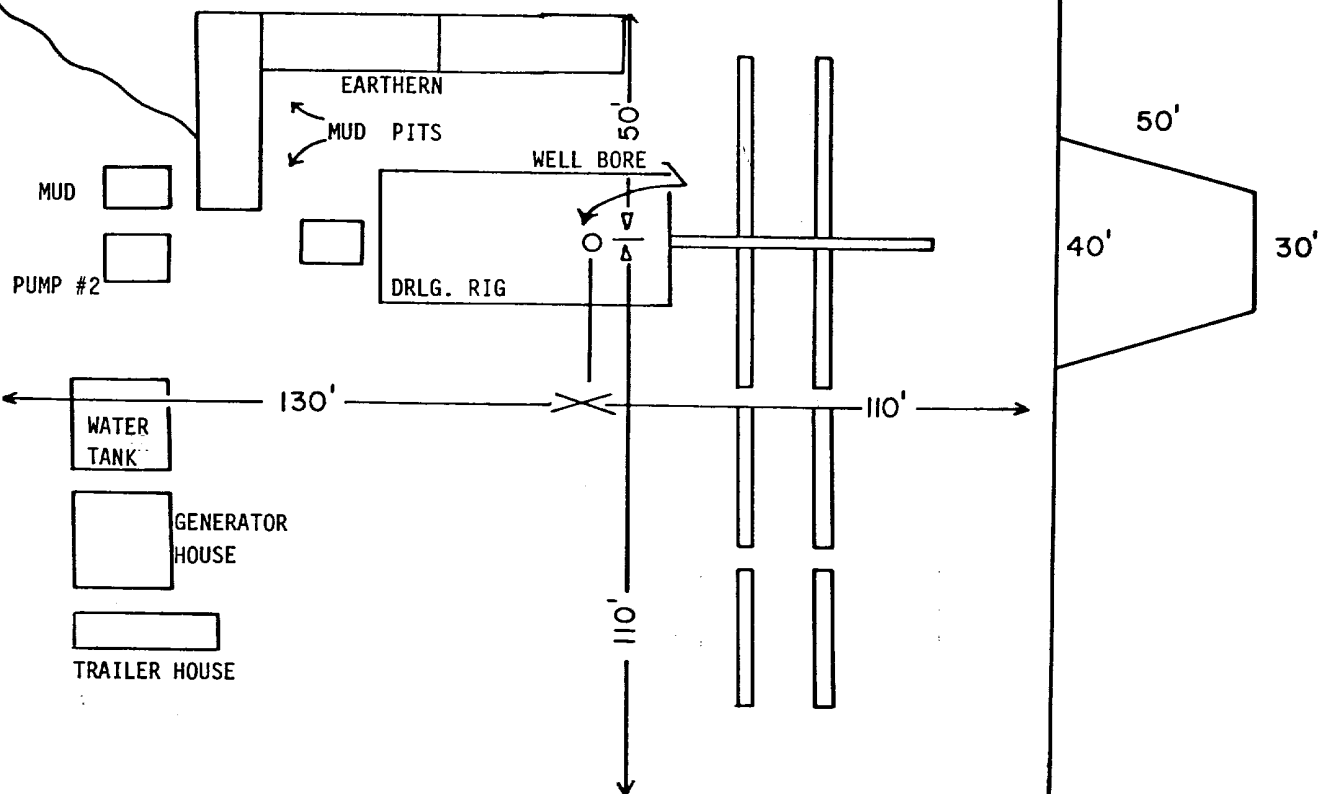

Scale: 1" = 50'

EXHIBIT "D"

J.C. Williamson  
HOLLY FEDERAL "A" #4

DRILLING RIG LAYOUT

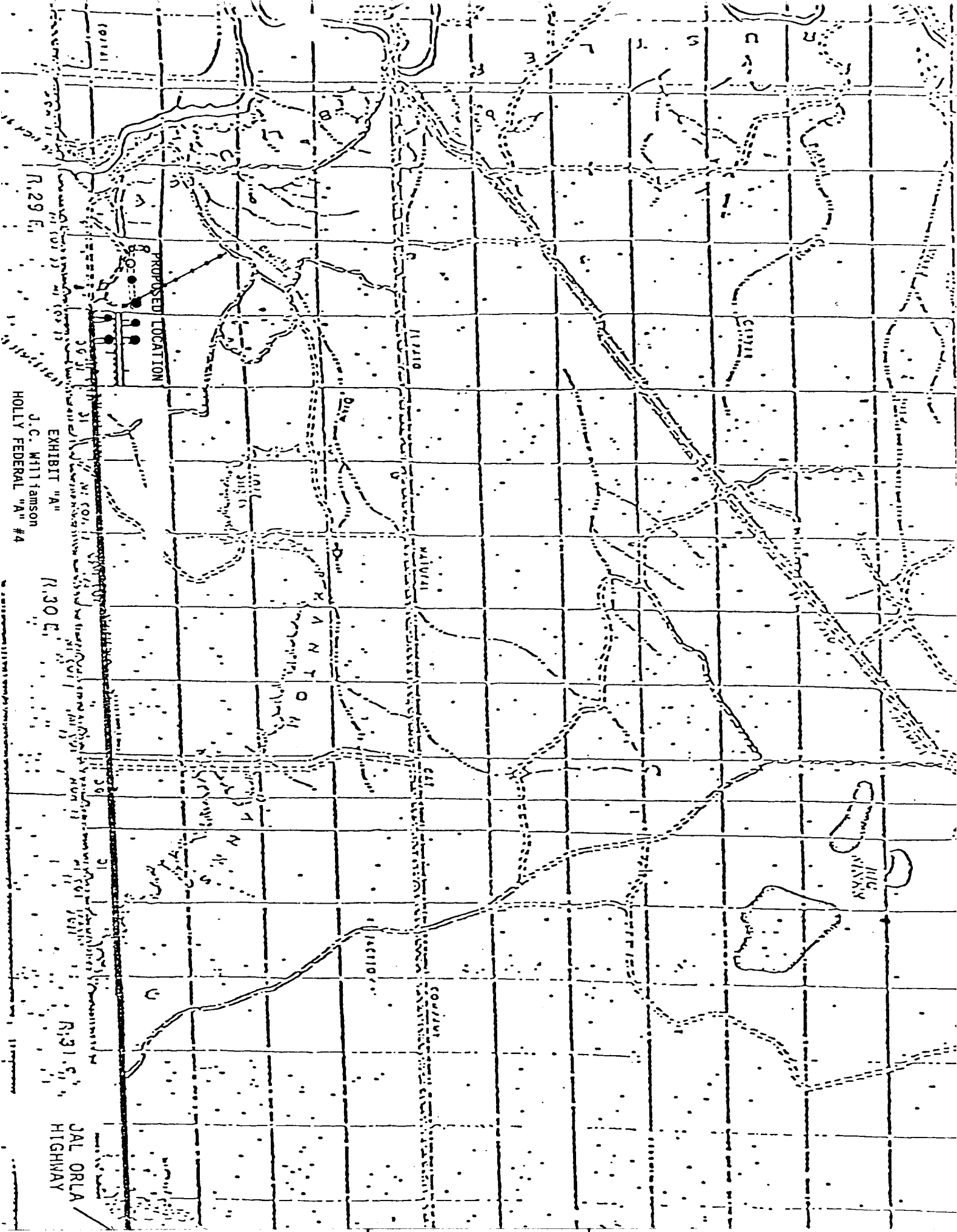

R.29 E.

J.C. WILLIAMSON  
EXHIBIT "A"  
HOLLY FEDERAL "A" #4

R.30 E.

JAL ORLA  
HIGHWAY