

RECEIVED BY Drawer DD UNITED STATES
Artesia, NM 88210 DEPARTMENT OF THE INTERIOR

FEB 12 1985

GEOLOGICAL SURVEY

APPLICATION FOR PERMIT TO DRILL, DEEPEN, OR PLUG BACK

O. C. P.
1A. TYPE OF WORK
ARTESIA, OFFICEDRILL ☒DEEPEN ☐PLUG BACK ☐

B. TYPE OF WELL

OIL
WELL ☒GAS
WELL ☐OTHER ☐SINGLE
ZONE ☒MULTIPLE ☐

2. NAME OF OPERATOR

Gulf Oil Corporation

3. ADDRESS OF OPERATOR

P.O. Box 670 Hobbs, NM - 88240

4. LOCATION OF WELL (Report location clearly and in accordance with any State requirements)

At surface
1650' FSL & 330' FWL

At proposed prod. zone

Same as above

14. DISTANCE IN MILES AND DIRECTION FROM NEAREST TOWN OR POST OFFICE*

13 miles Southeast of Malaga, NM

10. DISTANCE FROM PROPOSED*

LOCATION TO NEAREST
PROPERTY OR LEASE LINE, FT.
(Also to nearest drlg. unit line, if any)

16. NO. OF ACRES IN LEASE

1240

18. DISTANCE FROM PROPOSED LOCATION*
TO NEAREST WELL, DRILLING COMPLETED,
OR APPLIED FOR, ON THIS LEASE, FT.

19. PROPOSED DEPTH

5100

17. NO. OF ACRES ASSIGNED
TO THIS WELL

40

20. ROTARY OR CABLE TOOLS

Rotary

21. ELEVATIONS (Show whether DF, RT, GR, etc.)

2902.7 GLE

22. APPROX. DATE WORK WILL START*

3/1/85

23.

PROPOSED CASING AND CEMENTING PROGRAM

SIZE OF HOLE	SIZE OF CASING	WEIGHT PER FOOT	SETTING DEPTH	QUANTITY OF CEMENT
12 1/4"	8 5/8"	24	450	400 ft ³ (CIRCULATE)
7 7/8"	5 1/2"	15.5	5100	1300 ft ³ (circulate)

Mud Program: 0' - 450' FW spud mud 8.6 - 9.0 ppg, 32-36 vis, 7 - 8 PH,
450' - 5100' Brine/Polymer 10.0 - 10.2ppg, 28 - 32 vis, NC-30cc WL

See Attached BOP drawing for 2000 - 3000 psi working pressure.

IN ABOVE SPACE DESCRIBE PROPOSED PROGRAM: If proposal is to deepen or plug back, give data on present productive zone and proposed new productive zone. If proposal is to drill or deepen directionally, give pertinent data on subsurface locations and measured and true vertical depths. Give blowout preventer program, if any.

24.

SIGNED

R. C. Anderson

TITLE

Area Prod Mgr

DATE

2-2-85

(This space for Federal or State office use)

PERMIT NO.

APPROVAL DATE

APPROVED BY

Dan WorkDuty

TITLE

DATE

2-12-85

CONDITIONS OF APPROVAL, IF ANY:

OKAPPROVAL SUBJECT
GENERAL REQUIREMENTS AND
SPECIAL STIPULATIONS
ATTACHED

*See Instructions On Reverse Side



NEW MEXICO OIL CONSERVATION COMMISSION
WELL LOCATION AND ACREAGE DEDICATION PLAT

Form C-102
Supersedes C-128
Effective 1-1-65

All distances must be from the outer boundaries of the Section

Operator GULF OIL CORP.		Lease BOWEN "BP" FED.		Well No. 3	
Tract Letter L	Section 23	Township 26S	Range 29E	County EDDY	
Actual Footage Location of Well: 1650 feet from the SOUTH line and 330 feet from the WEST line					
Ground Level Elev. 2902.7	Producing Formation DELAWARE	Pool BRUSHY DRAW	Dedicated Acreage: 40 Acres		

1. Outline the acreage dedicated to the subject well by colored pencil or hachure marks on the plat below.
2. If more than one lease is dedicated to the well, outline each and identify the ownership thereof (both as to working interest and royalty).
3. If more than one lease of different ownership is dedicated to the well, have the interests of all owners been consolidated by communitization, unitization, force-pooling, etc?

☐ Yes ☐ No If answer is "yes," type of consolidation _____

If answer is "no," list the owners and tract descriptions which have actually been consolidated. (Use reverse side of this form if necessary.) _____

No allowable will be assigned to the well until all interests have been consolidated (by communitization, unitization, forced-pooling, or otherwise) or until a non-standard unit, eliminating such interests, has been approved by the Commission.

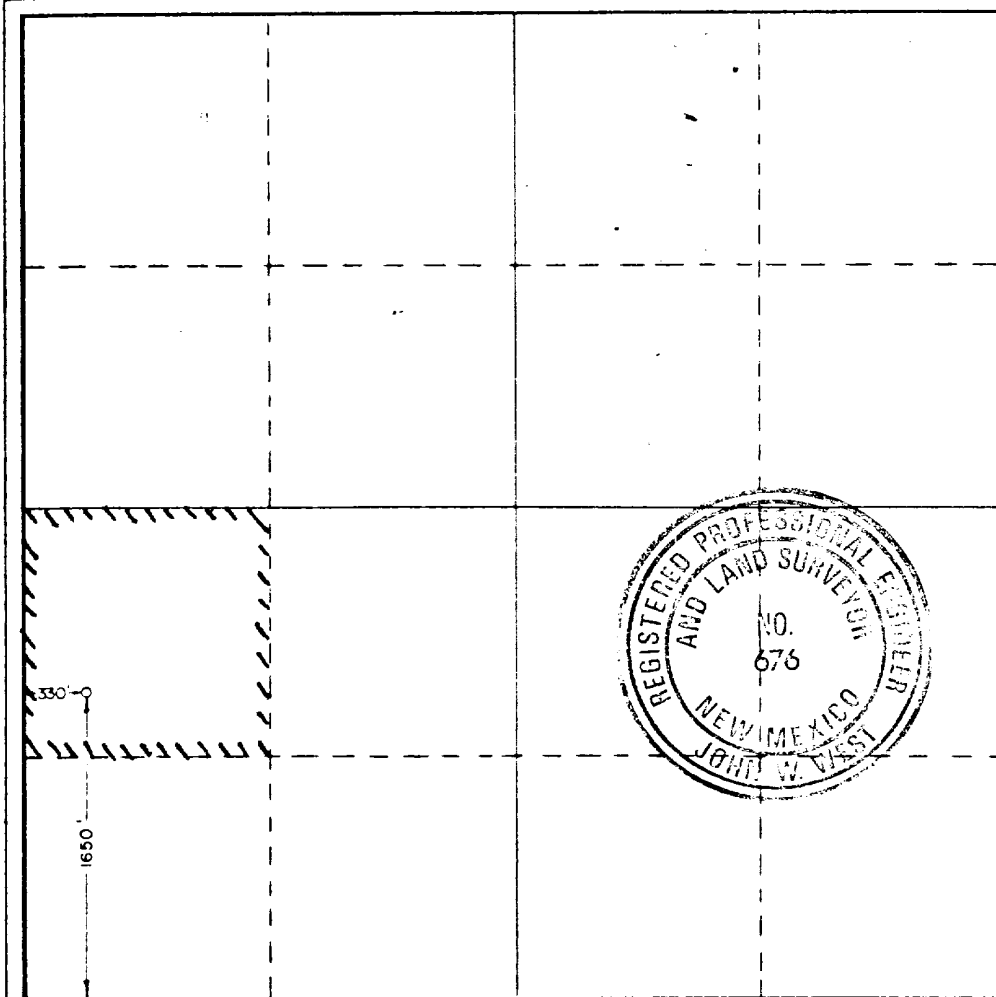

CERTIFICATION

I hereby certify that the information contained herein is true and complete to the best of my knowledge and belief.

Name L. C. Anderson

Position
Area Prod Mgr

Company
Gulf Oil Corp.

Date
2-2-85

I hereby certify that the well location shown on this plat was plotted from field notes of actual surveys made by me or under my supervision, and that the same is true and correct to the best of my knowledge and belief.

Date Surveyed
10/24/84

Registered Professional Engineer
and/or Land Surveyor

John W. West
Certificate No. JOHN W. WEST, 676
RONALD J. EIDSON, 3239

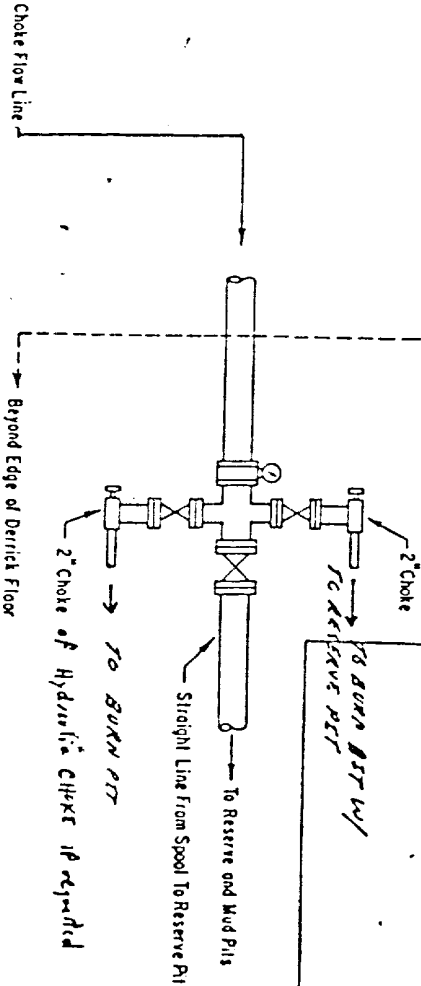
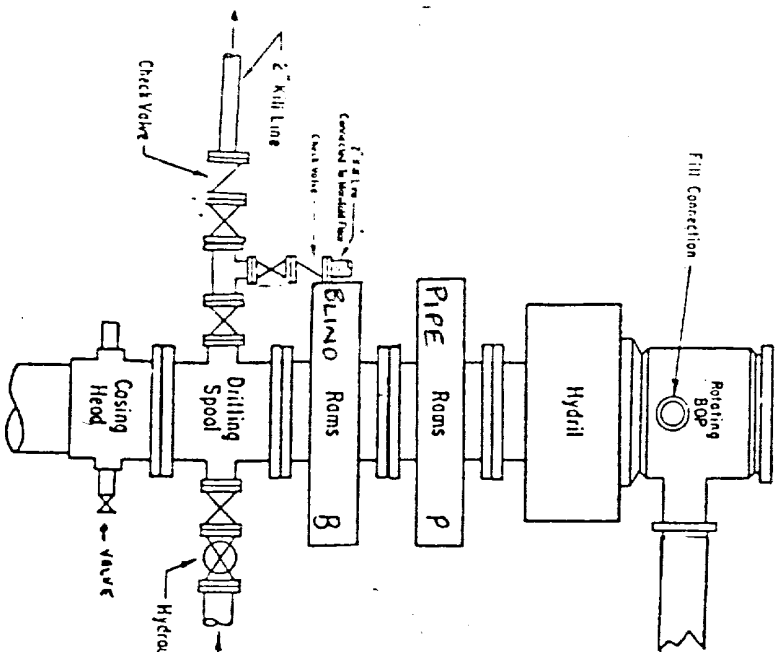

ADDITIONS - DELETIONS - CHANGES
SPECIFY

NOTE: "Wells Reopened" means at any time the Gulf Survivors can, may, or will require the equipment to be installed during operations.

2000-3000 PSI WORKING PRESSURE BOP HOOK - UP

SPECIFY WORKING PRESSURE

labeled, with control handles to indicate open and closed positions. A pressure reducer and regulator must be provided for operating the Hydril preventer. When required, a second pressure reducer shall be available to limit operating fluid pressures to ram preventers. Gulf Legion No. 38 hydraulic oil, or equivalent or better, is to be used as the fluid to operate the hydraulic equipment.

The choke manifold, the choke flow line, the choke lines and the relief lines are to be supported by metal stands and adequately anchored. The choke flow line, relief lines and choke lines shall be constructed as straight as possible and without sharp bends. Entry and exit access shall be maintained to the choke manifold. All valves are to be selected for operation in the presence of oil, gas, and drilling fluid. The choke flow line valves and valves of the relief lines connected to the drilling spool and all ram type preventers must be equipped with stem saturation, wet-tight joints if needed and hand wheels which are to extend beyond the edge of the derrick structure. All other valves shall be equipped with handles.

The blowout preventer assembly shall consist of one blind ram preventer and one pipe ram preventer, both hydraulically operated; a Hydril preventer; valves; chokes and connections, as illustrated. If a tapered drill string is used, a ram preventer shall be provided for each size of drill pipe. Casing and tubing rams to fit the preventers are to be available as needed. The ram preventers may be two singles or a double type. If correct in size, the flanged outlets of the ram preventer may be used for connecting to the 4-inch I.D. choke flow line and to the kill line. The substructure height shall be sufficient to install a rotating blowout preventer.

Minimum operating equipment for the preventers and hydraulically operated valves shall be as follows: (1) multiple pumps, driven by a continuous source of power, capable of fluid charging the total accumulator volume from the nitrogen precharge pressure to its rated pressure within 2 minutes. Also, the pumps are to be connected to the hydraulic operating system which is to be a closed system. (2) the charging pumps shut down, the pressurized fluid volume stored in the accumulator shall be sufficient to close all the pressure-operated devices simultaneously within 9 seconds; after closure, the remaining accumulator pressure shall be not less than 1000 PSI with the remaining accumulator fluid volume at least 50 percent of the original. When required, either an additional source of power, remote and equivalent, is to be available to operate the above pumps, or there shall be additional pumps operated by separate power and equal in performance capabilities.

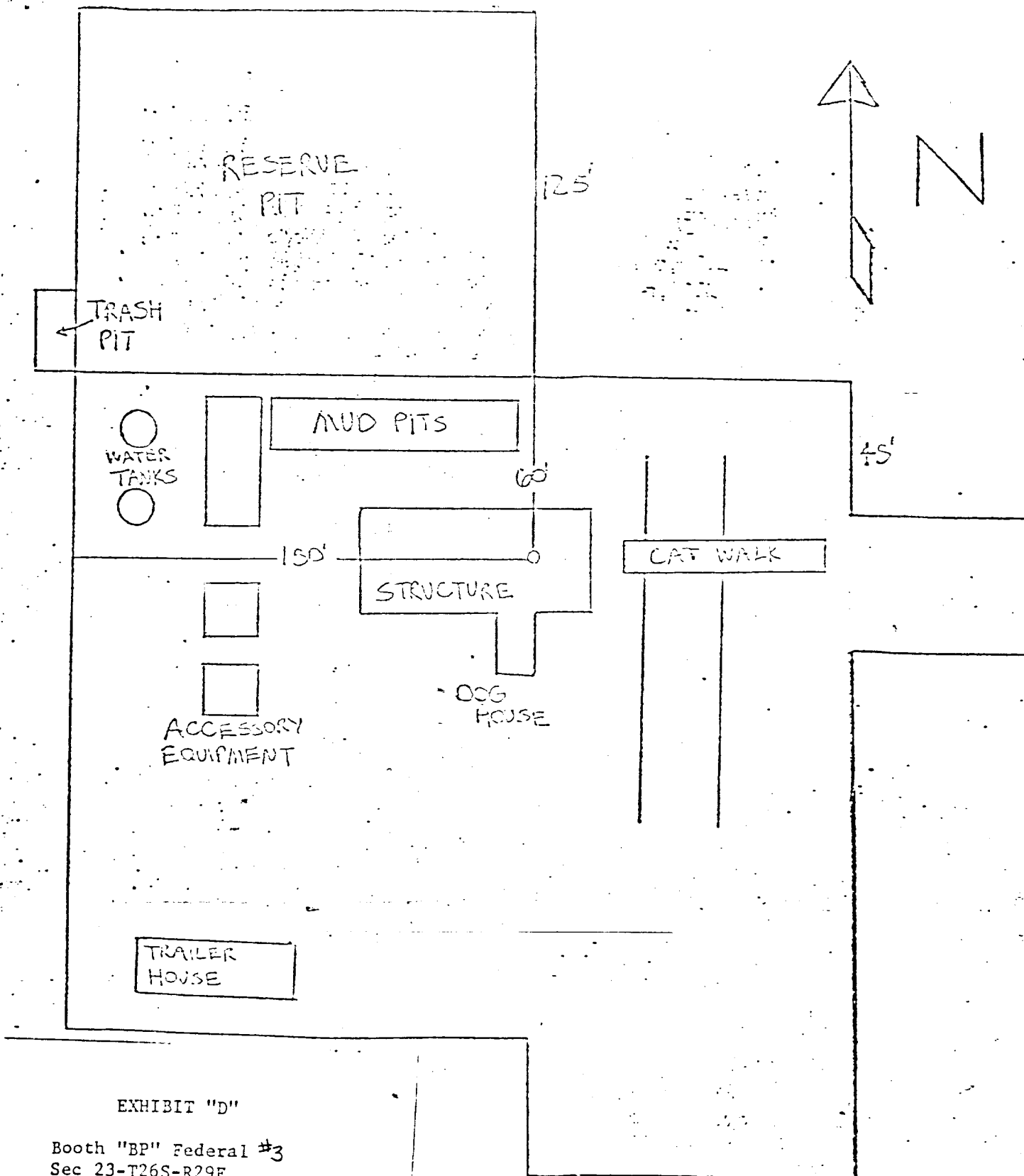

EXHIBIT "D"

Booth "BP" Federal #3
Sec 23-T26S-R29E
Eddy County, New Mexico