

STATE OF NEW MEXICO
ENERGY AND MINERALS DEPARTMENT

C.O.L. CONSERVATION DIVISION
P. O. BOX 2088
SANTA FE, NEW MEXICO

Form C-101
Revised 10-1-78

NO. OF COPIES RECEIVED	
DISTRIBUTION	
SANTA FE	
FILE	
U.S.G.S.	
LAND OFFICE	
OPERATOR	

RECEIVED BY
JUL -7 1987

5A. Indicate Type of Lease
STATE ☒ FCC ☐
5. State Oil & Gas Lease No.
LG 350

APPLICATION FOR PERMIT TO DRILL, DEEPEN, OR PLUG BACK

1a. Type of Work DRILL <input checked="" type="checkbox"/> DEEPEN <input type="checkbox"/> PLUG BACK <input type="checkbox"/>		7. Unit Agreement Name Delaware River Unit
b. Type of Well OIL WELL <input checked="" type="checkbox"/> GAS WELL <input type="checkbox"/> OTHER <input type="checkbox"/> SINGLE ZONE <input type="checkbox"/> MULTIPLE ZONE <input type="checkbox"/>		8. Farm or Lease Name INCO State
2. Name of Operator INCO INVESTMENTS CORPORATION		9. Well No. 1
3. Address of Operator Suite 1200, 16610 Dallas Parkway, Dallas, TX 75248		10. Field and Pool, or Wildcat Wildcat
4. Location of Well UNIT LETTER <u>P</u> LOCATED <u>990</u> FEET FROM THE <u>South</u> LINE AND <u>990</u> FEET FROM THE <u>East</u> LINE OF SEC. <u>10</u> TWP. <u>26S</u> RGE. <u>28E</u> NMPM		12. County Eddy
19. Proposed Depth 3150		19A. Formation Delaware
20. Rotary or C.T. Rotary		
21. Elevations (Show whether DF, RT, etc.) 2994.0 Ground Level	21A. Kind & Status Plug. Bond Cash	21B. Drilling Contractor Roper Energy Co.
		22. Approx. Date Work will start 7/15/87

23. PROPOSED CASING AND CEMENT PROGRAM

SIZE OF HOLE	SIZE OF CASING	WEIGHT PER FOOT	SETTING DEPTH	SACKS OF CEMENT	EST. TOP
12 1/4	8 5/8"	32#	350'	225	Circulate to surface
7 7/8	5 1/2"	14.5#	3150"	200	2300

WORK WILL BE COMPLETED FOR 180 DAYS
BY DATE 1-17-88
UNLESS DRILLING UNDERWAY

IN ABOVE SPACE DESCRIBE PROPOSED PROGRAM: IF PROPOSAL IS TO DEEPEN OR PLUG BACK, GIVE DATA ON PRESENT PRODUCTIVE ZONE AND PROPOSED NEW PRODUCTIVE ZONE. GIVE BLOWOUT PREVENTER PROGRAM, IF ANY.

I hereby certify that the information above is true and complete to the best of my knowledge and belief.

Signed Edward D. Hayden, Sr. Title Edward D. Hayden, Sr. Date 7/1/87

(This space for State Use)
Original Signed By Mike Williams TITLE Oil & Gas Inspector
APPROVED BY _____ DATE JUL 16 1987
CONDITIONS OF APPROVAL, IF ANY _____

NEW MEXICO OIL CONSERVATION COMMISSION
WELL LOCATION AND ACREAGE DEDICATION PLAT

Form C-102
Supersedes C-128
Effective 1-1-65

All distances must be from the outer boundaries of the Section

Operator Inco Investments Corp.			Lease Inco State			Well No. 1		
Tract Letter P	Section 17	Township 26 South	Range 25 East	County Eddy				
Actual Footage Location of Well: 999 feet from the south line and 990 feet from the east line								
Ground Level Elev. 2994.0		Producing Formation Delaware		Pool Wildcat - 1001			Dedicated Acreage: 40 Acres	

1. Outline the acreage dedicated to the subject well by colored pencil or hachure marks on the plat below.
2. If more than one lease is dedicated to the well, outline each and show the ownership thereof (both as to working interest and royalty).
3. If more than one lease of different ownership is dedicated to the well, have the interests of all owners been consolidated by communitization, unitization, force-pooling, etc?
☐ Yes ☐ No If answer is "yes," type of consolidation:

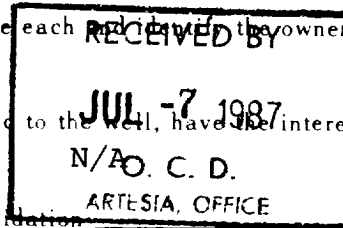

If answer is "no," list the owners and tract descriptions which have actually been consolidated. (Use reverse side of this form if necessary.)

No allowable will be assigned to the well until all interests have been consolidated (by communitization, unitization, forced-pooling, or otherwise) or until a non-standard unit, eliminating such interests, has been approved by the Commission.

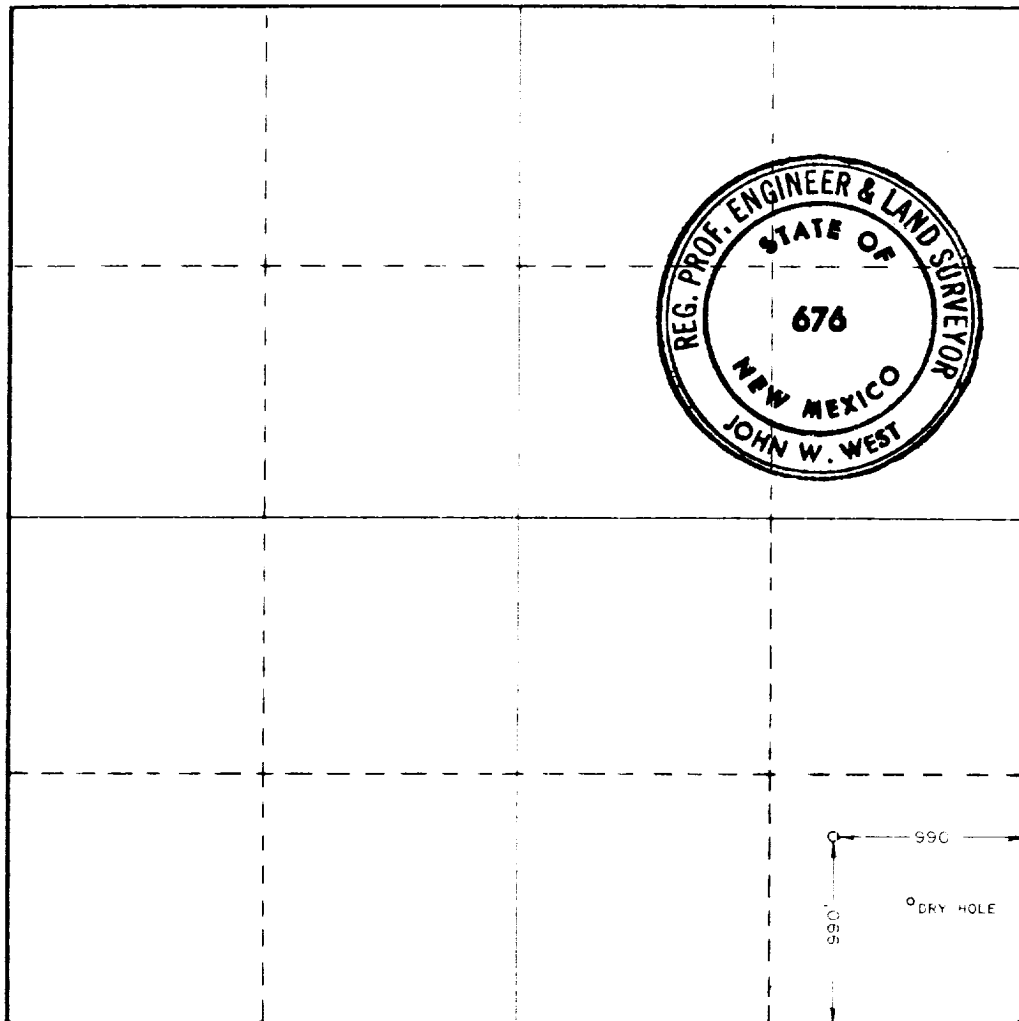

CERTIFICATION

I hereby certify that the information contained herein is true and complete to the best of my knowledge and belief.

Edward D. Hayden, Sr.
Name: Edward D. Hayden, Sr.
Position: President

Company: INCO INVESTMENTS CORP.

Date: 7/1/87

I hereby certify that the well location shown on this plat was plotted from field notes of actual surveys made by me or under my supervision, and that the same is true and correct to the best of my knowledge and belief.

Date Surveyed: June 30, 1987

Registered Professional Engineer and/or Land Surveyor

John W. West

Certificate No. JOHN W. WEST, 676
RONALD J. EIDSON, 3239

91746



P.O. Box 2461
Midland, Texas 79703

Roper Energy

1-87 EQR

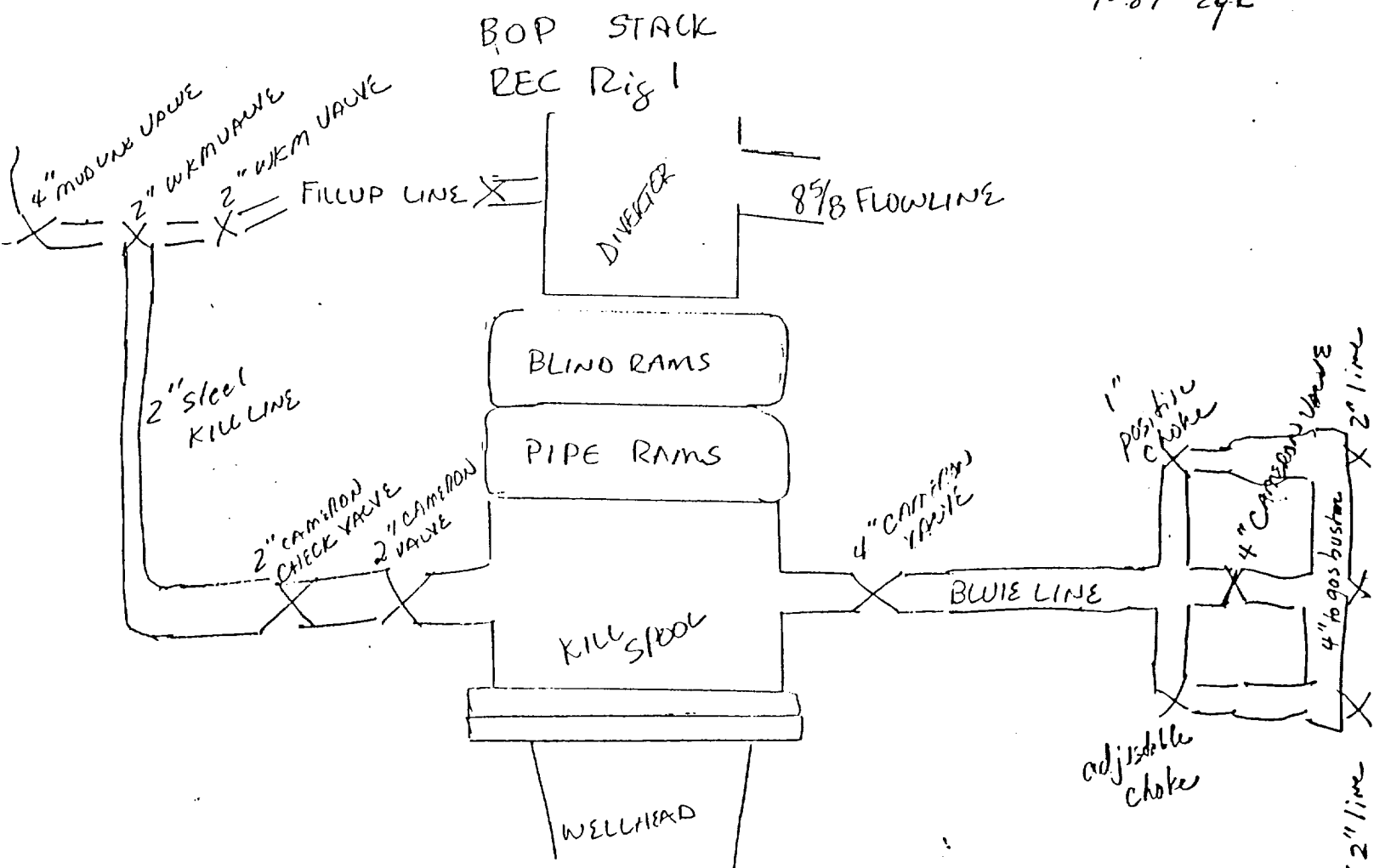

SHAFFER LWS TYPE w/H₂S trim including
KILL SPOOL { CHORE MANIFOLD