

UNITED STATES  
DEPARTMENT OF THE INTERIOR  
GEOLOGICAL SURVEY30-015-25781  
5. LEASE DESIGNATION AND SERIAL NO.

## APPLICATION FOR PERMIT TO DRILL, DEEPEN, OR PLUG BACK

## 1a. TYPE OF WORK

DRILL ☒DEEPEN ☐PLUG BACK ☐

## b. TYPE OF WELL

OIL  
WELL ☒GAS  
WELL ☐OTHER ☐

## 2. NAME OF OPERATOR

BASS ENTERPRISES PRODUCTION CO.

## 3. ADDRESS OF OPERATOR

P O BOX 2760, MIDLAND TX 79702

## 4. LOCATION OF WELL (Report location clearly and in accordance with any State requirements.)

At surface

760' FNL &amp; 2080' FEL, SEC. 20, T24S, R31E, Eddy County, New Mexico

At proposed prod. zone

same as above.

## 14. DISTANCE IN MILES AND DIRECTION FROM NEAREST TOWN OR POST OFFICE\*

+ 40 miles NW from Jal, New Mexico

## 15. DISTANCE FROM PROPOSED\*

LOCATION TO NEAREST

PROPERTY OR LEASE LINE, FT.

(Also to nearest drlg. unit line, if any)

760'

## 16. NO. OF ACRES IN LEASE

1730.31

## 18. DISTANCE FROM PROPOSED LOCATION\*

TO NEAREST WELL, DRILLING, COMPLETED,  
OR APPLIED FOR, ON THIS LEASE, FT.

NA

## 19. PROPOSED DEPTH

4450'

## 21. ELEVATIONS (Show whether DF, RT, GR, etc.)

3508.6' GR

17. NO. OF ACRES ASSIGNED  
TO THIS WELL

40

## 20. ROTARY OR CABLE TOOLS

Rotary

## 22. APPROX. DATE WORK WILL START\*

Upon approval

## 23.

## PROPOSED CASING AND CEMENTING PROGRAM

SIZE OF HOLE	SIZE OF CASING	WEIGHT PER FOOT	SETTING DEPTH	QUANTITY OF CEMENT
12 1/4"	8 5/8"	24#	600'	400 sx Circ to surface.
7 7/8"	5 1/2"	14#	4450'	140 sx

RECEIVED

JUL 31 8 40 AM '87

CARLOS ADAM RESOURCE  
AREA HEADQUARTERS

IN ABOVE SPACE DESCRIBE PROPOSED PROGRAM: If proposal is to deepen or plug back, give data on present productive zone and proposed new productive zone. If proposal is to drill or deepen directionally, give pertinent data on subsurface locations and measured and true vertical depths. Give blowout preventer program, if any.

## 24.

SIGNED

Troy L. Bowers

TITLE Engineering Assistant

DATE

July 27, 1987

(This space for Federal or State office use)

PERMIT NO.

APPROVAL DATE

APPROVED BY

Scott C. Adam

TITLE

DATE

8-3-87

CONDITIONS OF APPROVAL, IF ANY:

N MEXICO OIL CONSERVATION COMMISS  
WELL LOCATION AND ACREAGE DEDICATION PLAT

Form C-102  
Supersedes C-128  
Effective 1-1-65

All distances must be from the outer boundaries of the Section.

**EXHIBIT "A"**

Operator <b>Bass Enterprises Production Co.</b>			Lease <b>Poker Lake Unit</b>		Well No. <b>68</b>
Unit Letter <b>B</b>	Section <b>20</b>	Township <b>24 South</b>	Range <b>31 East</b>	County <b>Eddy</b>	
Actual Footage Location of Well: <div style="display: flex; justify-content: space-between;"> <span>2080 feet from the East line and</span> <span>760 feet from the North line</span> </div>					
Ground Level Elev. <b>3508.6'</b>	Producing Formation <b>Delaware</b>		Pool <b>Wildcat</b>		Dedicated Acreage: <b>40</b> Acres

1. Outline the acreage dedicated to the subject well by colored pencil or hachure marks on the plat below.
2. If more than one lease is dedicated to the well, outline each and identify the ownership thereof (both as to working interest and royalty).
3. If more than one lease of different ownership is dedicated to the well, have the interests of all owners been consolidated by communitization, unitization, force-pooling, etc?

☐ Yes    ☐ No    If answer is "yes," type of consolidation \_\_\_\_\_

If answer is "no," list the owners and tract descriptions which have actually been consolidated. (Use reverse side of this form if necessary.) \_\_\_\_\_

No allowable will be assigned to the well until all interests have been consolidated (by communitization, unitization, forced-pooling, or otherwise) or until a non-standard unit, eliminating such interests, has been approved by the Commission.

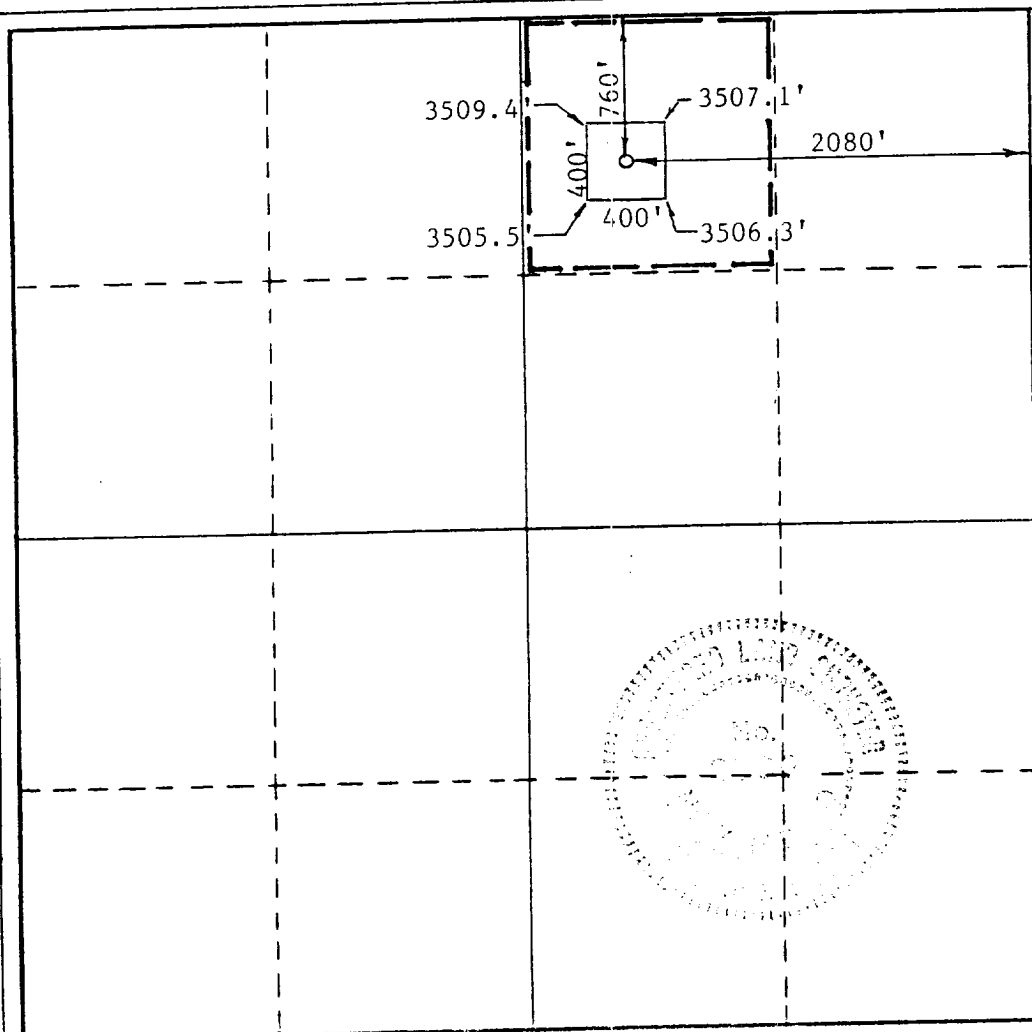

**CERTIFICATION**

I hereby certify that the information contained herein is true and complete to the best of my knowledge and belief.

*Troy L. Bevers*  
Name

Troy L. Bevers

Position

Engineering Assistant

Company

Bass Enterprises Prod. Co.

Date

July 27, 1987

I hereby certify that the well location shown on this plat was plotted from field notes of actual surveys made by me or under my supervision, and that the same is true and correct to the best of my knowledge and belief.

Date Surveyed

July 22, 23 & 24, 1987

Registered Professional Engineer  
and/or Land Surveyor

*Ronald J. Eidson*

Certificate No. JOHN W. WEST, 676

RONALD J. EIDSON, 3239

## EIGHT POINT PROGRAM

NAME OF WELL: Poker Lake Unit #68

LOCATION: 760' FNL & 2080' FEL, Sec. 20, T24S, R31E,  
Eddy County, New Mexico

POINT 1: ESTIMATED FORMATION TOPS (SEE NO. 2 BELOW)

POINT 2: WATER, OIL, GAS AND/OR MINERAL BEARING FORMATIONS

ANTICIPATED FORMATION TOPS: Estimated KB 3522'  
Estimated GL 3510'

<u>Formation</u>	<u>Estimated Top from KB</u>	<u>Estimated Subsea Top</u>
T/Rustler	592'	+2930 water (brackish)
T/Salt	962'	+2560'
B/Salt	4103'	- 581'
T/Lamar	4323'	- 801'
T/Ramsey	4357'	- 835' oil/gas
T/Reservoir Sand	4374'	- 852' oil/gas
TD	4450'	- 928'

POINT 3: CASING PROGRAM

CASINGS:

Type	Intervals	Purpose	Condition
14" thin wall	0-40'	Conductor	New
8 5/8" 24#/ft K-55 ST&C	0-600'	Surface	New
5 1/2" 14#/ft K-55 ST&C	0-4450'	Production	New

POINT 4: PRESSURE CONTROL EQUIPMENT (SEE ATTACHED BEPCO II BOP DIAGRAM)

A BOP equivalent to a BEPCo II, furnished by contractor should be nipped up on the surface casing head. The entire BOP stack\*, choke, kill lines, kelly cock, kelly safety valve, and inside blowout preventer should be tested to the rated working pressure of the preventer or casing head, whichever is less. Both a low pressure (200 psi) and a working pressure test are required:

- a) Upon initial installation
- b) After any component changes

A function test to insure that the preventers are operating correctly should be performed on each trip but not more than once per day.

\*The annular preventer should be tested to 50% of the rated working pressure.

G SINKS QUADRANGLE  
NEW MEXICO—EDDY CO.  
7.5 MINUTE SERIES (TOPOGRAPHIC)  
**EXHIBIT "B"**

1:50,000  
1:62,500  
1:62,500  
1:62,500

EDDY COUNTY, N. M.  
Topographic Map of  
BIG SINKS, NEW MEXICO  
Township: 24-25-S  
Range: 30-31-E

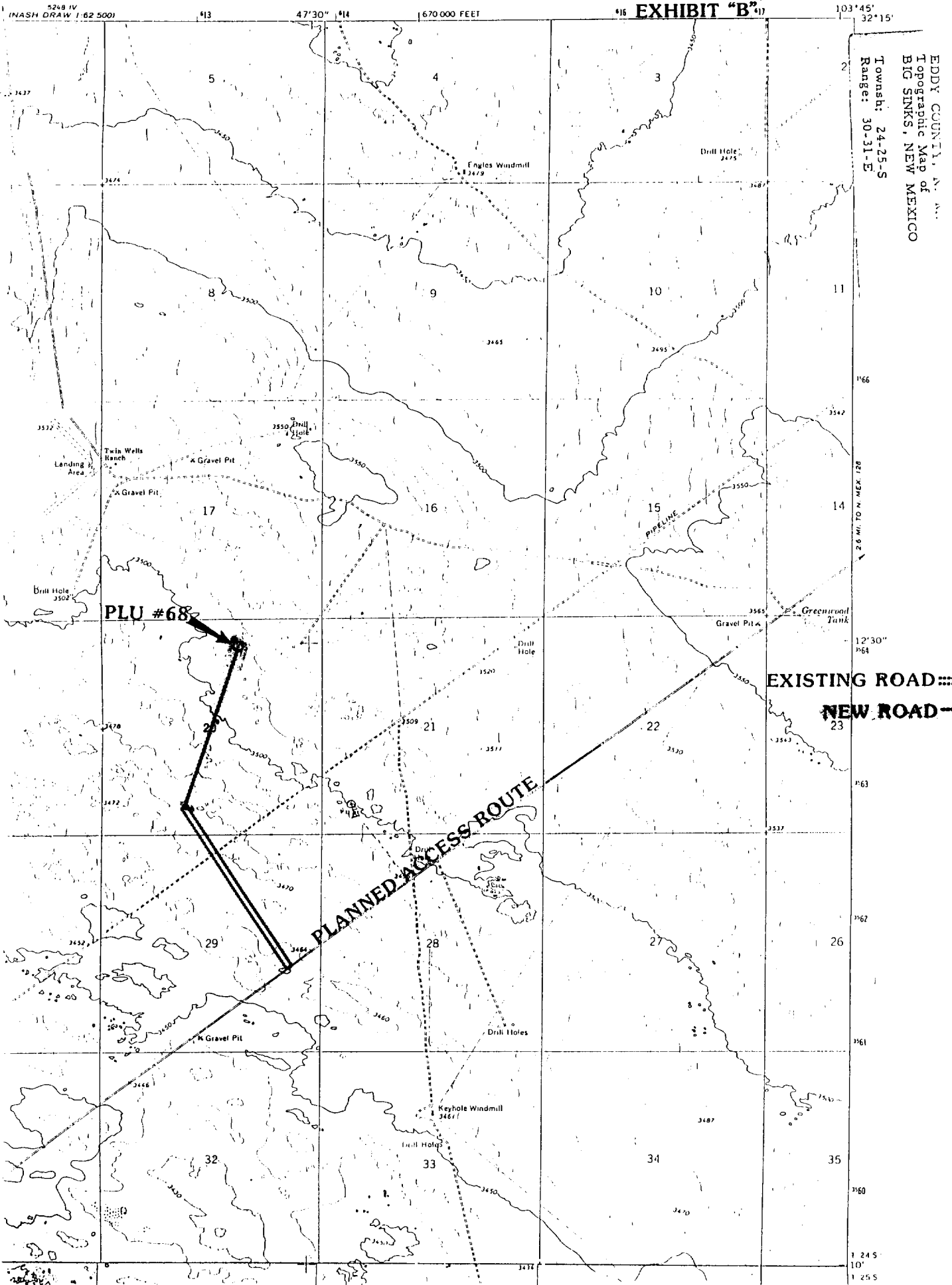

EXHIBIT "D"

