

UNITED STATES
DEPARTMENT OF THE INTERIOR
BUREAU OF LAND MANAGEMENT

SUBMIT IN DUPLICATE*

(See other in-
structions on
reverse side)

Form approved.
Budget Bureau No. 1004-0137
Expires August 31, 1985

WELL COMPLETION OR RECOMPLETION REPORT AND LOG *

1a. TYPE OF WELL: OIL WELL ☐ GAS WELL ☐ DRY ☒ OTHER ☐ Uneconomical to
b. TYPE OF COMPLETION: NEW WELL ☒ WORK OVER ☐ DEEP EN ☐ BACK ☐ DIFF. EN ☐ OTHER ☐ Produce. Plan to
convert to disposal

2. NAME OF OPERATOR

Merit Energy Company

3. ADDRESS OF OPERATOR

12221 Merit Drive, Suite 500, Dallas, TX 75251

4. LOCATION OF WELL (Report location clearly and in accordance with any State requirements)*

At surface

2090' FNL & 1980' FWL

At top prod. interval reported below

Same

At total depth Same

14. PERMIT NO.

DATE ISSUED

8-2-93

15. DATE SPUNDED

8-12-92

16. DATE T.D. REACHED

8-29-93

17. DATE COMPL. (Ready to prod.)

9-19-93

18. ELEVATIONS (DF, RKB, RT, GR, ETC.)*

3515.0 GR

19. ELEV. CASINGHEAD

20. TOTAL DEPTH, MD & TVD

8440

21. PLUG. BACK T.D., MD & TVD

8350

22. IF MULTIPLE COMPL.
HOW MANY*

23. INTERVALS
DRILLED BY

ROTARY TOOLS

CABLE TOOLS

X

24. PRODUCING INTERVAL(S). OF THIS COMPLETION—TOP, BOTTOM, NAME (MD AND TVD)*

8218 - 8254 (Delaware)

25. WAS DIRECTIONAL
SURVEY MADE

Yes

26. TYPE ELECTRIC AND OTHER LOGS RUN

DLL/GR/CNL

27. WAS WELL CORED

No

28. CASING RECORD (Report all strings set in well)

CASING SIZE	WEIGHT, LB./FT.	DEPTH SET (MD)	HOLE SIZE	CEMENTING RECORD	AMOUNT PULLED
11 3/4	42#	418	14 3/4	485 SX	None
8 5/8	32#	4450	11	1773 SX	None
5 1/2	15 1/2 & 17#	8440	7 7/8	974 SX	None

29. LINER RECORD

SIZE	TOP (MD)	BOTTOM (MD)	SACKS CEMENT*	SCREEN (MD)

30. TUBING RECORD

SIZE	DEPTH SET (MD)	PACKER SET (MD)
2 7/8	8152	8152

31. PERFORATION RECORD (Interval, size and number)

8218 - 8254

2 spf Total 20 shots

1/3"

32. ACID, SHOT, FRACTURE, CEMENT SQUEEZE, ETC.

DEPTH INTERVAL (MD)	AMOUNT AND KIND OF MATERIAL USED
8218 - 8254	Acid w/1500 gals 15% HCL
	Frac w/104,140# Sand

33. PRODUCTION

DATE FIRST PRODUCTION		PRODUCTION METHOD (Flowing, gas lift, pumping—size and type of pump)					WELL STATUS (Producing or shut-in)	
9-20-93		Swab Test						
DATE OF TEST	HOURS TESTED	CHOKE SIZE	PROD'N FOR TEST PERIOD	OIL—BBL.	GAS—MCF	WATER—BBL.	GAS-OIL RATIO	
9-20-93	24		→	6	TSTM	194		
FLOW. TUBING PRESS.	CASINO PRESSURE	CALCULATED 24-HOUR RATE	OIL BBL	GAS—MCF.	WATER—BBL.	OIL GRAVITY-API (CORR.)		
		→	6	TSTM	194			

34. DISPOSITION OF GAS (Sold, used for fuel, vented, etc.)

35. LIST OF ATTACHMENTS

Logs, Plat, Deviation Survey

36. I hereby certify that the foregoing and attached information is complete and correct as determined from all available records

SIGNED

TITLE

Regulatory Manager

CARLSBAD, NEW MEXICO

DATE

10-1-93

*(See Instructions and Spaces for Additional Data on Reverse Side)

38. SUMMARY OF POROUS ZONES: (Show all important zones of porosity and contents thereof; cored intervals; and all drill-stem, tests, including depth interval tested, cushion used, flowing and shut-in pressures, and recoveries):

38. GEOLOGIC MARKERS

FORMATION	TOP	BOTTOM	DESCRIPTION, CONTENTS, ETC.	NAME	TOP	
					MEAS. DEPTH	TRUE VERT. DEPTH
				Rustler	850	850
				Delaware	4440	4440
				Cherry Canyon	5520	5520
				Lower Brushy Canyon	8020	8020
				Bone Spring	8290	8290

WELL NAME & NUMBER SDS 11 FED #1

LOCATION Section 11, T-24-S, R-31-E
(Give Unit, Section, Township and Range)

JAN 18 1994

OPERATOR Enron Oil & Gas Company, 4000 North Big Springs, P.O. Box 2267, Midland TX

79702

DRILLING CONTRACTOR Nabors Drilling USA, Inc., 500 W. Wall, Suite 280, Midland, TX 79701

The undersigned hereby certifies that he is an authorized representative of the drilling contractor who drilled the above-described well and that he has conducted deviation tests and obtained the following results:

<u>DEGREES @ DEPTH</u>	<u>DEGREES @ DEPTH</u>	<u>DEGREES @ DEPTH</u>	<u>DEGREES @ DEPTH</u>
0.75 142	2.00 2765	1.00 6871	
1.25 387	1.75 2828	1.00 7366	
1.50 637	1.25 2900	1.25 7863	
2.25 1108	1.25 2954	1.25 7931	
3.00 1233	1.00 3214	0.50 8410	
2.00 1364	1.75 3422		
1.75 1449	2.00 3612		
1.50 1541	1.50 3714		
1.00 1695	1.00 3935		
0.50 1894	1.00 4301		
1.00 2083	0.50 4785		
2.00 2357	1.00 5160		
1.74 2418	0.75 5440		
1.75 2480	0.50 5875		
1.25 2575	0.75 6372		

Drilling Contractor Nabors Drilling USA, Inc.

By *L. V. Bohannon*

L. V. Bohannon, Drilling Supt.

Subscribed and sworn to before me this 14 day of September, 19 93

Joann McMahon
Notary Public

My Commission Expires _____

Midland County TX

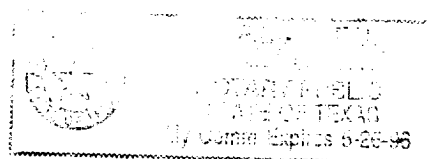

Submit to Appropriate
District Office
State Lease - 4 copies
Fee Lease - 3 copies

State of New Mexico
Energy, Minerals and Natural Resources Department

Form C-102
Revised 1-1-89

OIL CONSERVATION DIVISION

P.O. Box 2088
Santa Fe, New Mexico 87504-2088

DISTRICT I

P.O. Box 1980, Hobbs, NM 88240

DISTRICT II

P.O. Drawer DD, Artesia, NM 88210

DISTRICT III

1000 Rio Brazos Rd., Aztec, NM 87410

WELL LOCATION AND ACREAGE DEDICATION PLAT

All Distances must be from the outer boundaries of the section

Operator ENRON OIL AND GAS COMPANY			Lease S.D.S. "11" FEDERAL		Well No. 1
Unit Letter F	Section 11	Township 24 SOUTH	Range 31 EAST	NMPM	County EDDY
Actual Footage Location of Well: 2090 feet from the NORTH line and 1980 feet from the WEST line					
Ground Level Elev. 3515.0'	Producing Formation Delaware	Pool Und	Dedicated Acreage: 40 Acres		

- Outline the acreage dedicated to the subject well by colored pencil or hatchure marks on the plat below.
- If more than one lease is dedicated to the well, outline each and identify the ownership thereof (both as to working interest and royalty).
- If more than one lease of different ownership is dedicated to the well, have the interest of all owners been consolidated by communitization, unitization, force-pooling, etc.?
☐ Yes ☐ No If answer is "yes" type of consolidation _____

If answer is "no" list of owners and tract descriptions which have actually been consolidated. (Use reverse side of this form necessary.)

No allowable will be assigned to the well unit all interests have been consolidated (by communitization, unitization, forced-pooling, otherwise) or until a non-standard unit, eliminating such interest, has been approved by the Division.

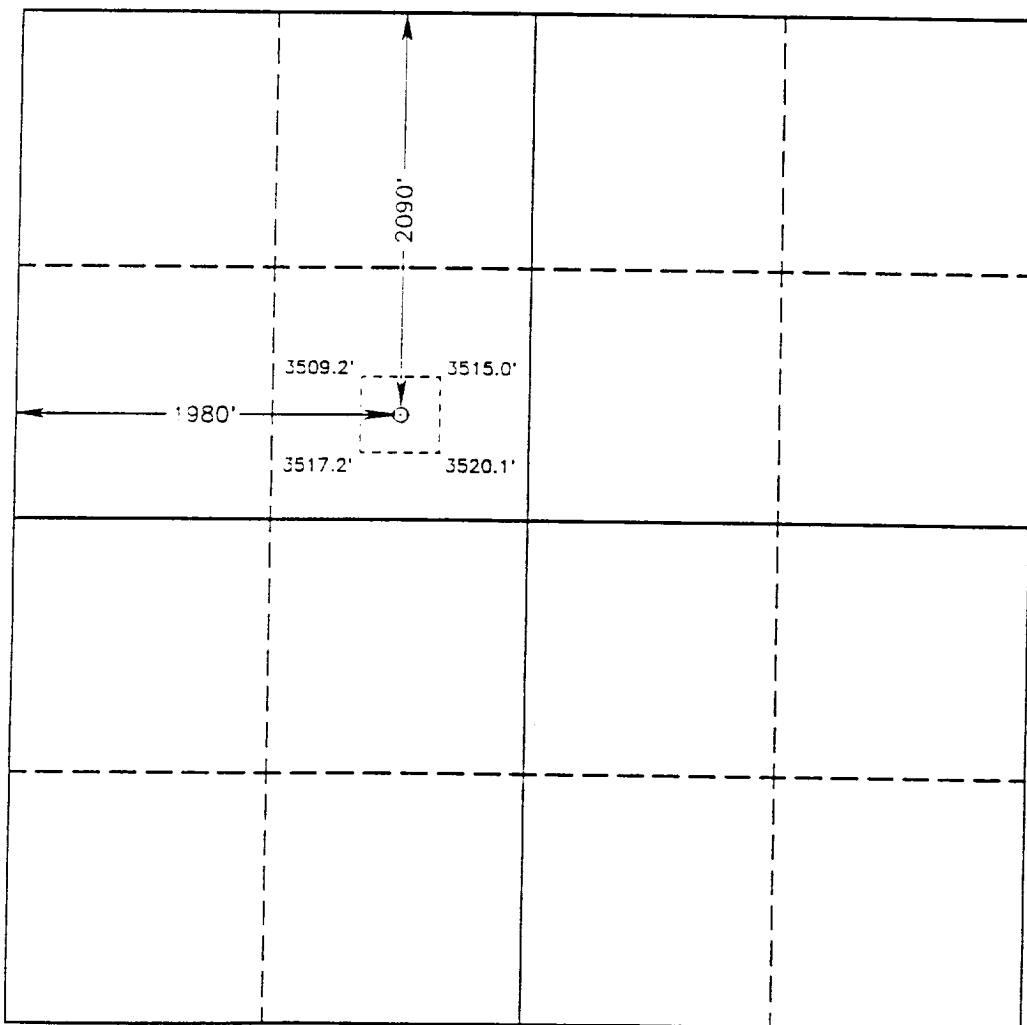

OPERATOR CERTIFICATION

I hereby certify the the information contained herein is true and complete to the best of my knowledge and belief.

Signature

Printed Name

Betty Gildon

Position

Regulatory Analyst

Company

Enron Oil & Gas Company

Date

6/18/93

SURVEYOR CERTIFICATION

I hereby certify that the well location shown on this plat was plotted from field notes of actual surveys made by me or under my supervision and that the same is true and correct to the best of my knowledge and belief.

Date Surveyed

MARCH 23, 1993

Signature & Seal of
Professional Surveyor

