

NM OIL CONS. COMMISSION
UNITED STATES
DEPARTMENT OF THE INTERIOR
ARTESIA, NM 88210
BUREAU OF LAND MANAGEMENT

SUBMIT IN TRIPLICATE*
(Other instructions on
reverse side)

Form approved.
Budget Bureau No. 1004-0136
Expires: December 31, 1991

APPLICATION FOR PERMIT TO DRILL OR DEEPEN

1a. TYPE OF WORK DRILL <input checked="" type="checkbox"/> DEEPEN <input type="checkbox"/>		5. LEASE DESIGNATION AND SERIAL NO. LC 061705- 8A	
b. TYPE OF WELL OIL WELL <input checked="" type="checkbox"/> GAS WELL <input type="checkbox"/> OTHER <input type="checkbox"/>		6. IF INDIAN, ALLOTTEE OR TRIBE NAME	
2. NAME OF OPERATOR Bass Enterprises Production Company		7. UNIT AGREEMENT NAME Poker Lake Unit	
3. ADDRESS AND TELEPHONE NO. P.O. Box 2760, Midland, TX 79702 (915) 683-2277		8. FARM OR LEASE NAME, WELL NO. Poker Lake Unit #106	
4. LOCATION OF WELL (Report location clearly and in accordance with any State requirements.) At surface 1980' FWL & 1980' FSL, Section 25, T-24-S, R-30-E At proposed prod. zone		9. API WELL NO. 30-015-27920	
14. DISTANCE IN MILES AND DIRECTION FROM NEAREST TOWN OR POST OFFICE* 15.2 Miles SE from Malaga, NM		10. FIELD AND POOL, OR WILDCAT Poker Lake Unit (Delaware)	
13. DISTANCE FROM PROPOSED* LOCATION TO NEAREST PROPERTY OR LEASE LINE, FT. (Also to nearest drig. unit line, if any) 1980'		11. SEC., T., R., M., OR BLM. AND SURVEY OR AREA 66202	
18. DISTANCE FROM PROPOSED LOCATION* TO NEAREST WELL, DRILLING, COMPLETED, OR APPLIED FOR, ON THIS LEASE, FT. 1320'		12. COUNTY OR PARISH Eddy	
21. ELEVATIONS (Show whether DF, RT, GR, etc.) 3443' GR		13. STATE NM	
19. PROPOSED DEPTH 8300'		17. NO. OF ACRES ASSIGNED TO THIS WELL 40	
20. ROTARY OR CABLE TOOLS Rotary		22. APPROX. DATE WORK WILL START* Upon Approval	

PROPOSED CASING AND CEMENTING PROGRAM

SIZE OF HOLE	GRADE SIZE OF CASING	WEIGHT PER FOOT	SETTING DEPTH	QUANTITY OF CEMENT
*14-3/4"	11-3/4" WC-40	42#	960'	530 SX (Circ. to Surface)
**11"	8-5/8" WC-50	32#	4050'	890 SX (Circ. to Surface)
***7-7/8"	5-1/2" K-55	15.5#	8300'	615 SX (Tie Back to 3850')

- *Surface casing to be set +/-100' above the salt in the Rustler Anhydrite.
**Intermediate casing to be set in the top of the Lamar Lime.
***DV Tool to be set at +/-6000', cement to tie back to 3850'.

Drilling procedure, BOP diagram, anticipated tops and surface use plans attached.

Note: This location is outside of R-111 Potash Areas.

Approval Subject to
General Requirements and
Special Regulations
Attached

IN ABOVE SPACE DESCRIBE PROPOSED PROGRAM: If proposal is to deepen, give data on present productive zone and proposed new productive zone. If proposal is to drill or deepen directionally, give pertinent data on subsurface locations and measured and true vertical depths. Give blowout preventer program, if any.

24. SIGNED William R. Dannels TITLE Division Drilling Supt. DATE 3/24/94

(This space for Federal or State office use)

PERMIT NO. _____ APPROVAL DATE _____

Application approval does not warrant or certify that the applicant holds legal or equitable title to those rights in the subject lease which would entitle the applicant to conduct operations thereon.

CONDITIONS OF APPROVAL, IF ANY:

APPROVED BY Ron Denton TITLE Acting AREA MANAGER DATE APR 18 1994

*See Instructions On Reverse Side

Submit to Appropriate
District Office
State Lease - 4 copies
Fee Lease - 3 copies

State of New Mexico
Energy, Minerals and Natural Resources Department

Form C-102
Revised 1-1-85

OIL CONSERVATION DIVISION

P.O. Box 2088
Santa Fe, New Mexico 87504-2088

DISTRICT I

P.O. Box 1980, Hobbs, NM 88240

DISTRICT II

P.O. Drawer DD, Artesia, NM 88210

DISTRICT III

1000 Rio Brazos Rd., Aztec, NM 87410

WELL LOCATION AND ACREAGE DEDICATION PLAT

All Distances must be from the outer boundaries of the section

Operator BASS ENTERPRISES PROD. CO.			Lease POKER LAKE UNIT		Well No. 106
Unit Letter K	Section 25	Township 24 SOUTH	Range 30 EAST	NMPM	County EDDY
Actual Footage Location of Well: 1980 feet from the SOUTH line and 1980 feet from the WEST line					
Ground Level Elev. 3443'	Producing Formation Delaware		Pool Poker Lake (Delaware) UND		Dedicated Acreage: 40 Acres

- Outline the acreage dedicated to the subject well by colored pencil or hachure marks on the plat below.
 - If more than one lease is dedicated to the well, outline each and identify the ownership thereof (both as to working interest and royalty).
 - If more than one lease of different ownership is dedicated to the well, have the interest of all owners been consolidated by communitization, unitization, force-pooling, etc.?
☐ Yes ☐ No If answer is "yes" type of consolidation _____
- If answer is "no" list of owners and tract descriptions which have actually been consolidated. (Use reverse side of this form necessary.) _____
- No allowable will be assigned to the well unit all interests have been consolidated (by communitization, unitization, forced-pooling, otherwise) or until a non-standard unit, eliminating such interest, has been approved by the Division.

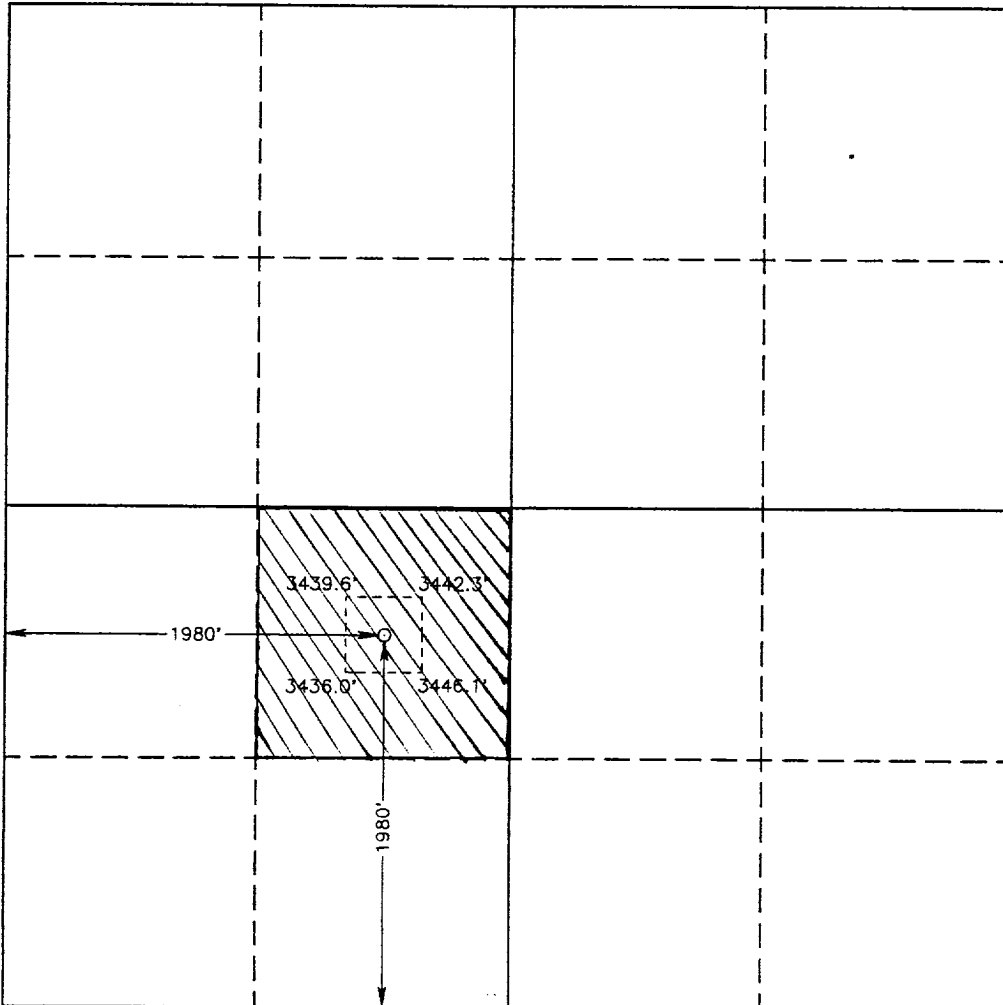

OPERATOR CERTIFICATION

I hereby certify the the information contained herein is true and complete to the best of my knowledge and belief.

Signature *William R. Dannels*
Printed Name **William R. Dannels**
Position **Division Drilling Supt.**
Company **Bass Enterprises Prod. Co.**
Date **3/24/94**

SURVEYOR CERTIFICATION

I hereby certify that the well location shown on this plat was plotted from field notes of actual surveys made by me or under my supervision, and that the same is true and correct to the best of my knowledge and belief.

Date Surveyed **FEBRUARY 23 1994**
Signature *Seal of Gary L. Jones*
Professional Surveyor
NEW MEXICO
7977
Certificate No. **7977**
Name **GARY L. JONES**
Address **676**
3239
7977

94-11-0344

3000 PSI WP

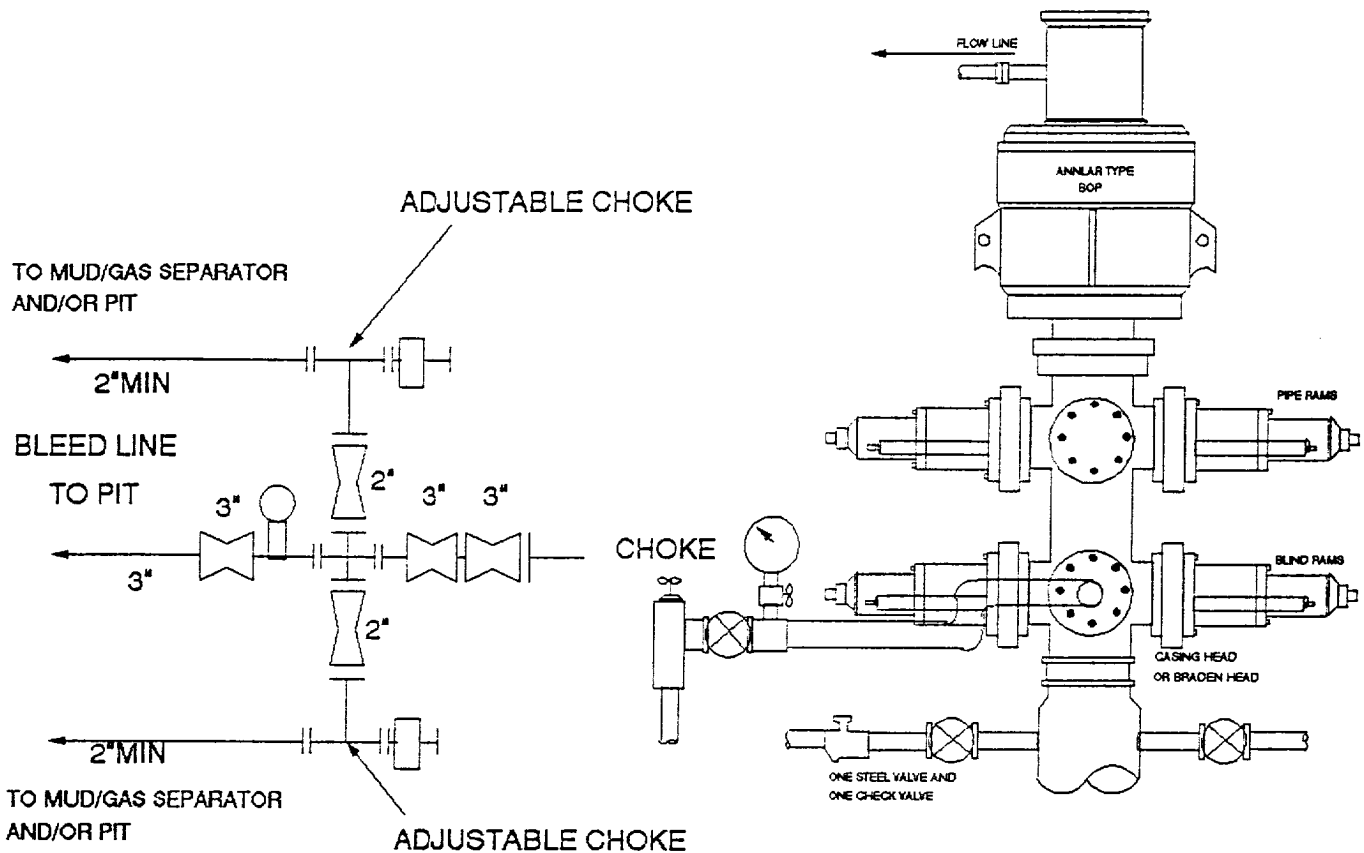

THE FOLLOWING CONSTITUTE MINIMUM BLOWOUT PREVENTER REQUIREMENTS

- A. One double gate blowout preventer with lower rams for pipe and upper rams blind, all hydraulically controlled.
- B. Opening on preventers between rams to be flanged, studded or clamped and at least two inches in diameter.
- C. All connections from operating manifold to preventers to be all steel hose or tube a minimum of one inch in diameter.
- D. The available closing pressure shall be at least 15% in excess of that required with sufficient volume to operate (close, open, and re-close) the preventers.
- E. All connections to and from preventers to have a pressure rating equivalent to that of the BOP's.
- F. Manual controls to be installed before drilling cement plug.
- G. Valve to control flow through drill pipe to be located on rig floor.
- H. Choke may be either positive or adjustable. Choke spool may be used between rams.