

District I  
PO Box 1980, Hobbs, NM 88241-1980  
District II  
811 S. 1st Street, Artesia, NM 88210-2834  
District III  
1000 Rio Brazos Rd., Aztec, NM 87410  
District IV  
2040 South Pacheco, Santa Fe, NM 87505

State of New Mexico  
Energy, Minerals & Natural Resources Department

OIL CONSERVATION DIVISION  
2040 South Pacheco  
Santa Fe, NM 87505

517  
Form C-102  
Revised October 18, 1994  
Instructions on back  
Submit to Appropriate District Office  
State Lease - 4 Copies  
Fee Lease - 3 Copies

RECEIVED  
OCD ARTESIA

AMENDED REPORT

WELL LOCATION AND ACREAGE DEDICATION PLAT

<sup>1</sup> API Number 30-015-29307	<sup>2</sup> Pool Code 84330	<sup>3</sup> Pool Name ROSS DRAW WOLFCAMP (GAS)
<sup>4</sup> Property Code 14828	<sup>5</sup> Property Name EL PASO 23 FEDERAL	<sup>6</sup> Well Number 2
<sup>7</sup> OGRID No. 26485	<sup>8</sup> Operator Name BURLINGTON RESOURCES OIL & GAS CO.	<sup>9</sup> Elevation 3101'

<sup>10</sup> Surface Location

UL or lot no.	Section	Township	Range	Lot. Idn	Feet from the	North/South Line	Feet from the	East/West line	County
B	23	26S	30E		1120	NORTH	2630	EAST	EDDY

<sup>11</sup> Bottom Hole Location If Different From Surface

UL or lot no.	Section	Township	Range	Lot. Idn	Feet from the	North/South Line	Feet from the	East/West line	County
D	23	26S	30E		330	NORTH	1150	WEST	EDDY

<sup>12</sup> Dedicated Acres 320	<sup>13</sup> Joint or Infill	<sup>14</sup> Consolidation Code	<sup>15</sup> Order No.
--------------------------------------	-------------------------------	----------------------------------	-------------------------

NO ALLOWABLE WILL BE ASSIGNED TO THIS COMPLETION UNTIL ALL INTERESTS HAVE BEEN CONSOLIDATED  
NON-STANDARD UNIT HAS BEEN APPROVED BY THE DIVISION

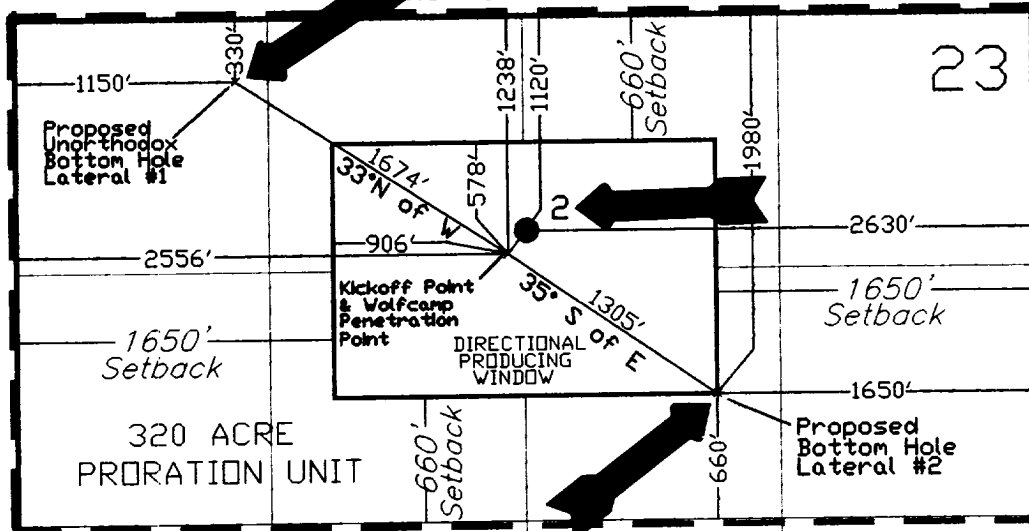

☐ DIRECTIONAL PRODUCING WINDOW  
☐ MINIMUM SETBACK DISTANCE

<sup>17</sup> OPERATOR CERTIFICATION

I hereby certify that the information contained herein is true and complete to the best of my knowledge and belief.

*Maria L. Perez*  
Signature

MARIA L. PEREZ  
Printed Name

REGULATORY REPRESENTATIVE  
Title

2-4-97  
Date

<sup>18</sup> SURVEYOR CERTIFICATION

I hereby certify that the well location shown on this plat was plotted from field notes of actual surveys made by me or under my supervision, and that the same is true and correct to the best of my belief.

Date of Survey

Signature and Seal of Professional Surveyer:

Certificate Number

Proposed dual lateral well in a 320 acre proration unit and Directional Producing Window w/setback requirements from outer boundary of a standard Wolfcamp formation gas proration unit. One lateral is approximately 1700' to the northwest and the other is approximately 1300' to the southeast from the surface location.

Lateral #1 is a proposed unorthodox bottom hole location. Lateral #2 is within the orthodox producing window as prescribed by Statewide Rule 104.C(2)(b) & Statewide Rule 111.A(8) for Directional Wells.