

DISTRICT I  
P. O. Box 1980  
Hobbs, NM 88241-1980

State of New Mexico  
Energy, Minerals, and Natural Resources Department

Form C-102  
Revised 02-10-94  
Instructions on back

DISTRICT II  
P. O. Drawer DD  
Artesia, NM 88211-0719

## OIL CONSERVATION DIVISION

P. O. Box 2088  
Santa Fe, New Mexico 87504-2088

Submit to the Appropriate  
District Office  
State Lease - 4 copies  
Fee Lease - 3 copies

☐ AMENDED REPORT

DISTRICT III  
1000 Rio Brazos Rd.  
Aztec, NM 87410

DISTRICT IV  
P. O. Box 2088  
Santa Fe, NM 87507-2088

### WELL LOCATION AND ACREAGE DEDICATION PLAT

1 API Number		2 Pool Code 84330		3 Pool Name CORRAL DRAW WOLFCAMP GAS					
4 Property Code		5 Property Name CORRAL DRAW 9 FEDERAL						6 Well Number 1	
7 OGRID No. 26485		8 Operator Name BURLINGTON RESOURCES OIL & GAS COMPANY						9 Elevation 2941'	
10 SURFACE LOCATION									
UL or lot no. C	Section 9	Township 25 SOUTH	Range 29 EAST, N.M.P.M.	Lot Ida	Feet from the 860'	North/South line NORTH	Feet from the 1650'	East/West line WEST	County EDDY
11 BOTTOM HOLE LOCATION IF DIFFERENT FROM SURFACE									
UL or lot no. G	Section 9	Township 25S	Range 29E	Lot Ida	Feet from the 1980	North/South line North	Feet from the 1650	East/West line East	County Eddy
12 Dedicated Acres 320		13 Joint or Infill		14 Consolidation Code		15 Order No.			

NO ALLOWABLE WELL BE ASSIGNED TO THIS COMPLETION UNTIL ALL INTERESTS HAVE BEEN CONSOLIDATED OR A NON-STANDARD UNIT HAS BEEN APPROVED BY THE DIVISION

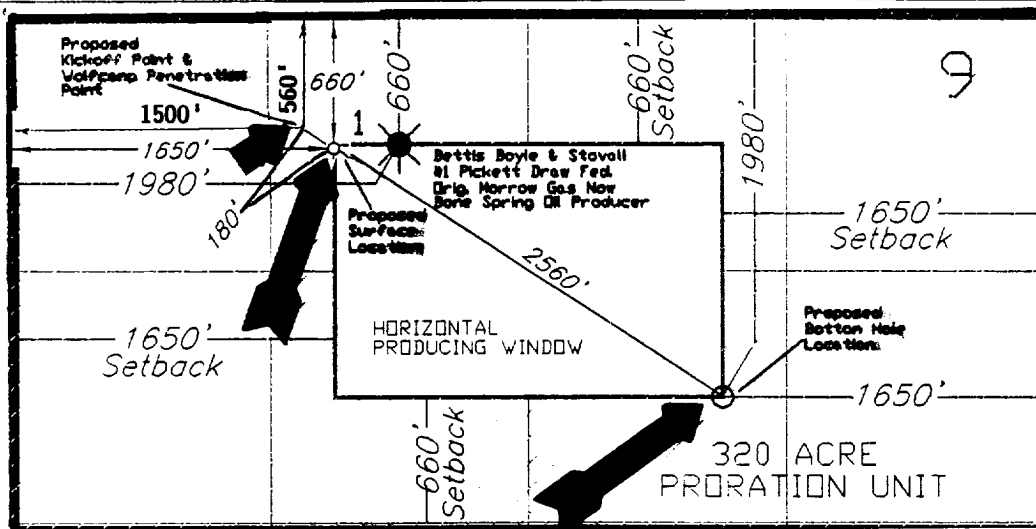

☐ HORIZONTAL PRODUCING WINDOW FOR ORTHODOX LATERAL

☐ MINIMUM SETBACK DISTANCE

#### OPERATOR CERTIFICATION

I hereby certify that the information contained herein is true and complete to the best of my knowledge and belief.

Signature

Printed Name

Maria L. Perez

Title

Regulatory Representative

Date

2-12-98

#### SURVEYOR CERTIFICATION

I hereby certify that the well location shown on this plat was plotted from field notes of actual surveys made by me or under my supervision, and that the same is true and correct to the best of my belief.

Date of Survey

JANUARY 28, 1998

Signature and Seal of Professional Surveyor

Certificate No. 12123  
ROGER M. ROBBINS, P.S. #12128

JOB #56458 / 23 NW / JSJ