

DECLARED WATER BASIN
CEMENT BEHIND THE 13-1/2" WITNESS
CASING MUST BE CIRCULATED

Form 3160-3
(August 1999)

UNITED STATES
DEPARTMENT OF THE INTERIOR
BUREAU OF LAND MANAGEMENT

APPLICATION FOR PERMIT TO DRILL OR REENTER

FORM APPROVED
OMB No. 1004-0136
Expires November 30, 2000

5. Lease Serial No.
NM91507 (and ~~NM85853~~)

6. If Indian, Allottee or Tribe Name
N/A

7. If Unit or CA Agreement, Name and No.
N/A 28594

8. Lease Name and Well No.
Wild Hog 11 Federal #1

9. API Well No.
30-015-31745

10. Field and Pool or Exploratory
Wildcat McNew

11. Sec., T., R., M., or Blk. and Survey or Area
Section 11, T-25-S, R-25-E

1a. Type of Work: ☒ DRILL ☐ REENTER

1b. Type of Well: ☐ Oil Well ☒ Gas Well ☐ Other ☐ Single Zone ☒ Multiple Zone

2. Name of Operator
Cabal Energy Corporation 194930

3a. Address 201 W. Wall, Suite 600
Midland, Texas 79701

3b. Phone No. (include area code)
915-682-0440

4. Location of Well (Report location clearly and in accordance with any State requirements. *)
At surface 1980' FWL & 990' FSL
At proposed prod. zone Same

14. Distance in miles and direction from nearest town or post office*
2 miles South of White City

12. County or Parish
Eddy

13. State
New Mexico

15. Distance from proposed*
location to nearest 990' FSL
property or lease line, ft.
(Also to nearest drig. unit line, if any)

16. No. of Acres in lease
NM91507 (480 Acres)
NM85853 (240 Acres)

17. Spacing Unit dedicated to this well
320 Acres (S/2 of Section 11)

18. Distance from proposed location*
to nearest well, drilling, completed,
applied for, on this lease, ft.

19. Proposed Depth
12,700'

20. BLM/BIA Bond No. on file
NM 2860

21. Elevations (Show whether DF, KDB, RT, GL, etc.)
GL 3471'

22. Approximate date work will start*
9-20-01

23. Estimated duration
60 days

24. Attachments

Carlsbad Controlled Water Basin

The following, completed in accordance with the requirements of Onshore Oil and Gas Order No.1, shall be attached to this form:

1. Well plat certified by a registered surveyor.
2. A Drilling Plan.
3. A Surface Use Plan (if the location is on National Forest System Lands, the SUPO shall be filed with the appropriate Forest Service Office).

4. Bond to cover the operations unless covered by an existing bond on file (see Item 20 above).
5. Operator certification.
6. Such other site specific information and/or plans as may be required by the authorized officer.

25. Signature Randell K. Ford

Name (Printed/Typed)

Randell K. Ford

Date

6-12-01

Title
President

Approved by (Signature) /s/ LESLIE A. THEISS

Name (Printed/Typed)

/s/ LESLIE A. THEISS

Date

AUG 09 2001

Title
FIELD MANAGER

Office

CARLSBAD FIELD OFFICE

Application approval does not warrant or certify the the applicant holds legal or equitable title to those rights in the land to which the applicant to conduct operations thereon.

Conditions of approval, if any, are attached.

APPROVAL FOR 1 YEAR

APPROVAL SUBJECT TO
GENERAL REQUIREMENTS AND
SPECIAL STIPULATIONS
ATTACHED

Title 18 U.S.C. Section 1001 and Title 43 U.S.C. Section 1212, make it a crime for any person knowingly and willfully to make to any department or agency of the United States any false, fictitious or fraudulent statements or representations as to any matter within its jurisdiction.

*(Instructions on reverse)

NM 91507 covers W/2, N/2NE/4, SW/4NE/4, NW/4SE/4 Section 11, T-25-S, R-25-E (480 acres)
NM 85853 covers S/2SE/4, NE/4SE/4, SE/4NE/4 Section 11, T-25-S, R-25-E (160 acres)
W/2SW/4 of Section 12, T-25-S, R-25-E (80 acres)

The well is actually being drilled in the SW/4 (Unit N) of Section 11, T-25-S, R-25-E.
However, the proration unit (S/2 of Section 11) involves both leases. (See Exhibit E
of the Surface Use and Operations Plan for Drilling, Completion, and Producing.

DISTRICT I
P.O. Box 1980, Hobbs, NM 88241-1980

Energy, Minerals and Natural Resources Department

Form C-102
Revised February 10, 1994
Submit to Appropriate District Office
State Lease - 4 Copies
Fee Lease - 3 Copies

DISTRICT II
P.O. Drawer DD, Artesia, NM 88211-0719

OIL CONSERVATION DIVISION
P.O. Box 2088
Santa Fe, New Mexico 87504-2088

DISTRICT III
1000 Rio Brazos Rd., Aztec, NM 87410

DISTRICT IV
P.O. BOX 2088, SANTA FE, N.M. 87504-2088

WELL LOCATION AND ACREAGE DEDICATION PLAT

☐ AMENDED REPORT

| | | | |
|---------------------|--|-----------|--------------------|
| API Number | | Pool Code | Pool Name |
| Property Code | Property Name WILD HOG II FEDERAL | | Well Number 1 |
| OGRID No. 194930 | Operator Name CABAL ENERGY CORPORATION | | Elevation 3471' |

Surface Location

| UL or lot No. | Section | Township | Range | Lot Idn | Feet from the | North/South line | Feet from the | East/West line | County |
|---------------|---------|----------|-------|---------|---------------|------------------|---------------|----------------|--------|
| N | 11 | 25-S | 25-E | | 990 | SOUTH | 1980 | WEST | EDDY |

Bottom Hole Location If Different From Surface

| UL or lot No. | Section | Township | Range | Lot Idn | Feet from the | North/South line | Feet from the | East/West line | County |
|---------------|---------|----------|-------|---------|---------------|------------------|---------------|----------------|--------|
| | | | | | | | | | |

| | | | |
|-------------------------|-----------------|--------------------|-----------|
| Dedicated Acres 32.0 | Joint or Infill | Consolidation Code | Order No. |
|-------------------------|-----------------|--------------------|-----------|

**NO ALLOWABLE WILL BE ASSIGNED TO THIS COMPLETION UNTIL ALL INTERESTS HAVE BEEN CONSOLIDATED
OR A NON-STANDARD UNIT HAS BEEN APPROVED BY THE DIVISION**

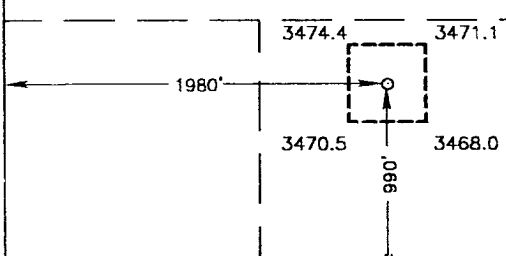
| | |
|--|--|
| <p>SPC NME NAD 1927 N=414552 E=489184</p>  | <p>OPERATOR CERTIFICATION</p> <p>I hereby certify the the information contained herein is true and complete to the best of my knowledge and belief.</p> <p><i>Randall K Ford</i> Signature</p> <p>Randell K. Ford Printed Name</p> <p>President Title</p> <p>June 12, 2001 Date</p> |
| | <p>SURVEYOR CERTIFICATION</p> <p>I hereby certify that the well location shown on this plat was plotted from field notes of actual surveys made by me or under my supervision, and that the same is true and correct to the best of my belief.</p> <p>JANUARY 27, 2001 Date Surveyed</p> <p>AWB Signature & Seal of Professional Surveyor</p> <p><i>Ronald J. Eidson</i> 01/30/01 01-11-0123</p> <p>Certificate No. RONALD J. EIDSON 3239 GARY EIDSON 12641</p> |



NOTICE OF STAKING



| | | | |
|--|---|---|---------------------------------|
| NOTICE OF STAKING Not to be used in place of Application for Permit to Drill (Form 3160-3) | | 6. Lease Number Lease #91507 | |
| 1. Oil Well _____ Gas Well <u>X</u> Other (Specify) _____ | | 7. If Indian, Allottee or Tribe Name N/A | |
| 2. Name of Operator: Cabal Energy Corporation | | 8. Unit Agreement Name N/A | |
| 3. Name of Specific Contact Person: Randell K. Ford | | 9. Farm or Lease Name Wild Hog 11 Fed | |
| 4. Address & Phone No. of Operator or Agent 915-682-0440 201 W. Wall, Suite 600, Midland, TX 79701 | | 10. Well No. #1 | |
| 5. Surface Location of Well 1980' FWL & 9901 FSL | | 11. Field or Wildcat Name Wildcat | |
| Attach: a) Sketch showing road entry onto pad, pad dimensions, and reserve pit. b) Topographical or other acceptable map showing location, access road, and lease boundaries. | | 12. Sec., T., R., M., or Blk and Survey or Area Sec. 11, T-25-S, R-25-E | |
| 15. Formation Objective(s) Morrow | 16. Estimated Well Depth 12,200 | 13. County, Parish, or Borough Eddy County | 14. State' New Mexico |
| 17. Additional Information (as appropriate; shall include surface owner's name, address and, if known, telephone number) BUREAU OF LAND MANAGEMENT | | | |

18. Signed Randell K Ford Title President Date 4-25-01

Note: Upon receipt of this Notice, the Bureau of Land Management (BLM) will schedule the date of the onsite predrill inspection and notify you accordingly. The location must be staked and access road must be flagged prior to the onsite.

Operators must consider the following prior to the onsite:

- a) H₂S Potential
- b) Cultural Resources (Archeology)
- c) Federal Right of Way or Special Use Permit

**SURFACE USE AND OPERATIONS PLAN FOR
DRILLING, COMPLETION, AND PRODUCING**

**CABAL ENERGY CORPORATION
Wild Hog 11 Federal #1
990' FSL & 1980' FWL
Section 11, T-25-S, R-25-E
Eddy County, New Mexico**

LOCATED:

2 Miles South of White City

OIL & GAS LEASE:

NM 91507 W/2, N/2NE/4, SW/4NE/4, NW/4SE/4 Section 11, T-25-S, R-25-E (480 acres)

NM 85853 S/2SE/4, NE/4SE/4, SE/4NE/4 Section 11, T-25-S, R-25-E (160 acres)
W/2SW/4 of Section 12, T-25-S, R-25-E (80 acres)

*Note: The well is actually being drilled in the SW/4 (Unit N) of Section 11, T-25-S, R-25-E.
However, the proration unit (S/2 of Section 11) involves both leases (See Exhibit E).*

RECORD LESSEE:

Cabal Energy Corporation
201 W. Wall, Suite 600
Midland, Texas 79701

BOND COVERAGE:

\$25,000 Statewide Oil & Gas Surety Bond
BLM Bond #: NM2860

ACRES IN LEASE:

720 Acres in both leases, 320 acre proration unit (See Exhibit E)

GRAZING LEASE:

Jimmy Foster
P. O. Box 105
White City, New Mexico 88268

POOL:

Wildcat

EXHIBITS:

- A. Area Map
- B. Drilling Rig Layout
- C. Vicinity Oil & Gas Map & Area Road Map
- D. Topographic & Location Verification Map
- E. Well Location & Acreage Dedication Plat.

This well will be drilled to a depth of approximately $\pm 12,700'$

1. EXISTING ROADS:

- A. Exhibit "A" is a portion of a section map showing the location of the proposed well as staked.
- B. Exhibit "C" is a plat showing existing roads in the vicinity of the proposed well site.

2. ACCESS ROADS:

- A. Length and Width:
935' x 12' of new road from the West
- B. Surface Material:
Existing
- C. Maximum Grade:
Less than two percent
- D. Turnouts:
None necessary
- E. Drainage Design:
Existing
- F. Culverts:
None necessary
- G. Gates and Cattle Guards:
None necessary

3. LOCATION OF EXISTING WELLS:

Existing wells in the immediate area are shown on Exhibit "C".

4. **LOCATION OF EXISTING AND/OR PROPOSED FACILITIES:**

Necessary production facilities for this well will be located on the well pad.

5. **LOCATION AND TYPE OF WATER SUPPLY:**

It is not contemplated that a water well will be drilled. Water necessary for drilling will be purchased and hauled to the site over existing roads shown on Exhibit "D".

6. **METHODS OF HANDLING WASTE DISPOSAL:**

- A. Drilling fluids will be allowed to evaporate in the drilling pits until the pits are dry.
- B. Water produced during tests will be disposed of in the drilling pits.
- C. Oil Produced during tests will be stored in test tanks.
- D. Trash will be contained in a trash trailer and removed from well site.
- E. All trash and debris will be removed from the well site within 30 days after finishing drilling and/or completion operations.

7. **ANCILLARY FACILITIES:**

None required.

8. **WELL SITE LAYOUT:**

Exhibit "B" shows the relative location and dimensions of the well pad, mud pits, reserve pit, and trash trailer and the location of major rig components. Reserve pit to be lined.

9. **PLANS FOR RESTORATION OF THE SURFACE:**

- A. After completion of drilling and/or completion operations, all equipment and other material not needed for operations will be removed. The well site will be cleaned of trash leaving the site aesthetically pleasing to the extent possible.
- B. After abandonment, all equipment, trash and debris will be removed and the site will be clean.

10. **OTHER INFORMATION:**

A. Topography

The land surface at the well site is rolling native grass with a regional slope to the southeast.

B. Soil:

Topsoil at the well site is loam with rock.

C. Flora and Fauna:

Vegetation is consistent with Chihuahuan Desert scrub, including creosote, catclaw acacia, horse creeper cacti, and various grasses.

D. Ponds and Streams:

There are no ponds, streams, or rivers in the area.

E. Residences and Other Structures:

There are no residences within a mile of the proposed well site.

F. Archaeological, Historical, and Cultural Sites:

None observed in this area.

G. Land Use:

Land is being used for cattle grazing.

H. Surface Ownership:

Bureau of Land Management

11. OPERATOR'S CONSULTANT:

R. K. Ford & Associates
201 West Wall, Suite 600
Midland, Texas 79701
915-682-0440 (Office)
915-682-0441 (Fax)
915-570-7216 (Home)

12. CERTIFICATION:

I hereby certify that I, or persons under my direct supervision, have inspected the proposed drill site and access route; that I am familiar with the conditions which currently exist; that the statements made in this plan are, to the best of my knowledge, true and correct; and that the work associated with the operations proposed herein will be performed by Cabal Energy Corporation and its contractors and subcontractors in conformity with this plan and the terms and conditions under which it is approved.

6-8-2001
Date

Randall K Ford
Randell K. Ford
President

RECEIVED

2001 JUN 19 AM 8:54

RAFFEA, J. AND NGMT
FO WILL OFFICE

SUPPLEMENTAL DRILLING DATA

CABAL ENERGY CORPORATION WILD HOG 11 FEDERAL #1

1. SURFACE FORMATION:

Quaternary

2. ESTIMATED TOPS OF GEOLOGIC MARKERS:

| | |
|---|---------|
| Base Anhydrite – Top Delaware | 1,472' |
| Wolfcamp Pay | 9,384' |
| Strawn | 10,154' |
| Base Middle Morrow Shale | 11,149' |
| Top 14 Zone (Washington Ranch Main Pay) | 11,264' |
| Lower Morrow Shale (Top) | 11,330' |
| Lower Morrow Shale (Base) | 11,399' |

3. ANTICIPATED POSSIBLE HYDROCARBON BEARING ZONES:

Morrow

4. CASING AND CEMENTING PROGRAM:

| Casing Size | Setting Depth From To | Weight | Grade | Joint |
|-------------|---|--------|-------|-------|
| 13-3/8" | 0 – 270' | 48# | H-40 | STC |
| 9-5/8" | 0 – 1,460' | 36# | J-55 | STC |
| 7" | 0 – 8,600' | 26# | S-95 | LTC |
| 4-1/2" | 8,300' – 12,500' 12,700' | 11.6# | S-95 | FJ |

Equivalent or adequate grades and weights of casing may be substituted at time casing is run, depending on availability. Changes will be relayed to BLM prior to running.

Plan to drill a 17-1/2" hole to equal 270'.

13-3/8" casing will be cemented with 200 sx or volume necessary to tie back to surface.

WITNESS

Plan to drill a 12-1/4" hole to about 1,460'.

9-5/8" casing will be cemented with 500 sx or volume necessary to tie back to surface.

Plan to drill a 8-3/4" hole to about 8,600'.

7" protection casing will be cemented with approximately 800 sx of Class "H".

Plan to drill a 6-1/8" hole to about ~~12,500'~~
12,700'

4-1/2" production casing liner will be cemented with 240 sx or volume necessary to the top of the liner from 8,300' – ~~12,500'~~
12,700'

5. PRESSURE CONTROL EQUIPMENT:

The BOP stack will consist of a 3,000 psi working pressure, dual ram type preventer and annular on the 12-1/4" hole portion and 5,000 psi working pressure after setting the 7" protective casing string.

A BOP sketch is attached.

6. CIRCULATING MEDIUM:

Surface to ^{12700'}~~12500'~~

Spud and drill to 270' with fresh water mud. Drill to 1,460' using 10 ppg brine. Drill to 8,600' using fresh water and cut brine. Drill to 12,500' using brine/polymer system.

7. AUXILIARY EQUIPMENT:

None required.

8. TESTING, LOGGING AND CORING PROGRAM:

Electric logging is planned. Drill stem tests and sidewall cores possible.

9. ABNORMAL PRESSURES, TEMPERATURES OR HYDROGEN SULFIDE GAS:

Possible abnormal pressure in the Wolfcamp & Atoka zones.

10. ANTICIPATED STARTING DATE:

It is planned that operations will commence on August 1, 2000, with drilling and completion operations lasting about 60 days.

HYDROGEN SULFIDE DRILLING OPERATIONS PLAN

CABAL ENERGY CORPORATION
Wild Hog 11 Federal #1

I. HYDROGEN SULFIDE TRAINING

A. All regularly assigned personnel, contracted or employed by Cabal Energy Corporation, will receive training from a qualified instructor in the following areas prior to commencing drilling potential hydrogen sulfide bearing formations in this well:

1. The hazards and characteristics of hydrogen sulfide (H₂S).
2. The proper use and maintenance of personal protective equipment and life support systems.

3. The proper use of H₂S detectors, alarms, warning systems, briefing areas, evacuation procedures and prevailing winds.
 4. The proper techniques for first aid and rescue procedures.
- B.** In addition, supervisory personnel will be trained in the following areas:
1. The effects of H₂S on metal components. If high tensile tubulars are to be used, personnel will be trained in their special maintenance requirements.
 2. Corrective action and shut-in procedures when drilling or reworking a well and blowout prevention and well control procedures.
 3. The contents and requirements of the H₂S Drilling Operations Plan.
- C.** There will be an initial training session just prior to encountering a known or probable H₂S zone (within 3 days or 500 feet) and weekly H₂S and well control drills for all personnel in each crew. The initial training session shall include a review of the site specific H₂S Drilling Operations Plan. This plan shall be available at the well site. All personnel will be required to carry documentation that they have received the proper training.

II. H₂S SAFETY EQUIPMENT AND SYSTEMS

Note: All H₂S safety equipment and systems will be installed, tested and operational when drilling reaches a depth of 500 feet above, or three days prior to penetrating the first zone containing or reasonably expected to contain H₂S.

- A.** Well Control Equipment.
1. Flare line with continuous pilot.
 2. Choke manifold with a minimum of one remote choke.
 3. Blind rams and pipe rams to accommodate all pipe sizes with properly sized closing unit.
 4. Auxiliary equipment to include: annular preventer, mud-gas separator, rotating head and flare.
- B.** Protective Equipment for Essential Personnel:
- Mark II Surviveair 30-minute units located in the dog house and at briefing areas, as indicated on well site diagram.
- C.** H₂S Detection and Monitoring Equipment:
1. Two portable H₂S monitors positioned on location for best coverage and response. These units have warning lights and audible sirens when H₂S levels of 20 ppm are reached.
 2. One portable SO₂ monitor positioned near flare line.

D. Visual Warning Systems

1. Wind direction indicators are shown on well site diagram.
2. Caution/Danger signs shall be posted on roads providing direct access to location. Signs will be painted a high visibility yellow with black lettering of sufficient size to be readable at a reasonable distance from the immediate location. Bilingual signs will be used when appropriate. See example attached.

E. Mud Program

1. The Mud Program has been designed to minimize the volume of H₂S circulated to the surface. Proper mud weights, safe drilling practices and the use of H₂S scavengers will minimize hazards when penetrating H₂S bearing zones.
2. A mud-gas separator will be utilized as needed.

F. Metallurgy:

All drill strings, casing, tubing, wellhead, blowout preventers, drilling spool, kill lines, choke manifold and line and valves shall be suitable for H₂S service.

G. Communication:

Cellular telephone communications in company vehicles, rig floor and mud logging trailer.

H. Well Testing:

Drill stem testing will be performed with a minimum number of personnel in the immediate vicinity which are necessary to safely and adequately conduct the test. The drill stem testing and an H₂S environment will be conducted during the daylight hours.

Scale 1" = 50'

200'

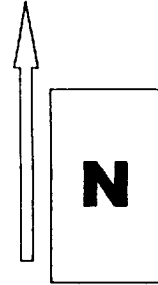

200'

Reserve Pit

DRILLING RIG LAYOUT
Cabal Energy Corporation
Wild Hog 11 Fed #1

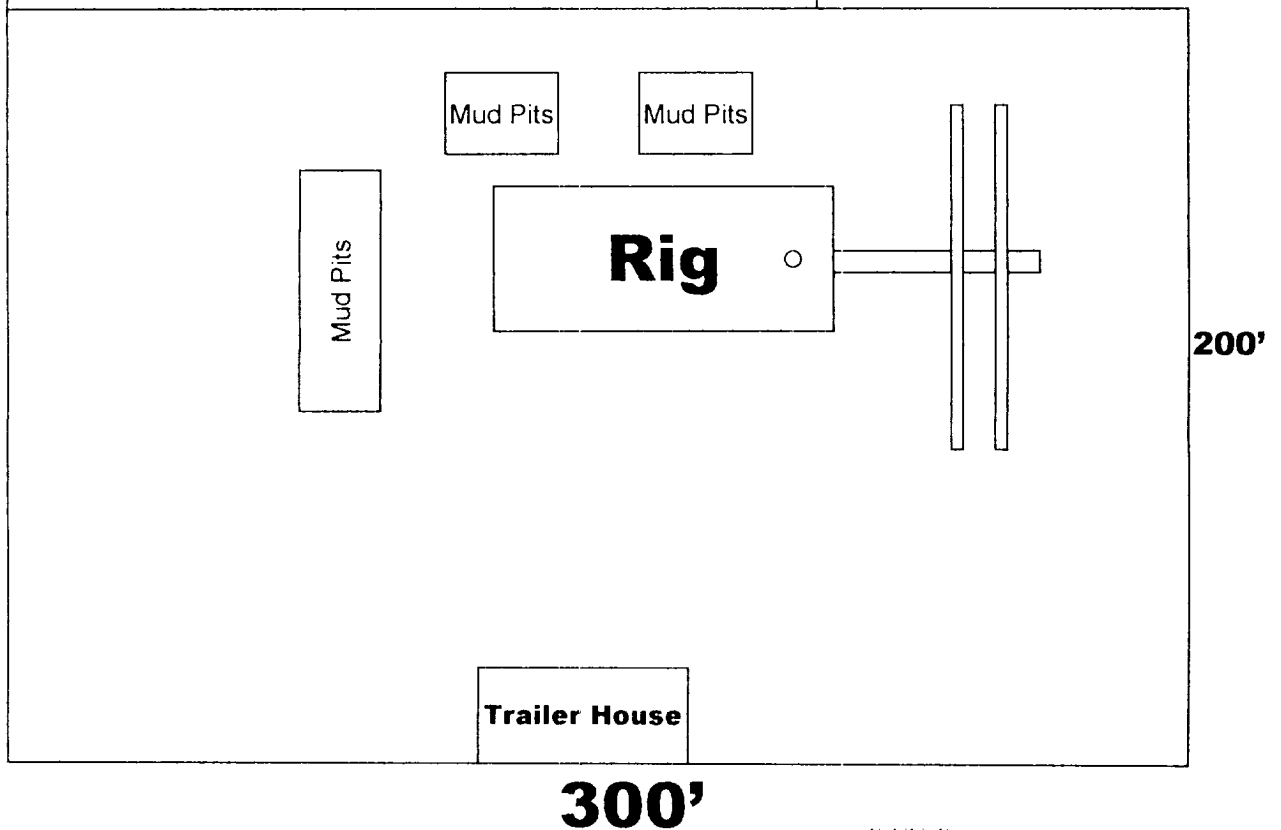

VICINITY MAP

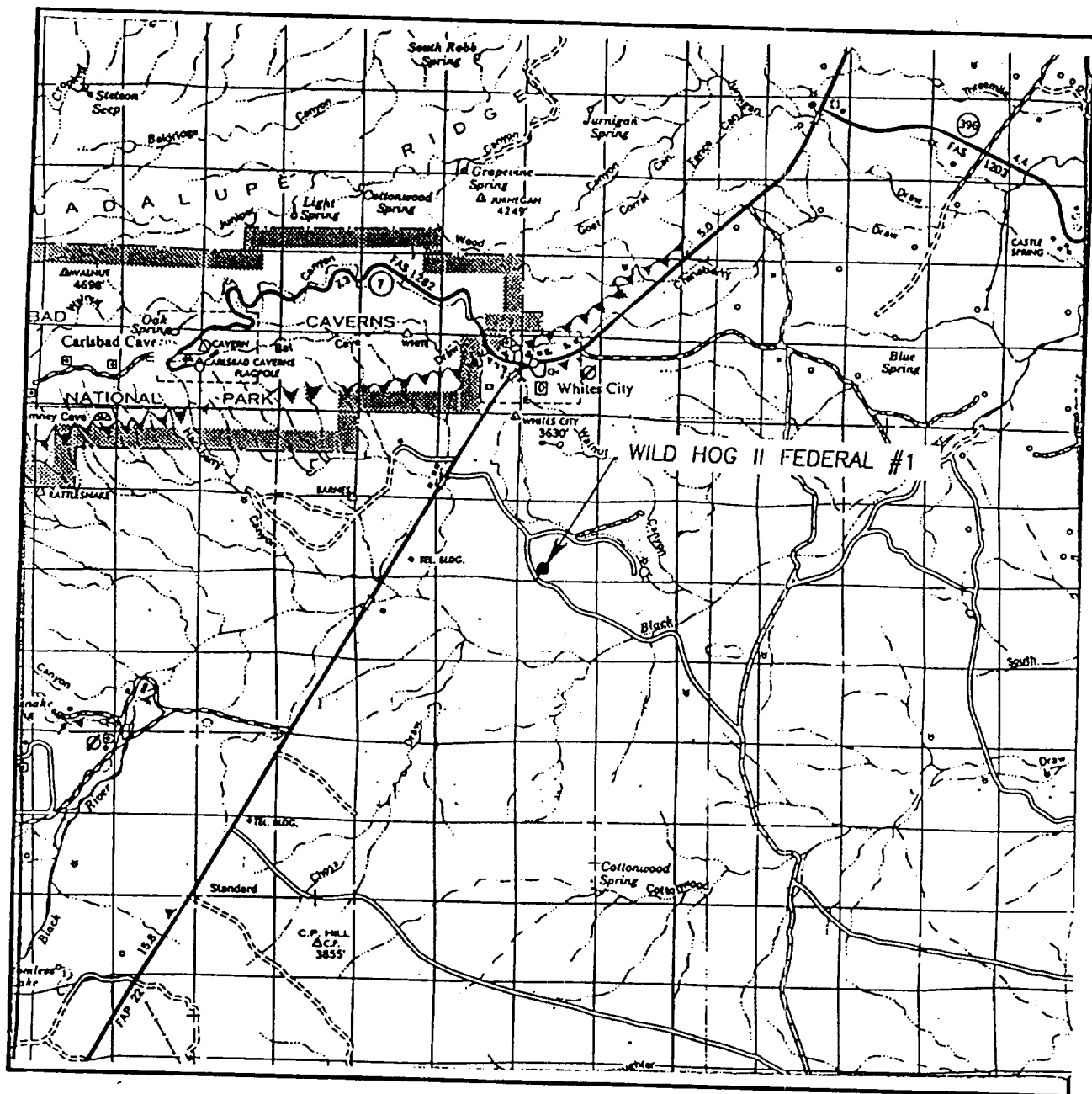

SCALE: 1" = 2 MILES

SEC. 11 TWP. 25-S RGE. 25-E

SURVEY N.M.P.M.

COUNTY EDDY

DESCRIPTION 990' FSL & 1980' FWL

ELEVATION 3471'

OPERATOR CABAL ENERGY CORPORATION

LEASE WILD HOG II FEDERAL

Exhibit C

Surface Use & Operations Plan

JOHN WEST SURVEYING
HOBBS, NEW MEXICO
(505) 393-3117

LOCATION VERIFICATION MAP

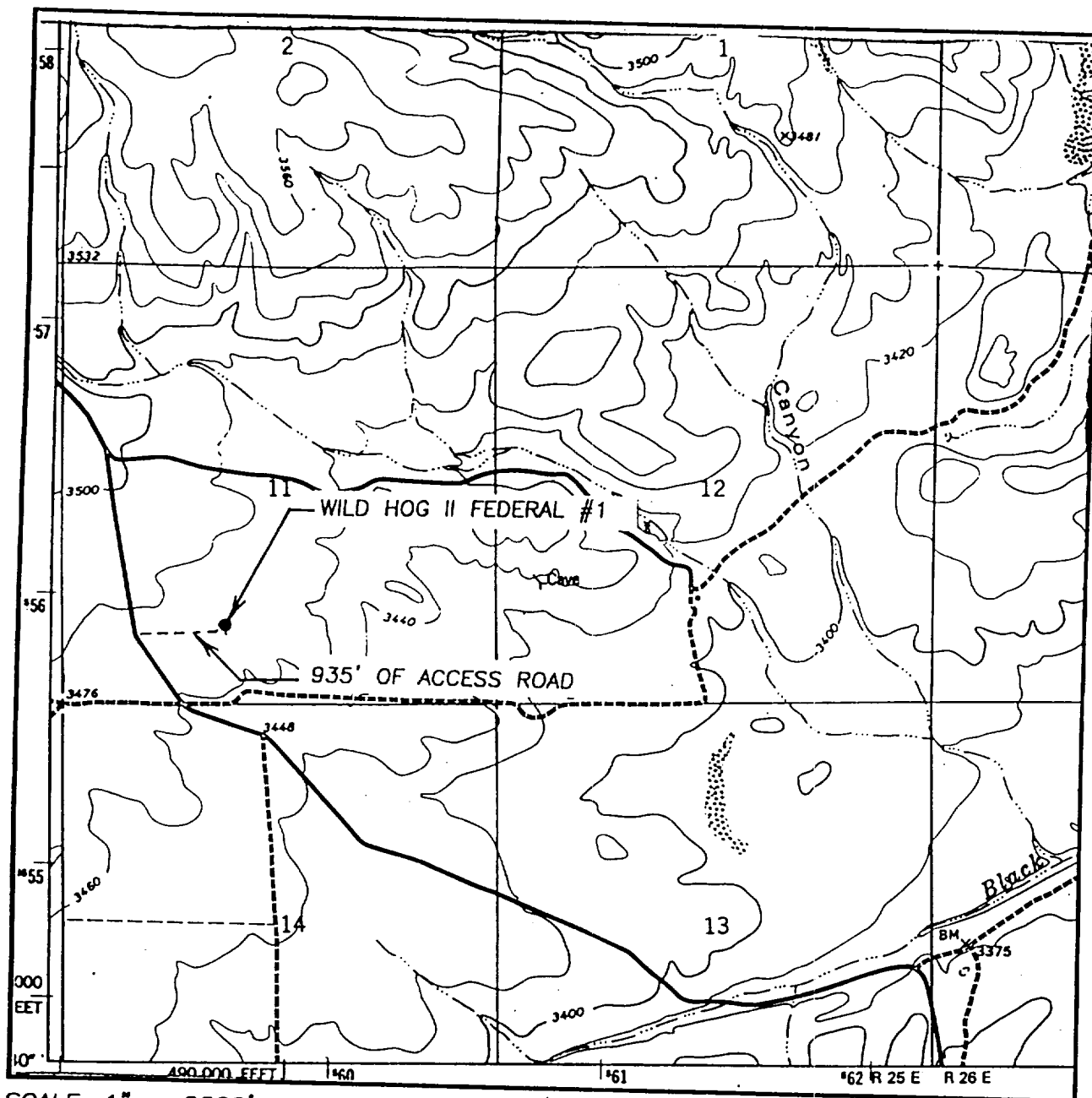

SCALE: 1" = 2000'

CONTOUR INTERVAL: 20'
BLACK RIVER VILLAGE N.M.

SEC. 11 TWP. 25-S RGE. 25-E

SURVEY N.M.P.M.

COUNTY EDDY

DESCRIPTION 990' FSL & 1980' FWL

ELEVATION 3471'

OPERATOR CABAL ENERGY CORPORATION

LEASE WILD HOG II FEDERAL

U.S.G.S. TOPOGRAPHIC MAP
BLACK RIVER VILLAGE N.M.

JOHN WEST SURVEYING
HOBBS, NEW MEXICO
(505) 393-3117

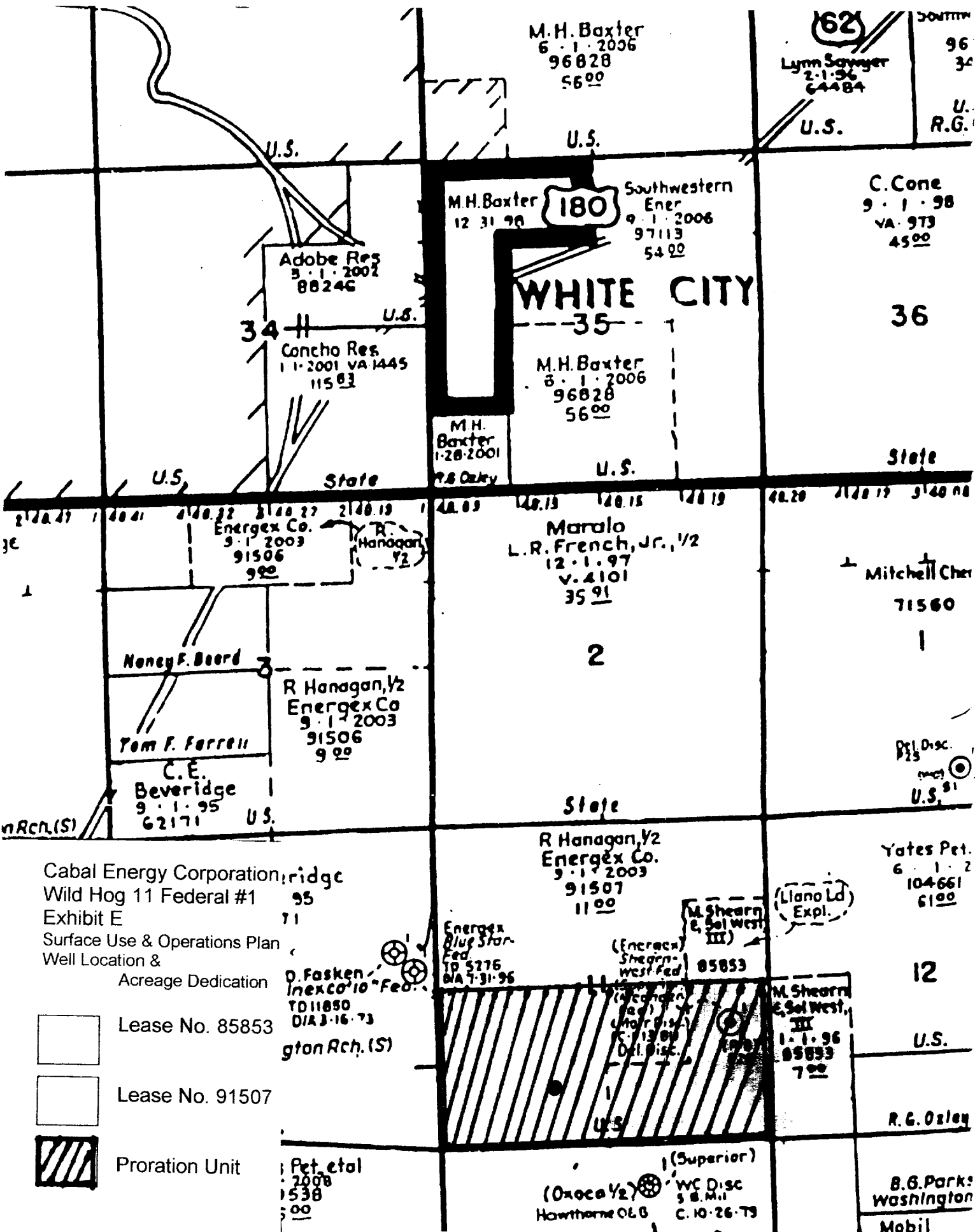

Cabal Energy Corporation, ridge
Wild Hog 11 Federal #1 95
Exhibit E 71
Surface Use & Operations Plan
Well Location &
Acreage Dedication



Lease No. 85853



Lease No. 91507



Proration Unit

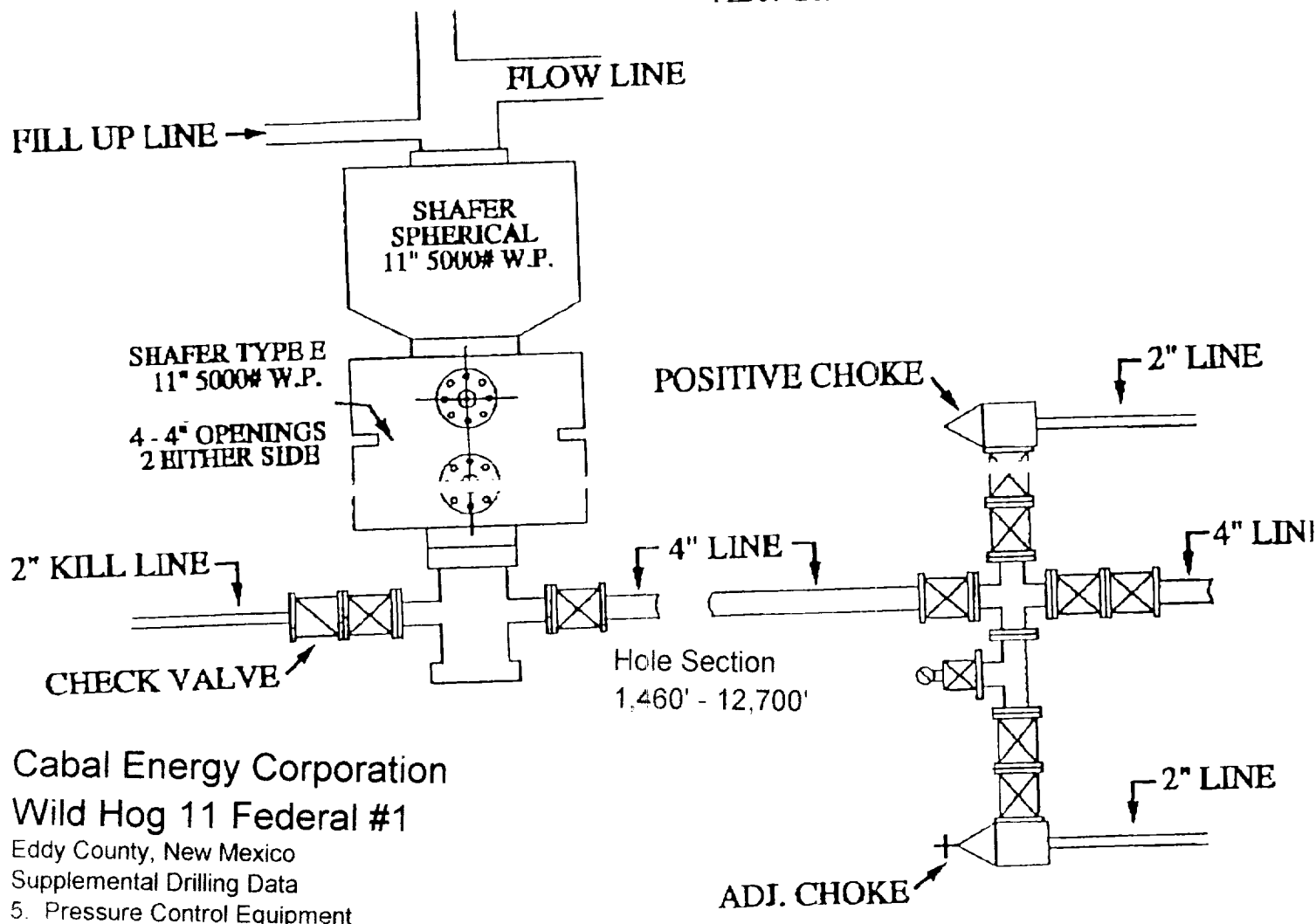
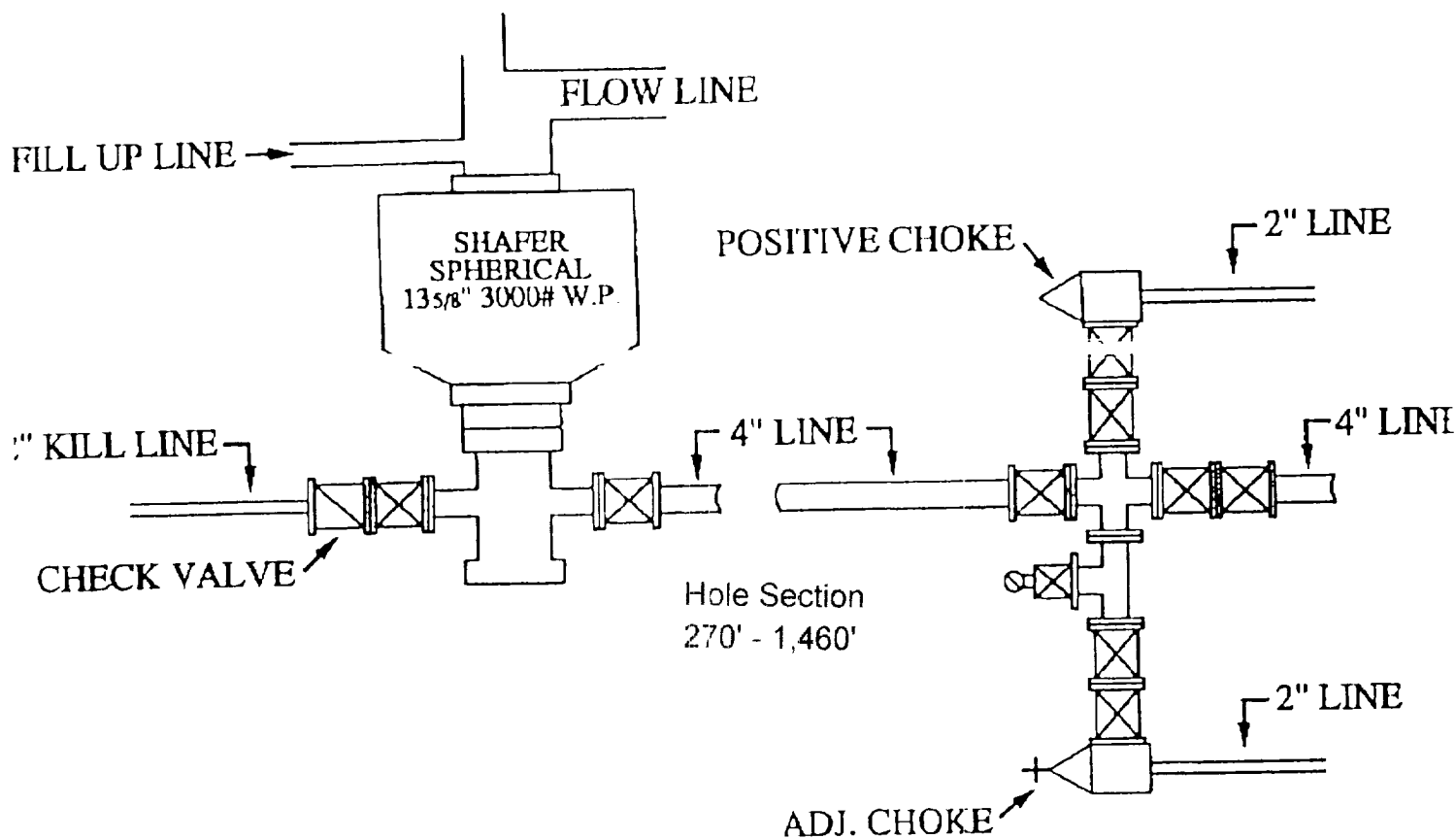

Cabal Energy Corporation

Wild Hog 11 Federal #1

Eddy County, New Mexico

Supplemental Drilling Data

5. Pressure Control Equipment

United States Department of the Interior
Bureau of Land Management
Roswell Field Office
2909 Second Street
Roswell, New Mexico 88201-1287

Statement Accepting Responsibility for Operations

Operator Name: Cabal Energy Corporation
Street or Box: 201 W. Wall, Suite 600
City, State: Midland, Texas
Zip Code: 79701

The undersigned accepts all applicable terms, conditions, stipulations, and restrictions concerning operations conducted on the leased land or portion thereof, as described below:

Lease No: NM 91507

Legal Description of Land:

W/2, N/2NE/4, SW/4NE/4, NW/4SE/4 Section 11, T-25-S, R-25-E
Eddy County, New Mexico (480 acres)

Lease No: NM 85853

Legal Description of Land:

S/2SE/4, NE/4SE/4, SE/4NE/4 Section 11, T 25-S, R-25-E
Eddy County, New Mexico (160 acres)

W/2SW/4 Section 12, T-25-S, R-25-E
Eddy County, New Mexico (80 acres)

Bond Coverage:

Statewide Oil and Gas Surety Bond, Cabal Energy Corporation (Principal)

BLM Bond File No.: NM2860



Randell K. Ford
President
June 12, 2001

BLM/CFO

**TITLE PAGE/ABSTRACT/
NEGATIVE SITE REPORT
CARLSBAD FIELD OFFICE**

| | | |
|--|-------------------------------|--|
| 1. BLM Report No.: | 2. (ACCEPTED) (REJECTED) | 3. NMCRIS No.: 74030 |
| 4. Title of Report (Project Title): Archaeological Survey for the Wild Hog II Federal No. 1 Well Pad and Access Road | | 5. Project Date(s): March 22, 2001 |
| 7. Consultant Name & Address Direct Charge: Sean Simpson Name: Mesa Field Services Address: P.O. Box 3072 Carlsbad, NM 88221-3072 Author's Name: Theresa Straight Field Personnel Names: Sean Simpson Phone: (505) 628-8885 | | 6. Report Date: March 23, 2001 |
| | | 8. Permit No.: 153-2920-00-F |
| 10. Sponsor Name and Address Individual Responsible: Randy Ford Name: R. K. Ford & Associates Address: 201 W. Wall Tower East, Ste. 600 Midland, TX 79701 Phone: (915) 682-0440 | | 9. Consultant Report No.: MFS – 198 |
| | | 11. For BLM use only |
| 12. Acreage Total acres surveyed: 5.82 Per Surface Ownership Federal: 5.82 State: 0 Private: 0 | | 13. Location & Area (maps attached if negative survey) a. State: New Mexico b. County: Eddy c. BLM Field Office: Carlsbad d. Nearest City or town: White's City, New Mexico e. Location: T 25S, R 25E, Section 11: Well Pad: N½ SE¼ SW¼ Access Road: NW¼ SE¼ SW¼, NE¼ SW¼ SW¼ Well Pad Footages: 990 ft from the south line and 1,980 ft from the west line f. 7.5' Map Name(s) and Code Number(s): Black River Village, NM 1979 (32104-B3) g. Area Block: Impact: 400 ft x 400 ft Surveyed: 400 ft x 400 ft Linear: Impact: 935 ft x 35 ft Surveyed: 935 ft x 100 ft |
| | | 14. a. Records Search Location: Carlsbad Field Office and ARMS, via modem Date: March 21, 2001 by Sean Simpson List by LA # all sites within .25 miles of the project (those sites within 500' are to be shown on the project map): No previously recorded sites are located within 0.25 miles of the project area. |

b. Description of Undertaking (client's activities): R. K. Ford & Associates plans on building the Wild Hog II Federal No. 1 well pad and an associated access road. The access road begins at an existing lease road and extends east for 935 ft to the southwest corner of the well pad.

c. Environmental Setting (NRCS soil designation, vegetative community, etc.): The project area is located south of White's City on an undulating plain. Soils are of the Reagon-Upton association. Vegetation is consistent with Chihuahuan Desert scrub, including creosote, catclaw acacia, horse crippler cacti, and various grasses. Visibility was good at the time of the survey, ranging from 75 to 80 percent. The elevation of the project area is 3,470 ft above mean sea level.

d. Field Methods

Transect Intervals: 15 m

Crew Size: 1

Time in Field: 2 hours

Collections: None

15. Cultural Resource Findings: One Isolated Manifestation (IM) was encountered along the proposed access road corridor.

Identification and Description (location shown on project map): IM 1 is a three hinged tobacco tin (Zone 13: E 559306/ N 3555884).

Management Summary (recommendations): Because no significant cultural material was encountered, archaeological clearance for the proposed pipeline is recommended as presently staked. If any cultural material is observed during construction, a qualified archaeologist from the BLM-CFO and Historic Preservation Division should be notified.

I certify that the information provided above is correct and accurate and meets all appreciable BLM standards.

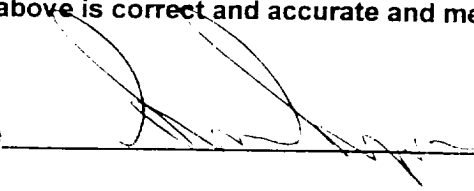
Responsible Archaeologist: Signature  Date 3/26/01

THE ABOVE COMPLETES A NEGATIVE REPORT. IF ELIGIBLE OR POTENTIALLY ELIGIBLE PROPERTIES ARE INVOLVED, THEN THE ABOVE WILL BE THE TITLE PAGE AND ABSTRACT FOR A COMPLETE REPORT.

Survey for the Wild Hog II Well Pad and Access Road

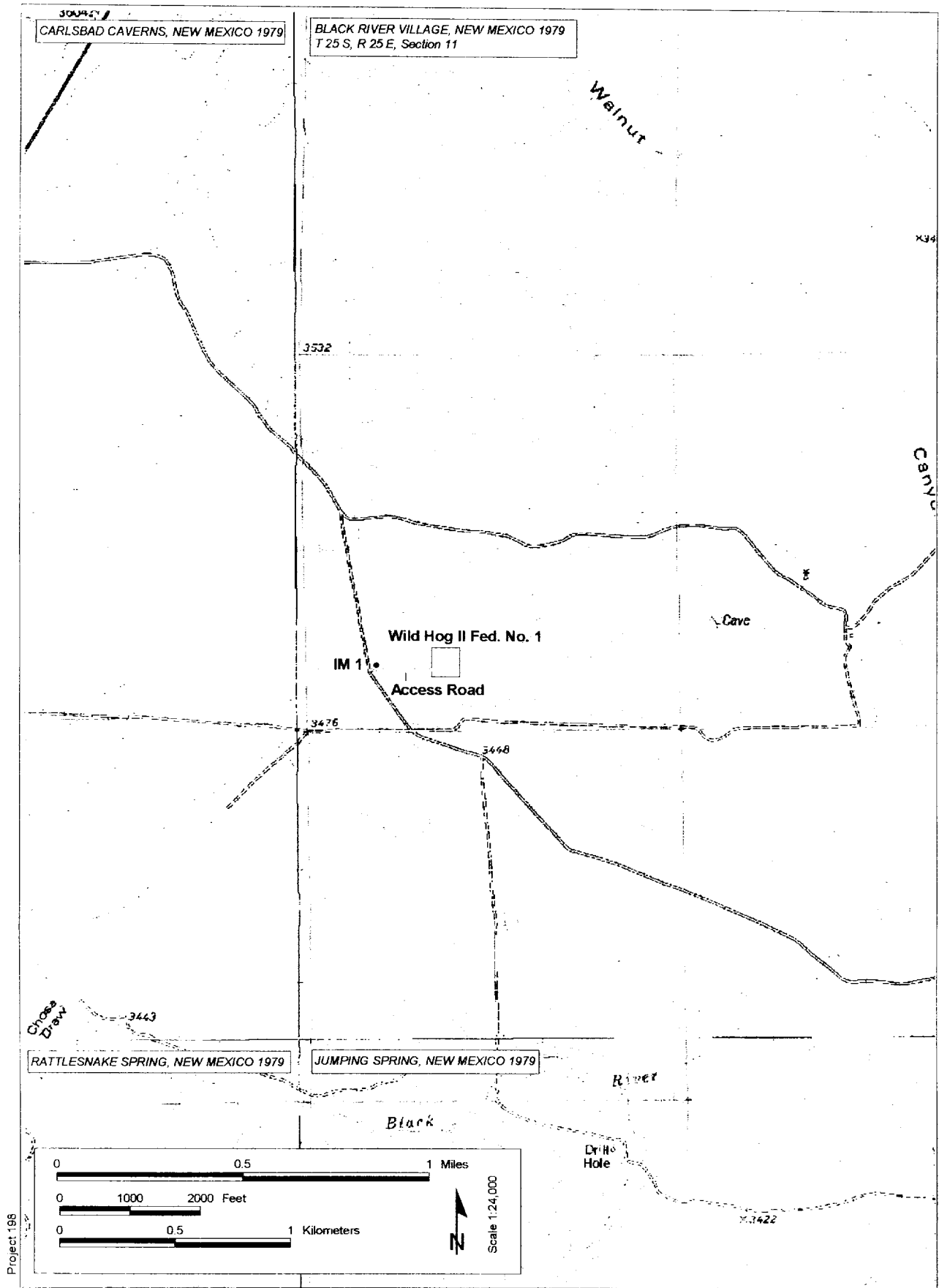

Figure 1. Project Area Map