

NO. OF COPIES RECEIVED	3
DISTRIBUTION	
SANTA FE	1
FILE	1
U.S.G.S.	
LAND OFFICE	
OPERATOR	1

NEW MEXICO OIL CONSERVATION COMMISSION

JAN 27 1982

O. C. D.
ARTESIA, CHIC

Form C-101
Revised 1-1-81

3. Indicate Type of Lease
STATE ☐ FEDERAL ☒

5. Line Oil & Gas Lease No.

APPLICATION FOR PERMIT TO DRILL, DEEPEN, OR PLUG BACK

1a. Type of Work DRILL <input checked="" type="checkbox"/> DEEPEN <input type="checkbox"/> PLUG BACK <input type="checkbox"/>		7. Unit Agreement Name
b. Type of Well OIL WELL <input type="checkbox"/> GAS WELL <input type="checkbox"/> Stratigraphic Test Hole <input type="checkbox"/> SINGLE ZONE <input type="checkbox"/> MULTIPLE ZONE <input type="checkbox"/>		8. Farm or Lease Name Cibola
c. Name of Operator Cibola Energy Corporation		9. Well No. 12-D
d. Address of Operator P.O. Box 1668, Albuquerque, New Mexico 87103		10. Field and Pool, or Acreage N/A
e. Location of Well UNIT LETTER D LOCATED 660 FEET FROM THE North LINE AND 660 FEET FROM THE West LINE OF SEC. 17 TWP. 9S RGE. 28E NMPM		11. County Chaves
18. Proposed Depth		19. Formation
20. Rotary or C.T.		Rotary
21. Elevation (feet, whether Dr, H, etc.)	21A. Kind & Status Plug Bond Statewide	21B. Drilling Contractor Harry Bevers
22. Approx. Date Work will start 1-27-82		

23. PROPOSED CASING AND CEMENT PROGRAM					
SIZE OF HOLE	SIZE OF CASING	WEIGHT PER FOOT	SETTING DEPTH	SACKS OF CEMENT	EST. TOP
4 1/2"	N/A	N/A	N/A	N/A	N/A

We plan to drill a 4 1/2" hole 20' into Yates formation. A Gamma Ray log will be run to determine the top of the Yates. A suitable cement plug will be pumped into the hole to plug from TD to the top of the water zone. Location will be cleaned and marker set.

THIS WELL IS BEING DRILLED AS A STRATIGRAPHIC TEST-HOLE FOR GEOLOGICAL INFORMATION ONLY AND UNDER NO CIRCUMSTANCES WILL IT BE PRODUCED.

IN ABOVE SPACE DESCRIBE PROPOSED PROGRAM: IF PROPOSAL IS TO DEEPEN OR PLUG BACK, GIVE DATA ON PRESENT PRODUCTIVE ZONE AND PROPOSED NEW PRODUCTIVE ZONE. GIVE BLOWOUT PREVENTER PROGRAM, IF ANY.

I hereby certify that the information above is true and complete to the best of my knowledge and belief.

Signed Ernie Vigil Title Drilling Secretary Date 1-25-82
(This space for State Use)

APPROVED BY Mike Williams TITLE OIL AND GAS INSPECTOR DATE JAN 29 1982
CONDITIONS OF APPROVAL, IF ANY:

NEW MEXICO OIL CONSERVATION COMMISSION
WELL LOCATION AND ACREAGE DEDICATION PLAT RECEIVED

Form C-102
Supersedes C-128
Effective 1-1-65

All distances must be from the outer boundaries of the Section.

Operator Cibola Energy		Lease Cibola Strat Test		MAR - 1 1982		Well No. Cibola 12-D
Unit Letter D	Section 17	Township 9 South	Range 28 East	County Chaves	ARTESIA, NEW MEXICO	
Actual Postage Location of Well:						
660 feet from the north line and		660 feet from the west line				
Ground Level Elev. 3889.0	Predicting Formation		Pool	Dedicated Acreage: Acres		

1. Outline the acreage dedicated to the subject well by colored pencil or hachure marks on the plat below.
2. If more than one lease is dedicated to the well, outline each and identify the ownership thereof (both as to working interest and royalty).
3. If more than one lease of different ownership is dedicated to the well, have the interests of all owners been consolidated by communitization, unitization, force-pooling, etc?

☐ Yes ☐ No If answer is "yes," type of consolidation _____

If answer is "no," list the owners and tract descriptions which have actually been consolidated. (Use reverse side of this form if necessary.) _____

No allowable will be assigned to the well until all interests have been consolidated (by communitization, unitization, forced-pooling, or otherwise) or until a non-standard unit, eliminating such interests, has been approved by the Commission.

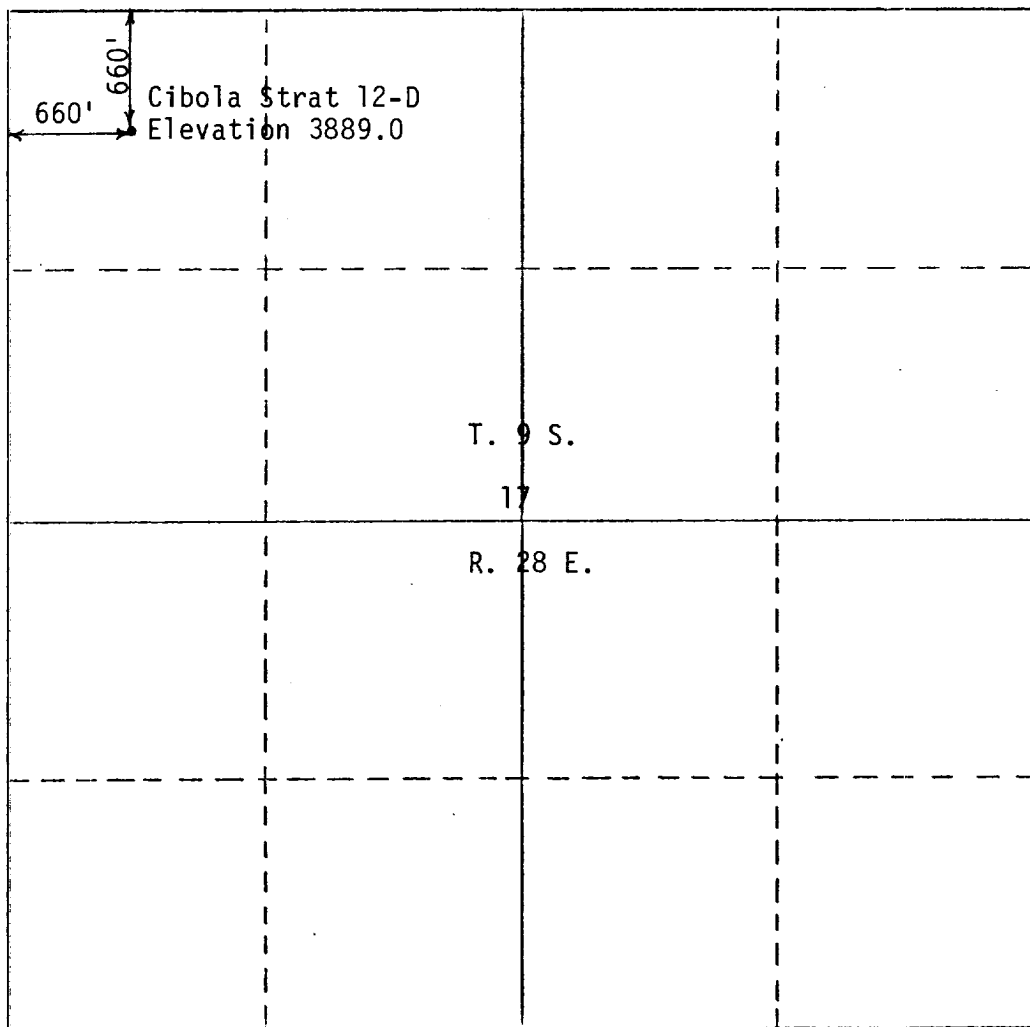

CERTIFICATION

I hereby certify that the information contained herein is true and complete to the best of my knowledge and belief.

Name
R. B. Wright
Position
Agent
Company
Cibola Energy Corp.
Date
2/26/82

I hereby certify that the well location shown on this plat was plotted from field notes of actual surveys made by me or under my supervision, and that the same is true and correct to the best of my knowledge and belief.

Date Surveyed
2/26/82
Registered Professional Engineer and/or Land Surveyor
Richard B. Wright
Certificate No.
7929

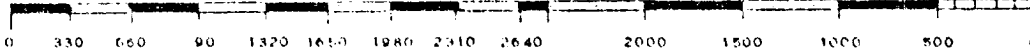
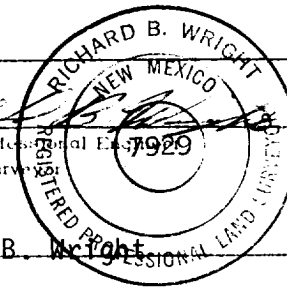

NEW MEXICO OIL CONSERVATION COMMISSION RECEIVED
WELL LOCATION AND ACREAGE DEDICATION PLAT

Form C-102
Supersedes C-128
Effective 1-1-65

MAR - 1 1982

All distances must be from the outer boundaries of the Section.

Operator Cibola Energy			Lease Cibola Strat Test		Well No. Cibola 12-D
Unit Letter D	Section 17	Township 9 South	Range 28 East	County Chaves	
Actual Footage Location of Well: 660 feet from the north line and 660 feet from the west line					
Ground Level Elev. 3889.0	Producing Formation		Dedicated Acreage		

1. Outline the acreage dedicated to the subject well by colored pencil or hachure marks on the plat below.
2. If more than one lease is dedicated to the well, outline each and identify the ownership thereof (both as to working interest and royalty).
3. If more than one lease of different ownership is dedicated to the well, have the interests of all owners been consolidated by communitization, unitization, force-pooling, etc?

☐ Yes ☐ No If answer is "yes," type of consolidation _____

If answer is "no," list the owners and tract descriptions which have actually been consolidated. (Use reverse side of this form if necessary.) _____

No allowable will be assigned to the well until all interests have been consolidated (by communitization, unitization, forced-pooling, or otherwise) or until a non-standard unit, eliminating such interests, has been approved by the Commission.

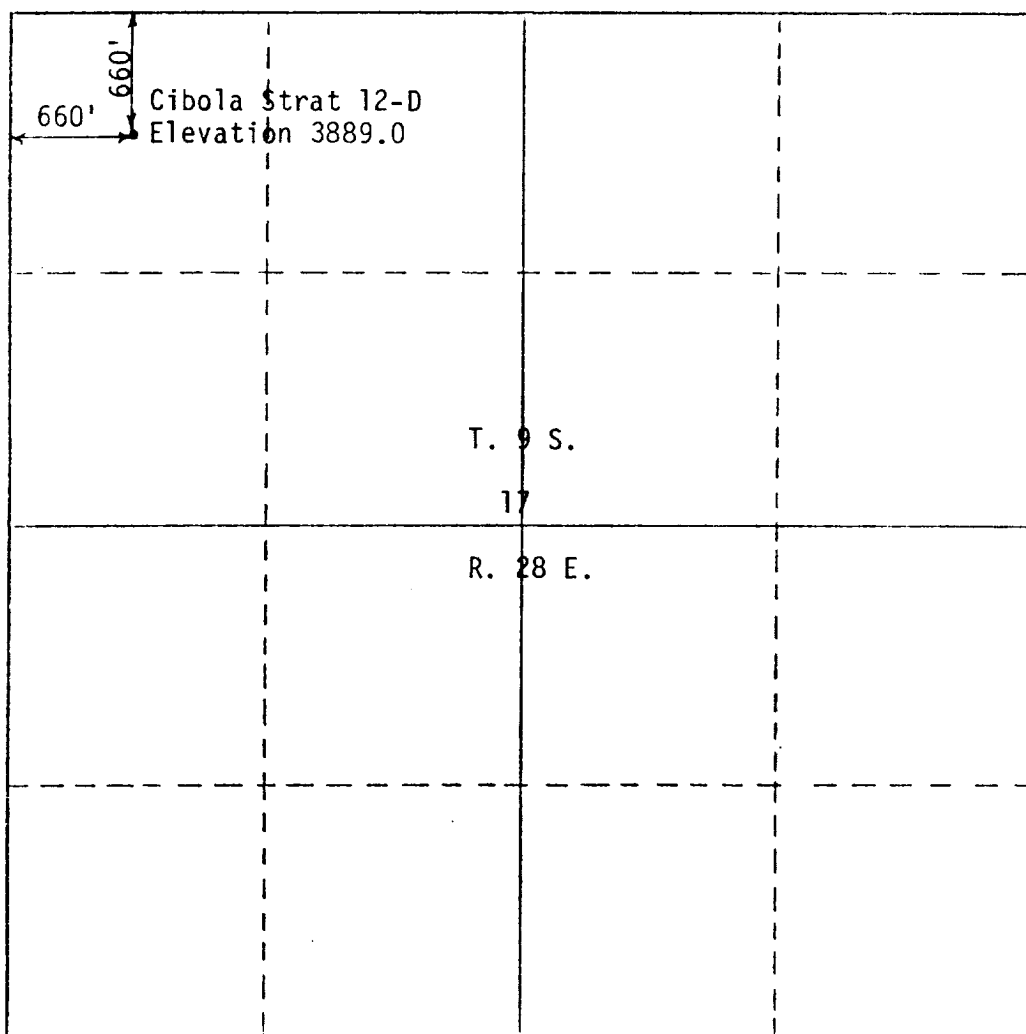

CERTIFICATION

I hereby certify that the information contained herein is true and complete to the best of my knowledge and belief.

Name
R. B. Wright
Position
Agent
Company
Cibola Energy Corp.
Date
2/26/82

I hereby certify that the well location shown on this plat was plotted from field notes of actual surveys made by me or under my supervision, and that the same is true and correct to the best of my knowledge and belief.

Date Surveyed
2/26/82
Resplate of Fretted
and/or Land Survey
Richard B. Wright
Certificate No.
7929

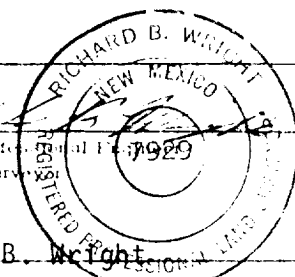

NEW MEXICO OIL CONSERVATION COMMISSION
WELL LOCATION AND ACREAGE DEDICATION PLAT

RECEIVED

Form C-102
Supersedes C-128
Effective 1-1-65

MAR - 1 1982

All distances must be from the outer boundaries of the Section.

Operator Cibola Energy			Lease Cibola Strat Test			Well No. Cibola 12-D		
Unit Letter D	Section 17	Township 9 South	Range 28 East	County Chaves				
Actual Footage Location of Well:								
660 feet from the north line and			660 feet from the west line					
Ground Level Elev. 3889.0		Producing Formation		Foot		Dedicated Acreage:		

1. Outline the acreage dedicated to the subject well by colored pencil or hatchure marks on the plat below.
2. If more than one lease is dedicated to the well, outline each and identify the ownership thereof (both as to working interest and royalty).
3. If more than one lease of different ownership is dedicated to the well, have the interests of all owners been consolidated by communitization, unitization, force-pooling, etc?

☐ Yes ☐ No If answer is "yes," type of consolidation _____

If answer is "no," list the owners and tract descriptions which have actually been consolidated. (Use reverse side of this form if necessary.) _____

No allowable will be assigned to the well until all interests have been consolidated (by communitization, unitization, forced-pooling, or otherwise) or until a non-standard unit, eliminating such interests, has been approved by the Commission.

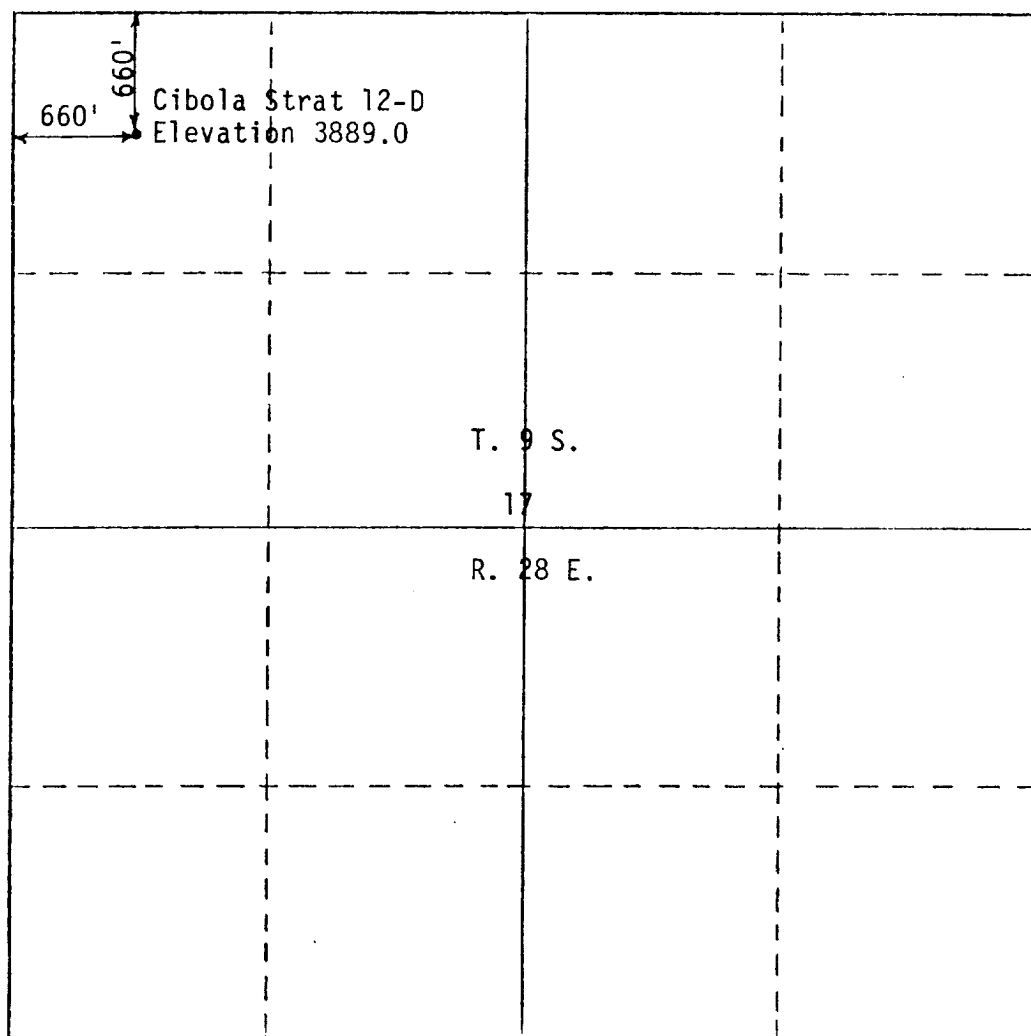

CERTIFICATION

I hereby certify that the information contained herein is true and complete to the best of my knowledge and belief.

Name

R. 3. Wright

Position

Agent

Company

Cibola Energy Corp.

Date

2/25/82

I hereby certify that the well location shown on this plat was plotted from field notes of actual surveys made by me or under my supervision, and that the same is true and correct to the best of my knowledge and belief.

2/25/82
Date Surveyed

Registered Professional Engineer
and/or Land Surveyor

Richard B. Wright
Certificate No. **7929**

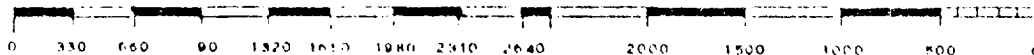
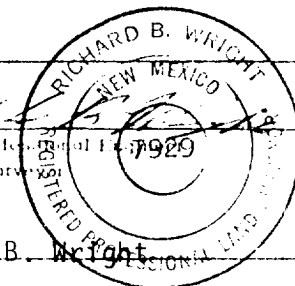

NEW MEXICO OIL CONSERVATION COMMISSION
 WELL LOCATION AND ACREAGE DEDICATION PLAT

RECEIVED

Form C-102
 Supersedes C-128
 Effective 1-1-65

MAR - 1 1982

All distances must be from the outer boundaries of the Section.

Operator Cibola Energy		Lease Cibola Strat Test		Well No. Cibola 12-D	
Unit Letter D	Section 17	Township 9 South	Range 28 East	County Chaves	
Actual Postage Location of Well:					
660 feet from the north line and		660 feet from the west line			
Ground Level Elev. 3889.0	Producing Formation	Foot	Dedicated Acreage		

1. Outline the acreage dedicated to the subject well by colored pencil or hatchure marks on the plat below.
2. If more than one lease is dedicated to the well, outline each and identify the ownership thereof (both as to working interest and royalty).
3. If more than one lease of different ownership is dedicated to the well, have the interests of all owners been consolidated by communitization, unitization, force-pooling, etc?

☐ Yes ☐ No If answer is "yes," type of consolidation _____

If answer is "no," list the owners and tract descriptions which have actually been consolidated. (Use reverse side of this form if necessary.) _____

No allowable will be assigned to the well until all interests have been consolidated (by communitization, unitization, forced-pooling, or otherwise) or until a non-standard unit, eliminating such interests, has been approved by the Commission.

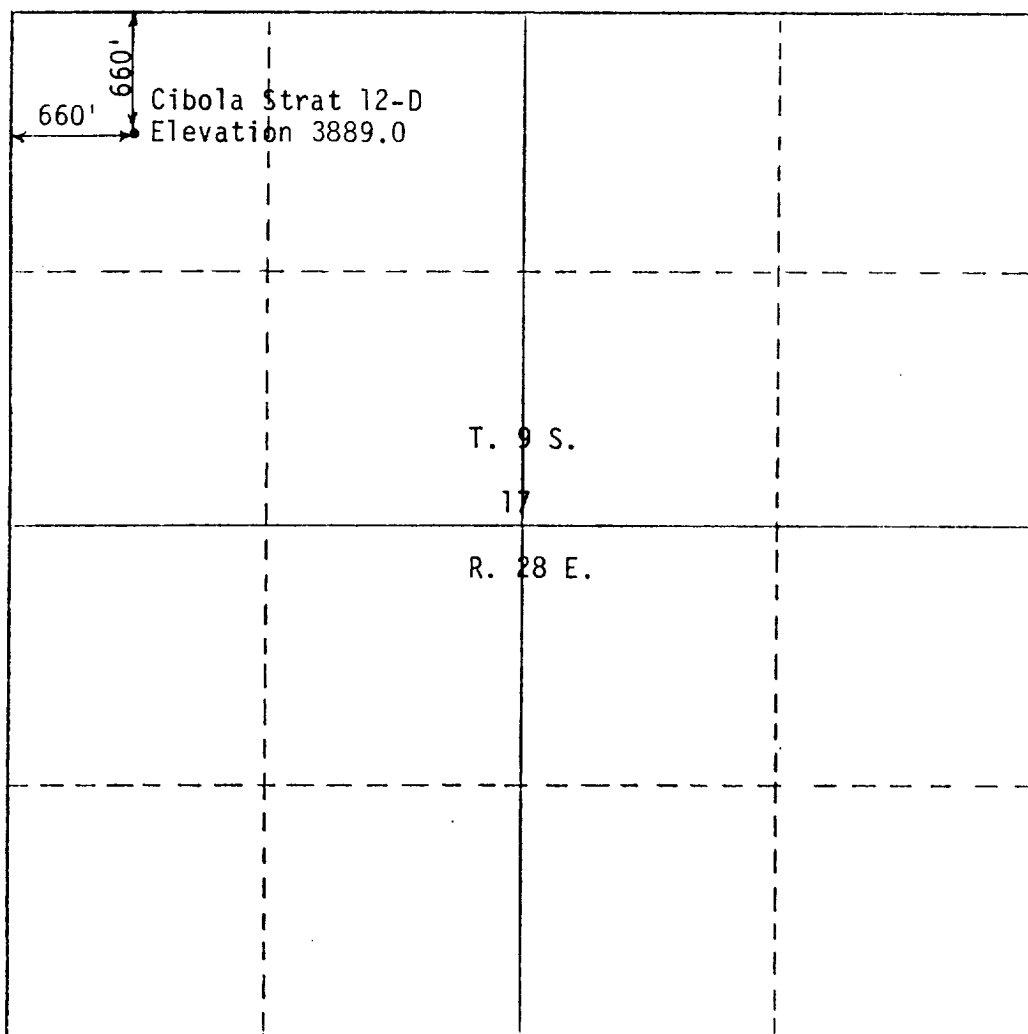

CERTIFICATION

I hereby certify that the information contained herein is true and complete to the best of my knowledge and belief.

Name

R. B. Wright

Position

Agent

Company

Cibola Energy Corp.

Date

2/25/82

I hereby certify that the well location shown on this plat was plotted from field notes of actual surveys made by me or under my supervision, and that the same is true and correct to the best of my knowledge and belief.

2/25/82
 Date Surveyed

Registered Professional Engineer
 and/or Land Surveyor

Richard B. Wright

Certificate No.

7923

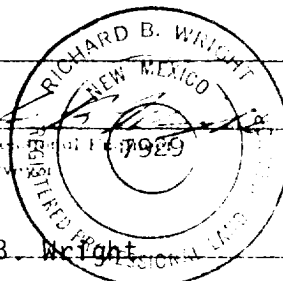

NEW MEXICO OIL CONSERVATION COMMISSION RECEIVED
 WELL LOCATION AND ACREAGE DEDICATION PLAT

Form C-102
 Supersedes C-128
 Effective 1-1-65

MAR - 1 1982

All distances must be from the outer boundaries of the Section.

Operator Cibola Energy			Lease Cibola Strat Test		Well No. Cibola 12-D
Unit Letter D	Section 17	Township 9 South	Range 28 East	County ARTESIA OFFICE Chaves	
Actual Footage Location of Well:					
660 feet from the north line and		660 feet from the west line			
Ground Level Elev. 3889.0	Producing Formation	Pool	Dedicated Acreage		

1. Outline the acreage dedicated to the subject well by colored pencil or hatchure marks on the plat below.
2. If more than one lease is dedicated to the well, outline each and identify the ownership thereof (both as to working interest and royalty).
3. If more than one lease of different ownership is dedicated to the well, have the interests of all owners been consolidated by communitization, unitization, force-pooling, etc?

☐ Yes ☐ No If answer is "yes," type of consolidation _____

If answer is "no," list the owners and tract descriptions which have actually been consolidated. (Use reverse side of this form if necessary.) _____

No allowable will be assigned to the well until all interests have been consolidated (by communitization, unitization, forced-pooling, or otherwise) or until a non-standard unit, eliminating such interests, has been approved by the Commission.

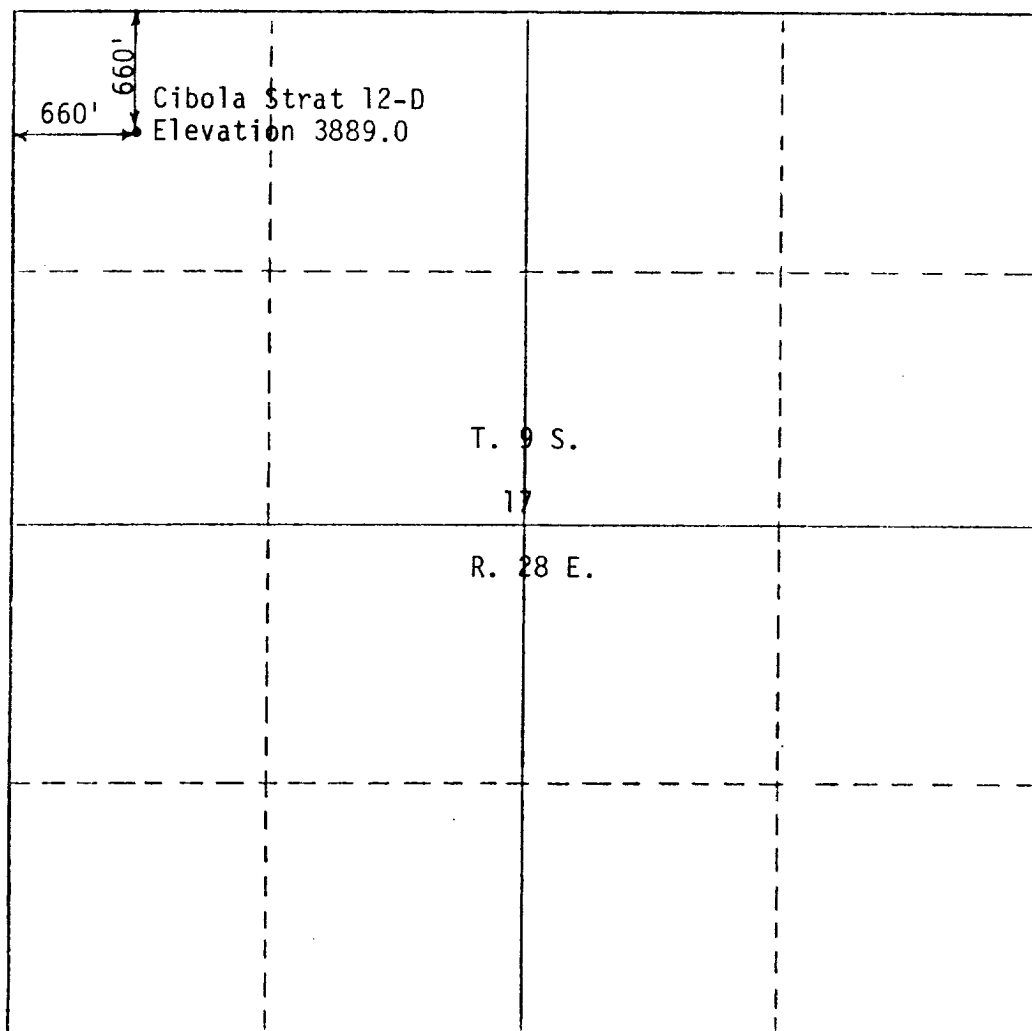

CERTIFICATION

I hereby certify that the information contained herein is true and complete to the best of my knowledge and belief.

Name _____

R. B. Wright

Position

Agent

Company

Cibola Energy Corp.

Date

2/25/82

I hereby certify that the well location shown on this plat was plotted from field notes of actual surveys made by me or under my supervision, and that the same is true and correct to the best of my knowledge and belief.

2/26/82
 Date Surveyed

Registered Professional Land Surveyor and/or Land Surveyor

Richard B. Wright

Certificate No.

7929

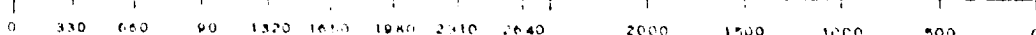
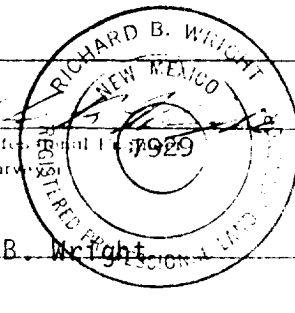

NEW MEXICO OIL CONSERVATION COMMISSION RECEIVED
W. LOCATION AND ACREAGE DEDICAT. PLAT

Form C-102
Supersedes C-128
Effective 1-1-65

All distances must be from the outer boundaries of the Section MAR - 1 1982

Operator Cibola Energy			Lease Cibola Strat Test			Well No. Cibola 12-D		
Unit Letter D	Section 17	Township 9 South	Range 28 East	County ARTESIA, OFFICE Chaves				
Actual Postage Location of Well:								
660 feet from the north line and			660 feet from the west line					
Ground Level Elev. 3889.0		Producing Formation		Feet		Dedicated Acreage		

1. Outline the acreage dedicated to the subject well by colored pencil or hachure marks on the plat below.
2. If more than one lease is dedicated to the well, outline each and identify the ownership thereof (both as to working interest and royalty).
3. If more than one lease of different ownership is dedicated to the well, have the interests of all owners been consolidated by communitization, unitization, force-pooling, etc?

☐ Yes ☐ No If answer is "yes," type of consolidation _____

If answer is "no," list the owners and tract descriptions which have actually been consolidated. (Use reverse side of this form if necessary.) _____

No allowable will be assigned to the well until all interests have been consolidated (by communitization, unitization, forced-pooling, or otherwise) or until a non-standard unit, eliminating such interests, has been approved by the Commission.

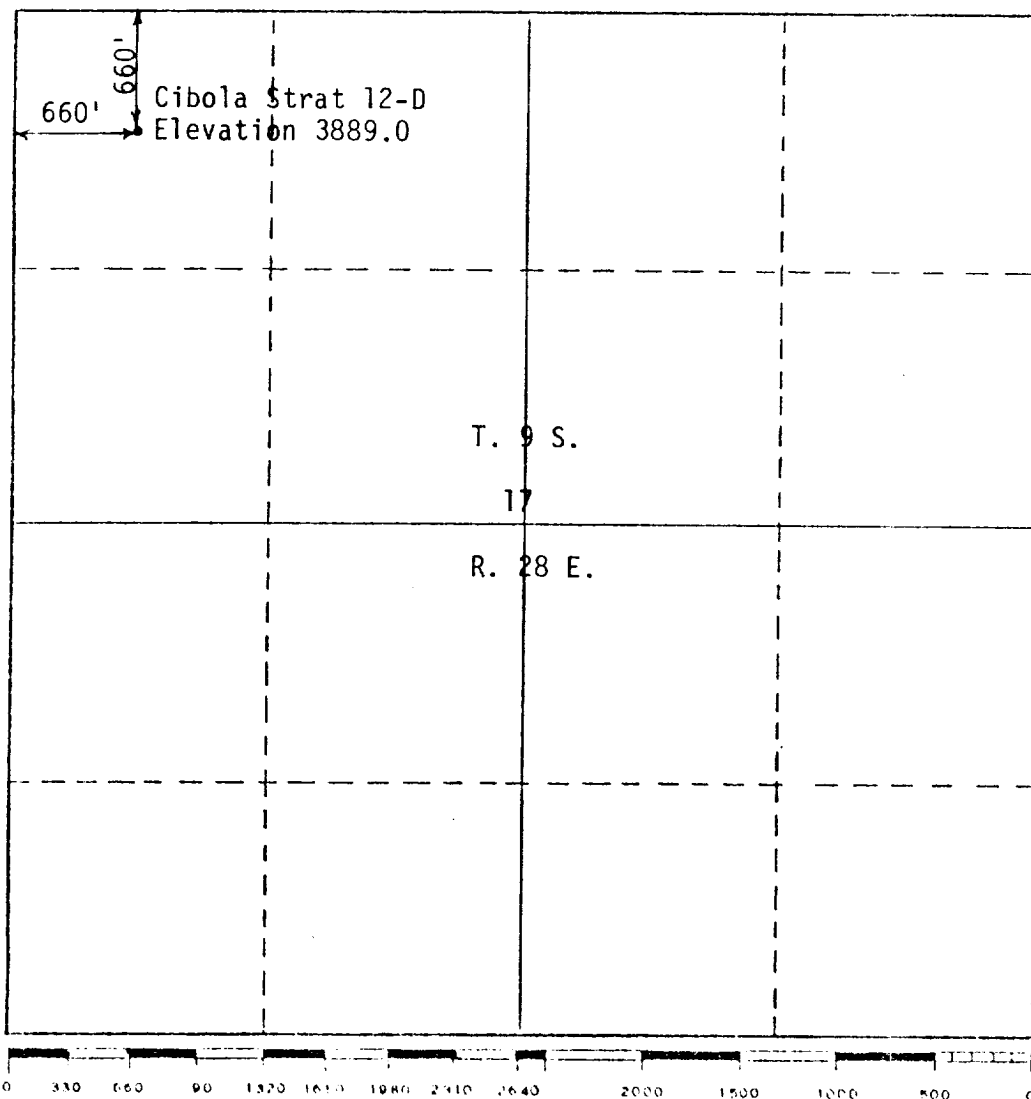

CERTIFICATION

I hereby certify that the information contained herein is true and complete to the best of my knowledge and belief.

Name
R. B. Wright

Position
Agent

Company
Cibola Energy Corp.

Date
2/26/82

I hereby certify that the well location shown on this plat was plotted from field notes of actual surveys made by me or under my supervision, and that the same is true and correct to the best of my knowledge and belief.

Date Surveyed
2/26/82

Resplate of 1 ref. Total 1-1-82
and/or Land Survey

Richard B. Wright

Certified No.
7929

