

NO. OF COPIES RECEIVED	3
DISTRIBUTION	
SANTA FE	/
FILE	/
U.S.G.S.	
LAND OFFICE	
OPERATOR	/

NEW MEXICO OIL CONSERVATION COM **RECEIVED**

JAN 27 1982

O. C. D.
ARTESIA, OFFICE

Form OC-101
Rev. 1-1-81

5A. Indicate Type of Lease
STATE ☐ FEDERAL ☒

5. Title of Lease

APPLICATION FOR PERMIT TO DRILL, DEEPEN, OR PLUG BACK

14. Type of Work a. Type of Well OIL WELL <input type="checkbox"/> GAS WELL <input type="checkbox"/> OTHER <input type="checkbox"/> b. Type of Well DRILL <input checked="" type="checkbox"/> DEEPEN <input type="checkbox"/> PLUG BACK <input type="checkbox"/> c. Type of Well OIL WELL <input type="checkbox"/> GAS WELL <input type="checkbox"/> OTHER <input type="checkbox"/> Stratigraphic Test Hole <input type="checkbox"/> SINGLE ZONE <input type="checkbox"/> MULTIPLE ZONE <input type="checkbox"/>		7. Unit Agreement Name
2. Name of Operator Cibola Energy Corporation		8. Farm or Lease Name Cibola
3. Address of Operator P.O. Box 1668, Albuquerque, New Mexico 87103		9. Well No. 18-D
4. Location of Well UNIT LETTER D LOCATED 660 FEET FROM THE North LINE AND 660 FEET FROM THE West LINE OF SEC. 19 TWP. 9S RGE. 28E N.M.P.M.		10. Field and Sect. or Wildcat N/A
		11. County Chaves
		12. County
		13. Proposed Depth
		13A. Formation
		13. Rotary or C.T.
14. E. or H. or G. or other (if any)		21A. Kind & Status Plug. Bond Statewide
		21B. Drilling Contractor Harry Bevers
		22. Approx. Date Work will start 1-27-82

23.

PROPOSED CASING AND CEMENT PROGRAM

SIZE OF HOLE	SIZE OF CASING	WEIGHT PER FOOT	SETTING DEPTH	SACKS OF CEMENT	EST. TOP
4 1/2"	N/A	N/A	N/A	N/A	N/A

We plan to drill a 4 1/2" hole 20' into Yates formation. A Gamma Ray log will be run to determine the top of the Yates. A suitable cement plug will be pumped into the hole to plug from TD to the top of the water zone. Location will be cleaned and marker set.

THIS WELL IS BEING DRILLED AS A STRATIGRAPHIC TEST-HOLE FOR GEOLOGICAL INFORMATION ONLY AND UNDER NO CIRCUMSTANCES WILL IT BE PRODUCED.

IN ABOVE SPACE DESCRIBE PROPOSED PROGRAM: IF PROPOSAL IS TO DEEPEN OR PLUG BACK, GIVE DATA ON PRESENT PRODUCTIVE ZONE AND PROPOSED NEW PRODUCTIVE ZONE. GIVE BLOWOUT PREVENTER PROGRAM, IF ANY.

I hereby certify that the information above is true and complete to the best of my knowledge and belief.

Signed Quita Vigil Title Drilling Secretary Date 1-25-82

(This space for State Use)

APPROVED BY Mike Williams TITLE OIL AND GAS INSPECTOR DATE JAN 29 1982

CONDITIONS OF APPROVAL, IF ANY:

NEW MEXICO OIL CONSERVATION COMMISSION
WELL LOCATION AND ACREAGE DEDICATION PLAT

RECEIVED

Form C-102
Supersedes C-128
Effective 1-1-65

FEB 25 1982

All distances must be from the outer boundaries of the Section.

Operator Cibola Energy			Lease Cibola Strat Test		Well No. Cibola 18-D
Unit Letter D	Section 19	Township 9 South	Range 28 East	County Chaves	
Actual Postage Location of Well: 660 feet from the north line and 660 feet from the west line					
Ground Level Elev. 3890.0	Producing Formation		Pool	Dedicated Acreage: Acres	

1. Outline the acreage dedicated to the subject well by colored pencil or hatchure marks on the plat below.
2. If more than one lease is dedicated to the well, outline each and identify the ownership thereof (both as to working interest and royalty).
3. If more than one lease of different ownership is dedicated to the well, have the interests of all owners been consolidated by communitization, unitization, force-pooling, etc?

☐ Yes ☐ No If answer is "yes," type of consolidation _____

If answer is "no," list the owners and tract descriptions which have actually been consolidated. (Use reverse side of this form if necessary.) _____

No allowable will be assigned to the well until all interests have been consolidated (by communitization, unitization, forced-pooling, or otherwise) or until a non-standard unit, eliminating such interests, has been approved by the Commission.

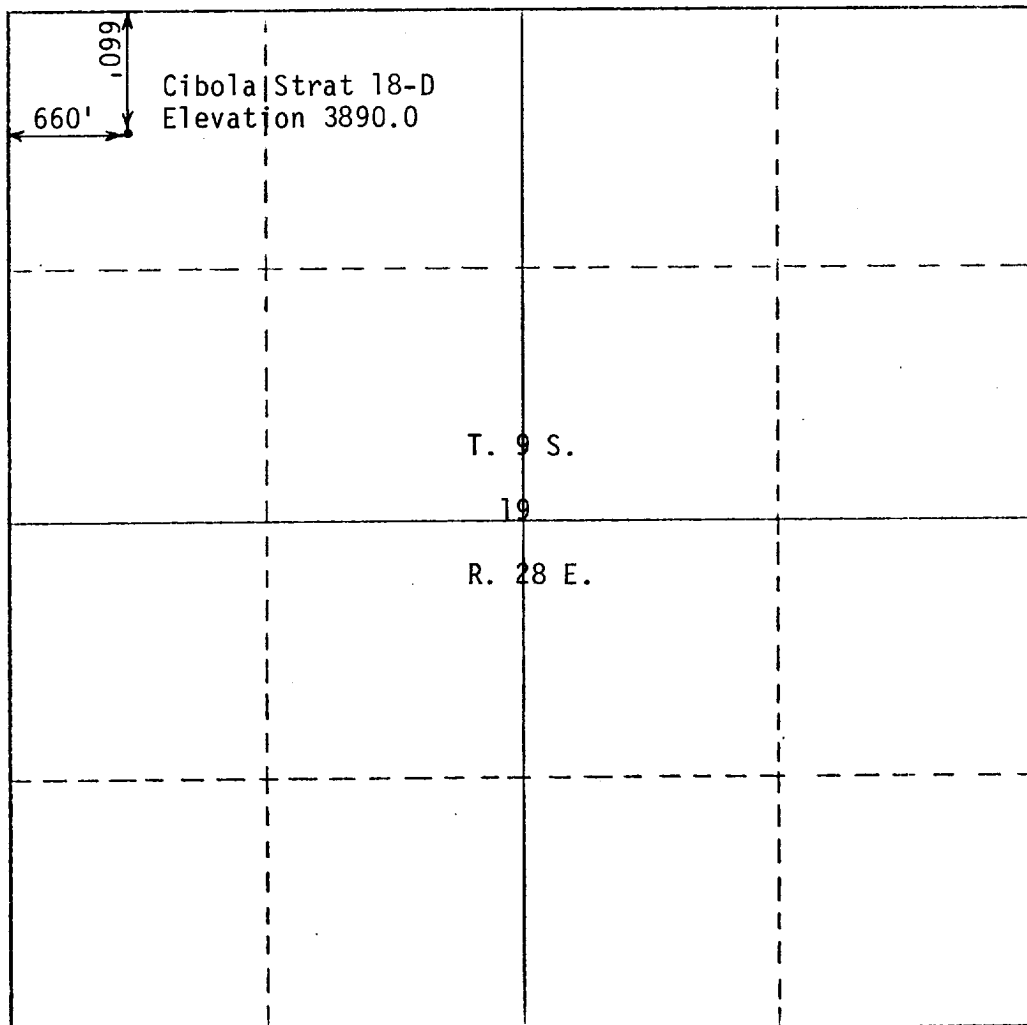

CERTIFICATION

I hereby certify that the information contained herein is true and complete to the best of my knowledge and belief.

[Signature]
Name

R. B. Wright
Position

Agent
Company
Cibola Energy Corp.

Date
2/23/82

I hereby certify that the well location shown on this plat was plotted from field notes of actual surveys made by me or under my supervision, and that the same is true and correct to the best of my knowledge and belief.

Date Surveyed
2/23/82

[Signature]
Registered Professional Engineer
and/or Land Surveyor

Richard B. Wright

Certificate No.
7929

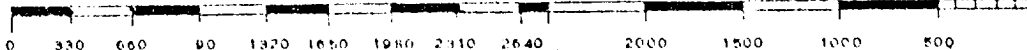
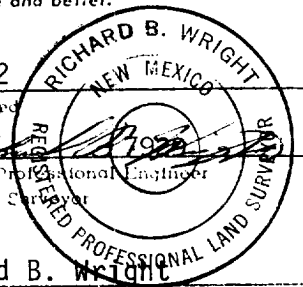

NEW MEXICO OIL CONSERVATION COMMISSION
WELL LOCATION AND ACREAGE DEDICATION PLAT

Form C-102
Supersedes C-128
Effective 1-1-65

All distances must be from the outer boundaries of the Section.

FEB 2 1982

Operator Cibola Energy			Lease Cibola Strat Test		Well No. Cibola 18-D
Well Letter D	Section 19	Township 9 South	Range 28 East	County Chaves	
Actual Footage Location of Well:					
660 feet from the north line and		660 feet from the west line			
Ground Level Elev. 3890.0	Producing Formation		Pool	Dedicated Acreage	

1. Outline the acreage dedicated to the subject well by colored pencil or hatchure marks on the plat below.
2. If more than one lease is dedicated to the well, outline each and identify the ownership thereof (both as to working interest and royalty).
3. If more than one lease of different ownership is dedicated to the well, have the interests of all owners been consolidated by communitization, unitization, force-pooling, etc?

☐ Yes ☐ No If answer is "yes," type of consolidation _____

If answer is "no," list the owners and tract descriptions which have actually been consolidated. (Use reverse side of this form if necessary.) _____

No allowable will be assigned to the well until all interests have been consolidated (by communitization, unitization, forced-pooling, or otherwise) or until a non-standard unit, eliminating such interests, has been approved by the Commission.

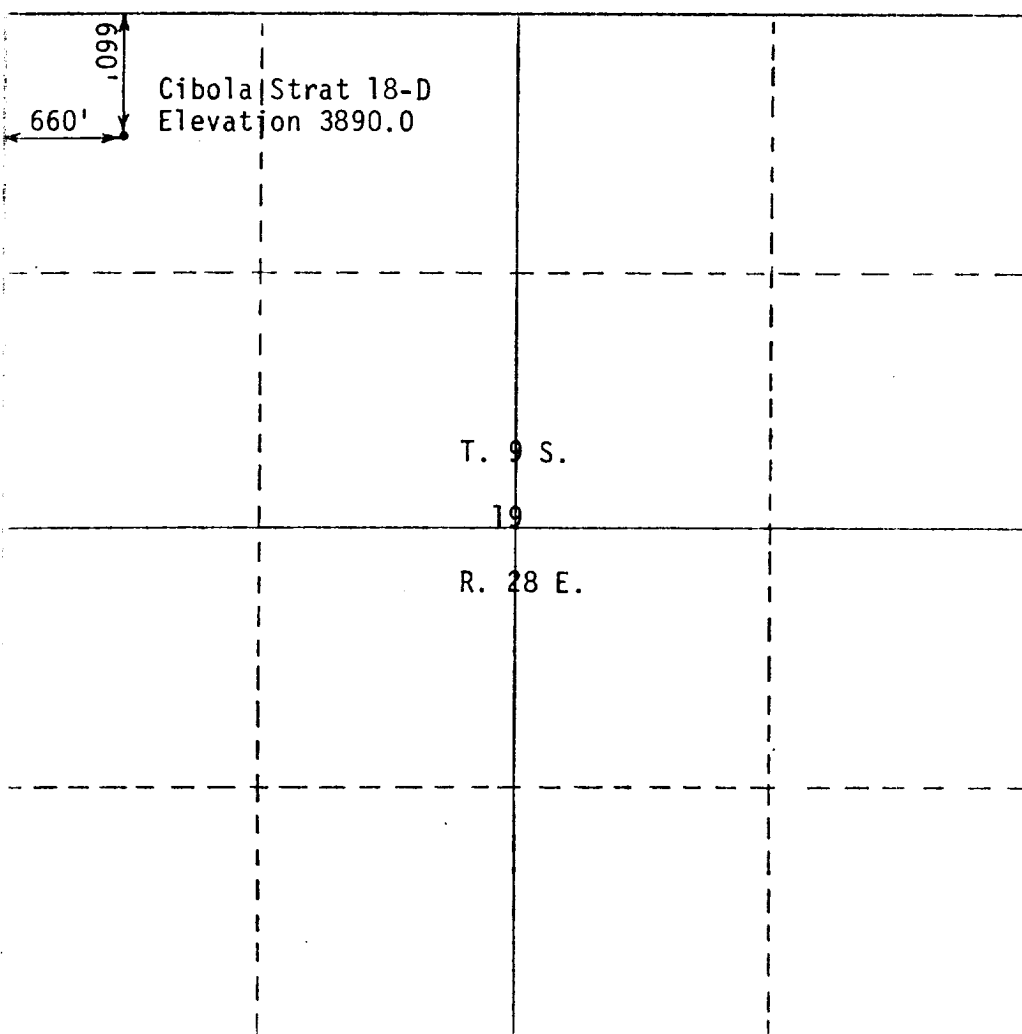

CERTIFICATION

I hereby certify that the information contained herein is true and correct to the best of my knowledge and belief.

[Signature]
Name

R. B. Wright
Position

Agent
Company
Cibola Energy Corp.

Date
2/23/82

I hereby certify that the well location shown on this plat was plotted from field notes of actual surveys made by me or under my supervision, and that the same is true and correct to the best of my knowledge and belief.

2/23/82

Date Surveyed
[Signature]
Registered Professional Engineer
and/or Land Surveyor

Richard B. Wright

Certificate No.
7929

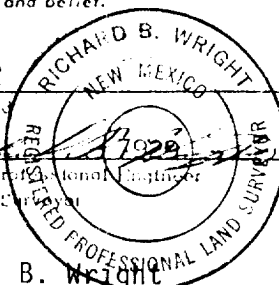

NEW MEXICO OIL CONSERVATION COMMISSION
WELL LOCATION AND ACREAGE DEDICATION, LAT

RECEIVED

Form C-102
Supersedes C-12A
Effective 1-1-65

FEB 25 1982

All distances must be from the outer boundaries of the Section.

Operator Cibola Energy			Lease Cibola Strat Test		Well No. Cibola 18-D
Unit Letter D	Section 19	Township 9 South	Range 28 East	County Chaves	
Actual Well Location of Well:					
660 feet from the north line and		660 feet from the west line		Elev.	
Ground Level Elev. 3890.0		Feet		Dedicated Acreage	

1. Outline the acreage dedicated to the subject well by colored pencil or hatchure marks on the plat below.
2. If more than one lease is dedicated to the well, outline each and identify the ownership thereof (both as to working interest and royalty).
3. If more than one lease of different ownership is dedicated to the well, have the interests of all owners been consolidated by communitization, unitization, force-pooling, etc?

☐ Yes ☐ No If answer is "yes," type of consolidation _____

If answer is "no," list the owners and tract descriptions which have actually been consolidated. (Use reverse side of this form if necessary.) _____

No allowable will be assigned to the well until all interests have been consolidated (by communitization, unitization, forced-pooling, or otherwise) or until a non-standard unit, eliminating such interests, has been approved by the Commission.

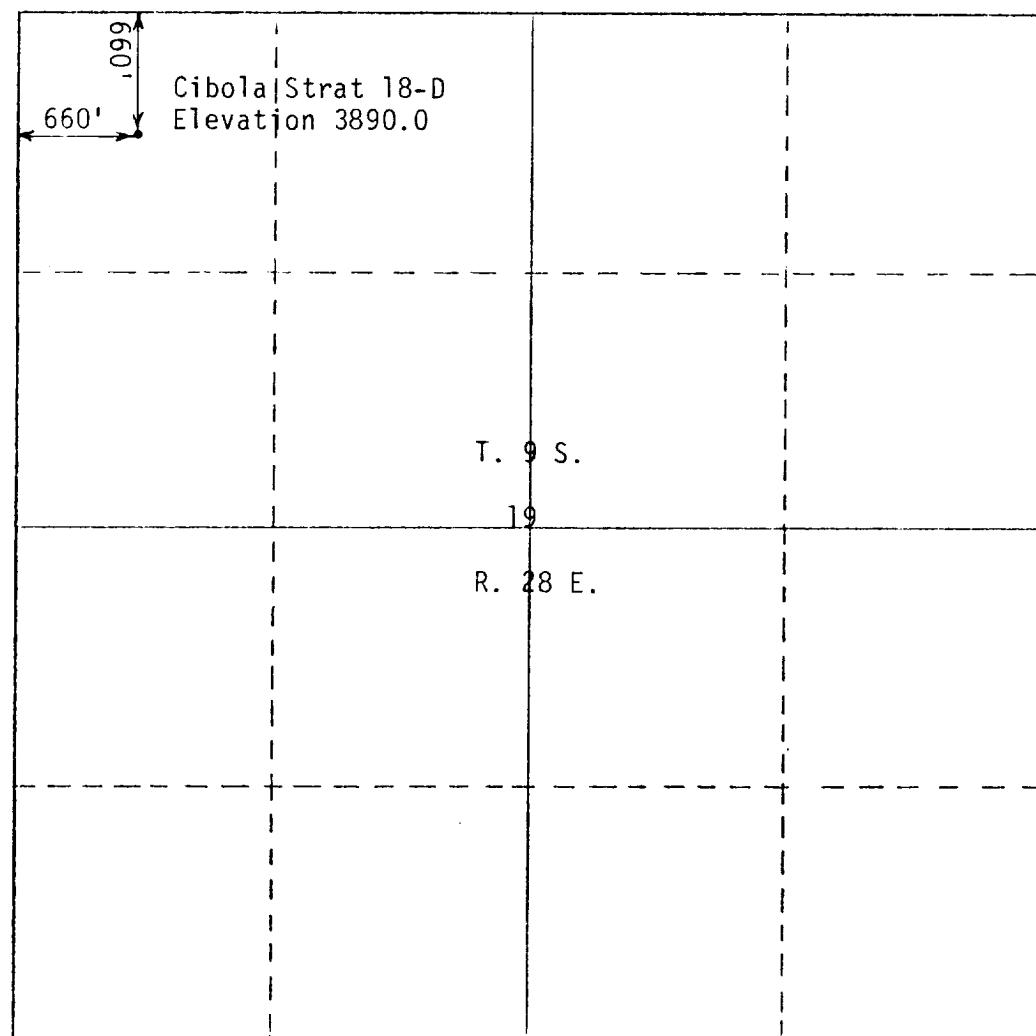

CERTIFICATION

I hereby certify that the information contained herein is true and complete to the best of my knowledge and belief.

[Signature]
Name

R. B. Wright
Position

Agent
Company

Cibola Energy Corp.

Date
2/23/82

I hereby certify that the well location shown on this plat was plotted from field notes of actual surveys made by me or under my supervision, and that the same is true and correct to the best of my knowledge and belief.

2/23/82
Date Surveyed

[Signature]
Registered Professional Engineer
and/or Land Surveyor

Richard B. Wright

Certificate No.
7929

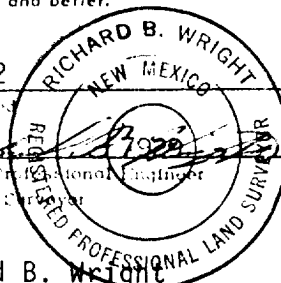

NEW MEXICO OIL CONSERVATION COMMISSION
WELL LOCATION AND ACREAGE DEDICATION . LAT

RECEIVED

Form C-102
Supersedes C-128
Effective 1-1-65

FEB 25 1982

All distances must be from the outer boundaries of the Section

Operator Cibola Energy		Lease Cibola Strat Test		Well No. Cibola 18-D	
Unit Letter D	Section 19	Township 9 South	Range 28 East	County ARTESIO	
Actual Well Location of Well:					
660 feet from the north		660 feet from the west		Line	
Ground Elevation 3890.0	Elevating Formation		Pool	Dedicated Acreage	

1. Outline the acreage dedicated to the subject well by colored pencil or hachure marks on the plat below.
2. If more than one lease is dedicated to the well, outline each and identify the ownership thereof (both as to working interest and royalty).
3. If more than one lease of different ownership is dedicated to the well, have the interests of all owners been consolidated by communitization, unitization, force-pooling, etc?

☐ Yes ☐ No If answer is "yes," type of consolidation _____

If answer is "no," list the owners and tract descriptions which have actually been consolidated. (Use reverse side of this form if necessary.) _____

No allowable will be assigned to the well until all interests have been consolidated (by communitization, unitization, forced-pooling, or otherwise) or until a non-standard unit, eliminating such interests, has been approved by the Commission.

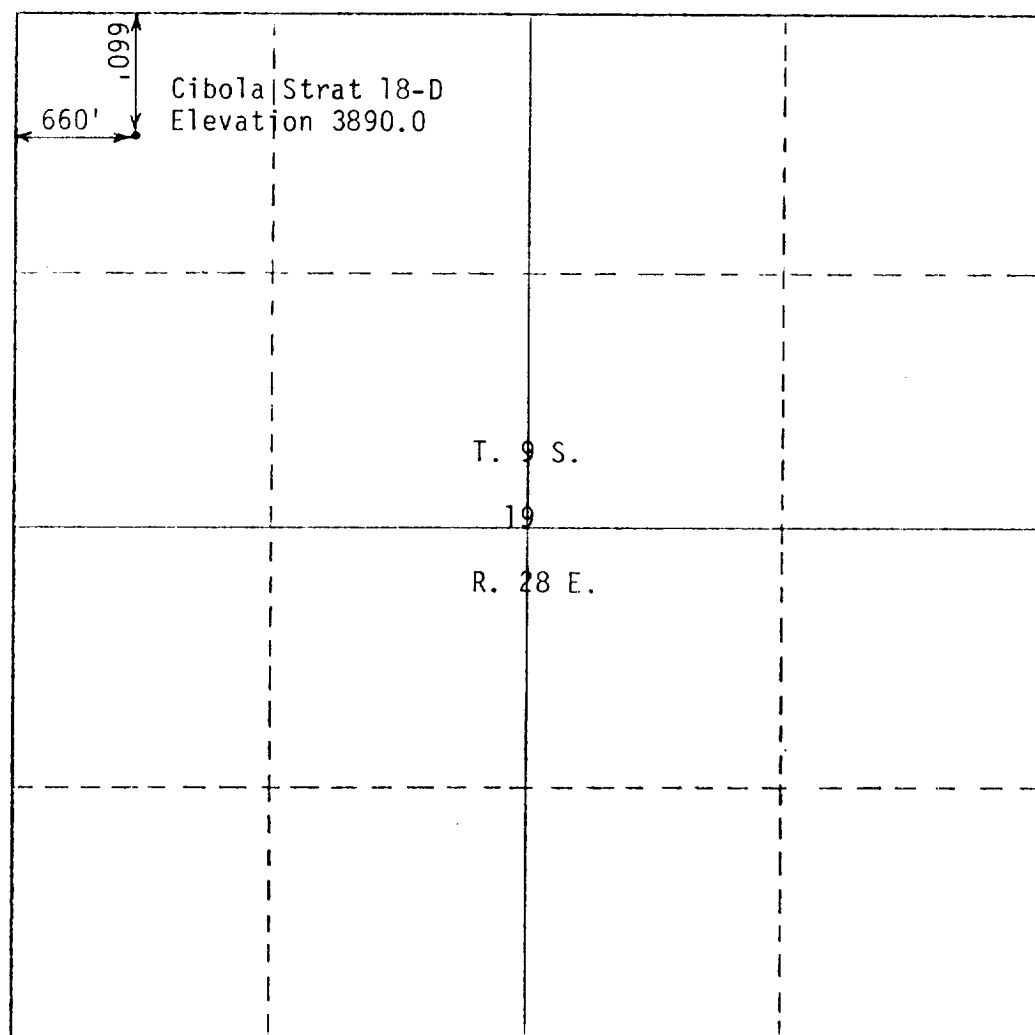

CERTIFICATION

I hereby certify that the information contained herein is true and complete to the best of my knowledge and belief.

Richard B. Wright
Name

R. B. Wright
Position

Agent

Company

Cibola Energy Corp.

Date

2/23/82

I hereby certify that the well location shown on this plat was plotted from field notes of actual surveys made by me or under my supervision, and that the same is true and correct to the best of my knowledge and belief.

2/23/82

Date Surveyed

Registered Professional Engineer and/or Land Surveyor

Richard B. Wright

Certificate No.

7929

NEW MEXICO OIL CONSERVATION COMMISSION
WELL LOCATION AND ACREAGE DEDICATION, LAT

RECEIVED

Form C-102
Supersedes C-128
Effective 1-1-65

All distances must be from the outer boundaries of the Section.

FEB 25 1982

Operator Cibola Energy		Lease Cibola Strat Test		Well No. Cibola 18-D
Unit Letter D	Section 19	Township 9 South	Range 28 East	County Chaves
Actual Well Location of Well:				
660 feet from the north line and		660 feet from the west line		
Ground Level Elev. 3890.0	Producing Formation	Pool	Dedicated Acreage	

1. Outline the acreage dedicated to the subject well by colored pencil or hatchure marks on the plat below.
2. If more than one lease is dedicated to the well, outline each and identify the ownership thereof (both as to working interest and royalty).
3. If more than one lease of different ownership is dedicated to the well, have the interests of all owners been consolidated by communitization, unitization, force-pooling, etc?

☐ Yes ☐ No If answer is "yes," type of consolidation _____

If answer is "no," list the owners and tract descriptions which have actually been consolidated. (Use reverse side of this form if necessary.) _____

No allowable will be assigned to the well until all interests have been consolidated (by communitization, unitization, forced-pooling, or otherwise) or until a non-standard unit, eliminating such interests, has been approved by the Commission.

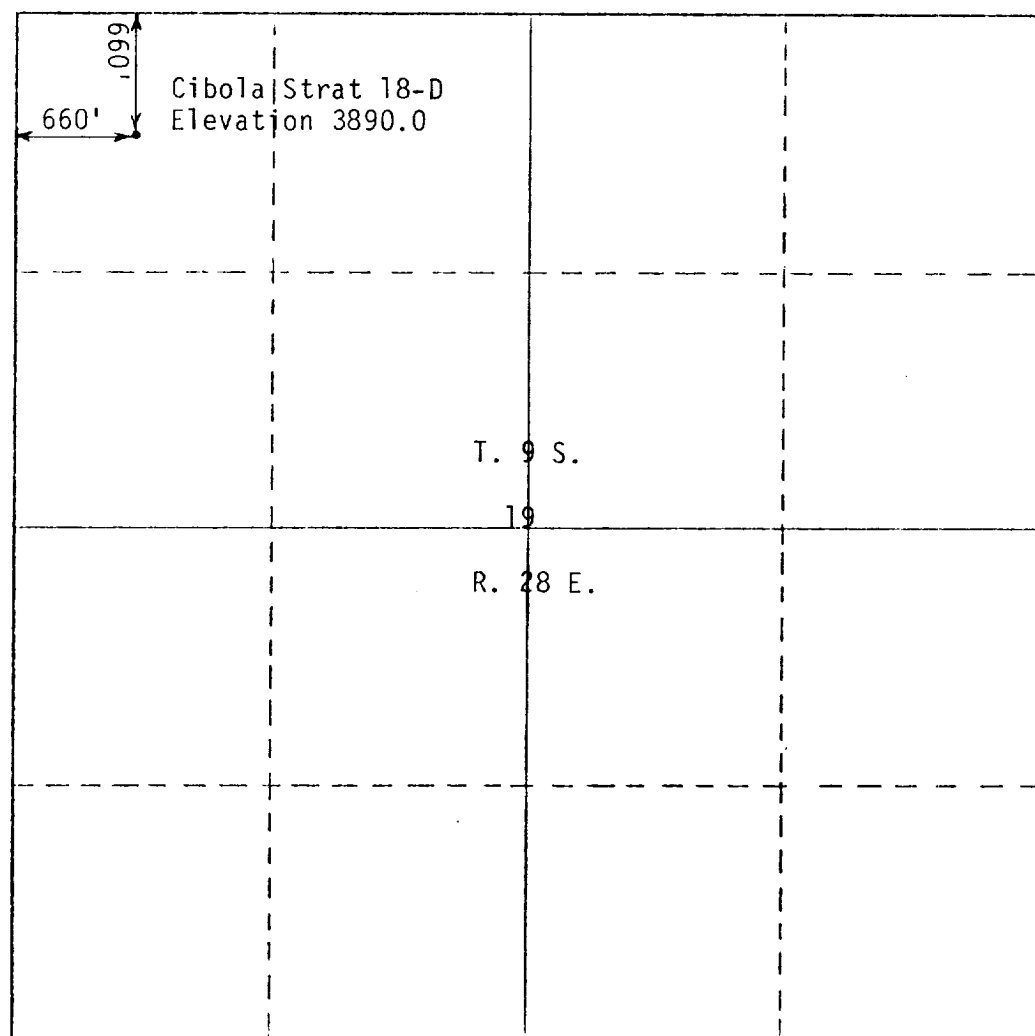

CERTIFICATION

I hereby certify that the information contained herein is true and complete to the best of my knowledge and belief.

[Signature]
Name

R. B. Wright
Position

Agent

Company

Cibola Energy Corp.

Date

2/23/82

I hereby certify that the well location shown on this plat was plotted from field notes of actual surveys made by me or under my supervision, and that the same is true and correct to the best of my knowledge and belief.

2/23/82

Date Surveyed

[Signature]
Registered Professional Engineer
and/or Land Surveyor

Richard B. Wright

Certificate No.

7929

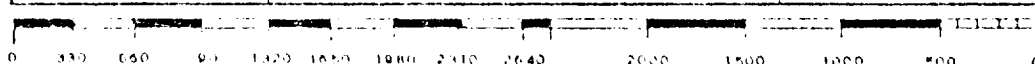
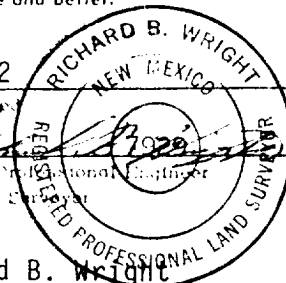

NEW MEXICO OIL CONSERVATION COMMISSION
WELL LOCATION AND ACREAGE DEDICATION PLAT

RECEIVED

Form C-102
Supersedes C-128
Effective 1-1-65

All distances must be from the outer boundaries of the Section.

FEB 25 1982

Operator Cibola Energy			Lease Cibola Strat Test		Well No. Cibola 18-D
Well Letter D	Section 19	Township 9 South	Range 28 East	County Chaves	
Actual Well Location of Well:					
660		feet from the north	line and	660	feet from the west
Ground Level Elev. 3890.0	Underlying Formation		Pool	Dedicated Acreage	

1. Outline the acreage dedicated to the subject well by colored pencil or hatchure marks on the plat below.
2. If more than one lease is dedicated to the well, outline each and identify the ownership thereof (both as to working interest and royalty).
3. If more than one lease of different ownership is dedicated to the well, have the interests of all owners been consolidated by communitization, unitization, force-pooling, etc?

☐ Yes ☐ No If answer is "yes," type of consolidation _____

If answer is "no," list the owners and tract descriptions which have actually been consolidated. (Use reverse side of this form if necessary.) _____

No allowable will be assigned to the well until all interests have been consolidated (by communitization, unitization, forced-pooling, or otherwise) or until a non-standard unit, eliminating such interests, has been approved by the Commission.

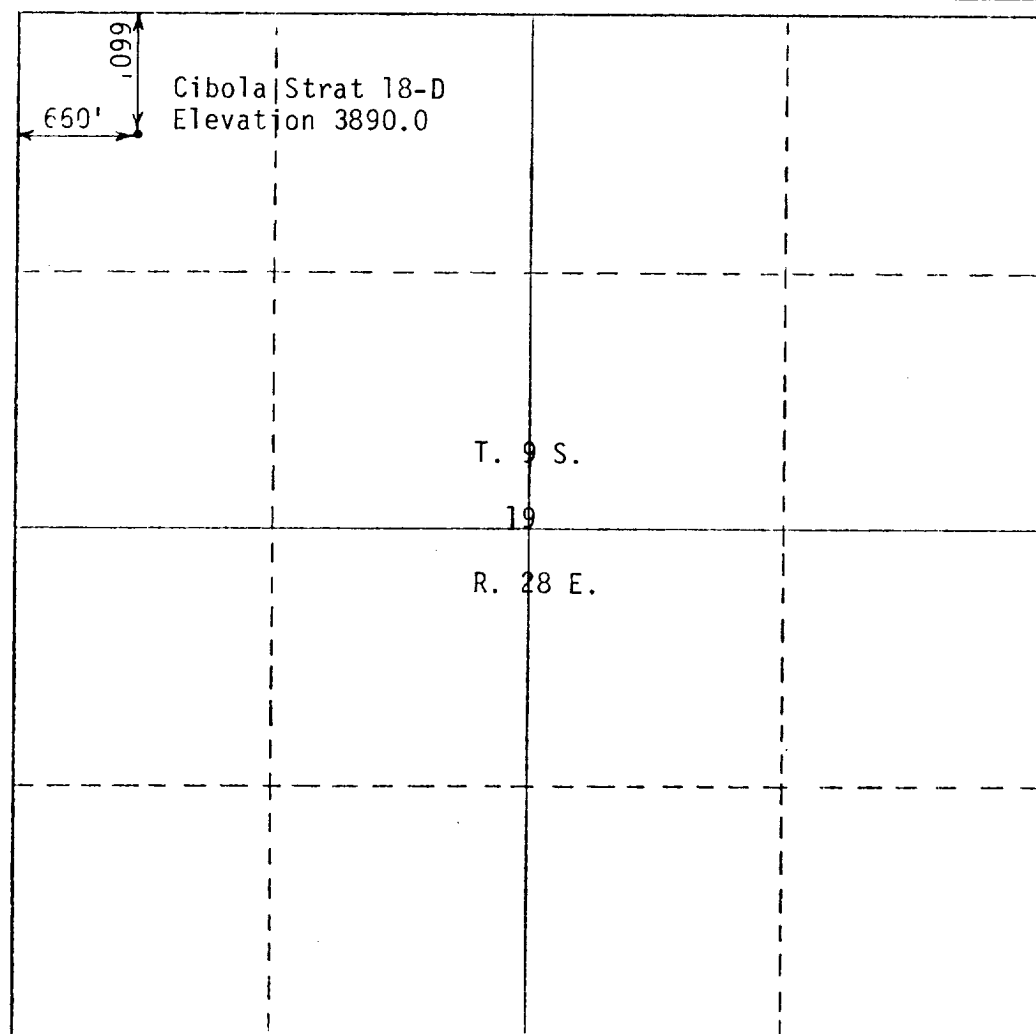

CERTIFICATION

I hereby certify that the information contained herein is true and complete to the best of my knowledge and belief.

[Signature]
Name

R. B. Wright
Position

Agent
Company

Cibola Energy Corp.

Date
2/23/82

I hereby certify that the well location shown on this plat was plotted from field notes of actual surveys made by me or under my supervision, and that the same is true and correct to the best of my knowledge and belief.

2/23/82
Date Surveyed

[Signature]
Registered Professional Engineer
and/or Land Surveyor

Richard B. Wright

Certificate No.
7929

